

"NEW CULVERT REQUIRED"
 STA 125+41 CONSTRUCT NEW 15" R.C.P. AND D.I. WITH GRADE LENGTH 90 FT.
 REIN. CONCRETE CLASS A (1:2:4) 1.2 Cu. Yds.
 REIN. CONCRETE CLASS B (1:2:4) 1.6 Cu. Yds.
 REIN. STEEL 31 Lbs.
 STA 132+87 CONSTRUCT NEW 3'x3' BOX CULVERT
 REIN. CONCRETE CLASS A (1:2:4) 23.7 Cu. Yds.
 REIN. STEEL 1362 LBS.

"NEW WOOD GUARD RAIL REQUIRED"
 -ON LEFT-
 STA 123+86 TO STA 124+10 LENGTH 24 FT.
 STA 125+50 TO STA 125+55 - 24 FT.
 TOTAL ON STREET 48 FT.

"NEW CABLE GUARD RAIL REQUIRED"
 -ON RIGHT-
 STA 122+25 TO STA 125+53 LENGTH 328 FT.
 STA 130+50 TO STA 131+88 - 136 FT.
 STA 132+30 TO STA 133+10 - 80 FT.
 -ON LEFT-
 STA 132+30 TO STA 133+90 - 160 FT.
 TOTAL ON SHEET 704 FT.

FED. ROAD DIST. NO.	STATE	FED. AID FISCAL YEAR	TOTAL SHEETS
77 D	1928	5	7

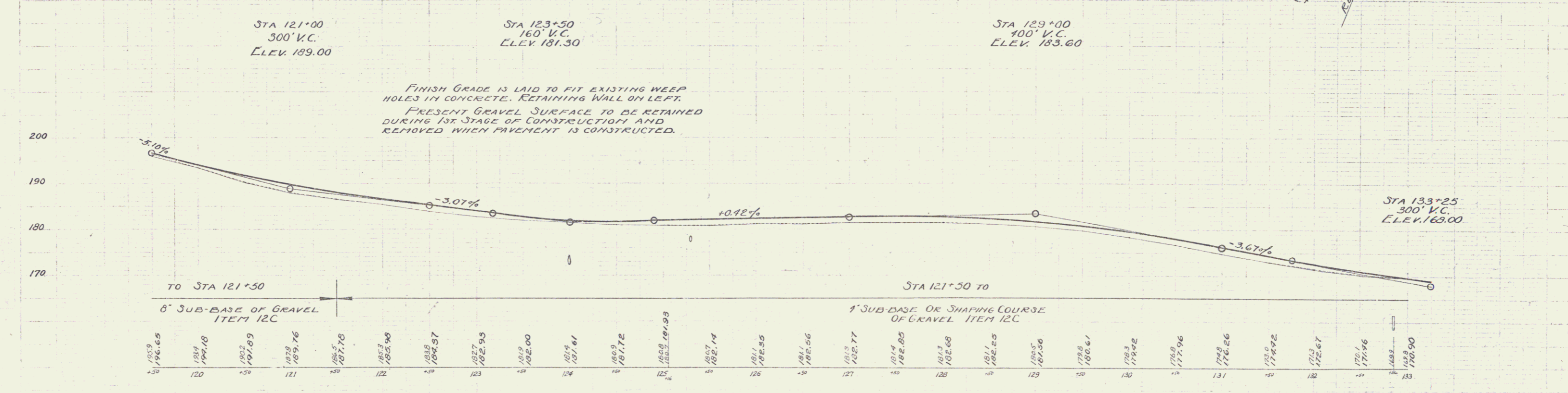
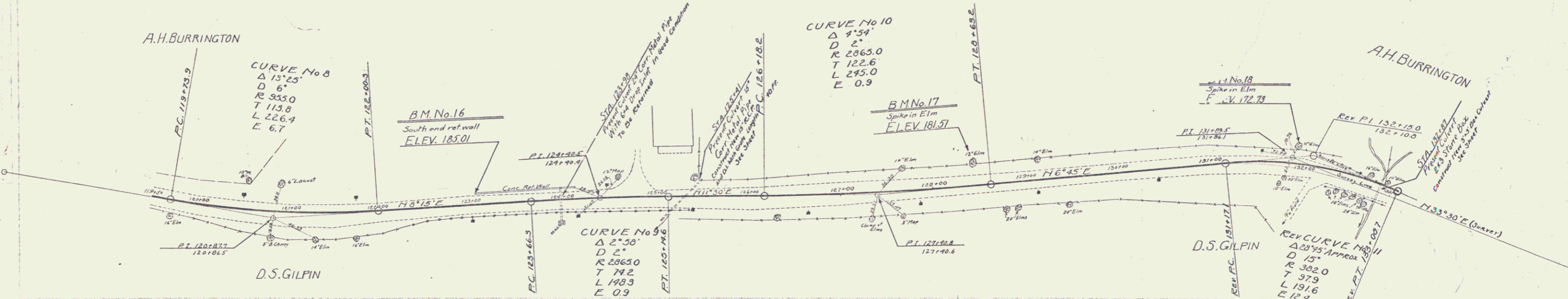

B.M. No. 16 - South end concrete retaining wall at left STA. 123+05 - ELEV. 185.01
 B.M. No. 17 - Spike in trunk 12" Elm at left STA. 128+4 - ELEV. 181.51
 B.M. No. 18 - Spike in root 11" Elm at left STA. 131+91 - ELEV. 172.73

SERIES NO. F 77 D
 SHEET 5 OF 7