

INDEX OF SHEETS

SHEET NO.	TITLE PAGE
1	TYPICAL CROSS-SECTION OF IMPROVEMENT—STAGE CONSTRUCTION—ONE COURSE
2	PLAN AND PROFILE STA. 91+00 TO 105+00 CEMENT CONCRETE PAVEMENT (TYPE B)
3	" " " " 105+00 TO 119+50 " " " "
4	" " " " 119+50 TO 133+00 " " " "
5	" " " " 133+00 TO 143+00 " " " "
6	" " " " 143+00 TO 149+90 " " " "
7	" " " " " " " " " " " "
8	STANDARD SHEET S-17
9	" " " " S-18
10	" " " " S-19
11	STANDARD CONCRETE BOX CULVERT—SPANS 5 TO 10 FEET
12	CROSS SECTIONS

FED. ROAD DIST. NO.	STATE	FED. AID PROJ. NO.	FISCAL YEAR	SHEET NO.	TOTAL SHEETS
9	VT.	FAP 77D	1928	1	21

STATE OF VERMONT
STATE HIGHWAY DEPARTMENT

PLAN AND PROFILE OF PROPOSED
STATE HIGHWAY

FEDERAL-AID PROJECT

TOWN OF WINDSOR

CONNECTICUT RIVER ROAD

FROM THE END OF FAP 77C NORTH 1.115 MILES
TO THE WINDSOR-HARTLAND TOWN LINE
LENGTH OF PROJECT 5890.0 FT. = 1.115 MILES

Route: US 5
Proj: FAP 77D
Pin # 99R 323

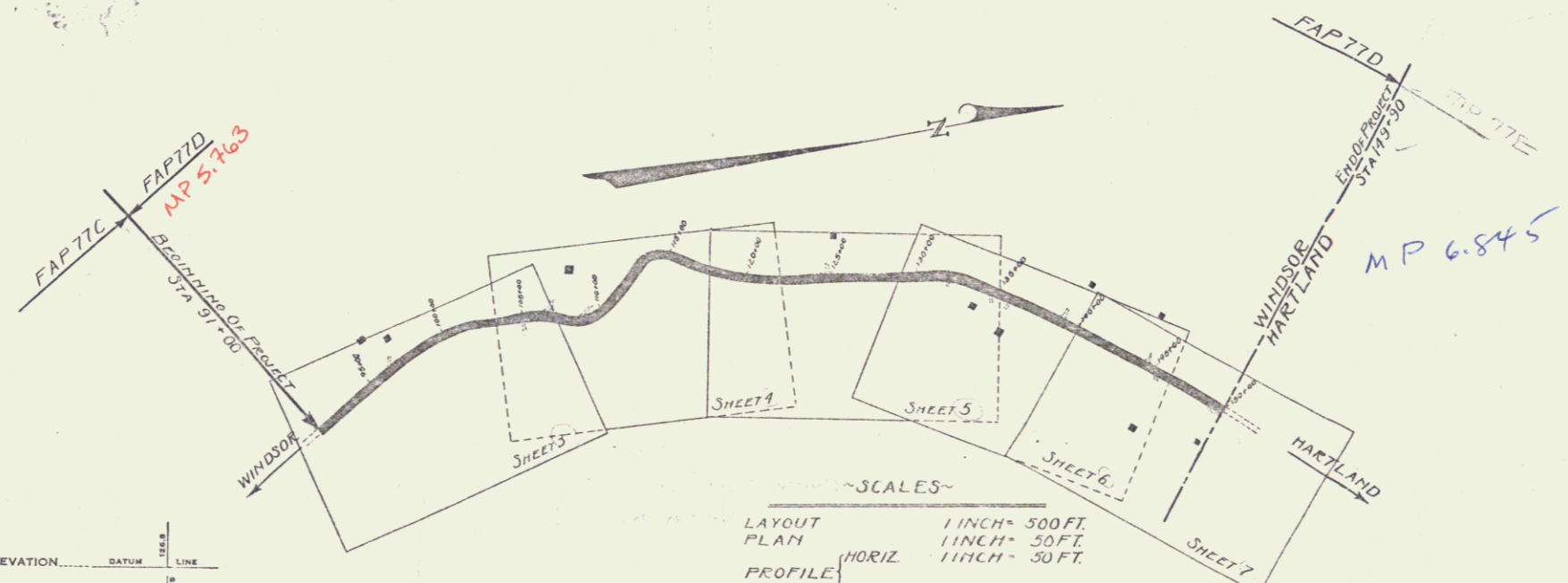
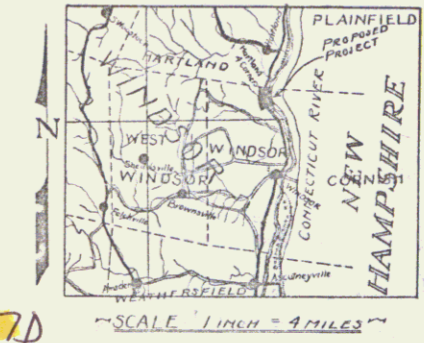

CONVENTIONAL SIGNS

COUNTY LINE	GROUND ELEVATION	BATHY LINE
TOWN LINE	GRADE ELEVATION	LINE
FENCE LINE		
STONE WALL		
UNFENCED PROPERTY		
GUARD RAIL		
TRAVELED WAY		
RAILROAD		
RETAINING WALL		
CENTER LINE		
SURVEY LINE		
CULVERT		
DROP INLET		
TROLLEY POLE		
POWER POLE		
TELEPHONE POLE		
TREES		
HEDGE		

CURVE DATA

DEFLECTION ANGLE	Δ
DEGREE OF CURVE	D
RADIUS OF CURVE	R
TANGENT DISTANCE	T
LENGTH OF CURVE	L
EXTERNAL DISTANCE	E
POINT OF INTERSECTION	P. I.
POINT OF CURVE	P. C.
POINT OF TANGENT	P. T.
POINT ON TANGENT	P. O. T.

SCALES

LAYOUT	1 INCH = 500 FT.
PLAN	1 INCH = 30 FT.
PROFILE	1 INCH = 30 FT.
VERT.	1 INCH = 10 FT.
CROSS SECTIONS	1 INCH = 5 FT.

THIS PROJECT TO BE CONSTRUCTED IN ACCORDANCE WITH STANDARD SPECIFICATIONS ON FILE WITH THE U.S. BUREAU OF PUBLIC ROADS AS APPROVED JULY 7, 1926.

THESE PLANS SUBJECT TO SUCH REVISIONS AS MAY BE REQUIRED BY THE BUREAU OF PUBLIC ROADS OR THE CHIEF ENGINEER.

RIGHT-OF-WAY DIVISION
TOWN FILE

PERPETUAL
Town of US 5
(To Be Returned To R.O.W. Division)

APPROVED: Sept 17, 1928
H. E. ...
CHIEF ENGINEER
SUBMITTED BY ORDER OF THE STATE HIGHWAY BOARD
Sept 17, 1928
L. R. ...
COMMISSIONER OF HIGHWAYS

RECOMMENDED
DISTRICT ENGINEER BUREAU OF PUBLIC ROADS
RECOMMENDED FOR APPROVAL
CHIEF ENGINEER BUREAU OF PUBLIC ROADS
APPROVED
DIRECTOR BUREAU OF PUBLIC ROADS

SERIES FAP No. 77D FILED
SHEET 1 OF 21

DIST. # 4 Plans