

LD. ROAD DIST. NO.	STATE	FED. AID PROJ. NO.	FISCAL YEAR	SHEET NO.	TOTAL SHEETS
9	VT	77C	1927	3	

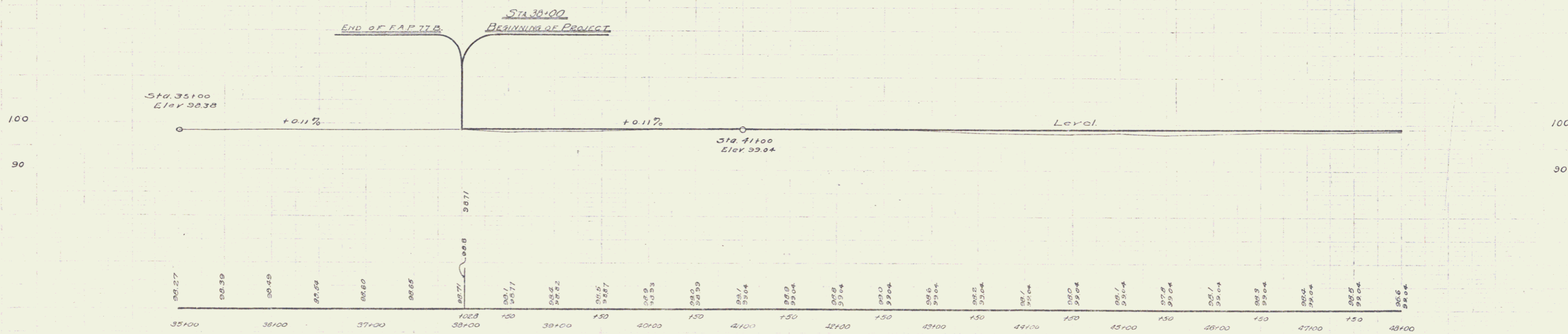
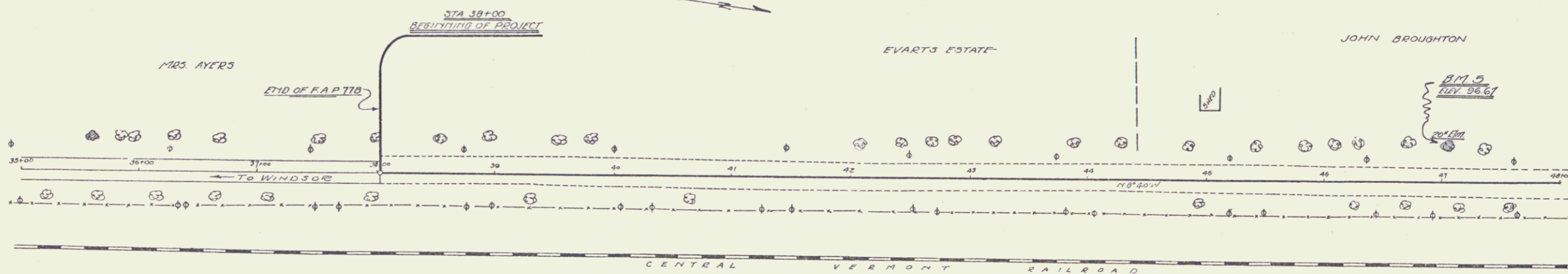

S.M. 5 - SPIKE IN 20' DIA. AT STA. 47+00 - ELEV. 96.61 - (ELEV. 103.32 AT END OF PART B)

Series F. No. 77C
Sheet 3 of 3