

NOTE
 The Contractor will be required to remove all material that is above the original ground line on the right, Sta 518+50 to 527+00, between the fence and the toe of slope of the new roadway. This excavation is to be paid for as "Common Excavation Incl Borrow" (Item 10-11) or "Solid Rock Excavation" (Item 10) in accordance with the Specifications.

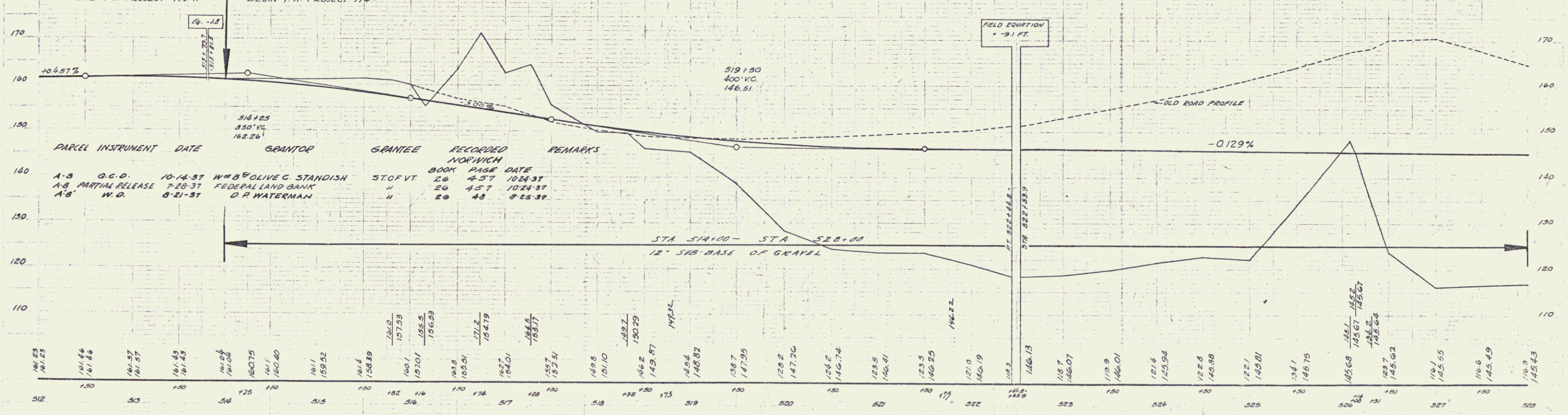
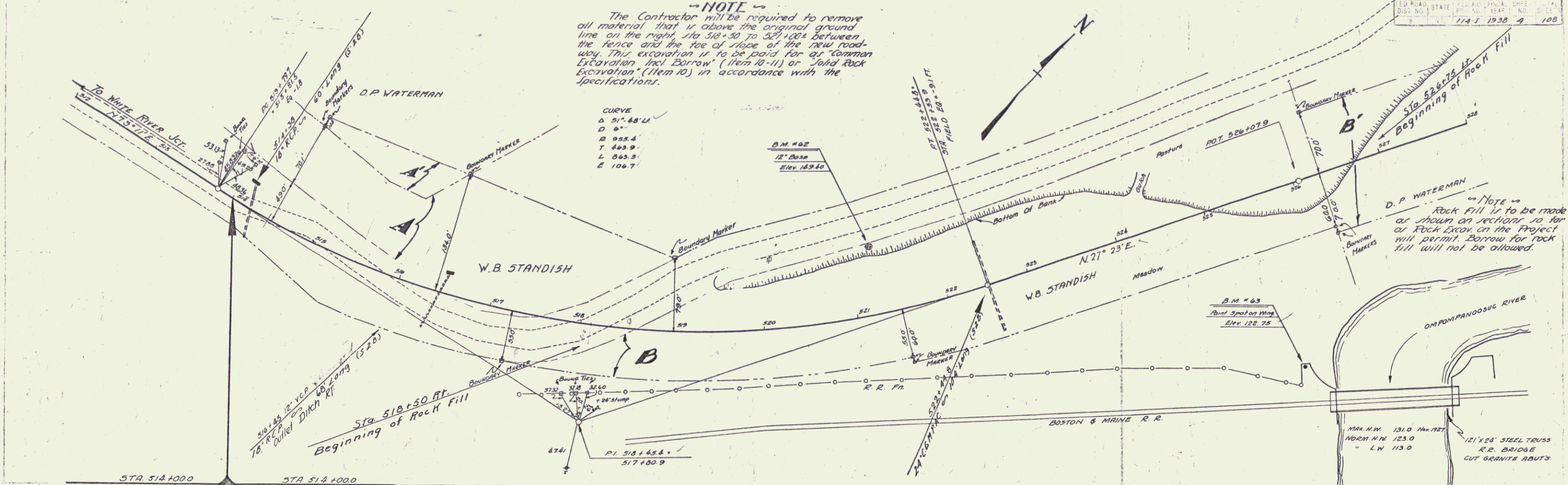

PARCEL	INSTRUMENT	DATE	GRANTOR	GRANTEE	RECORDED	REMARKS
A-B	G.C.D.	10-14-37	W & B OLIVE C. STANDISH	STOFVT	BOOK 26 PAGE 457	1024-37
A-B	PARTIAL RELEASE	7-29-37	FEDERAL LAND BANK	"	BOOK 26 PAGE 457	1024-37
A-B	W.G.	8-21-37	D.P. WATERMAN	"	BOOK 26 PAGE 48	1025-37

STA 514+00 - STA 528+00
 12" SUB-BASE OF GRAVEL

512	141.52	513	141.46	514	141.45	515	141.45	516	141.04	517	140.75	518	140.40	519	140.11	520	139.82	521	139.52	522	139.22	523	138.92	524	138.62	525	138.32	526	138.02	527	137.72	528	137.42	529	137.12
-----	--------	-----	--------	-----	--------	-----	--------	-----	--------	-----	--------	-----	--------	-----	--------	-----	--------	-----	--------	-----	--------	-----	--------	-----	--------	-----	--------	-----	--------	-----	--------	-----	--------	-----	--------