

Parcel	Kind of Instrument	Date of Instrument	Grantor	Grantee	Recorded Form	Page	Date	Remarks
A&B&C#1	Q.C.D.	11-28-32	Daniel Currier	Sholvt.	25	469	12-14-32	276+78
C #2	Q.C.D.	11-25-32	Maud Davis	"	25	468	12-14-32	270+19
D	Q.C.D.	11-25-32	Dr. L.B. Jones	"	25	466	12-14-32	
E & F	W.D.	11-25-32	Sherman Melendy	"	25	133	12-14-32	

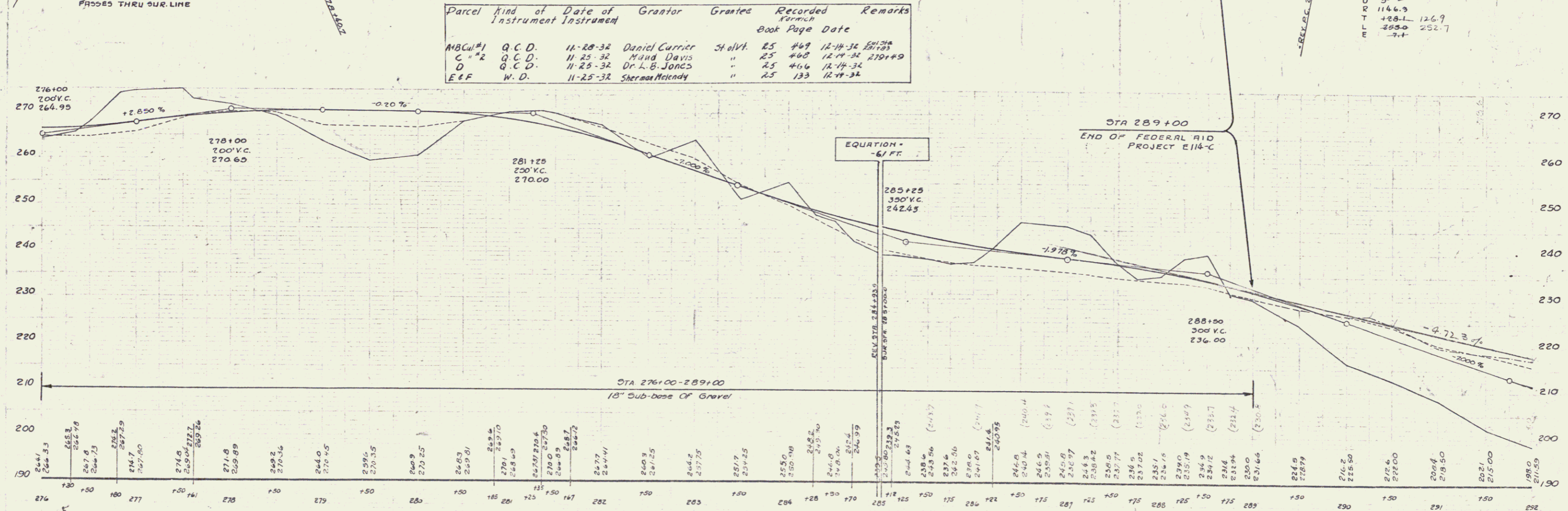

B.M. #31 SPIKE IN ROOT OF 12" MAPLE, 66 FT. RT. OF STA 277+69, ELEV. 266.74
 B.M. #32 SPIKE IN ROOT OF 26" ELM, 37 FT. LT. OF STA 284+56, ELEV. 247.31
 B.M. #33 SPIKE IN TRUNK OF 10" OAK, 9 FT. RT. OF STA 290+12 'B' LINE, ELEV. 226.24