

GUARD RAIL REQUIRED ON LEFT
 Sta. 77+18 to Sta. 77+92 Length 24ft
 - 82+31 - - 82+75 - 24 -
 - 85+32 - - 85+58 - 24 -
 - 88+30 - - 88+54 - 24 -

ON RIGHT
 Sta. 77+18 to Sta. 77+92 Length 24ft
 - 82+31 - - 82+75 - 24 -
 - 85+32 - - 85+58 - 24 -
 - 88+30 - - 88+54 - 188 -

TOTAL THIS SHEET 336ft

STONE BASE REQUIRED
 Sta. 82+63 to Sta. 90+00 Length 737ft

STANDARD UNDERDRAIN REQUIRED
 Sta. 75+00 to Sta. 82+63 Length 763ft

NEW CULVERTS REQUIRED

Sta. 88+42 4'x4' Reinforced Concrete 28'9"
 1-2-4 Concrete 73 cu yds
 1-3-6 Concrete 14.5 -
 Steel 193 lbs

Sta. 77+30 2'x2' Concrete 23'6"
 1-2-4 Concrete 4.8 cu yds
 1-3-6 - 6.7 -

Sta. 82+63 2'x2' Concrete 27ft
 1-2-4 Concrete 5.5 cu yds
 1-3-6 - 7.3 -

Sta. 85+44 3'x3' Reinforced Concrete 27ft
 1-2-4 Concrete 5.7 cu yds
 1-3-6 - 10.5 -
 Steel 122 lbs

FED. ROAD DIST. NO.	STATE	FED. AID PROGRAM	FISCAL YEAR	SHEET NO.	TOTAL SHEETS
5	VT.	19	1940	8	18

E. H. Dyer
 E. H. Dyer
 E. H. Dyer

E. H. Dyer
 E. H. Dyer
 E. H. Dyer

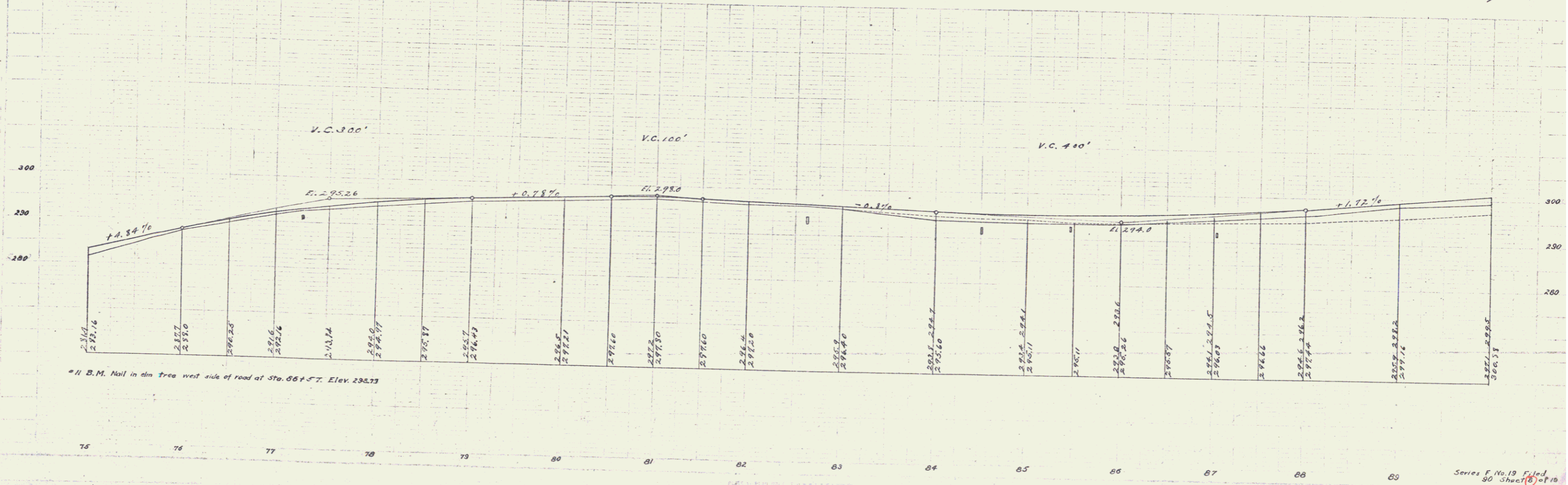
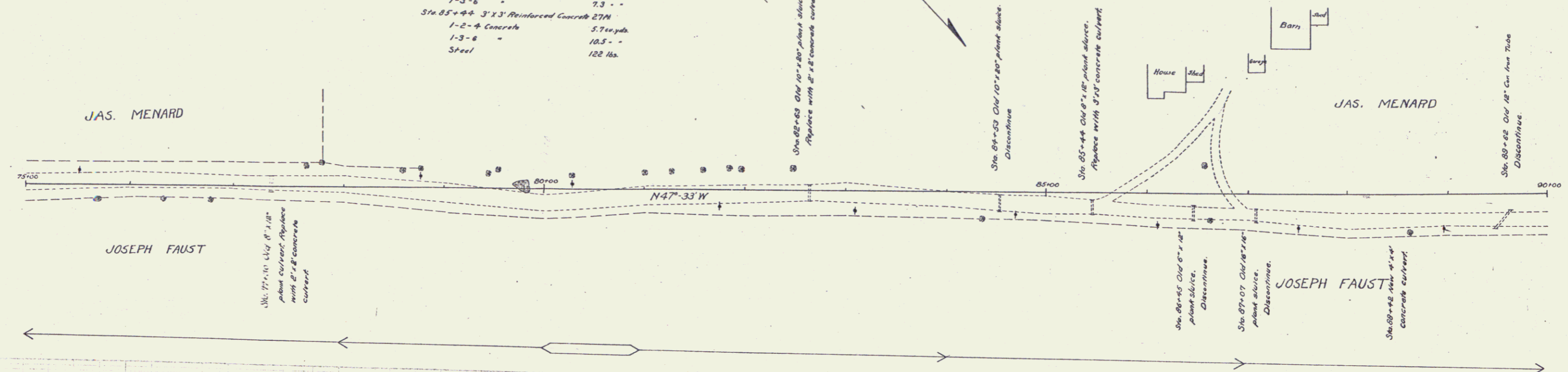

Series F No. 18 F. 1st 80 Sheet 8 of 18

7