

**GUARD RAIL REQUIRED ON LEFT**

Sta. 62-19 to Sta. 62+43 Length 24 ft  
 " 66-13 " " 66+37 " 24 "  
 " 70-59 " " 70+83 " 24 "  
 " 74-49 " " 74+73 " 24 "

**ON RIGHT**

Sta. 60-60 to Sta. 64+76 Length 416 ft  
 " 66-10 to " 68+50 " 240 "  
 " 70+59 " " 70+83 " 24 "  
 " 74+49 " " 74+73 " 24 "

TOTAL THIS SHEET 800 ft.

**NEW CULVERTS REQUIRED**

Sta. 62-22 2'x2' Concrete Culvert 29'3"  
 1-2-4 Concrete 5.9 cu yds  
 1-5-6 " 7.7 "

Sta. 66-22 2'x2' Concrete Culvert 28'6"  
 1-2-4 Concrete 5.7 cu yds  
 1-3-5 " 7.6 "

Sta. 70-62 3'x3' Reinforced Concrete 28'6"  
 1-2-4 Concrete 6.0 cu yds  
 1-3-5 " 10.9 "

Spew 130 lbs

**STANDARD UNDERDRAIN REQUIRED**

Sta. 74+60 to Sta. 75+00 Length 40 ft

FED. ROAD DIST. NO.	STATE	FED. AID PROJ. NO.	FISCAL YEAR	SHEET NO.	TOTAL SHEETS
6	VT.	13	1926	7	13

E. F. Welch  
E. H. Day  
Sketch

E. F. Welch  
E. H. Day  
Sketch

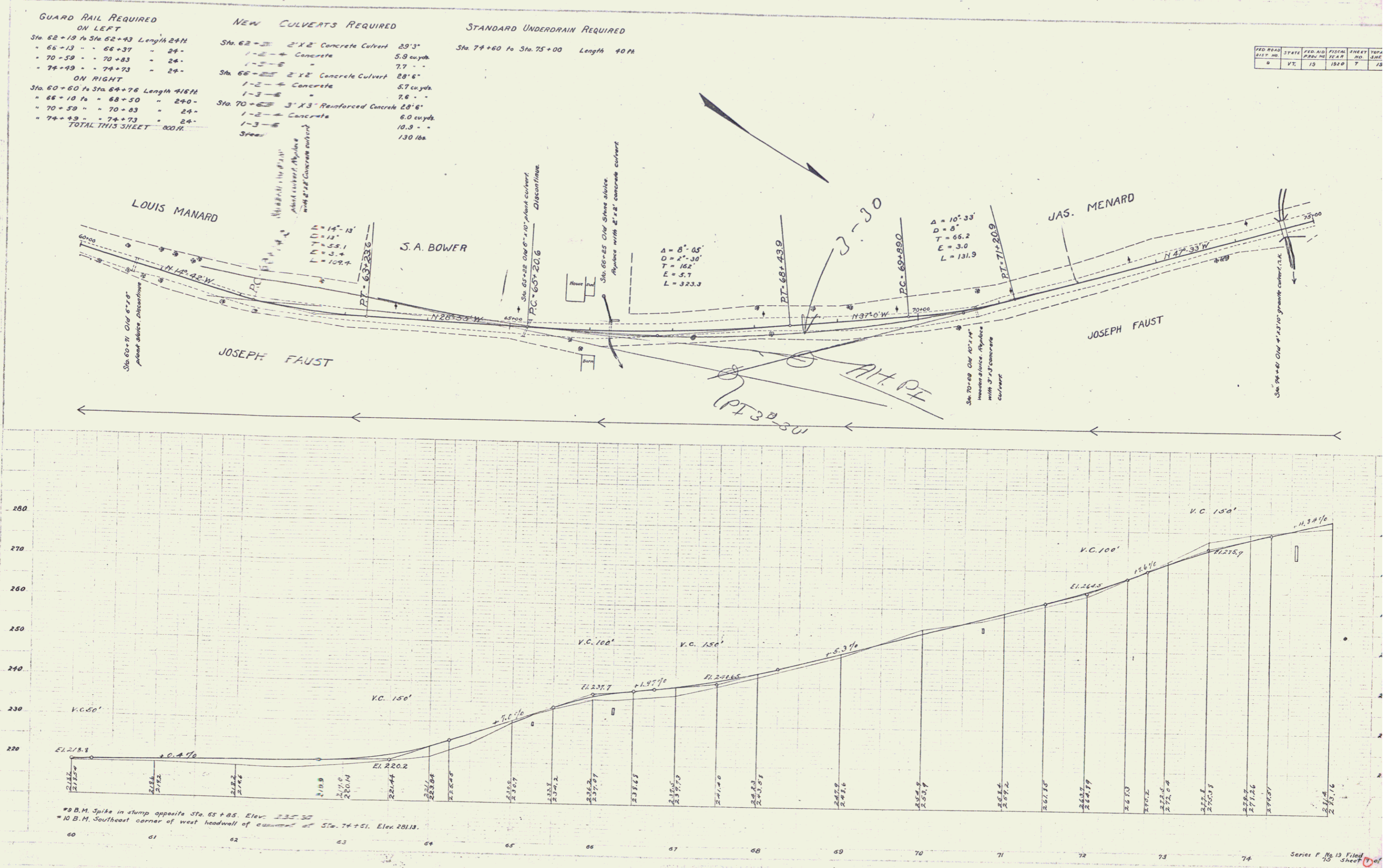

\* B.M. Spike in slump opposite Sta. 65+85. Elev. 235.30  
 \* B.M. Southeast corner of west headwall of culvert at Sta. 74+51. Elev. 281.13.

6