

NEW REIN CONC. PIPE CULVERTS REQUIRED

STATION TO STATION	PIPE SIZE	LENGTH
38+95L - 38+83R	12"	64'

NEW DRAIN PIPES WITH GRATES REQUIRED

STATION	PIPE SIZE	LENGTH	CHUTES
30+01	14"	99.76'	T
31+00	14"	99.76'	T
31+35	14"	99.76'	T
32+65	14"	99.76'	T
34+55	14"	99.76'	T
37+49	14"	99.76'	T
37+70	14"	99.76'	T
38+95	14"	99.76'	T
41+27	14"	99.76'	T
41+50	14"	99.76'	T
43+05	14"	99.76'	T
43+25	14"	99.76'	T
43+60	14"	99.76'	T
44+35	14"	99.76'	T
45+60	14"	99.76'	T

NEW CONCRETE GUTTER REQUIRED

STATION TO STATION	LENGTH	WIDTH	CONC. R	STEEL
39+03 - 45+95	692'	2.5'	37.3	c.y. 513.763

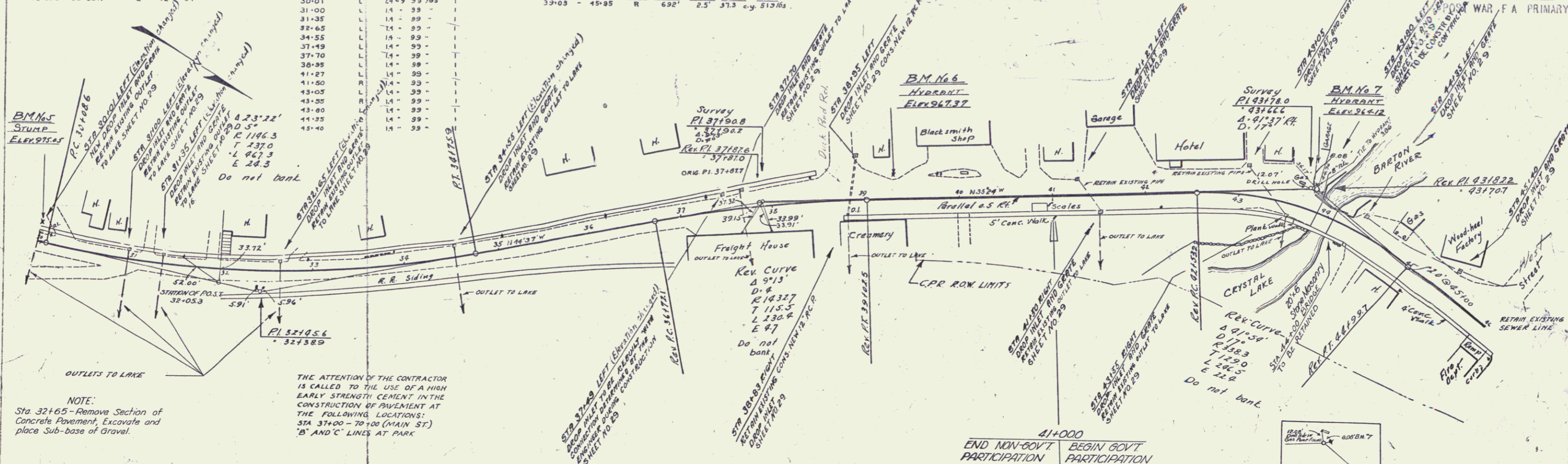

NOTE:
Sta. 32+65 - Remove Section of Concrete Pavement, Excavate and place Sub-base of Gravel.

THE ATTENTION OF THE CONTRACTOR IS CALLED TO THE USE OF A HIGH EARLY STRENGTH CEMENT IN THE CONSTRUCTION OF PAVEMENT AT THE FOLLOWING LOCATIONS:
STA 37+00 - 70+00 (MAIN ST)
'B' AND 'C' LINES AT PARK

CURVE REVISIONS

ORIG. P.I.	37+87.6
P.C.	37+87.1
P.T.	38+72.2
	39+02.6

CURVE REVISIONS

ORIG. P.I.	43+82.6
	43+70.1
P.C.	42+53.1
P.T.	44+99.6
	45+29.5

SCHEDULE OF PAVEMENTS

STATION TO STATION	WIDTH
30+00 - 34+00	34'-00"
34+00 - 39+06	39'-06" VARIABLE
39+06 - 46+00	46'-00" 30'

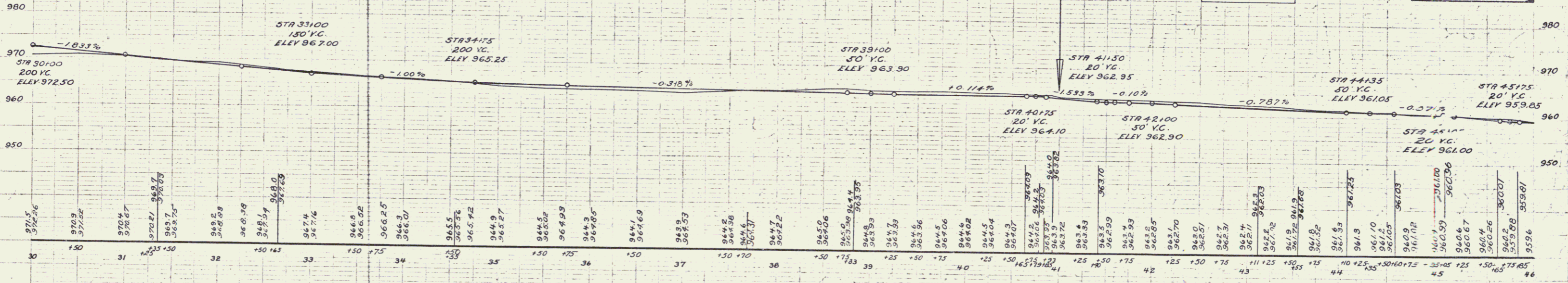

B.M. No. 5 STUMP IN RATIO STUMP 200' LT. STA. 30+00, ELEV. 975.05
B.M. No. 6, HYDRANT NUT, 25.0' LT. STA. 39+31, ELEV. 967.37
B.M. No. 7, HYDRANT NUT, 28.0' LT. STA. 43+78, ELEV. 964.12