

INDEX OF SHEETS

SHEET NO.	TITLE PAGE
1	TYPICAL CROSS-SECTION OF IMPROVEMENT (BITUMINOUS CONCRETE PAVEMENT, ITEM 361A OR B)
2-3	PLAN AND PROFILE
23	STANDARD STRUCTURE SHEET SC 2-4 BOX CULVERTS
24	SW2-3 INLETS & OUTLETS FOR BOX CULVERTS
25	S 28 PIPE CULVERTS
26	S 30 GUARD RAIL
27	S 40 BARRICADES, SIGNS & LIGHTS

STANDARD STRUCTURE SHEETS APPROVED BY THE CHIEF ENGINEER, VERMONT STATE DEPT. OF HIGHWAYS

S 28 APR 26, 1941
S 30 NOV 10, 1947
S 40 DEC 18, 1945

STATE OF VERMONT
STATE HIGHWAY DEPARTMENT

PLAN AND PROFILE OF PROPOSED STATE HIGHWAY

FEDERAL PROJECT
TOWNS OF BARTON - IRASBURG Project: F55(12)
ROUTE U.S. 5 Pin# 99R 298

BARTON - NEWPORT ROAD

BEGINNING AT A POINT APPROXIMATELY 1519 FEET NORTHERLY OF THE SOUTHERLY LINE OF BARTON VILLAGE AND EXTENDING NORTHERLY 30,100.3 FEET

LENGTH OF ROADWAY 2050.0 FEET = 0.388 MILES NON GOV'T. PART.
27,877.3 FEET = 5.280 MILES GOV'T. PART.

LENGTH OF BRIDGES 173.0 FEET = 0.033 MILES

LENGTH OF PROJECT 30,100.3 FEET = 5.701 MILES

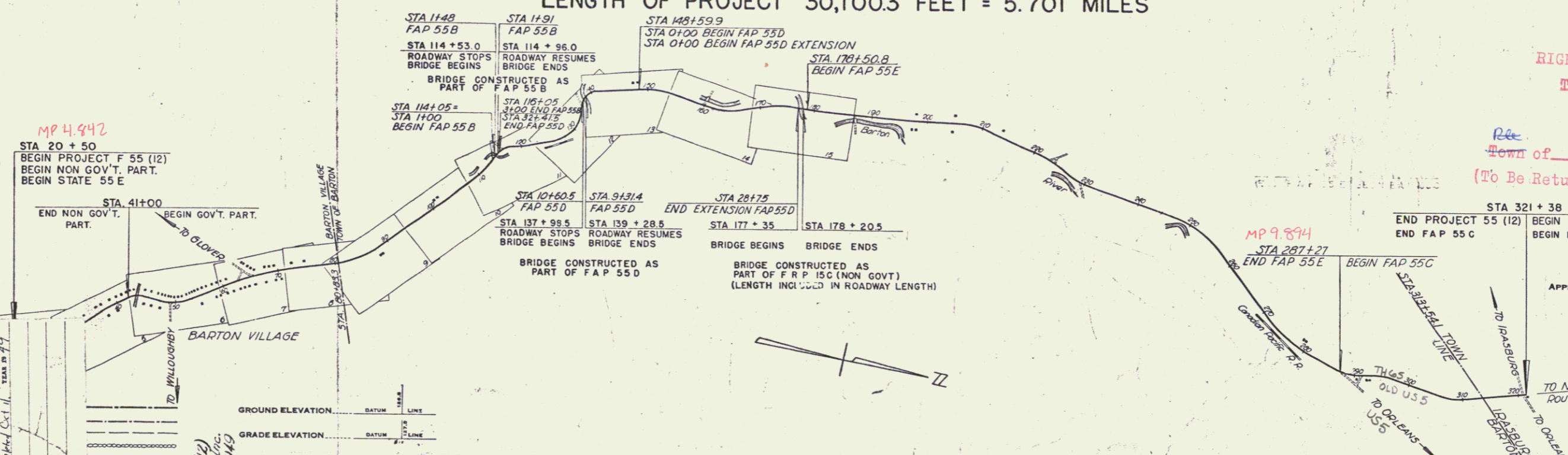
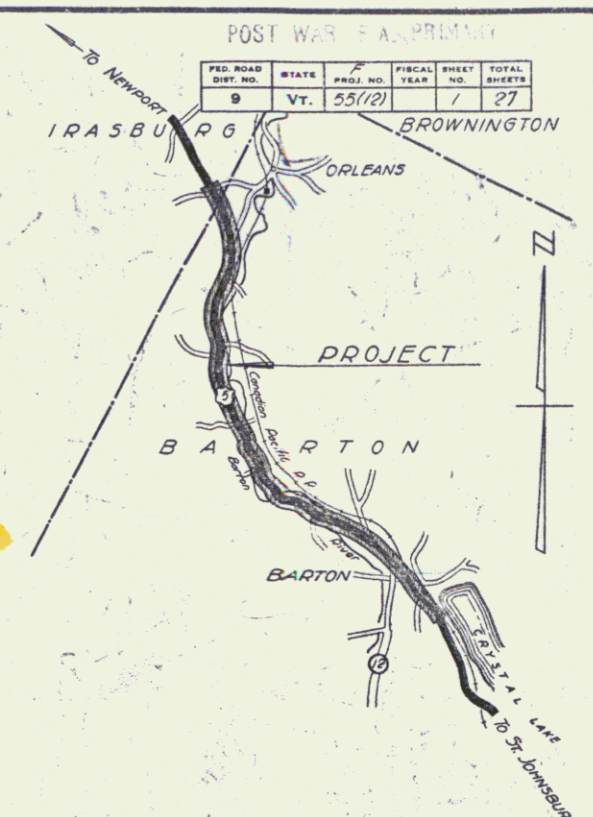

RIGHT-OF-WAY DIVISION
TOWN FILE
PERPETUAL
Town of US 5
(To Be Returned To R.O.W. Division)

PROJECT Barton - Irasburg
NUMBER F 55 (12)
TYPE B. & C. P. Ave.
CONTRACTOR W. H. Hamman, Inc.
COMPLETED Oct. 11, 1949

RECORD PLANS
Barton - Irasburg F-55(12)
Contractor W. H. Hamman, Inc.
Completion Date: Oct. 11, 1949

CURVE DATA	
DEFLECTION ANGLE	Δ
DEGREE OF CURVE	D
RADIUS OF CURVE	R
TANGENT DISTANCE	T
LENGTH OF CURVE	L
EXTERNAL DISTANCE	E
POINT OF INTERSECTION	P. I.
POINT OF CURVE	P. C.
POINT OF TANGENT	P. T.
POINT ON TANGENT	P. O. T.

SCALES

TITLE	1" = 1000'
TYPICAL	1" = 2'
PLAN	1" = 50'
PROFILE HORIZONTAL	1" = 50'
PROFILE VERTICAL	1" = 10'
CROSS SECTIONS	1" = 1"

RECORD PLANS
PREPARED BY: Donald R. Lovejoy
RESIDENT ENGINEER: Lee B. Bates

THESE PLANS ARE SUBJECT TO SUCH REVISIONS AS MAY BE REQUIRED BY THE PUBLIC ROADS ADMINISTRATION OR THE COMMISSIONER OF HIGHWAYS.

CONSTRUCTION IS TO BE CARRIED ON IN ACCORDANCE WITH THE PLANS AND THE STANDARD ROAD AND BRIDGE SPECIFICATIONS OF 1936, AS APPROVED DECEMBER 29, 1936 BY THE PUBLIC ROADS ADMINISTRATION, INCLUDING ALL SUBSEQUENT APPROVED REVISIONS AND SUCH REVISED SPECIFICATIONS AND SPECIAL PROVISIONS AS ARE SUBMITTED WITH THE PLANS.

APPROVED: June 1, 1948
T. C. Laughton
COMMISSIONER OF HIGHWAYS

SUBMITTED BY ORDER OF THE STATE HIGHWAY BOARD

APPROVED: June 1, 1948
A. J. Bennett
HIGHWAY ENGINEER

APPROVED: June 21, 1948
District Highway Commissioner

SERIES F No. 55(12) FILED
SHEET 1 OF 27