

**WOOD GUARD RAIL REQUIRED**

CULV. STA.	LT.	RT.
278+15	24'	-
279+09	24'	24'
282+17	24'	24'
283+82	24'	24'
286+79	24'	24'

**CABLE GUARD RAIL REQUIRED**

STATIONS	LENG.	CONSTANT	PIV. LENG.
278+00-278+36 R.	36'	40'	76'

**NEW 8" EITH CONC. PIPE CULVERTS REQUIRED**

Station	Size	Length	Conc. A	Conc. C	Steel
279+09	15"	36 R.	15 cy	15 cy	17#
283+82	10"	48 -	-	30 -	33#
286+79	36"	32 -	40 cy	-	38#
282+17	15"	49 -	-	23 cy	33#

CAD. STATE. I. I. M. I. SHEET 101  
 55-E 1931 26 75

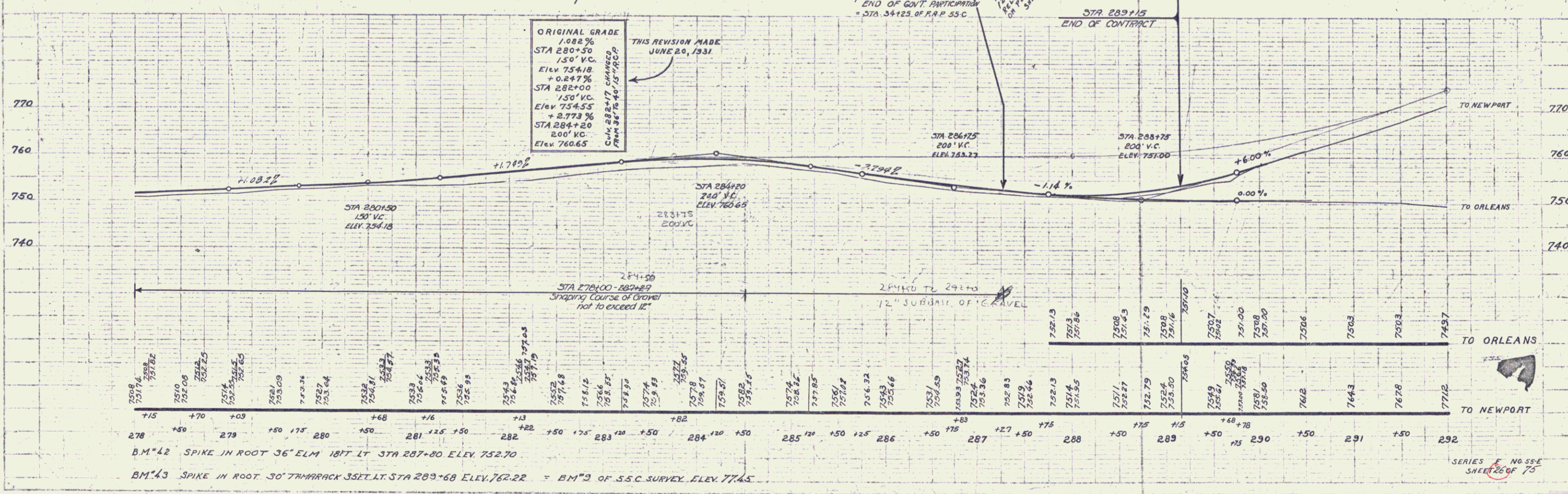
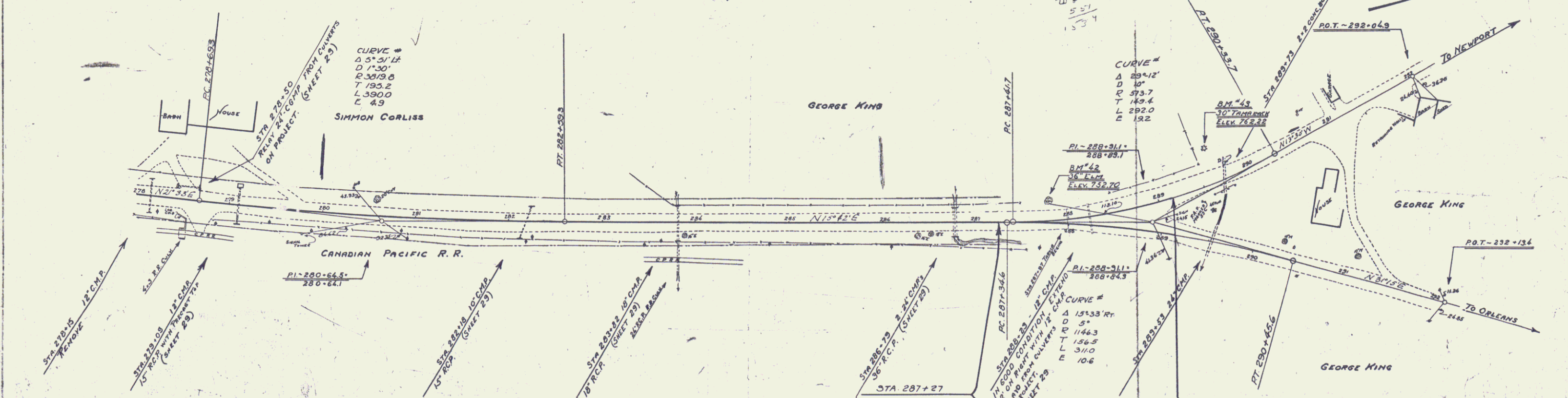

B.M. 42 SPIKE IN ROOT 36" ELM 187' LT STA 287+00 ELEV 752.70  
 B.M. 43 SPIKE IN ROOT 30" ZIMARRACK 351' LT STA 289+68 ELEV 762.22 = B.M. 3 OF S.S.C. SURVEY ELEV 774.5

SERIES E NO 55-E  
 SHEET 26 OF 75