

WOOD GUARD RAIL REQUIRED

CULV. STA.	LT.	RT.
220+21	24'	24'
224+24	24'	-
227+29	24'	-

CABLE GUARD RAIL REQUIRED

Station	Leg.	Offset	Paylength
225+40 - 228+76	RT	336'	40' 376'

NEW BRIM CONIC PIPE CULVERTS REQUIRED

Station	Size	Length	Conc. A	Conc. C	Steel
220+20	18"	40'	15 cy	15 cy	174#
227+09	15"	40'	15 cy	15 cy	174#

CULVERT REPAIRS REQUIRED

Station	Size	Dry Rubble
220+21	3x3	13 cy

STD UNDERDRAIN WITH 6" BENT COVERING GALV. METAL PIPE REQUIRED

STA. TO STA.	L. & R.	LENGTH
227+09R - 228+20L		80
228+20 - 229+50		130
229+45		80
229+60L - 230+90L		130
		400

FED. ROAD STATE FISCAL YEAR SHEET NO.

9	55-E	1931	22	75
---	------	------	----	----

Parcel Kind of Instrument Date of Greater Grantee Record Remarks

B	QCD	8-25-21	N.E.L. Merrill	St. of Yt.	40	111	8-31-21
---	-----	---------	----------------	------------	----	-----	---------

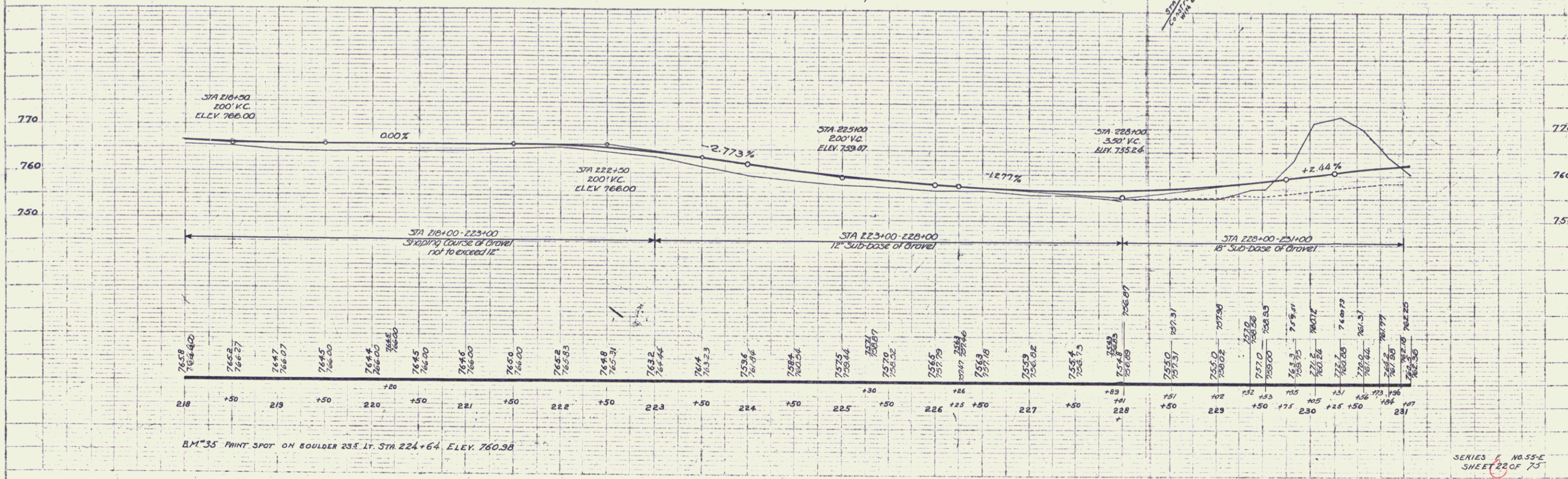
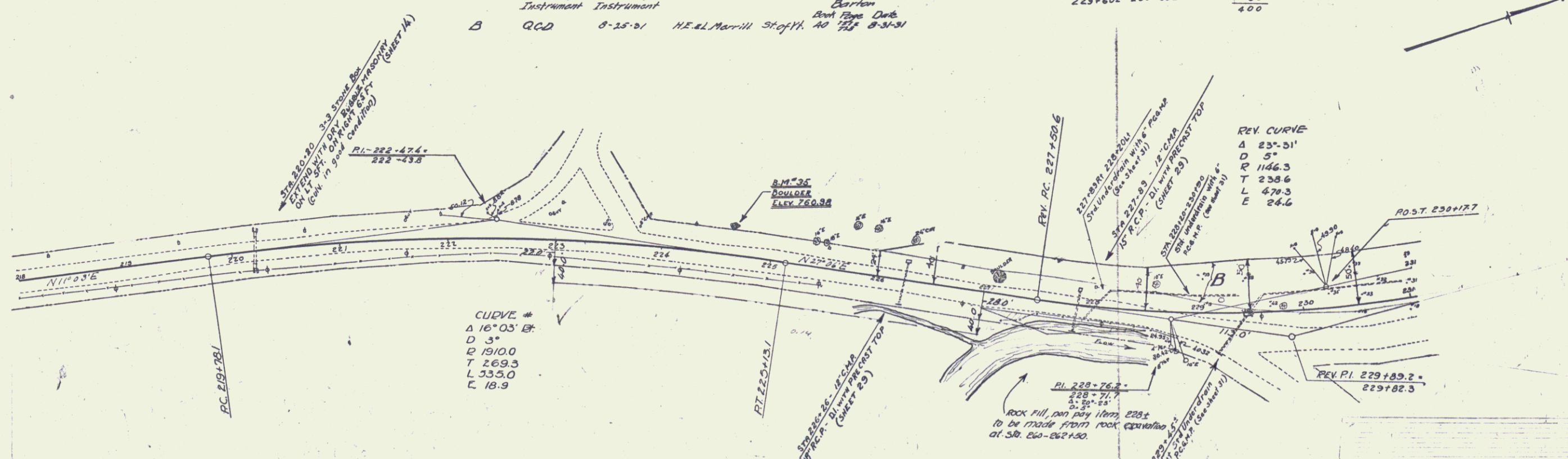

B.M. 35 PRINT SPOT ON BOULDER 235 FT. STA 224+64 ELEV. 760.38

SERIES E NO. 55-E SHEET 22 OF 75