

| PARCEL     | INSTRUMENT | DATE    | GRANTOR                   | GRANTEE        | RECORDED          | REMARKS                |
|------------|------------|---------|---------------------------|----------------|-------------------|------------------------|
| 29 A-B-C-D | WDOE       | 3-29-54 | LLOYD W & CLARA B. KERR   | STOYVT. BARTON | 48 316-377 4-1-54 | SEE ALSO SHEET 30 & 31 |
| 30         | WDOE       | 4-6-54  | FRED & MILDRED WHITEHOUSE | "              | 48 390 4-7-54     | SEE ALSO SHEET 31      |

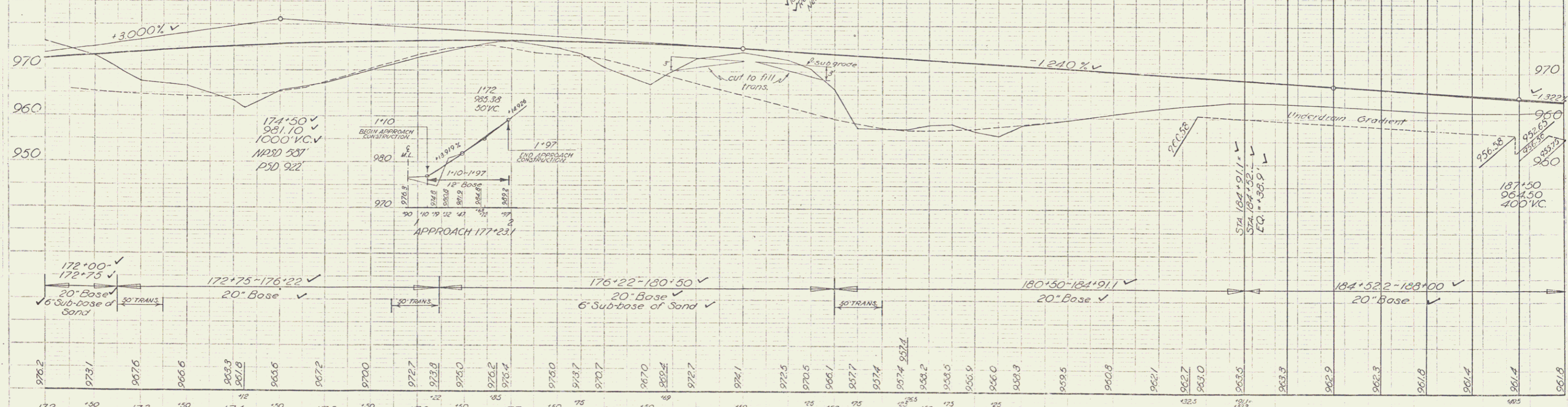

| STATION | ELEVATION | STATION | ELEVATION | STATION | ELEVATION |
|---------|-----------|---------|-----------|---------|-----------|
| 172+00  | 976.2     | 176+00  | 972.7     | 180+00  | 968.3     |
| 172+25  | 973.1     | 176+25  | 972.8     | 180+25  | 968.0     |
| 172+50  | 970.6     | 176+50  | 972.5     | 180+50  | 965.9     |
| 173+00  | 966.6     | 177+00  | 972.2     | 181+00  | 965.0     |
| 173+25  | 963.3     | 177+25  | 971.9     | 181+25  | 964.2     |
| 173+50  | 960.6     | 177+50  | 971.6     | 181+50  | 963.0     |
| 174+00  | 958.3     | 178+00  | 971.3     | 182+00  | 962.7     |
| 174+25  | 957.6     | 178+25  | 971.0     | 182+25  | 962.3     |
| 174+50  | 956.6     | 178+50  | 970.7     | 182+50  | 962.1     |
| 175+00  | 956.2     | 179+00  | 970.4     | 183+00  | 962.0     |
| 175+25  | 956.2     | 179+25  | 970.1     | 183+25  | 961.9     |
| 175+50  | 956.2     | 179+50  | 969.8     | 183+50  | 961.8     |
| 176+00  | 956.2     | 180+00  | 969.5     | 184+00  | 961.8     |
| 176+25  | 956.2     | 180+25  | 969.5     | 184+25  | 961.8     |
| 176+50  | 956.2     | 180+50  | 969.5     | 184+50  | 961.8     |
| 177+00  | 956.2     | 181+00  | 969.5     | 185+00  | 961.8     |
| 177+25  | 956.2     | 181+25  | 969.5     | 185+25  | 961.8     |
| 177+50  | 956.2     | 181+50  | 969.5     | 185+50  | 961.8     |
| 178+00  | 956.2     | 182+00  | 969.5     | 186+00  | 961.8     |
| 178+25  | 956.2     | 182+25  | 969.5     | 186+25  | 961.8     |
| 178+50  | 956.2     | 182+50  | 969.5     | 186+50  | 961.8     |
| 179+00  | 956.2     | 183+00  | 969.5     | 187+00  | 961.8     |
| 179+25  | 956.2     | 183+25  | 969.5     | 187+25  | 961.8     |
| 179+50  | 956.2     | 183+50  | 969.5     | 187+50  | 961.8     |
| 180+00  | 956.2     | 184+00  | 969.5     | 188+00  | 961.8     |

BM #22 S.I.R. of 12' Elm 20' W of 172+00 Sta 172+00 Elev 976.14  
 BM #23 S.I.R. of 12' Elm 20' W of 176+00 Sta 176+00 Elev 972.30  
 BM #23A Spot on Head wall 36' W Sta 180+50 Elev 969.30  
 BM #24A Spot on Head wall 33' W Sta 187+00 Elev 960.17

BARTON  
 Proj. FI-1 33(2)  
 Sheet 30 of 176