

THE 0.02 ACRE IS ALL AND THE SAME LAND AND PREMISES ACQUIRED BY THE STATE OF VERMONT FROM ALBIA G. WIGHTMAN BY WARRANTY DEED OF EASEMENT DATED JULY 2, 1954 AND RECORDED IN BOOK 48 PAGE 424 OF THE LAND RECORDS OF THE TOWN OF BARTON.

STATE OF VERMONT
TO
WILLIAM & LUCILLE CHALOUX
BY QCD REC'D 2/26/91 REC'D IN
BK 83/149-51

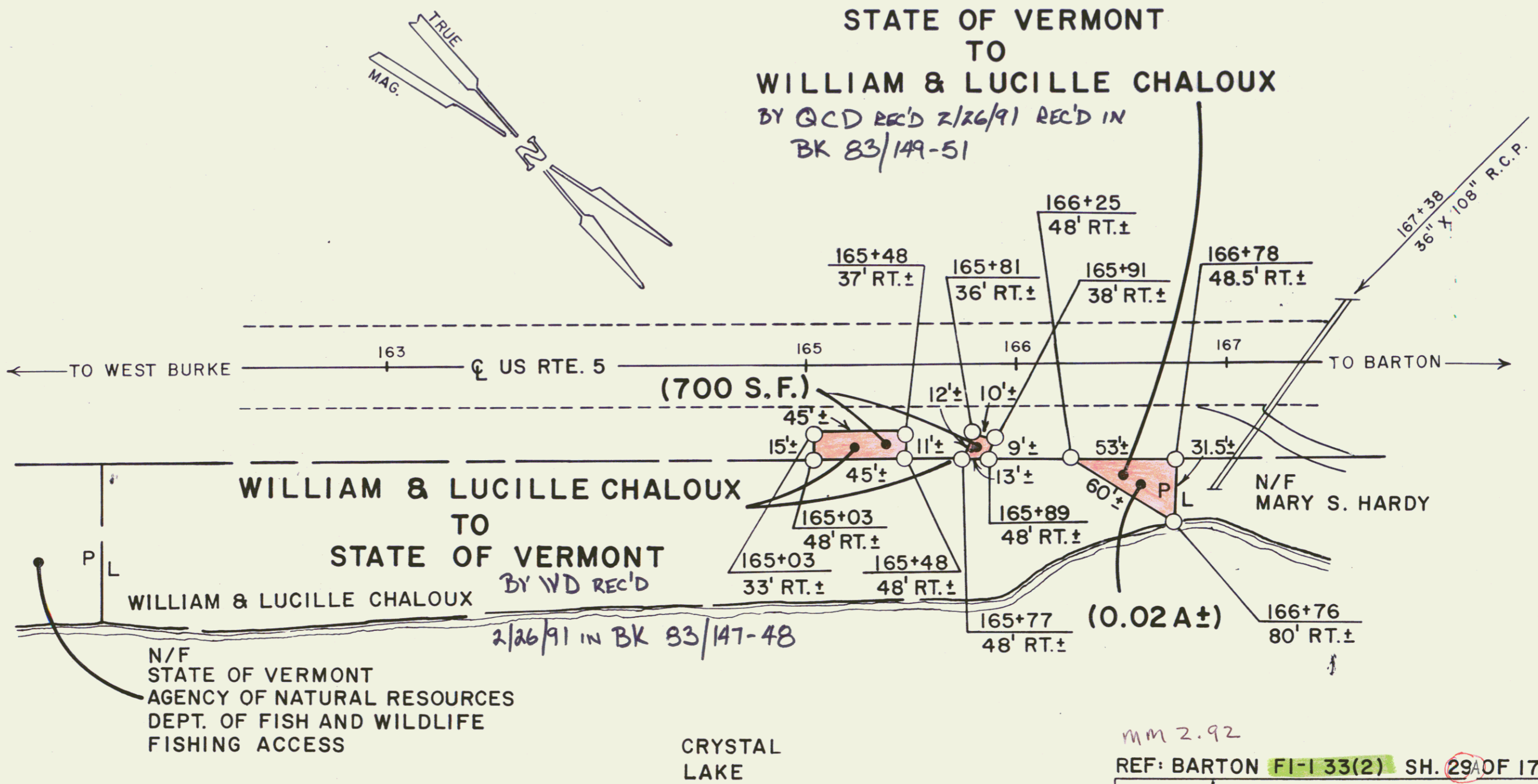

WILLIAM & LUCILLE CHALOUX
TO
STATE OF VERMONT
BY WD REC'D
WILLIAM & LUCILLE CHALOUX
2/26/91 IN BK 83/147-48

N/F
STATE OF VERMONT
AGENCY OF NATURAL RESOURCES
DEPT. OF FISH AND WILDLIFE
FISHING ACCESS

CRYSTAL LAKE

MM 2.92
REF: BARTON FI-1 33(2) SH. 29A OF 176

STATE OF VERMONT
AGENCY OF TRANSPORTATION

TOWN OF BARTON



APPROX. SCALE 1"=50' DATE: 1-18-91 DRAWN BY C.C.P.

17