

Wood Guard Rail Required  
 11 LEFT 34 23  
 Sta 116+00 to 116+34 Length 34 FT.  
 TOTAL THIS SHEET 23 24 FT.

Cable Guard Rail Required  
 50 BENT 209  
 Sta 114+40 to 116+50 Length 210 FT.  
 121+08 LEFT 385  
 Sta 120+50 to 120+88 Length 38 FT.  
 Sta 126+13 To 127+98 Length 185 FT.  
 TOTAL THIS SHEET 250 FT. 173 FT.

NEW CULVERTS REQUIRED  
 Sta 116+33 18" REIN. CON. OR CAST IRON PIPE LENGTH 36 FT.  
 CLASS A (1-2-4) CONCRETE 1.9 cu. yd.  
 REINFORCING STEEL 60 LB.

CULVERT REPAIRS  
 Sta 121+50 REPAIR PRESENT TILE CULVERT  
 CONSTRUCT HEADWALL AT INLET  
 CLASS A (1-2-4) CONCRETE 70 cu. yd.  
 REINFORCING STEEL 33

FED. ROAD DIST. NO.	STATE	FED. AID PROJ. NO.	FISCAL YEAR	SHEET NO.	TOTAL SHEETS
1	W.V.	1	1957	11	103

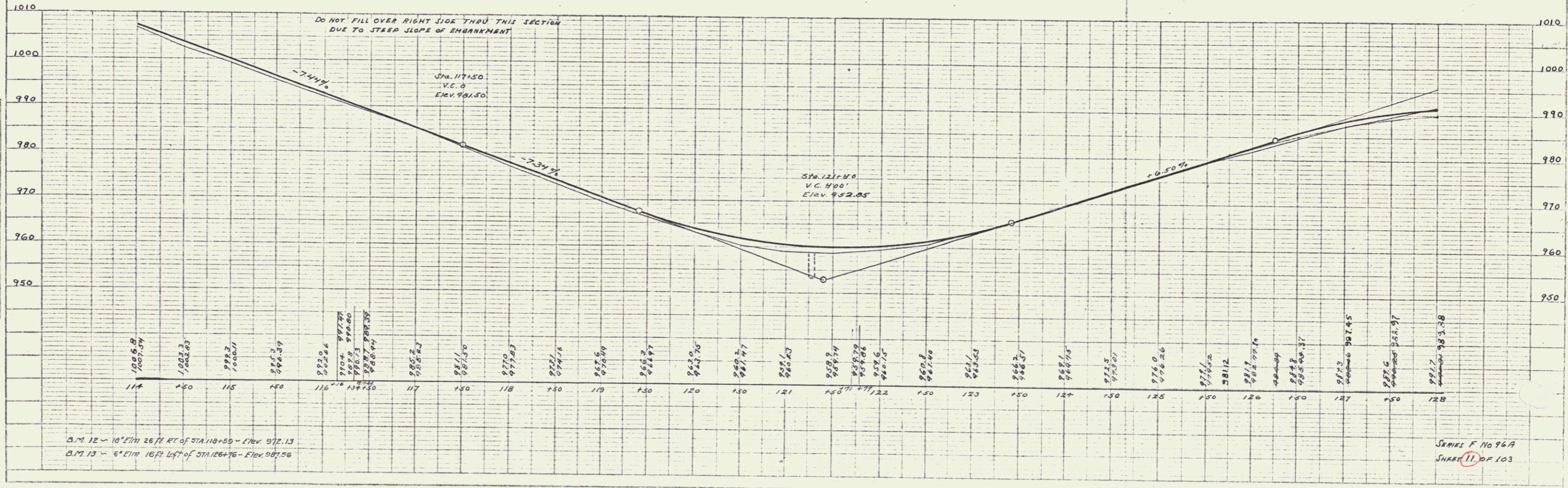
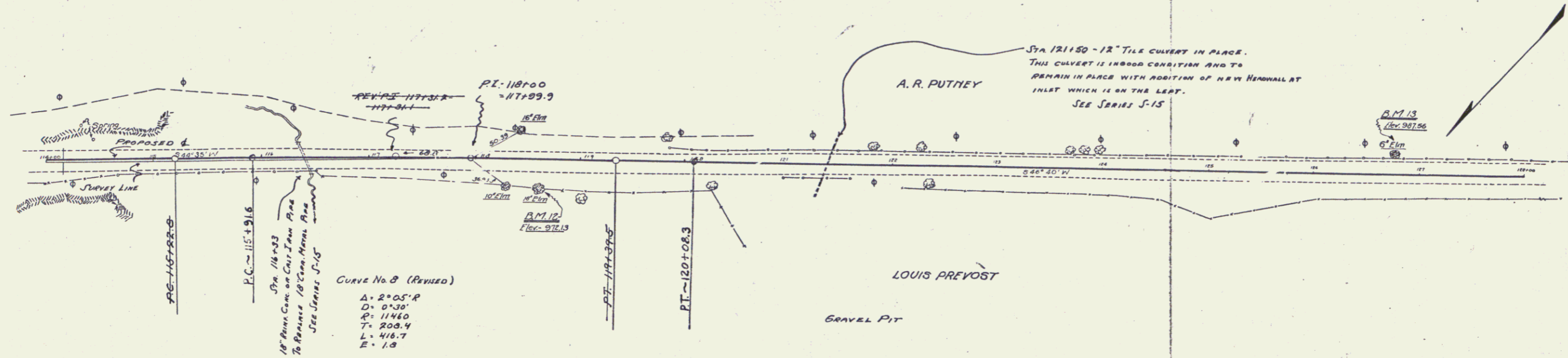

PLAN  
 DATE: 11/1/57  
 DRAWN BY: J. L. GIBSON  
 CHECKED BY: J. L. GIBSON

PROFILE  
 DATE: 11/1/57  
 DRAWN BY: J. L. GIBSON  
 CHECKED BY: J. L. GIBSON

SERIES F NO 76A  
 SHEET 11 OF 103