

INDEX OF SHEETS

SHEET NO.	TITLE PAGE	STA.
2	TYPICAL CROSS-SECTION OF IMPROVEMENT	
3	PLAN AND PROFILE	0+00 TO 11+00
4		11+00 TO 25+00
5		25+00 TO 39+00
6		39+00 TO 54+00
7		54+00 TO 69+00
8		69+00 TO 84+00
9		84+00 TO 99+00
10		99+00 TO 114+00
11		114+00 TO 129+00
12		129+00 TO 143+00
13		143+00 TO 157+00
14		157+00 TO 173+00
15		173+00 TO 187+00
16		187+00 TO 198+00
17		198+00 TO 210+00
18		210+00 TO 224+00
19		224+00 TO 238+00
20		238+00 TO 252+00
21		252+00 TO 266+00
22		266+00 TO 280+00
23		280+00 TO 294+00
24		294+00 TO 308+00
25		308+00 TO 318+67.1
26	CULVERT	STA. 62+52
27		226+23
28-45	CROSS SECTIONS	STA. 0+00 TO 48+00
46-104		48+50 TO 318+00

(To Be Returned To R.O.W. Division)

PERPETUAL  
TOWN OF U.S. 5  
RIGHT-OF-WAY DIVISION

FED. AID DIST. NO.	STATE	FED. AID PROJ. NO.	FED. AID DIV. NO.	SHEET NO.	TOTAL SHEETS
3	Vt.	96A	1027	1	103

STATE OF VERMONT  
STATE HIGHWAY DEPARTMENT

PLAN AND PROFILE OF PROPOSED  
STATE HIGHWAY  
FEDERAL AID PROJECT

TOWN OF DERBY  
DERBY LINE - NEWPORT CITY ROAD  
FROM 200' SOUTH CANADA - UNITED STATES BOUNDARY  
SOUTHERLY TO DERBY - NEWPORT CITY LINE

Route: U.S. 5  
U.S. F. 96A  
Pin # 992292

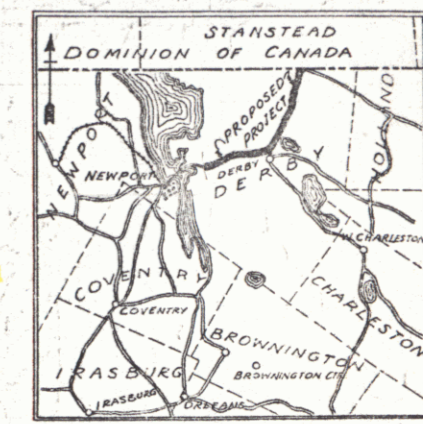

SCALE 1 INCH = 4 MILES

RECORD PLANS

NOTE: ANY FURTHER INFORMATION CONCERNING FINAL QUANTITIES, ASSUMES OR OTHER DETAILS RELATIVE TO THIS PROJECT MAY BE FOUND IN EITHER THE FIELD BOOKS OR THE ESTIMATE FILE.

MP 0.60  
END OF PROJECT  
STA. 313+77.3

MP 5.899  
BEGINNING OF PROJECT  
STA. -2+00

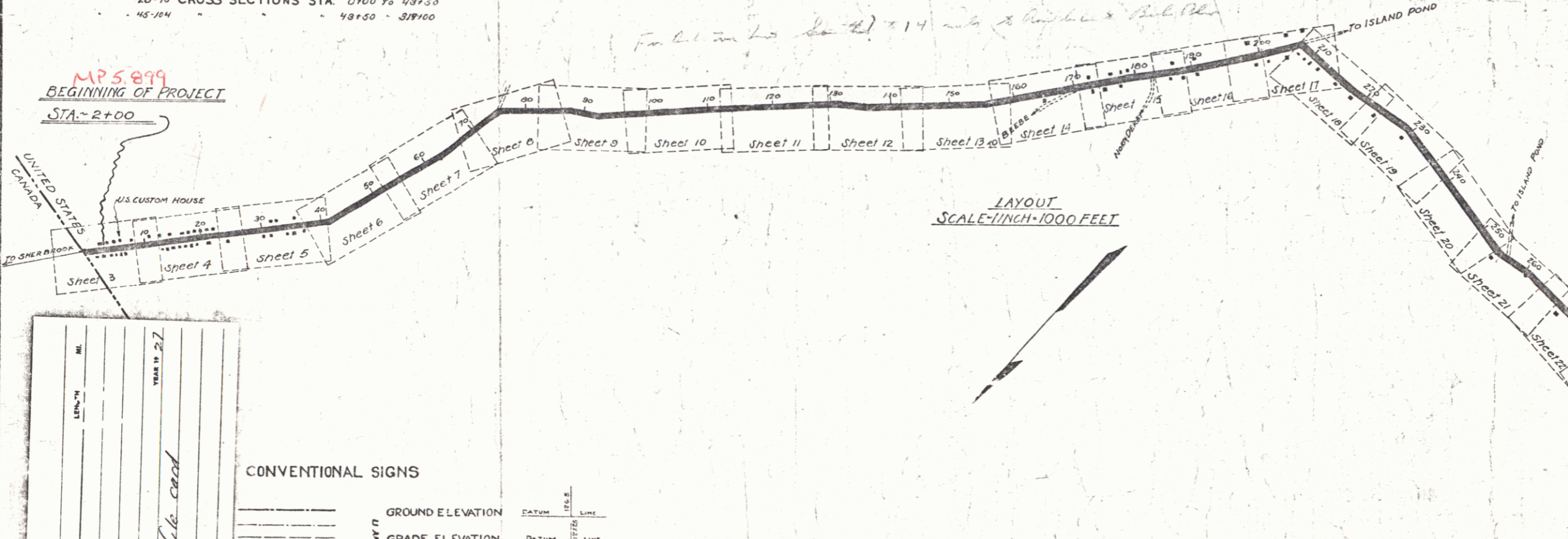

LAYOUT  
SCALE 1/4 INCH = 100 FEET



THESE PLANS SUBJECT TO SUCH REVISIONS AS MAY BE REQUIRED BY THE BUREAU OF PUBLIC ROADS OR THE CHIEF ENGINEER

PROJECT	NUMBER	TYPE	CONTRACTOR	LOCATION	YEAR
Derby	96A	State	Joseph McCormick	See file card	1927

CONVENTIONAL SIGNS

GROUND ELEVATION	DATUM	LINE
GRADE ELEVATION	DATUM	LINE

CURVE DATA	DEFLECTION ANGLE	DEGREE OF CURVE	RADIUS OF CURVE	TANGENT DISTANCE	LENGTH OF CURVE	EXTERNAL DISTANCE	POINT OF INTERSECTION	POINT OF CURVE	POINT OF TANGENT
Δ	D	R	T	L	E	P.I.	P.C.	P.T.	

RIGHT-OF-WAY DIVISION  
TOWN FILE

PERPETUAL  
Town of U.S. 5  
(To Be Returned To R.O.W. Division)

APPROVED: 4-11-27  
H.C. Sargent, CHIEF ENGINEER  
SUBMITTED BY: 4-11-27  
S. B. Bates, COUNTY ENGINEER  
RECOMMENDED: [Signature]  
DISTRICT ENGINEER, BUREAU OF PUBLIC ROADS  
RECOMMENDED FOR APPROVAL: [Signature]  
CHIEF ENGINEER, BUREAU OF PUBLIC ROADS  
APPROVED: [Signature]  
DIRECTOR - BUREAU OF PUBLIC ROADS

SERIES F No. 96A FILED  
SHEET 1 OF 103