

Non Govt PARTICIPATION  
 CEILING (CONCRETE CLAY WALL & GUTTER REQUIRED)

| STATIONS      | L x R | LENS WIDTH | CONC. A | STEEL              |
|---------------|-------|------------|---------|--------------------|
| 281+00-282+25 | Lt    | 100'       | 2'-0"   | 25.8 c.y. 3305 lbs |
| 285+00-288+25 | Lt    | 325'       | 2'-0"   | 74.3 c.y. 9584 lbs |

|                |       |           |      |       |
|----------------|-------|-----------|------|-------|
| FED. DIST. NO. | STATE | PROJ. NO. | YEAR | SHEET |
| 9              | IA    | 130A      | 1934 | 24    |

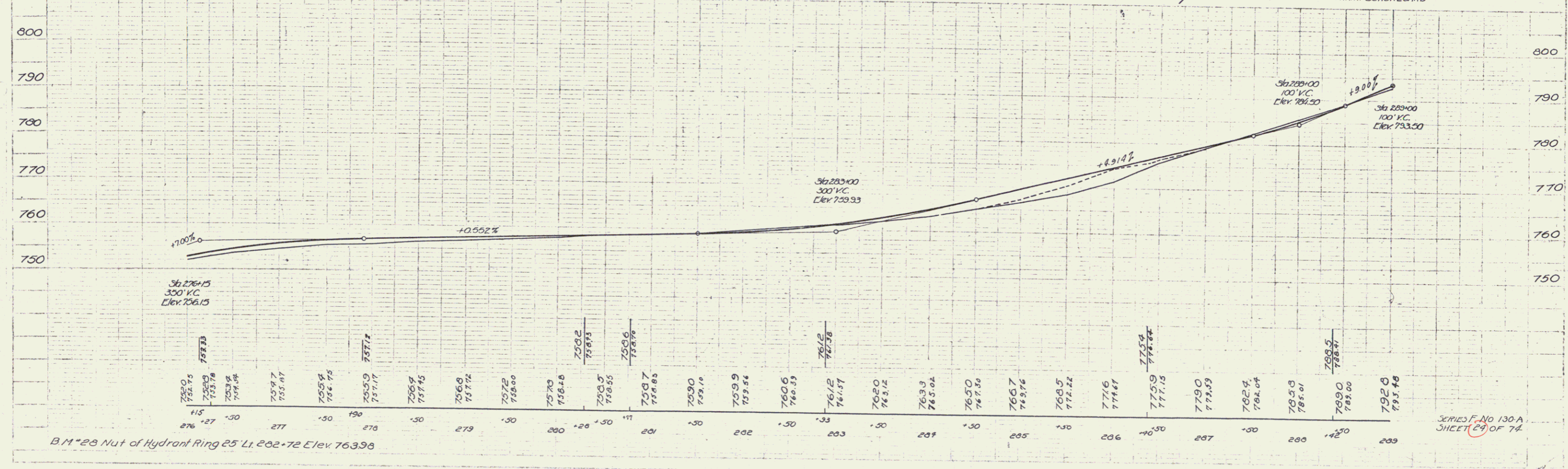
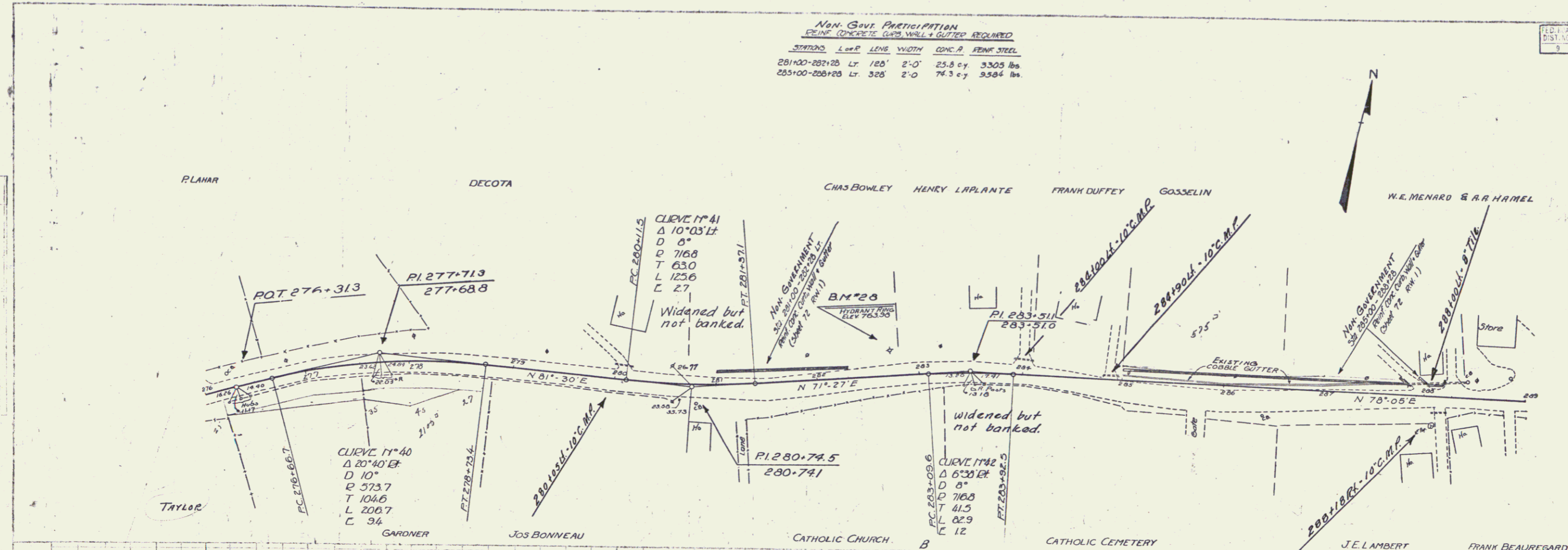

B.M. 28 Nut of Hydrant Ring 25' Lt. 282+72 Elev 763.96

SERIES F-NO 130A  
 SHEET 24 OF 74