

WOOD GUARD RAIL REQUIRED

CULVERT STATION	LEFT	RIGHT
210+20	24'	24'
214+50	24'	24'
217+65	24'	24'
220+00	24'	24'
215+50	24'	24'

NEW CAST IRON PIPE CULVERTS REQUIRED

STATION	DIAM	LEN	CONC. R	CONC. C	REIN. STEEL
210+20	18"	30'	-	14	17 lbs.
213+45	18"	30'	14	14	17 lbs.
217+65	18"	30'	14	14	17 lbs.
220+00	18"	30'	14	14	17 lbs.
215+50	18"	30'	14	14	17 lbs.

DESIGNED BY: STATE PROJ. NO. 1730-A
 DIST. NO. 1730-A
 YEAR: 1937
 SHEET: 19 OF 24

Person	Kind of Instrument	Date of Instrument	Grantor	Gantee	Recorded County	Remarks
C. Culver	Q.C.D.	6-30-31	L.S. Merrill	St. of M.	17 356	7-25-31 (Culvert Sta. 210+20 to 215+50)
A	"	6-30-31	J.W. Powers	"	17 300	7-25-31 (Culvert Sta. 210+20 to 215+50)

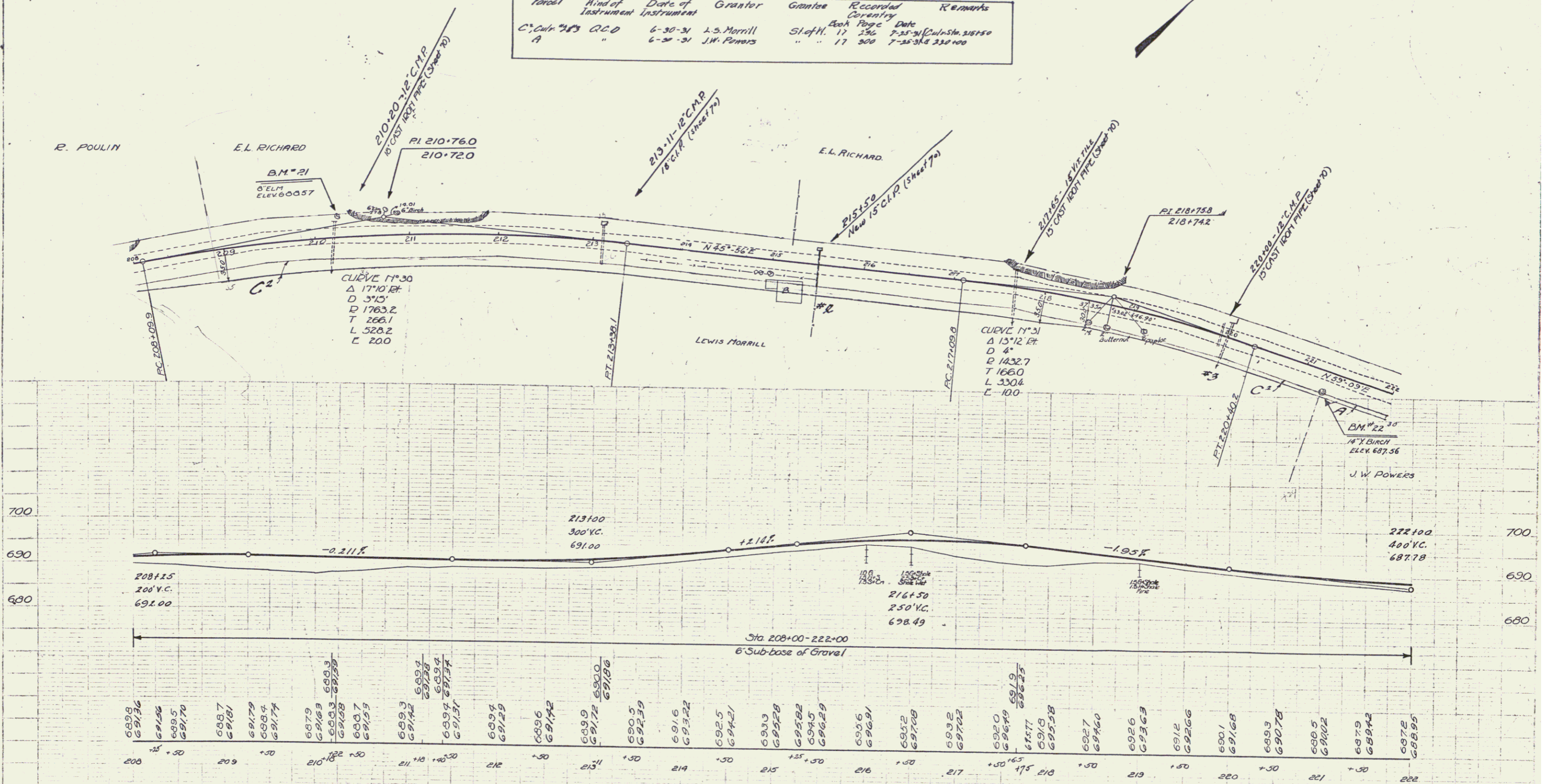

B.M. #21 Spike in rod 8' Elm 21 ft 210+26 Elev 688.57
 B.M. #22 Spike in root 14" Birch 20' ft 221+24 Elev 687.56

SERIES F NO 130-A
 SHEET 19 OF 24