

WOOD GUARD RAIL REQUIRED

CLVERT STATION	LEFT	RIGHT
199+50	24'	24'
202+00	24'	24'
204+00	24'	24'

Parcel	Kind of Instrument	Date of Instrument	Grantor	Grantee	Recorded Conveying Book Page Date	Remarks
B30*	G.C.D.	6-30-31	LS Morrill	Steph. H. 17	234 7-25-31	

NEW CAST IRON PIPE CULVERTS REQUIRED

STATION	DRAIN	LEVEL	CONC. CHUCK	REIN. SIZE
199+50	15"	4 1/2'	-	13 cy. 17 lbs.
202+00	15"	4 1/2'	-	-
204+00	15"	4 1/2'	-	13 cy. 17 lbs.

PLG. 1041 STATE. FEB. 00
 130-A 1937 16 74

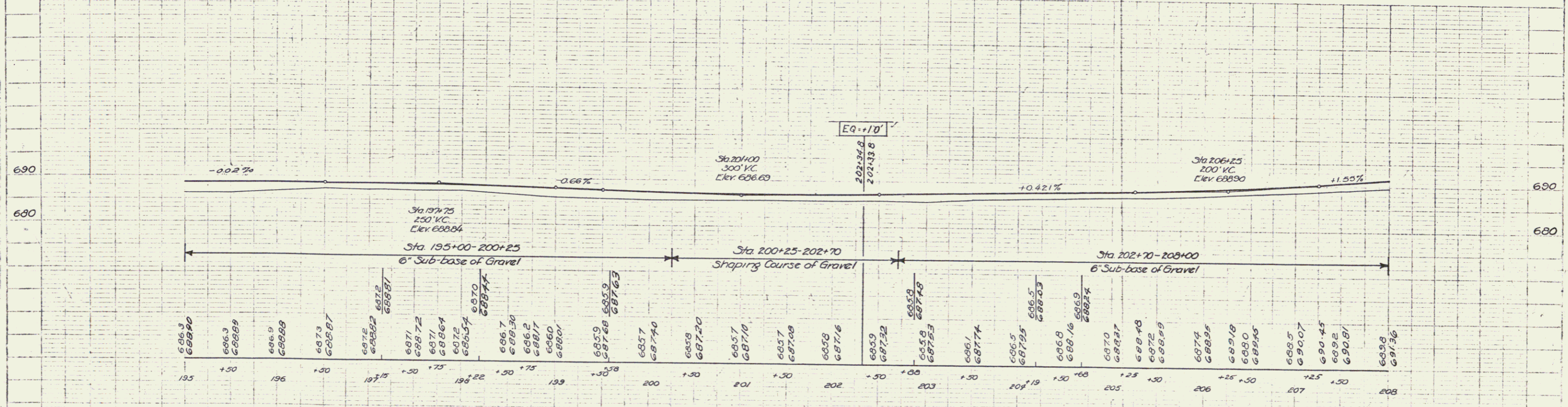
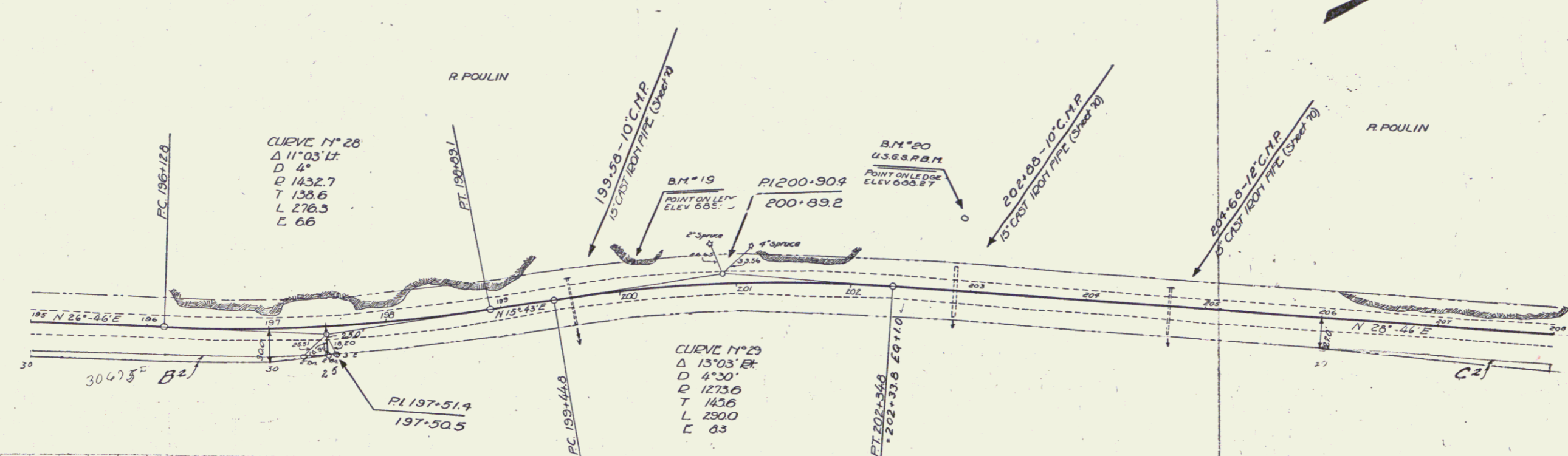

B.M. 19 Point on ledge 22 Lt. 200+15 Elev. 689.40
 B.M. 20 U.S.G.S. P.M. (549-1922) 62 Lt. 202+32 Elev. 688.27

SERIES F No. 130-A
 SHEET 13 OF 74