

WOOD GUARD RAIL REQUIRED		
CULVERT STATION	LEFT	RIGHT
93+62	24'	24'
101+85	24'	24'
103+00	24'	24'
99+85	24'	24'

Parcel Kind of Date of Grantor Grantee Recorded Remarks
 Instrument Instrument
 B.G. Chas. 9, 7, 7, A.C.D. 6-13-31 C.A. H. Nadeau Sloof H. 17 387 7-25-31

NEWLY CAST IRON PIPE CULVERTS REQUIRED					
STATION	CHYR	LENG	CONC. P.	CONC. C.	PIPE STEEL
95+62	15'	42"	-	12.41	17 lbs.
99+85	15'	36"	-	12.41	17 lbs.
101+85	15'	36"	-	12.41	17 lbs.
103+00	15'	42"	1.87	12.41	33 lbs.
104+30	15'	36"	-	12.41	17 lbs.

ED. ROAD STATE PROJ. NO. SHEET NO. DIST. NO. 9 VI. 7304 1931 71 74

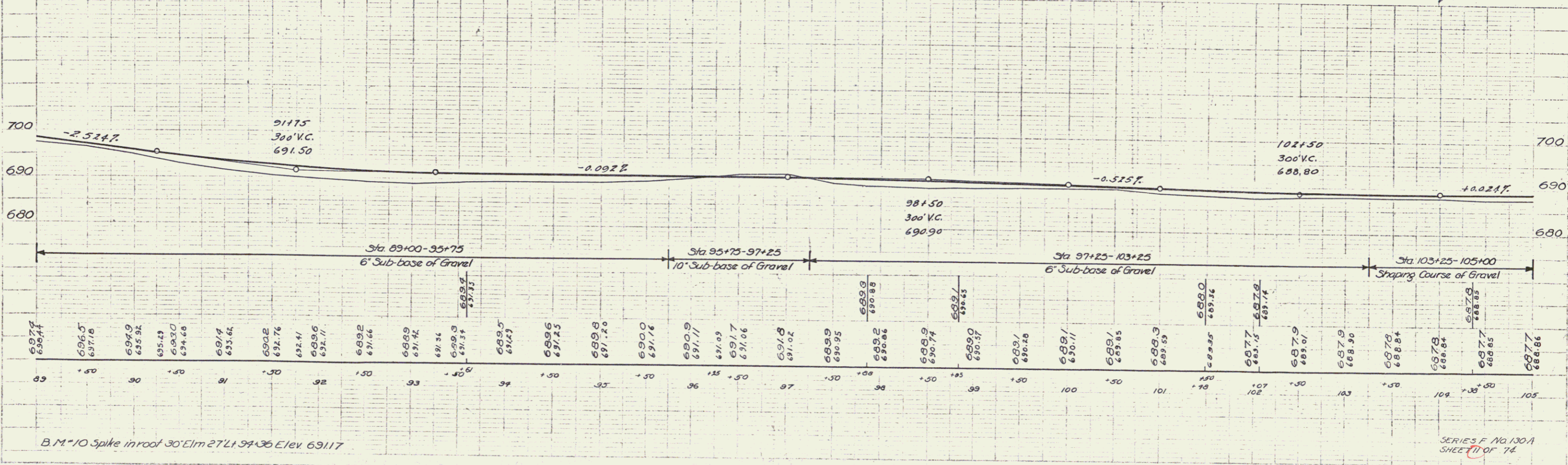
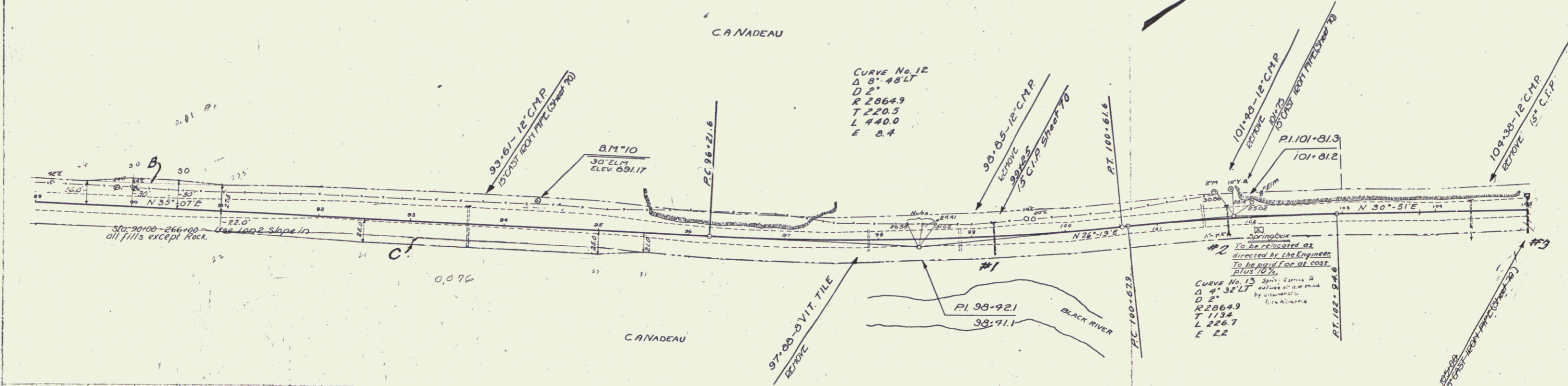

1:4 SCALE

1:4 SCALE

SERIES F. NO. 130-A SHEET 10 OF 74