

**INDEX OF SHEETS**

SHEET NO. 1	TITLE PAGE
" 2	TYPICAL CROSS-SECTION OF IMPROVEMENT (STAGE CONSTRUCTION)
" 3	GRAVEL SURFACE COURSE
" 4	DETAILS OF CONSTRUCTION (BANKING TABLES)
" 5-20	24 PLAN AND PROFILE SHEETS
" 21-22	26-66 CROSS-SECTIONS
" 23-25	70 STANDARD STRUCTURE SHEETS
" 26	" " " 3-20
" 27	" " " 3-22
" 28	" " " 3-23

FED. ROAD DIST. NO.	STATE	FED. AID PROJ. NO.	FISCAL YEAR	SHEET NO.	TOTAL SHEETS
9	VT.	130A	1931	1	74

**STATE OF VERMONT  
STATE HIGHWAY DEPARTMENT**

**PLAN AND PROFILE OF PROPOSED  
STATE HIGHWAY**  
FEDERAL AID PROJECT

**TOWN OF COVENTRY - CITY OF NEWPORT  
BARTON - NEWPORT ROAD**

FROM THE END OF F.A.P. 9, NORTH 2787.23 FT. TO A POINT  
ABOUT 600 FT. BEYOND THE SO CALLED LOWER ROAD TO NEWPORT CITY

LENGTH OF PROJECT 27,872.3 FT. = 5.278 MILES

Route: US5  
Project: FAP 130A  
Pin # 99R283

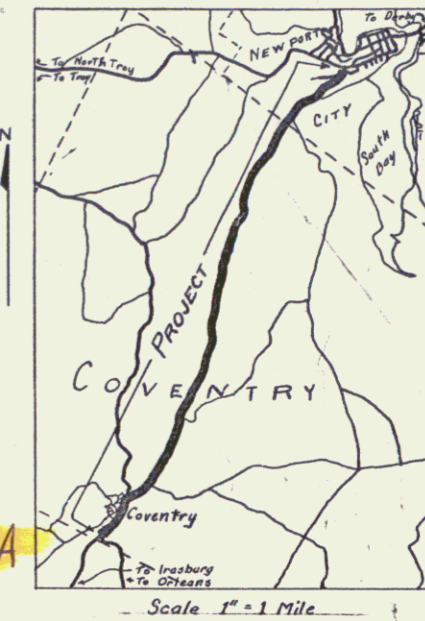

Record Plans

RIGHT-OF-WAY DIVISION  
TOWN FILE  
PERPETUAL  
Town of US5  
(To Be Returned To R.O.W. Division)

NOTE: ANY FURTHER INFORMATION CONCERNING FINAL QUANTITIES, ACCENTS OR OTHER DETAILS RELATIVE TO THIS PROJECT MAY BE FOUND IN EITHER THE FIELD BOOKS OR THE ESTIMATE FILE.

SCALES  
TITLE PAGE 1"=1000'  
LAYOUTS 1"=50'  
HORIZONTAL SECTIONS 1"=10'  
VERTICAL SECTIONS 1"=5'

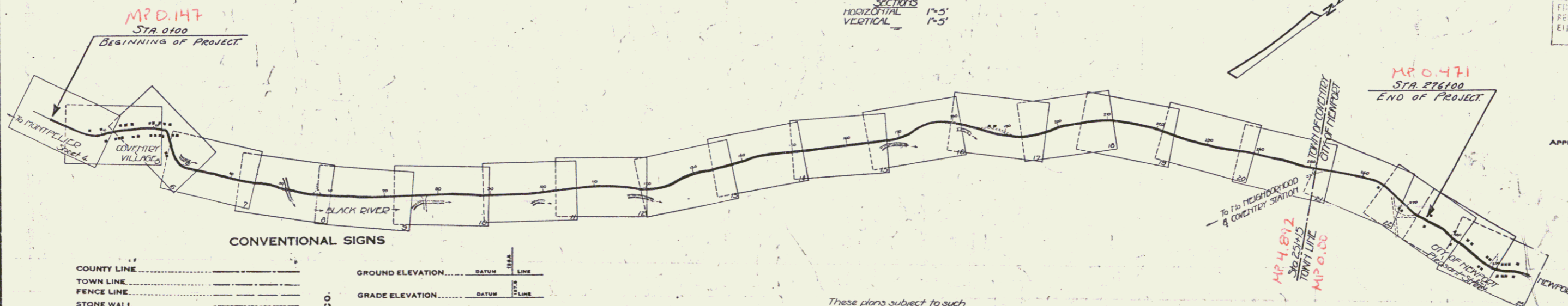

**CONVENTIONAL SIGNS**

COUNTY LINE	GROUND ELEVATION	CURVE DATA
TOWN LINE	GRADE ELEVATION	
FENCE LINE		DEFLECTION ANGLE
STONE WALL		DEGREE OF CURVE
UNFENCED PROPERTY		RADIUS OF CURVE
GUARD RAIL		TANGENT DISTANCE
TRAVELED WAY		LENGTH OF CURVE
RAILROAD		EXTERNAL DISTANCE
RETAINING WALL		POINT OF INTERSECTION
CENTER LINE		POINT OF CURVE
SURVEY LINE		POINT OF TANGENT
CULVERT		POINT ON TANGENT
DROP INLET		
TRAVEL POLE		
POWER POLE		
TELEPHONE POLE		
TREES		
HEDGES		

These plans subject to such revisions as may be required by the Bureau of Public Roads or by the Chief Engineer.

APPROVED: May 18, 1931  
*H. Sargent*  
COMMISSIONER OF HIGHWAYS  
SUBMITTED BY ORDER OF THE STATE HIGHWAY BOARD

RECOMMENDED  
DISTRICT ENGINEER BUREAU OF PUBLIC ROADS  
RECOMMENDED FOR APPROVAL  
CHIEF ENGINEER BUREAU OF PUBLIC ROADS  
APPROVED  
CORRECT: May 18, 1931  
*W. B. Remond*  
ROAD ENGINEER  
SERIES F. NO. 130A FILED  
SHEET 1 OF 74