

INDEX OF SHEETS

SHEET NO.	TITLE	PAGE
2	TYPICAL CROSS SECTIONS OF IMPROVEMENT (1" BY CONC. PAV'T. ITEM 381-B MOD.)	
3	QUANTITY SHEET (ITEMS)	
4	QUANTITY SHEET (DRAINAGE)	
5-6	EARTHWORK AND GRADE SHEETS	
7-11	PLAN AND PROFILE SHEETS	
12	R.O.W. DETAIL SHEET	
13	BLANK	
14	A-61 SOLID ROCK EXCAVATION	
15	B-1 BANKING TABLES	
16	B-5 TYPICAL SLOPE GRADING	
17	B-6 MUCK EXCAVATION	
18	D-2 UNDERDRAIN AND HEADWALLS	
19	D-4 ELBOWS, FLUSHING BASINS AND METAL END SECTIONS	
20	BLANK	
21	D-8 DROP INLETS	
22	E-1 BARRICADES, SIGNS AND LIGHTS	
23	E-31 CONSTRUCTION IDENTIFICATION SIGNS	
24	G-4 MARKER POSTS, GUIDE POSTS AND PLANK GUARD RAIL	
25	J-1 PROJECT AND BOUNDARY MARKERS	
26-384	CROSS SECTIONS	

EXTRA SHEETS:
 6A-B FINAL EARTHWORKS
 38A-E REVISED SECTIONS
 38F-I DRAINAGE

STATE OF VERMONT
 DEPARTMENT OF HIGHWAYS

PROPOSED IMPROVEMENT

TOWN OF COVENTRY
 COUNTY OF ORLEANS
 U.S. ROUTE 5 AND VT. ROUTE 14
 ORLEANS-NEWPORT ROAD

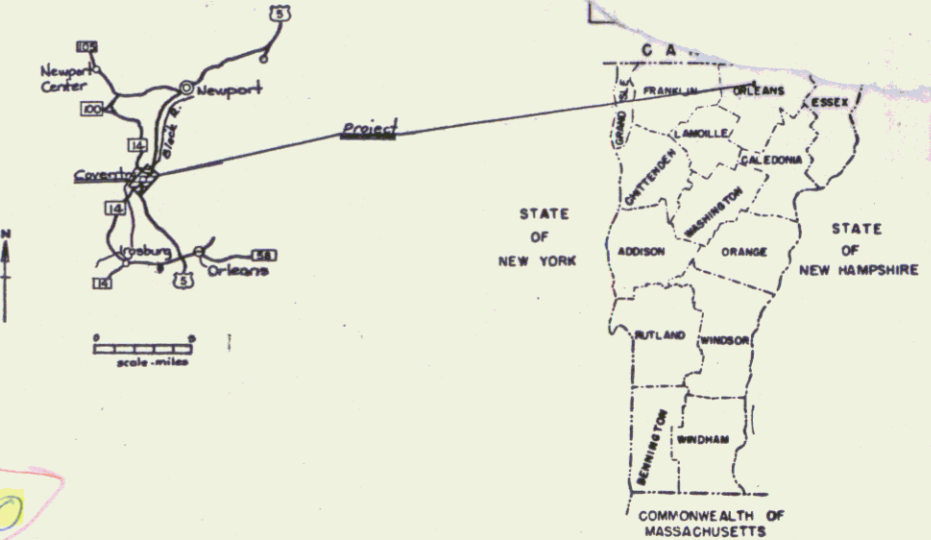

BEGINNING AT A POINT 0.146 MILE NORTHEASTERLY OF THE IRASBURG-COVENTRY TOWN LINE AND EXTENDING NORTH-EASTERLY 2,785 FEET.

LENGTH OF PROJECT 2,785 FEET = 0.527 MILE

PROJECT NAME & NUMBER TYPE PAV'T. AREA
 COVENTRY F 041-5(2) BIT. CONC. PAV'T. 6808 S.Y.

RECORD PLANS

MATERIALS

SUB-BASE OF GRAVEL — LEMARCHE PIT & D. LAWSON PIT
 COVENTRY, VT.

PEN. MACADAM CRUSHED GRAVEL BASE COURSE
 & CRUSHED GRAVEL — CALKINS PLANT
 COVENTRY, VT.

ASPHALT CEMENT, CUTBACK ASPHALT
 & REFINED TAR — MOBILE OIL CO. PROVIDENCE, R.I.

BITUMINOUS CONCRETE PAVEMENT — L. M. PIKE & SON (PLANT)
 COVENTRY, VT.

A.C.C.G. METAL PIPE & CGM. PIPE — NEW ENGLAND METAL CULVERT
 WHITE RIVER JCT., VT.

CABLE GUARD RAIL, WOOD G. RAIL, STEEL
 MARKER POSTS & BOUNDARY MARKERS — S.T. GRISWOLD & CO. INC.
 WILLISTON, VT.

CONTRACT

DATED — 16 SEPTEMBER, 1964
 STARTED — 28 SEPTEMBER, 1964
 COMPLETED — 15 JULY, 1965
 ACCEPTED — 15 JULY, 1965

CONTRACTOR — LEO & ROLAND LAPERLE ST. JOHNSBURY, VT.
 RESIDENT ENGINEER — WILLIAM O. FISK
 RECORD PLANS — W. O. FISK

MP 0.146
 50 + 15.0'
 BEGIN PROJECT
 F 041-5(2)

NOTE
 THIS PROJECT IS COMPLETELY
 WITHIN THE LIMITS OF FEDERAL
 AID PROJECT FAR-E 130A2,
 BUILT 1933.

1965 ADT	1420-2250
1985 ADT	600-1480
1985 DHV	115 - 235
D	55%
T	8%
V	50 MPH

MP 0.673
 78 + 00.00'
 END PROJECT
 F 041-5(2)

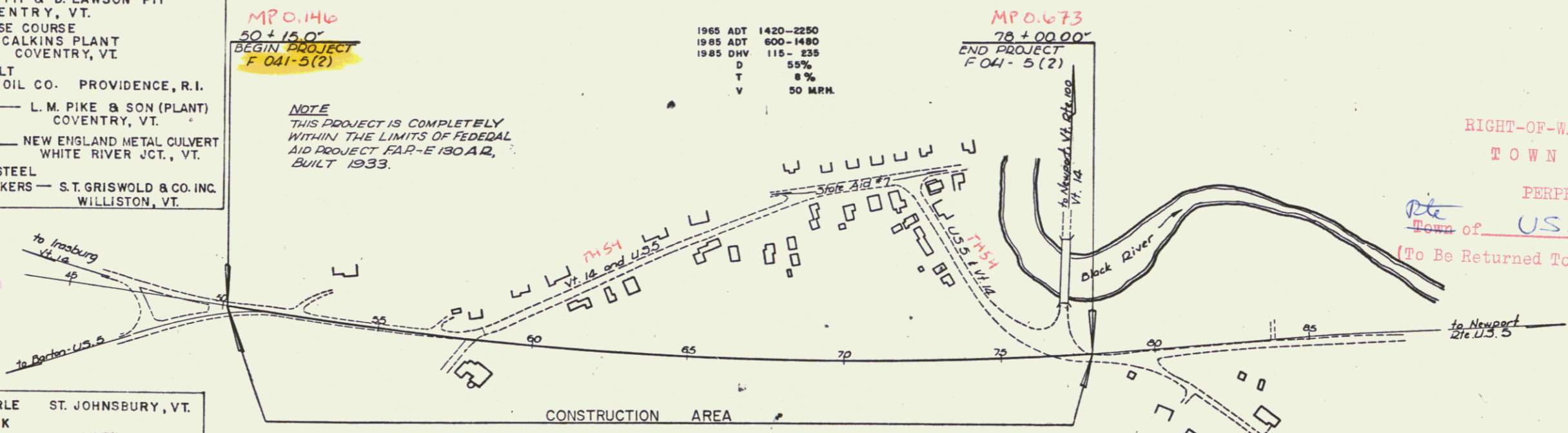

RIGHT-OF-WAY DIVISION
 TOWN FILE
 PERPETUAL
 Town of USS
 (To Be Returned To R.O.W. Division)

CONVENTIONAL SIGNS

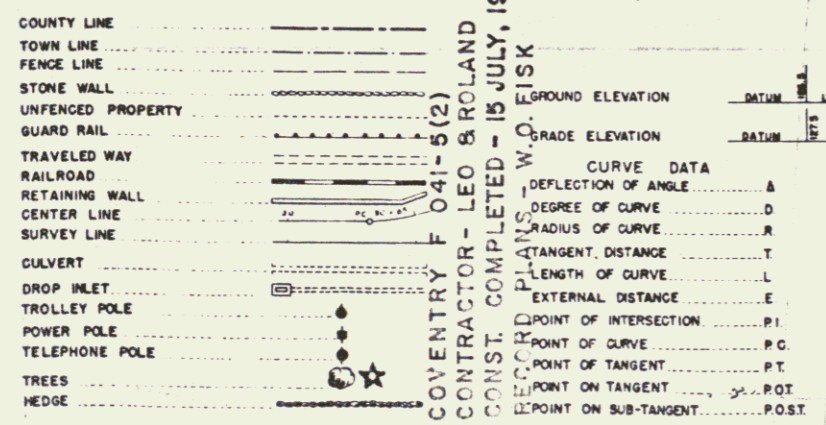

PROJECT COVENTRY
 F 041-5(2)
 TYPE BITUMINOUS CONCRETE PAVEMENT
 LENGTH 0.527 MI.
 CONTRACTOR LEO & ROLAND LAPERLE
 ST. JOHNSBURY, VT.
 YEAR 1964-65
 LOCATION BEGINNING AT A POINT 0.146 MILE NORTHEASTERLY OF
 THE IRASBURG-COVENTRY TOWN LINE AND EXTENDING
 NORTHEASTERLY 2,785 FEET.

APPROVED SECONDARY ENGINEER DATE	APPROVED CONSTRUCTION ENGINEER DATE 6/27/63	APPROVED BRIDGE ENGINEER DATE	APPROVED DISTRICT ENGINEER DATE 7/1/63	APPROVED HIGHWAY ENGINEER DATE 6/25/63	APPROVED CHIEF ENGINEER DATE 6/28/63
--	---	-------------------------------------	--	--	--

THESE PLANS ARE SUBJECT TO SUCH REVISIONS AS MAY BE
 REQUIRED BY THE BUREAU OF PUBLIC ROADS OR THE COMMISSIONER
 OF HIGHWAYS.

CONSTRUCTION IS TO BE CARRIED ON IN ACCORDANCE WITH
 THE PLANS AND THE STANDARD SPECIFICATIONS FOR HIGHWAY AND BRIDGE
 CONSTRUCTION OF JANUARY 1956 SUBMITTED TO THE BUREAU OF
 PUBLIC ROADS AS APPROVED JULY 5, 1955, INCLUDING ALL SUBSEQUENT
 APPROVED REVISIONS AND SUCH REVISED SPECIFICATIONS AND SPECIAL
 PROVISIONS AS ARE SUBMITTED WITH THE PLANS.

DEPARTMENT OF COMMERCE BUREAU OF PUBLIC ROADS	
APPROVED	DATE
DIVISION ENGINEER	DATE
PROJECT F NO. 041-5(2)	
SHEET 1 OF SHEETS 38	