

INDEX OF SHEETS

SHEET NO.	TITLE PAGE
1	TITLE PAGE
2	TYPICAL CROSS-SECTION OF IMPROVEMENT
3	BANKING AND WIDENING TABLES
4	PLAN AND PROFILE

STATE OF VERMONT
 STATE HIGHWAY DEPARTMENT
 PLAN AND PROFILE OF PROPOSED
 STATE HIGHWAY
 FEDERAL AID PROJECT

FED. ROAD DIST. NO.	STATE	FED. AID PROJ. NO.	FISCAL YEAR	SHEET NO.	TOTAL SHEETS
9	Vt.				

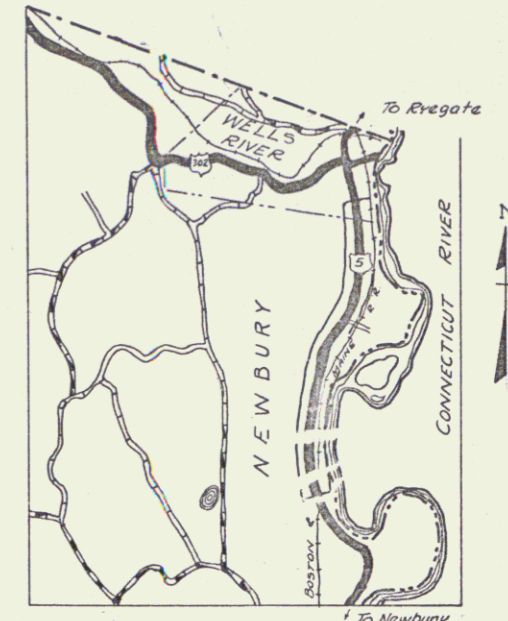

Town: Newbury Project: FAP 112E(1)
 Route: US 5

BEGINNING AT A POINT 1575 FT NORTH OF THE B&M TRACKS Pin# 99R277
 & EXTENDING NORTHERLY 15,538.8 FT TO A POINT 2260 FT SOUTH OF THE INTERSECTION WITH US 302

Historical
 RIGHT-OF-WAY DIVISION
 TOWN FILE
 PERPETUAL
 Town of US 5
 (To Be Returned To R.O.W. Division)

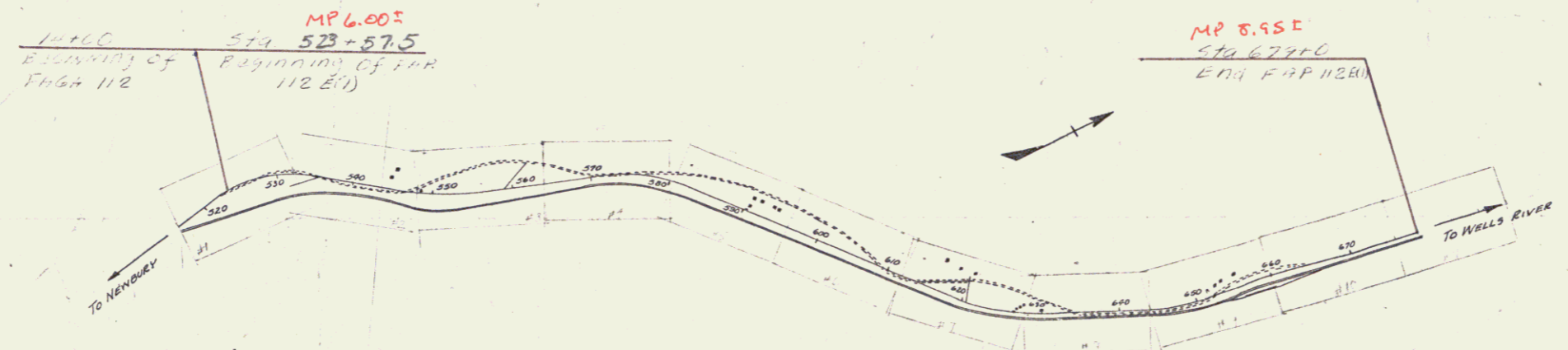

PROJECT NO.	112
SECTION	112E(1)
DATE	11/12/81
DESIGNER	
CHECKER	
APPROVED	
LOCATION	From Sta. 302+13 to 313+00
CONTRACT	112E(1)

GROUND ELEVATION..... DATUM..... LINE.....
 GRADE ELEVATION..... DATUM..... LINE.....

CURVE DATA

DEFLECTION ANGLE.....	Δ
DEGREE OF CURVE.....	D
RADIUS OF CURVE.....	R
TANGENT DISTANCE.....	T
LENGTH OF CURVE.....	L
EXTERNAL DISTANCE.....	E
POINT OF INTERSECTION.....	P. I.
POINT OF CURVE.....	P. C.
POINT OF TANGENT.....	P. T.
POINT ON TANGENT.....	P. O. T.

SCALES

TITLE	1" = 1000'
TYPICAL	1" = 2'
PLAN	1" = 50'
PROFILE HORIZONTAL	1" = 50'
PROFILE VERTICAL	1" = 10'
CROSS SECTIONS	1" = 5'

THESE PLANS ARE SUBJECT TO SUCH REVISIONS AS MAY BE REQUIRED BY THE PUBLIC ROADS ADMINISTRATION OR THE COMMISSIONER OF HIGHWAYS.
 CONSTRUCTION IS TO BE CARRIED ON IN ACCORDANCE WITH THE PLANS AND THE STANDARD ROAD AND BRIDGE SPECIFICATIONS OF 1936, AS APPROVED DECEMBER 29TH, 1936 BY THE PUBLIC ROADS ADMINISTRATION, INCLUDING ALL SUBSEQUENT APPROVED REVISIONS AND SUCH REVISED SPECIFICATIONS AND SPECIAL PROVISIONS AS ARE SUBMITTED WITH THE PLANS.

APPROVED _____ ROAD ENGINEER	APPROVED _____ DISTRICT HIGHWAY COMMISSIONER	SERIES F No. _____ FILED SHEET (1) OF _____
---------------------------------	---	--

Dist. # 7 PLANS 1