

Turnout
 LT 676+25 - 677+75
 RT 676+0 - 678+0

DRIVES CONSTRUCTED
 LT 679+50
 RT

3 CABLE GUARD RAIL
 LT 676+0 - 676+39

1944
 1955
 SPALLING
 A.J.A.
 T.L.

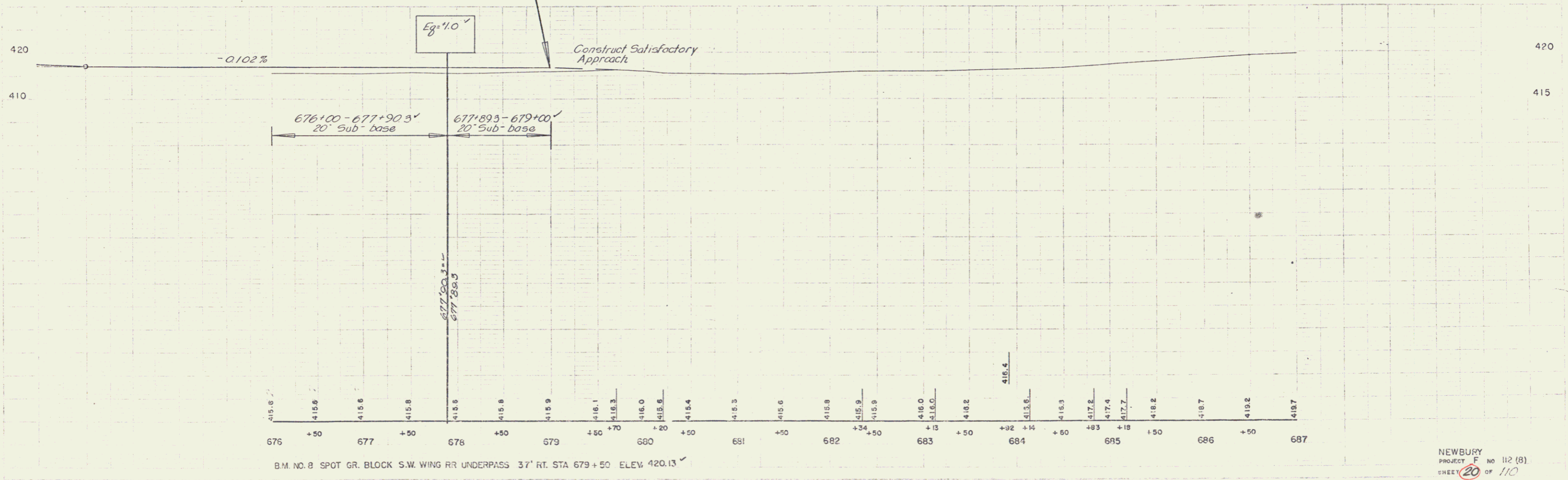
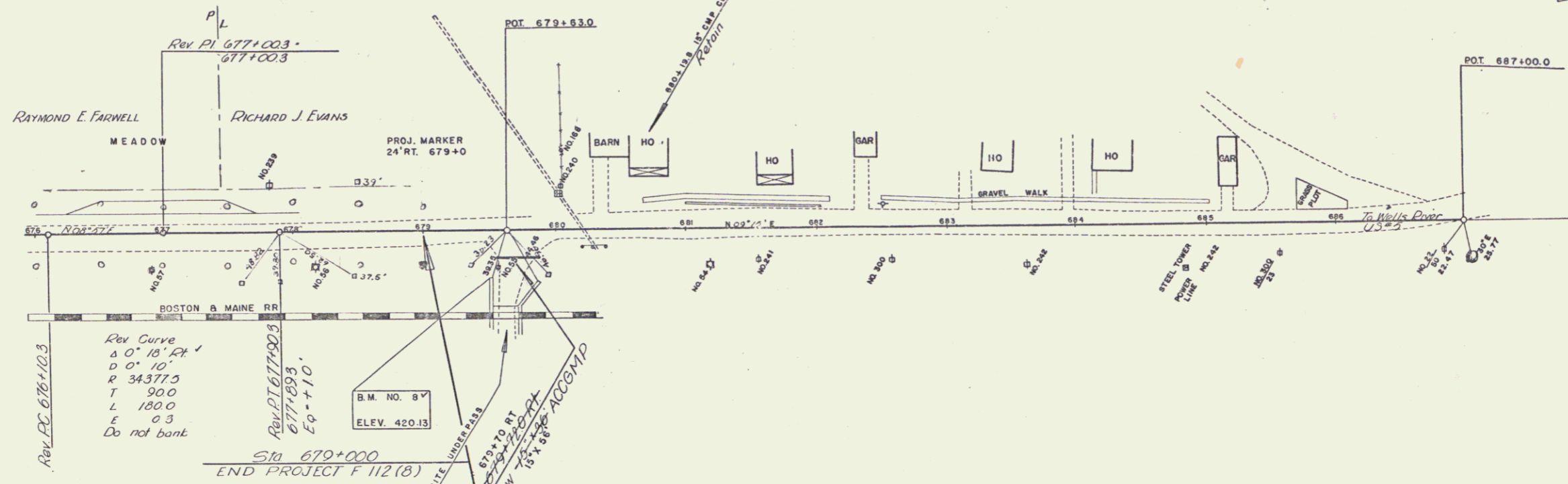

NEWBURY
 PROJECT F NO 112 (8)
 SHEET 20 OF 110