

Construct Drives
631+78 RT. 6 LT

Construct Turnout
629+29 - 631+25 LT
633+25 - 641+25 RT
633+50 - 641+0 RT

Three Cable Guard Rail w/ Steel Posts.
LT
628+00 - 629+75
RT
628+00 - 630+49
641+25 - 644+00

Plank Guard Rail
633+0 LT

Steel Guide Posts
LT
631+50
633+50
638+25
643+75

RT
631+50
633+50
633+35

REMOVAL OF PRESENT ROAD SURFACE
628+0 - 633+0 LT

#7-B ROBERT A. ROGERS & RENE R. ROGERS
(A 0.47) STA 633+60 - 642+00
CULVERT RIGHTS - STA 638+13.5
COND 3/23/56
RECORDED: NEWBURY - BK 46 - PG 235/248 - 3/23/56

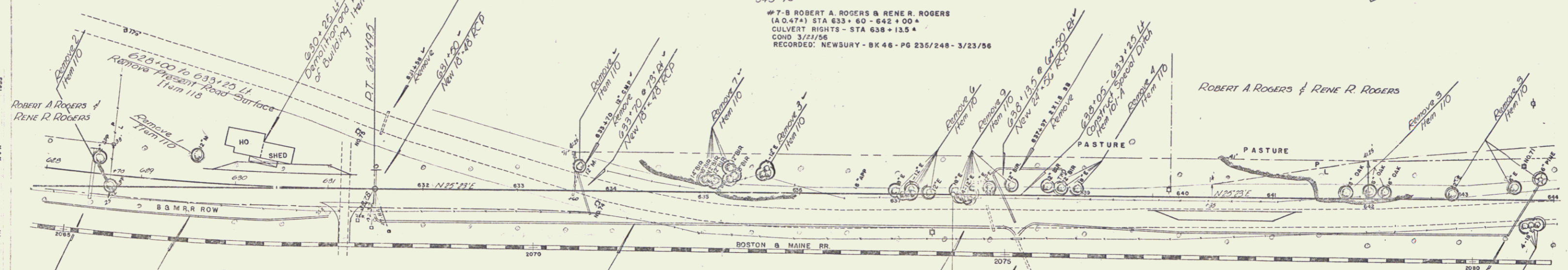

THE FOLLOWING SECTION OF OLD U.S. RTE. 5 IS RELINQUISHED AS INDICATED BELOW:
BEGINNING AT A POINT 60' LT STA 615+15 AND EXTENDING NORTHERLY 0.313 MILES TO A POINT 60' LT STA 632+0
RELINQUISHED TO THE TOWN OF NEWBURY, RECORDED BOOK 2, PAGE 5, OF HIGHWAY RECORDS OF THE TOWN OF NEWBURY 23/9/58

#10 WALTER E. & INEZ F. JOCK
(A 1.00) STA 628+68 - 634+00
W.C. 4/28/54
RECORDED: NEWBURY - BK 46 - PG 1 - 4/28/54

#8-C BOSTON & MAINE RAILROAD COMPANY
(A 1.36) STA 640+35 - 652+30
CULVERT RIGHTS - STA 631+50
638+13.5
643+75
COND 3/23/56
RECORDED: NEWBURY - BK 46 - PG 235/248 - 3/23/56

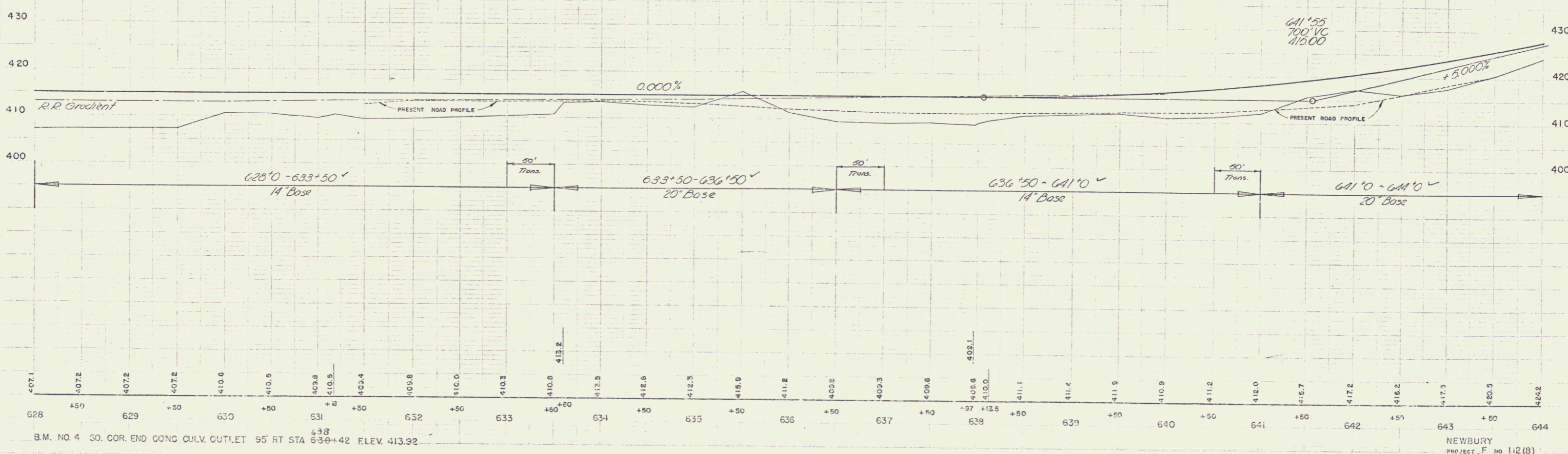

B.M. NO. 4 SO. COR. END CONC. CULV. OUTLET 95' RT STA 638+42 ELEV. 413.92

NEWBURY
PROJECT NO 112 (B)
SHEET 170 110