

CHANGING ELEVATIONS OF
DI, MAN HOLES OR CATCH BASINS
SH 0+69.17

REV CURVE
 $\Delta 200.20 \text{ 47}$
 22.1790
 79.276
 137.49
 $27.4 = 62.83$

Construct Drive
 73+00 LT 78+00 RT
 74+00 LT 81+00 RT
 77+00 RT
 79+00 RT

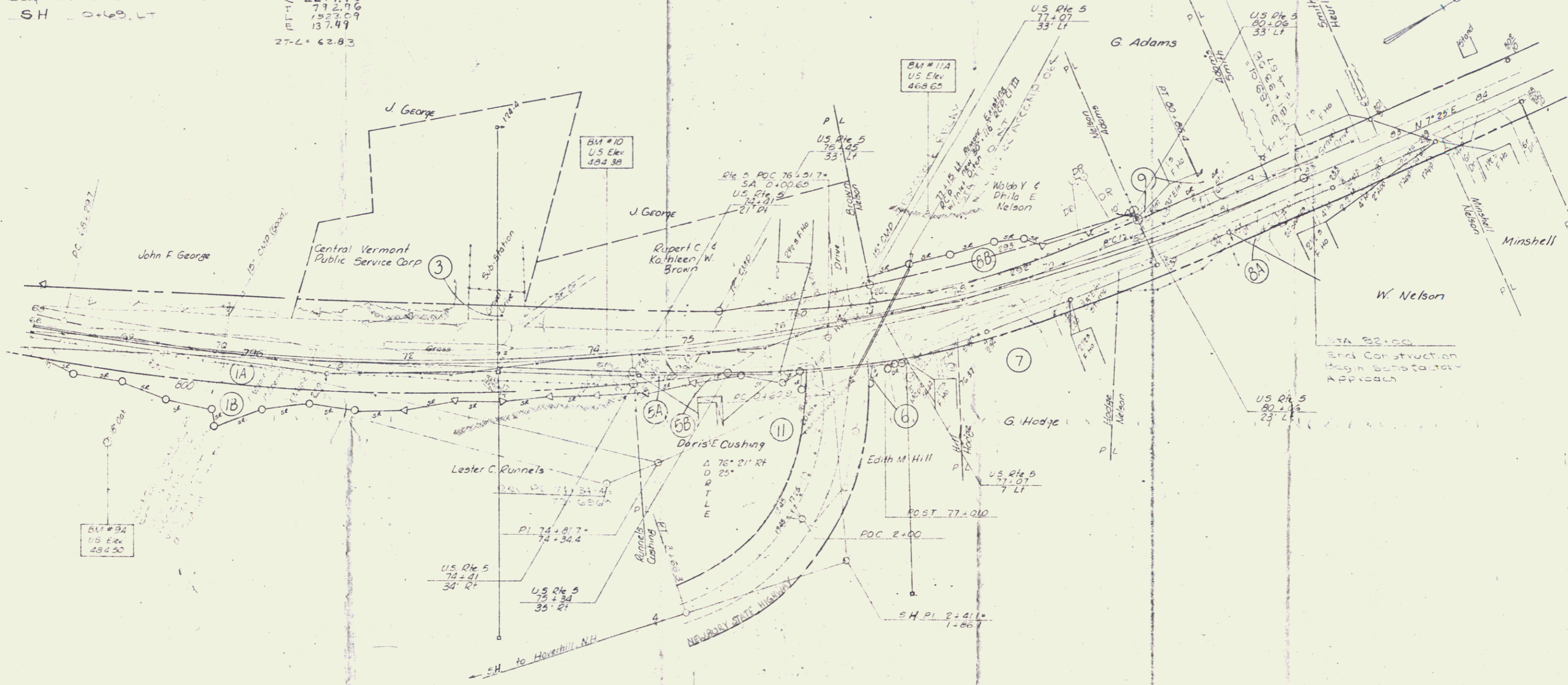

AUG 8 1974
 FOR UTILITIES AND
 ROW USE ONLY

SURVEYED BY	Footner	DATE	July 73
DRAWN BY		DATE	
TRACED BY		DATE	Sept 73

NEWBURY
 PROJ. BP NO. 041-3-2306
 SHEET 7A OF 8-7