

DETAIL FOR FIELD LAYOUT OF BOX CULVERT STA. 53+57

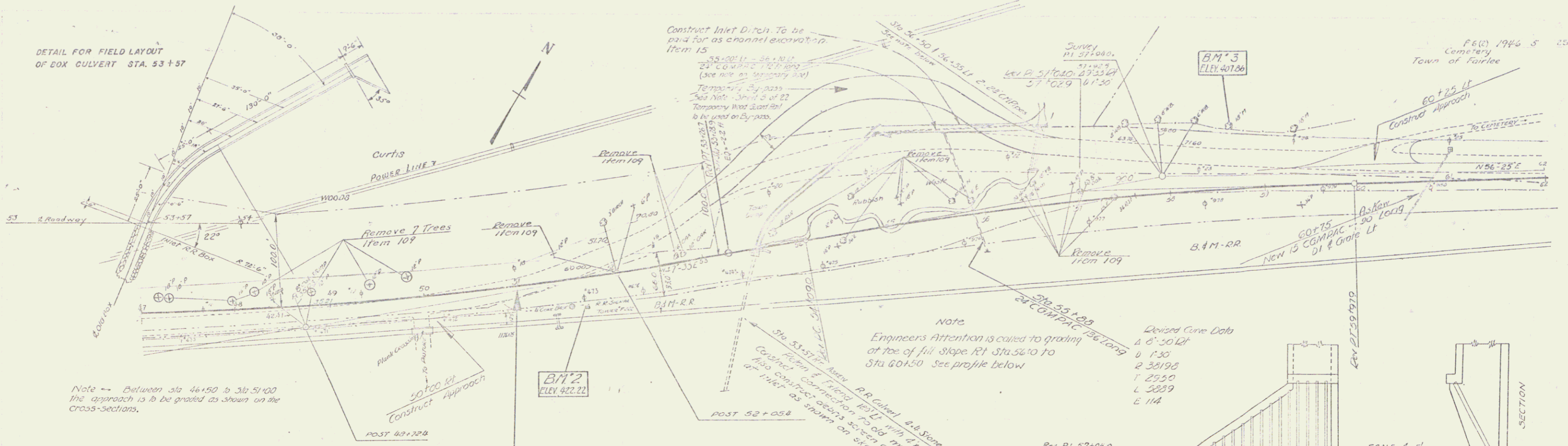

PARCEL	INSTRUMENT	DATE	GRANTOR	GRANTEE	RECORDED FAIRLEE	BOOK	PAGE	DATE
430								
420								
410								
400								
390								

- Note -- The project is designed for the construction operation in connection with the construction of the 4'x4' RC Box at Sta 53+57 to be carried out in the following manner:
1. Construct temporary bypass for traffic at the approximate location shown on the layout and cross-sections, placing gravel sub-base as shown on cross-sections. Also construct the section of 24" corrugated galvanized metal pipe under the temporary by-pass in line with the procedure set up under Item 3. This work to be paid for as Common Excavation, Item 10-A or 10-B.
  2. Excavate and construct 4'x4' RC Box complete. To handle the water from the two 24" CM pipes a temporary opening is to be constructed through the new box at the junction with the railroad culvert.
  3. Install the remainder of the 24" corrugated galvanized metal pipe from the inlet of the new RC box to connect with the section of pipe as constructed under item 1, the pipe and necessary trench excavation to be paid for at contract bid prices. The 24" metal pipes are to be laid in and ends plugged with concrete.
  4. The construction of necessary excavation and embankments for the completion of the project and placing of base and surface to be completed.
  5. After traffic is put over the new location the temporary 24" metal pipe is to be removed and necessary inlet ditch to be constructed as per plans. The 24" metal pipe when removed is to become the property of the site.

STA 51+00  
BEGINNING OF F 6 (2) =  
STA 51+00 OF FAP 6  
REMARKS

Note -- In order that traffic may be maintained during the construction of this project, the excavation of the inlet ditch for the culvert of Sta. 53+57 will not be made until after the new road surface is opened to traffic. The channel excavation then made is to be used on the Fairlee 112 (S) Project.

Note  
Engineers Attention is called to grading at toe of fill slope Rt Sta 56+0 to Sta 60+50. See profile below

Devised Curve Data  
A 6' 50" Lt  
B 1' 30"  
C 38196  
T 2950  
L 5889  
E 114

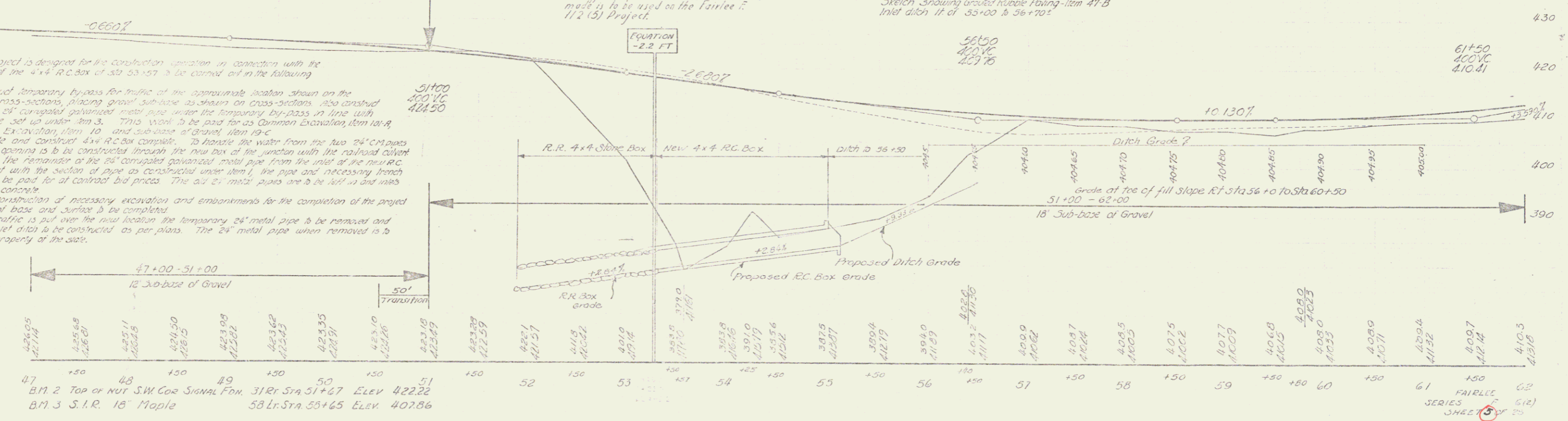
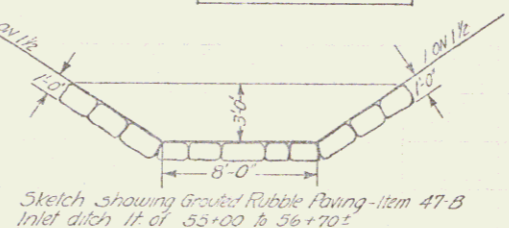
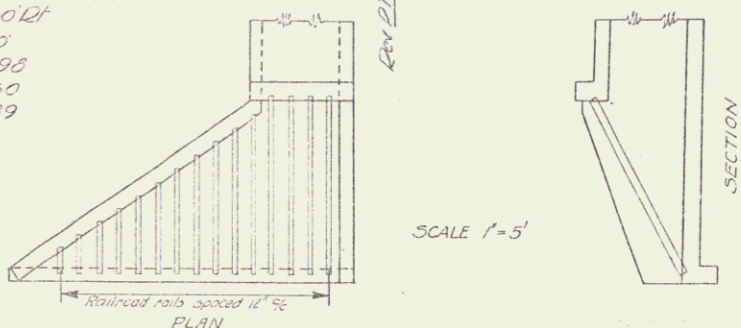

B.M. 2 Top of Nut S.W. Cor. Signal Fm. 31 Rt. Sta 51+47 ELEV 422.22  
B.M. 3 S.I.R. 18" Maple 58 Lt. Sta 55+65 ELEV 407.86

F 6 (2) 1944 S  
Cemetery  
Town of Fairlee