

**CULVERT REPAIRS REQUIRED**

Sta. 20+24  
New Concrete Headwalls - Both Ends 1 each.

FED. ROAD DIST. NO.	STATE	FED. AID PROJ. NO.	FISCAL YEAR	INVEST. NO.	TOTAL LENGTH
2	VT	6	1918	4	2.0

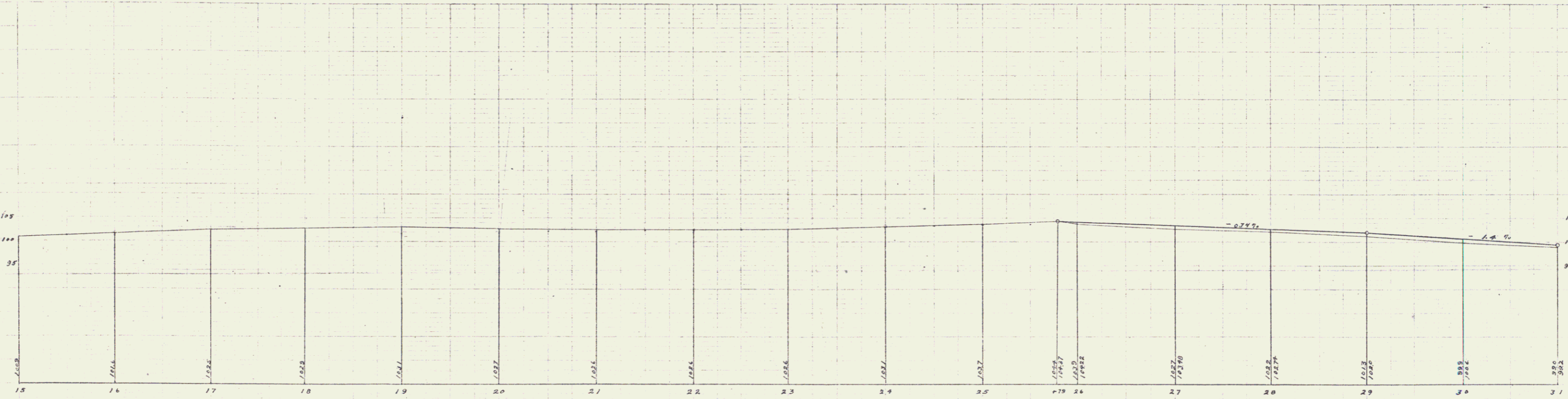
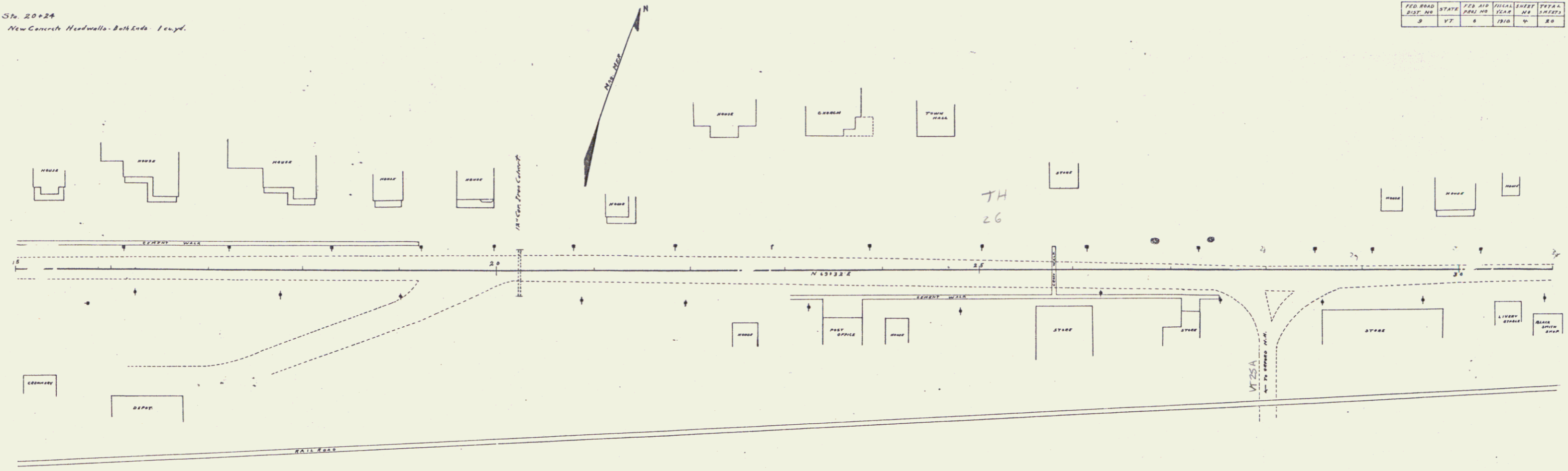

B.M. N.E. on Lower Slope Road Near Mouth of Pond Sully, E.I. 185.36

Note: Sta. 20+20 to Sta. 25+79 to be resurfaced as per section 10 & shown on sheet 2. Cracked down shoulder.

Sheet 1 of 2  
Scale 1" = 40'