

INDEX OF SHEETS

| SHEET NO. | TITLE PAGE                               |
|-----------|--|
| 2         | TYPICAL CROSS-SECTION OF IMPROVEMENT     |
| 3         | PLAN AND PROFILE STA. 0+00 TO STA. 15+00 |
| 4         | " " " " 15+00 " " 31+00                  |
| 5         | " " " " 31+00 " " 47+00                  |
| 6         | " " " " 47+00 " " 63+00                  |
| 7         | " " " " 63+00 " " 79+00                  |
| 8         | " " " " 79+00 " " 95+00                  |
| 9         | " " " " 95+00 " " 111+00                 |
| 10        | " " " " 111+00 " " 127+00                |
| 11-20     | CROSS-SECTIONS                           |

| FED. AID DIST. NO. | STATE | FED. AID PROJ. NO. | FISCAL YEAR | SHEET NO. | TOTAL SHEETS |
|--------------------|-------|--------------------|-------------|-----------|--------------|
| 3                  | VT.   | 4                  | 1918        | 7         | 27           |

STATE OF VERMONT  
 STATE HIGHWAY DEPARTMENT  
 PLAN AND PROFILE OF PROPOSED  
 STATE HIGHWAY  
 FEDERAL AID PROJECT

TOWN OF FAIRLEE

Pin# 992263

Route: U.S. 5

Project: F#6

RIVER ROAD  
 FROM ROAD TO SOUTH END OF LAKE MOREY TO ROAD TO NORTH END

SCALES: PLAN 1" = 200' ; PROFILE HORIZ. 1" = 500' VERT. 1" = 100' ; CROSS-SECTIONS 1" = 50'

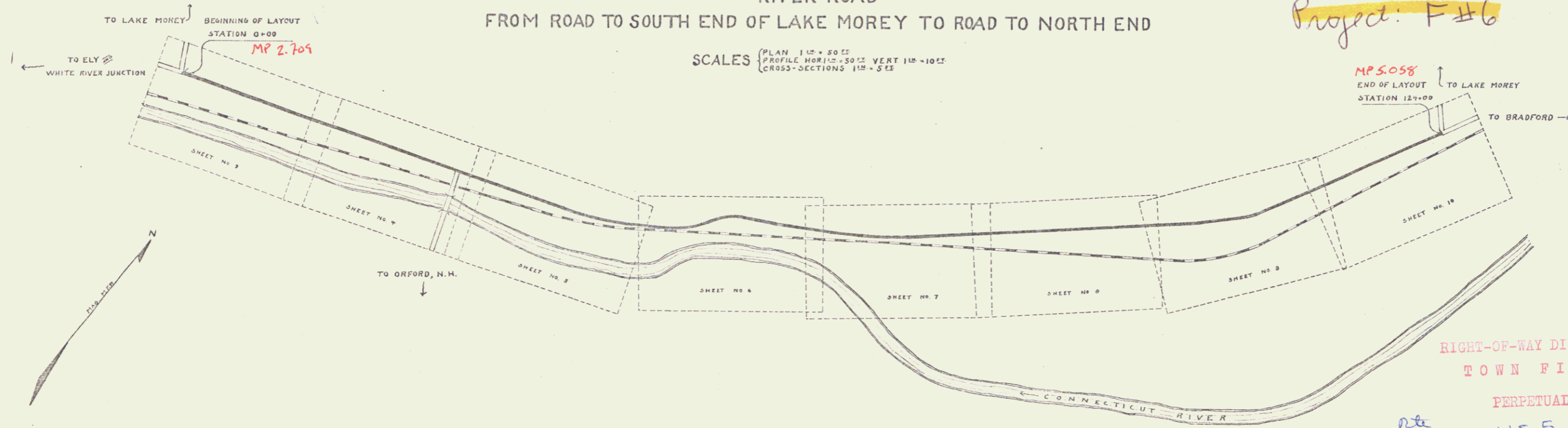

LAYOUT

SCALE 500 FEET = 1 IN.

CONVENTIONAL SIGNS

|                     |       |                  |      |       |      |
|---------------------|-------|------------------|------|-------|------|
| COUNTY LINE         | ---   | GROUND ELEVATION | DATE | SCALE | LINE |
| TOWN LINE           | ----  | GRADE ELEVATION  | DATE | SCALE | LINE |
| FENCE LINE          | ----- |                  |      |       |      |
| STONE WALL          | ----- |                  |      |       |      |
| UNFENCED PROPERTY   | ----- |                  |      |       |      |
| GUARD RAIL          | ----- |                  |      |       |      |
| TRAVELED WAY        | ----- |                  |      |       |      |
| RAILROAD            | ----- |                  |      |       |      |
| RETAINING WALL      | ----- |                  |      |       |      |
| BASE OR SURVEY LINE | ----- |                  |      |       |      |
| CULVERT             | ----- |                  |      |       |      |
| DROP INLET          | ----- |                  |      |       |      |
| TROLLEY POLE        | ----- |                  |      |       |      |
| POWER POLE          | ----- |                  |      |       |      |
| TELEPHONE POLE      | ----- |                  |      |       |      |
| TREES               | ----- |                  |      |       |      |
| HEDGE               | ----- |                  |      |       |      |

|                       |       |
|-----------------------|-------|
| CURVE DATA            |       |
| DEFLECTION ANGLE      | Δ     |
| DEGREE OF CURVE       | D     |
| RADIUS OF CURVE       | R     |
| TANGENT DISTANCE      | T     |
| LENGTH OF CURVE       | L     |
| EXTERNAL DISTANCE     | E     |
| POINT OF INTERSECTION | P. I. |
| POINT OF CURVE        | P. C. |
| POINT OF TANGENT      | P. T. |

RIGHT-OF-WAY DIVISION  
 TOWN FILE  
 PERPETUAL  
 Town of U.S. 5  
 (To Be Returned To R.O.W. Division)

01/01/18

RECOMMENDED

STATE ENGINEER

SUBMITTED

STATE HIGHWAY COMMISSIONER

RECOMMENDED FOR APPROVAL

CHIEF ENGINEER

APPROVED

DIRECTOR

Series F No. 6 File  
 Sheet D of 20

DIST # 7 PERALS