

INDEX OF SHEETS

SHEET NO. 1	TITLE PAGE
2	TYPICAL CROSS-SECTION OF IMPROVEMENT (GRADING BASE DRAINAGE WITH GUARD RAIL AND DOUBLE TACK COAT OF REFINED TAR (ITEM 29))
3	BANKING AND WIDENING TABLES
4-7	PLAN AND PROFILE
8	7'x7' REINFORCED CONCRETE BOX CULVERT STA. 101+28
9	STANDARD STRUCTURE SHEET S-28 PIPE CULVERTS
10	" " " S-30 GUARD RAIL
11	" " " S-30-A STANDARD UNDERDRAIN & F.A. MARKERS
12	" " " S-40 BARRICADES, SIGNS & LIGHTS
13	" " " S-41 ROUNDING OF SLOPES
14-41	CROSS SECTIONS

STANDARD STRUCTURE SHEETS  
 APPROVED BY THE CHIEF ENGINEER  
 S-28 JULY 11, 1933  
 S-30 AUGUST 15, 1934

STATE OF VERMONT  
 STATE HIGHWAY DEPARTMENT

PLAN AND PROFILE OF PROPOSED  
 STATE HIGHWAY

FEDERAL AID PROJECT F.A.P. 236B-(1)

TOWN OF FAIRLEE

NORWICH - BRADFORD ROAD

BEGINNING AT A POINT ON ROUTE U.S. 5 0.5 MILES  
 NORTHEASTERLY OF THE INTERSECTION WITH STATE  
 ROUTE 113 AND EXTENDING NORTHEASTERLY 1.118 MILES  
 TOTAL LENGTH OF PROJECT 5904.4 FT. = 1.118 MILES

Pin# 992260

Project: FAP 236 B-(1)

F.A.P.					
FED. ROAD DIST. NO.	STATE	FED. AID PROJ. NO.	FISCAL YEAR	SHEET NO.	TOTAL SHEETS
9	VT	236B-(1)	1941	1	71

FAIRLEE

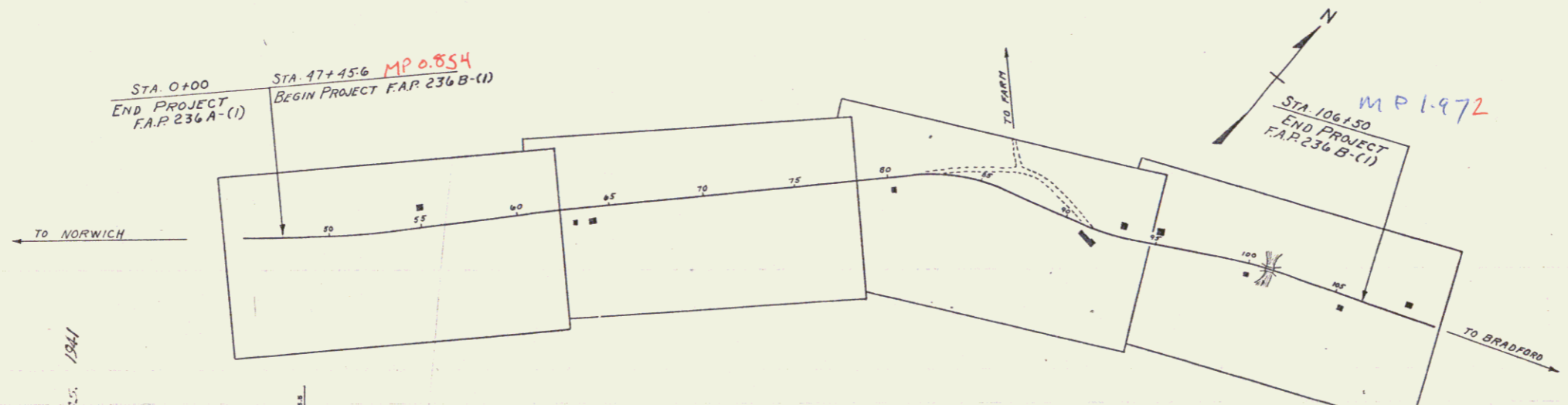
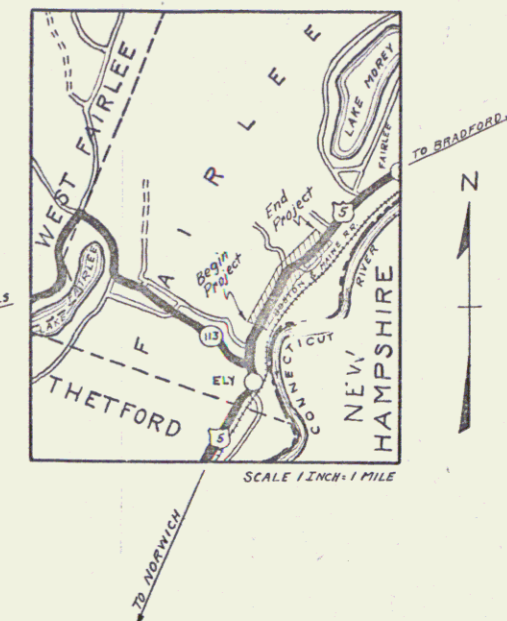

RECORD PLANS  
 By - Leo D. Sullivan  
 March 16, 1940

RIGHT-OF-WAY DIVISION  
 TOWN FILE  
 PERPETUAL

U.S. 5  
 (To Be Returned to R.O.W. Division)  
 APPROVED: *H. S. August*  
 COMMISSIONER OF HIGHWAYS  
 SUBMITTED BY ORDER OF THE STATE HIGHWAY BOARD

- COUNTY LINE
- TOWN LINE
- FENCE LINE
- STONE WALL
- UNFENCED PROPERTY
- GUARD RAIL
- TRAVELED WAY
- RAILROAD
- RETAINING WALL
- CENTER LINE
- SURVEY LINE
- CULVERT
- DROP INLET
- TROLLEY POLE
- POWER POLE
- TELEPHONE POLE
- TREES
- HEDGE

- GROUND ELEVATION DATUM
  - GRADE ELEVATION DATUM
- CURVE DATA
- DEFLECTION ANGLE..... Δ
  - DEGREE OF CURVE..... D.
  - RADIUS OF CURVE..... R.
  - TANGENT DISTANCE..... T.
  - LENGTH OF CURVE..... L.
  - EXTERNAL DISTANCE..... E.
  - POINT OF INTERSECTION..... P. I.
  - POINT OF CURVE..... P. C.
  - POINT OF TANGENT..... P. T.
  - POINT ON TANGENT..... P. O. T.

SCALES

TITLE	1" = 400'
TYPICAL	1" = 2'
PLAN	1" = 50'
PROFILE HORIZONTAL	1" = 50'
PROFILE VERTICAL	1" = 10'
CROSS SECTIONS	1" = 5'

THESE PLANS ARE SUBJECT TO SUCH REVISIONS AS MAY BE REQUIRED BY THE PUBLIC ROADS ADMINISTRATION OR THE COMMISSIONER OF HIGHWAYS.  
 CONSTRUCTION IS TO BE CARRIED ON IN ACCORDANCE WITH THE PLANS AND THE STANDARD ROAD AND BRIDGE SPECIFICATIONS OF 1936 AS APPROVED DECEMBER 29TH, 1936 BY THE PUBLIC ROADS ADMINISTRATION, INCLUDING ALL SUBSEQUENT APPROVED REVISIONS AND SUCH REVISED SPECIFICATIONS AND SPECIAL PROVISIONS AS ARE SUBMITTED WITH THE PLANS.

APPROVED: *Leo D. Sullivan* ROAD ENGINEER  
 APPROVED: *March 13, 1940* DISTRICT HIGHWAY COMMISSIONER  
 SERIES F.A.P. NO. 236B(1) FILED  
 SHEET 1 OF 41

DIST. #7 PLANS