

INDEX OF SHEETS

SHEET NO.	TITLE PAGE
1	TYPICAL CROSS-SECTION OF IMPROVEMENT (7" CURE COURSE, CEMENT CONCRETE PAVEMENT)
2	CONCRETE PAVEMENT DETAILS (2 SHEETS) AND FINISHING & VULNERING TABLES
3-5	PLAN AND PROFILE
6-9	BRIDGE STRUCTURE SHEET
10	PIPE CULVERTS
11	GUARD RAILS
12	STD. UNDERDRAINS
13	BARBICORDS - SIGNS & LIGHTS
14	BOUNDARIES OF SLOPES
15-25	CROSS-SECTIONS

STATE OF VERMONT
STATE HIGHWAY DEPARTMENT

PLAN AND PROFILE OF PROPOSED
STATE HIGHWAY

FEDERAL AID PROJECT

TOWN OF BRATTLEBORO

ROUTE US 5

BRATTLEBORO - BELLOWS FALLS ROAD

BEGINNING AT A POINT 0.821 MILES SOUTH OF THE BRATTLEBORO-DUMMERSTON TOWN LINE ON ROUTE US 5 AND EXTENDING NORTHERLY 0.821 MILES.

LENGTH OF PROJECT
43370 FT = 0.821 MILES

CV					
PER. ROAD	STATE	FED. AID	FIN. YEAR	NEP. NO.	TOTAL LENGTH
0	VT	59-0-00	1	1	0.821

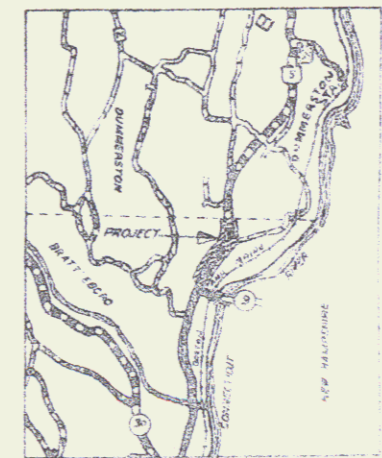

SCALE: 1" = 1 MILE

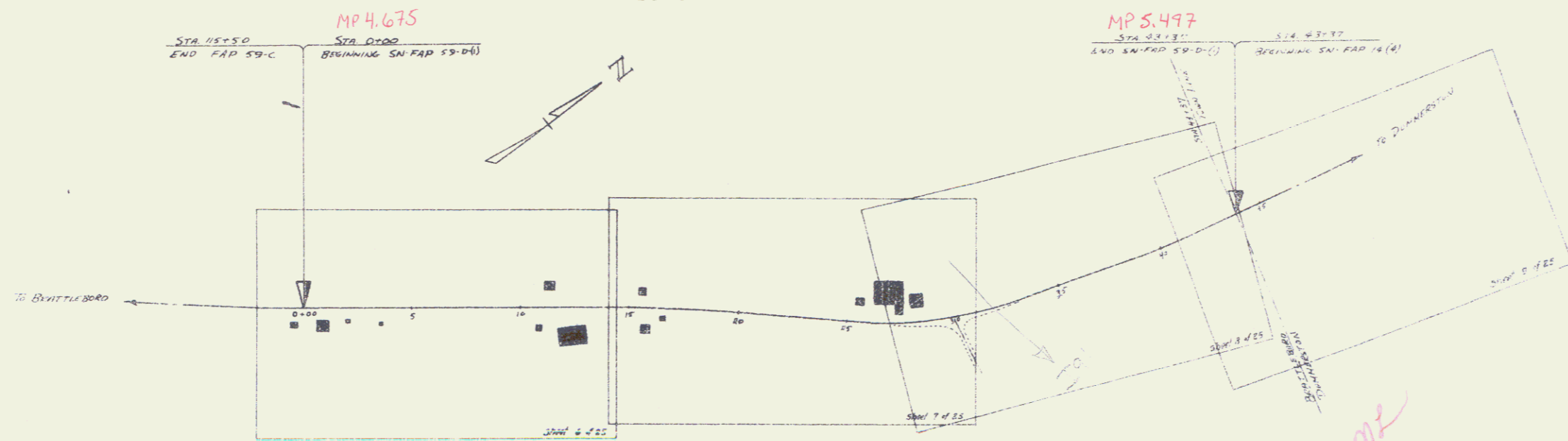

01/01/56

APPROVED: _____
COMMISSIONER OF HIGHWAYS
SUBMITTED BY ORDER OF THE STATE HIGHWAY BOARD

7/6/00M2

GROUND ELEVATION		GRADE ELEVATION	
DATUM	UNIT	DATUM	UNIT
MEAN SEA LEVEL	FEET	MEAN SEA LEVEL	FEET

CURVE DATA		SCALES	
DEFLECTION ANGLE	D	TITLE	1" = 300'
DEGREE OF CURVE	D	TYPICAL	1" = 50'
RADIUS OF CURVE	R	PLAN	1" = 50'
PARABOLIC CURVES	P	UNDERGROUND	1" = 50'

THESE PLANS ARE SUBJECT TO SUCH REVISIONS AS MAY BE REQUIRED BY THE PUBLIC ROADS ADMINISTRATION OR THE COMMISSIONER OF HIGHWAYS.
CONSTRUCTION IS TO BE CARRIED ON IN ACCORDANCE WITH THE PLANS AND THE STANDARD ROAD AND BRIDGE SPECIFICATIONS OF 1950, AS APPROVED DECEMBER 28TH, 1934 BY THE PUBLIC

RECOMMENDED FOR APPROVAL: _____
APPROVED: _____