

WOOD GUARD RAIL
 STA. TO STA. LT. DT.
 79+96 - 80+20 24' 2.4"
 Total 48'

NEW CULVERT
 80+08
 15" RCP 30'
 Cmc "B" (1-25-0) 4.3 cr

DIST.	DATE	BY	CHKD	NO.	SHEET
1	VI	290	1027	9	24

NEW LEACHING BASINS REQUIRED

- STA. 80+10 - 81+05
- 81+00 - 81+30
- 81+30 - 82+30

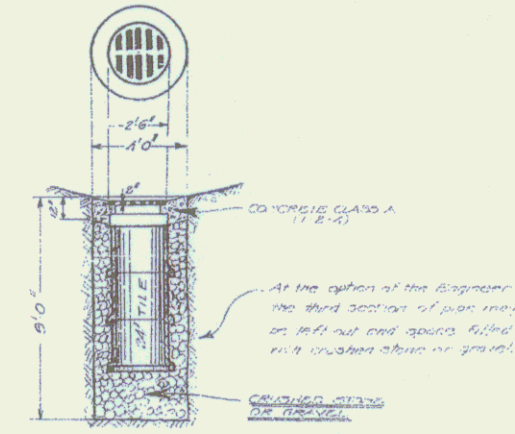

LEACHING BASIN

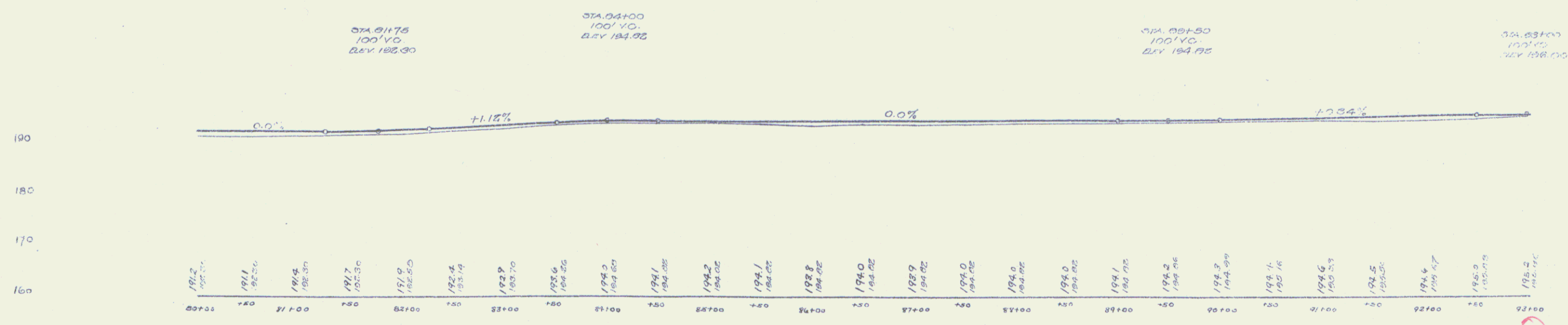
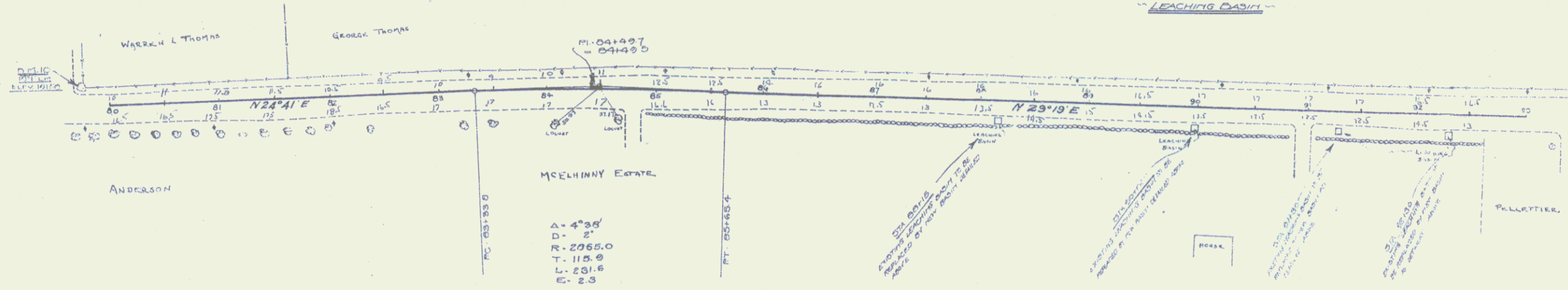

SHEET 58

16

5