

THIS IS PART OF THE SAME LAND AND PREMISES CONVEYED TO THE STATE OF VERMONT BY THE FOLLOWING INSTRUMENTS:  
 WARRANTY DEED FROM E.R. SARGENT AND H. H. NEWTON DATED OCT. 10, 1931, AND RECORDED IN BOOK 69 PAGE 580.  
 WARRANTY DEED FROM H. H. NEWTON DATED FEB. 3, 1940, AND RECORDED IN BOOK 76, PAGE 30.  
 WARRANTY DEED FROM JAMES C. AND PRISCILLA L. PIERCE DATED MARCH 11, 1960, AND RECORDED IN BOOK 103, PAGE 427, ALL OF THE LAND RECORDS OF THE TOWN OF BRATTLEBORO.

STATE OF VERMONT - LESSOR  
 MICHAEL N. LACROIX - LESSEE  
 Rec'D 6/8/90 IN BK 216/677  
*Lease expired 5/31/95  
 see file.*

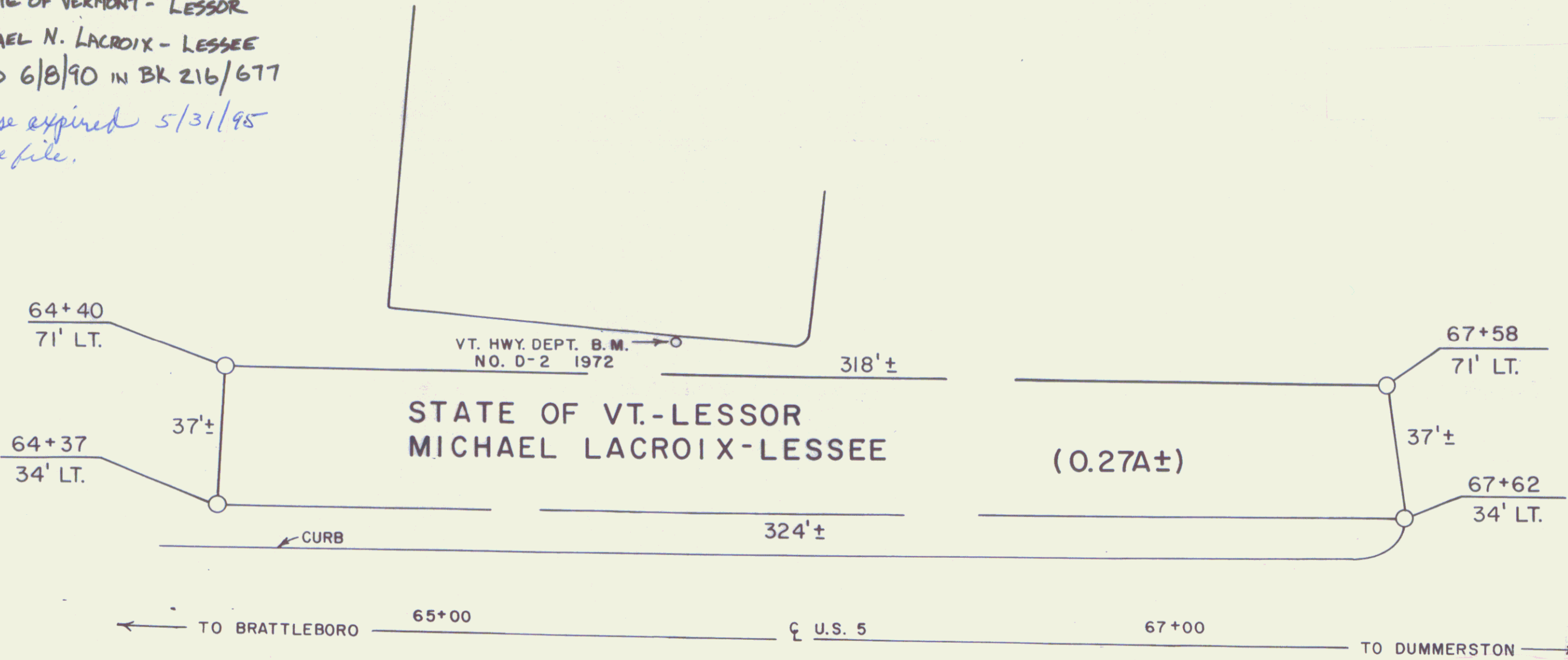
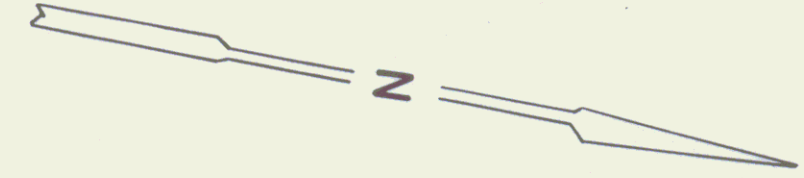

Town: BRATTLEBORO Project: MA 3280  
 RF: BRATTLEBORO MA 3280

STATE OF VERMONT  
 AGENCY OF TRANSPORTATION

Route: V35  
 TOWN OF BRATTLEBORO  
 SHEET 10

APPROX. SCALE 1" = 30' DATE 12-12-89 DRAWN BY M. J.R.