

NEW SATCH BASINS REQUIRED

ON LEFT	ON RIGHT
STA 13+10	STA 11+55
• 15+70	• 14+25
• 17+00	• 17+00
• 18+70	• 20+10
• 22+00	

TOTAL FOR SHEET = 6

For Vitripled Clay Pipe
See Pages 56-58 in Field Book

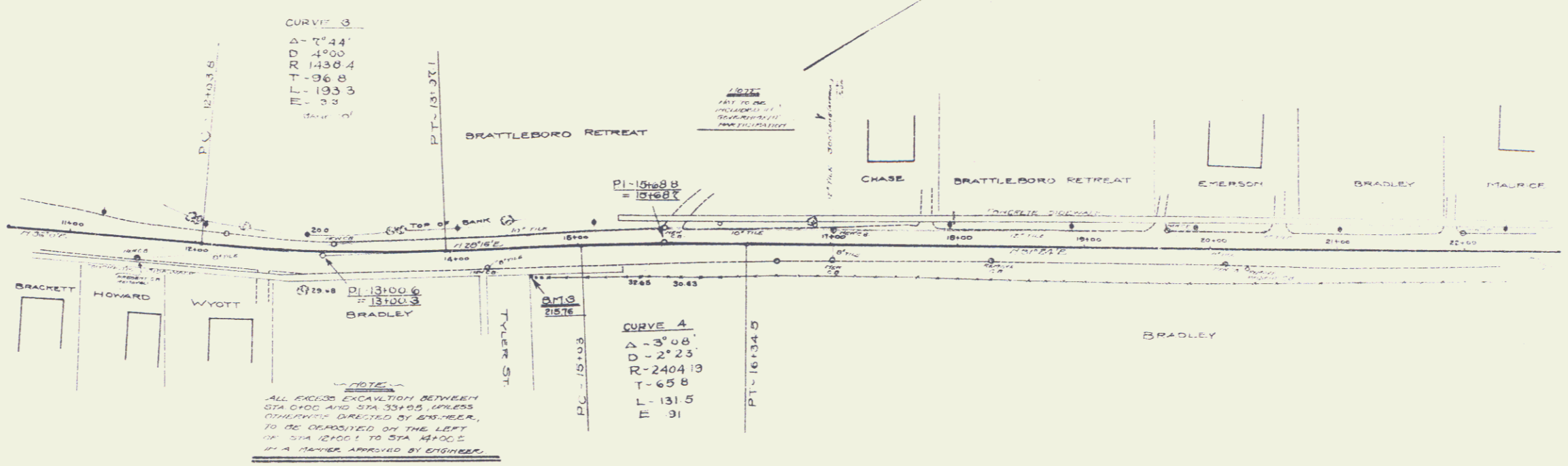

SANDY SUBGRADE THROUGH VILLAGE

Sta 17+00
200' VC
ELEV 212.10

Sta 22+00
100' VC
ELEV 213.35

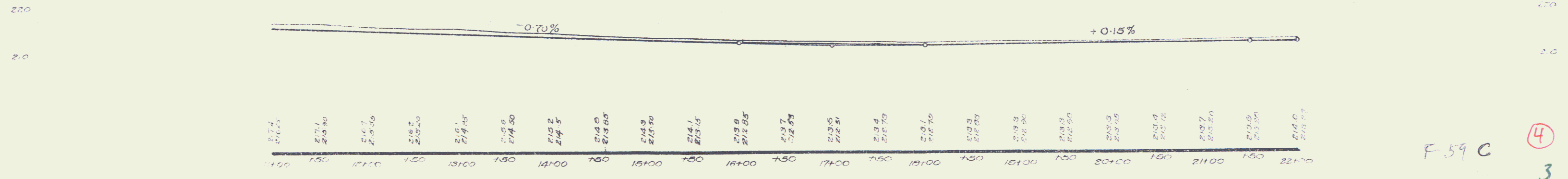

F 59 C

4
3