

WEST RIVER BRIDGE
 TOWN: BRATTLEBORO VT.
 PRELIMINARY PLAN AND PROFILE
 FOR SUBMISSION TO THE VT PUBLIC SERVICE COMMISSION
 Scale: Plan 1" = 50'
 Profile 1" = 20'
 Date: Feb. 5, 1924

Route: US5
 Project: 1924 West River Bridge
 Pin # 99R246

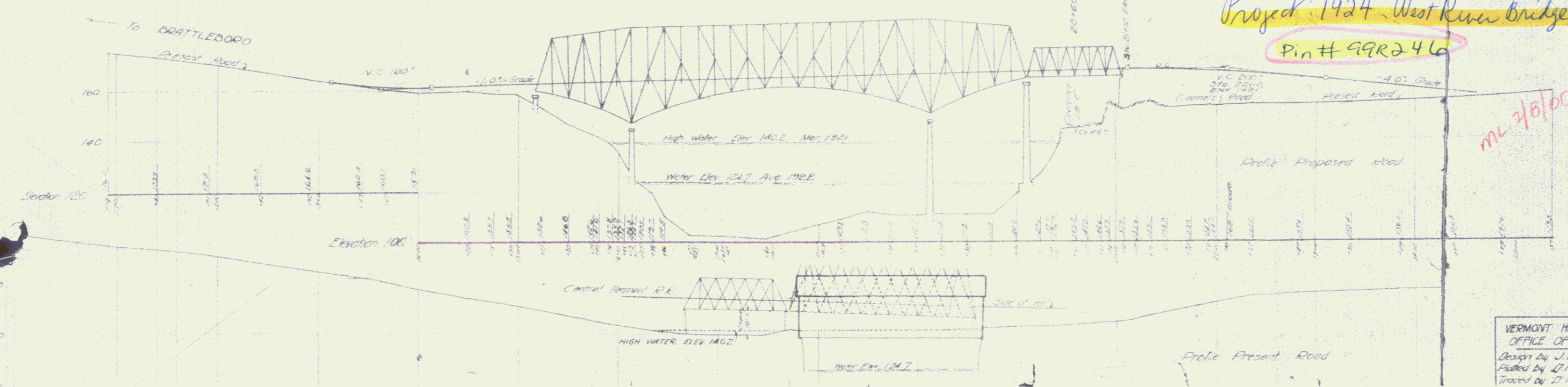

VERMONT HIGHWAY DEPARTMENT
 OFFICE OF CHIEF ENGINEER
 Design by J.L. Davis
 Plotted by J.M. Gentry Feb 4, 1924
 Traced by J.M. Gentry Feb 2, 1924