

INDEX OF SHEETS

SHEET NO. 1	TITLE PAGE
2	TYPICAL CROSS-SECTION OF IMPROVEMENT--2 1/2" BITUMINOUS CONCRETE PAVEMENT, ITEM 361 B
3	QUANTITY SHEET-ITEMS
4	QUANTITY SHEET-DRAINAGE
5	EARTHWORK SHEET
6-16	PLAN AND PROFILE
17	STANDARD STRUCTURE SHEET S-28 PIPE CULVERTS
18	" " " " S-30A STANDARD UNDERDRAIN
19	" " " " S-40 BARRICADES, SIGNS AND LIGHTS
20-27	CROSS SECTIONS

STATE OF VERMONT
STATE HIGHWAY DEPARTMENT

PLAN AND PROFILE OF PROPOSED
STATE HIGHWAY

VILLAGE OF BRATTLEBORO
ROUTE U.S. 5
MAIN STREET

BEGINNING AT THE INTERSECTION OF ROUTE U.S. 5 AND VERMONT ROUTE 30 AND EXTENDING SOUTHERLY 5150.0 FEET. (EXCLUDING 571.0 FEET)
LENGTH OF PROJECT: 4579.0 FT.=0.867 MILES

STANDARD STRUCTURE SHEETS APPROVED BY THE CHIEF ENGINEER
VERMONT STATE DEPT. OF HIGHWAYS
S-28 APRIL 26, 1941
S-30A APRIL 19, 1941
S-40 DEC. 18, 1945

POST WAR F A PRIMARY

FED. ROAD DIST. NO.	STATE	F. YEAR	F. SHEET NO.	TOTAL SHEETS
9	Vt.	59(4)	1	27

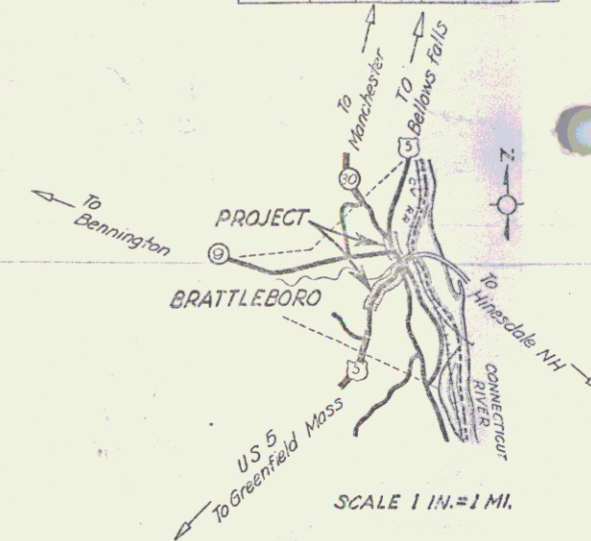

(To Be Returned To R.O.W. Division)
Town of U.S.
PERPETUAL
E.I.I.E.N.M.O.I.
HIGHWAY DIVISION

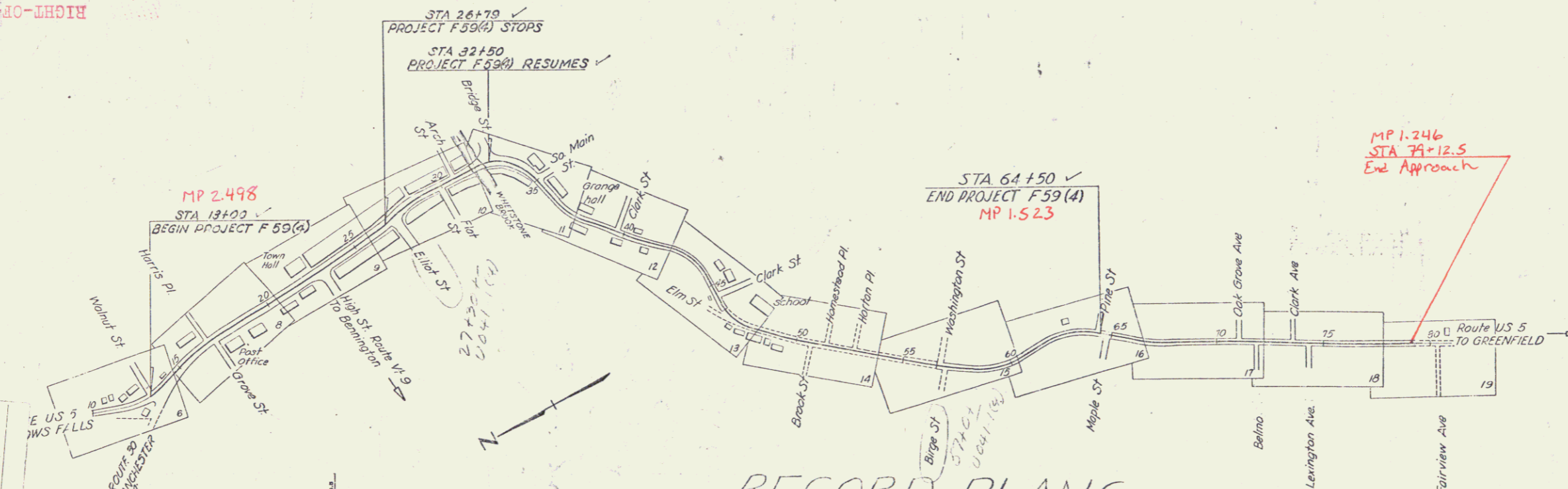

PROJECT	Brattleboro
DESIGNED BY	F. L. Dudley
TYPE	U.S. 5, B.T. Co., National
CONTRACTOR	Cross with Const. Co.
LOCATION	Sec. 4/7
DATE	Completed 4/17 Year 1949

GROUND ELEVATION	DATUM	LINE
GRADE ELEVATION	DATUM	LINE

CURVE DATA

DEFLECTION ANGLE Δ
DEGREE OF CURVE D
RADIUS OF CURVE R
TANGENT DISTANCE T
LENGTH OF CURVE L
EXTERNAL DISTANCE E
POINT OF INTERSECTION P. I.
POINT OF CURVE P. C.
POINT OF TANGENT P. T.
POINT ON TANGENT P. O. T.

SCALES

TITLE	1" = 300'
TYPICAL	1" = 20'
PLAN	1" = 20'
PROFILE HORIZONTAL	1" = 20'
PROFILE VERTICAL	1" = 10'
CROSS SECTIONS	1" = 5'

RECORD PLANS
Resident Engineer F. L. Dudley
Prepared Under the Direction of
F. L. Dudley by M. L. Bliss
June 1949

APPROVED: 6 JUL 49
F. L. Dudley
COMMISSIONER OF HIGHWAYS
SUBMITTED BY ORDER OF THE STATE HIGHWAY BOARD

THESE PLANS ARE SUBJECT TO SUCH REVISIONS AS MAY BE REQUIRED BY THE PUBLIC ROADS ADMINISTRATION OR THE COMMISSIONER OF HIGHWAYS.
CONSTRUCTION IS TO BE CARRIED ON IN ACCORDANCE WITH THE PLANS AND THE STANDARD ROAD AND BRIDGE SPECIFICATIONS OF 1938, AS APPROVED DECEMBER 29, 1936 BY THE PUBLIC ROADS ADMINISTRATION, INCLUDING ALL SUBSEQUENT APPROVED REVISIONS AND SUCH REVISED SPECIFICATIONS AND SPECIAL PROVISIONS AS ARE SUBMITTED WITH THE PLANS.

APPROVED 5 JUL 49 <i>F. L. Dudley</i> HIGHWAY ENGINEER	APPROVED July 7, 1949 <i>F. L. Dudley</i> DISTRICT HIGHWAY COMMISSIONER	SERIES F No. 59(4) FILED SHEET 1 OF 7
--	---	--

STEARNS R. JENKINS US 5

Δ 39°-08' Lt.
 D 16'
 R 359.3
 T 122.2
 L 244.4
 E 21.9



ESTIMATED QUANTITIES

BRATTLEBORO VILLAGE

Surveyed by: Pajor January 1953
 Designed by: Pajor February 1953
 Drawn by: Houghton March 1953
 Checked by: Pajor
 Series F No. 59 (4) Filed
 Sheet 6 of 27 Sheets

ERECTION OF PROJECT MARKERS, ITEM 586

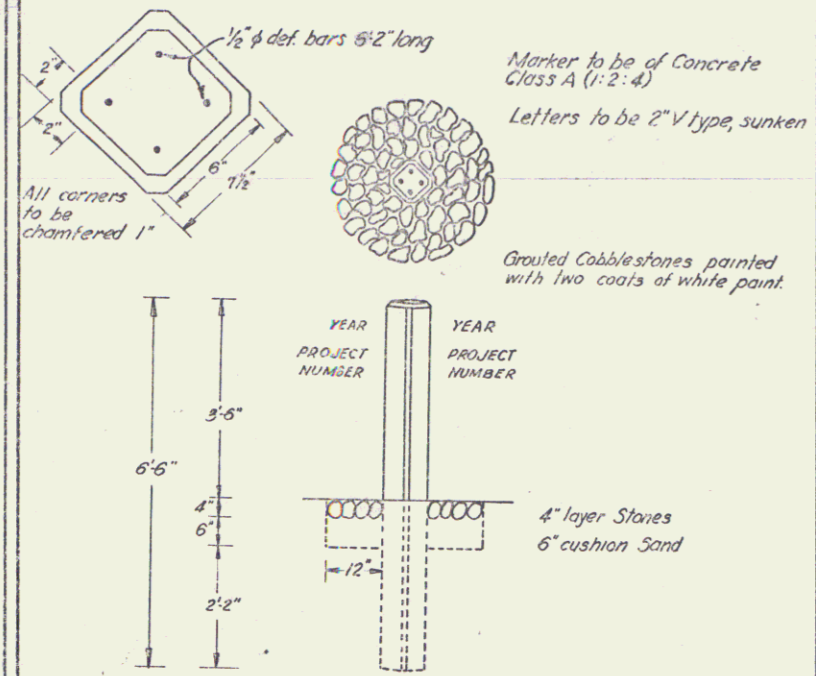

DETAILS OF RAMP CONSTRUCTION AT DRIVES 46+25-56+53

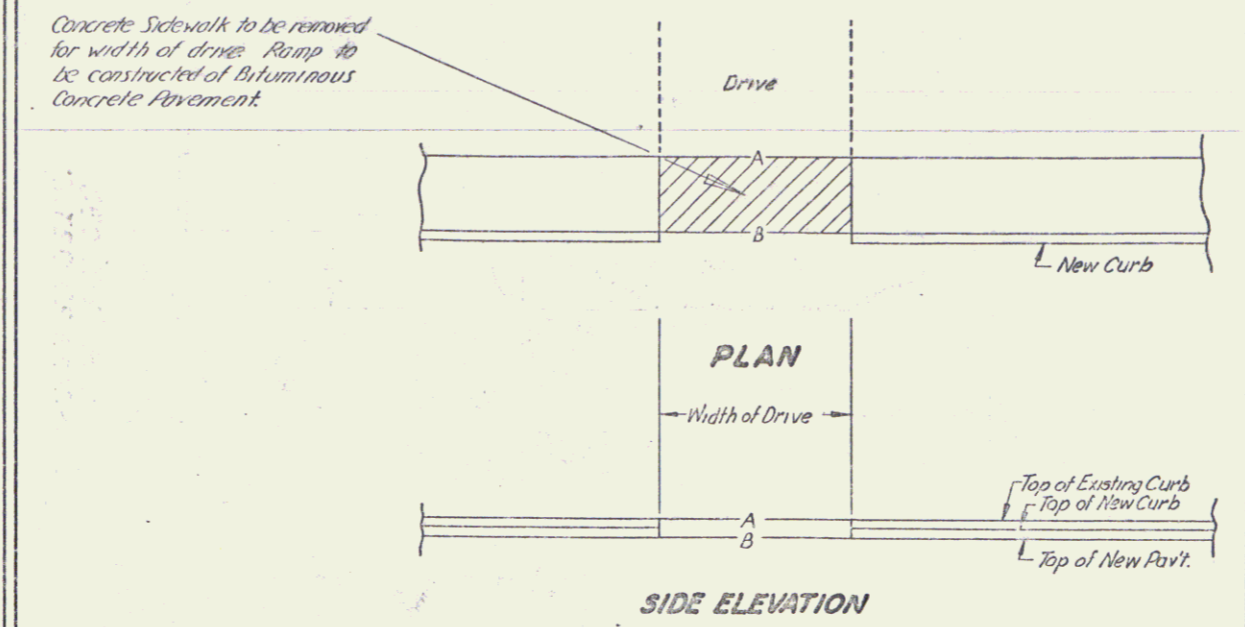

1/49
Royer
TITLE
DATE
BY
CHECKED
NO.

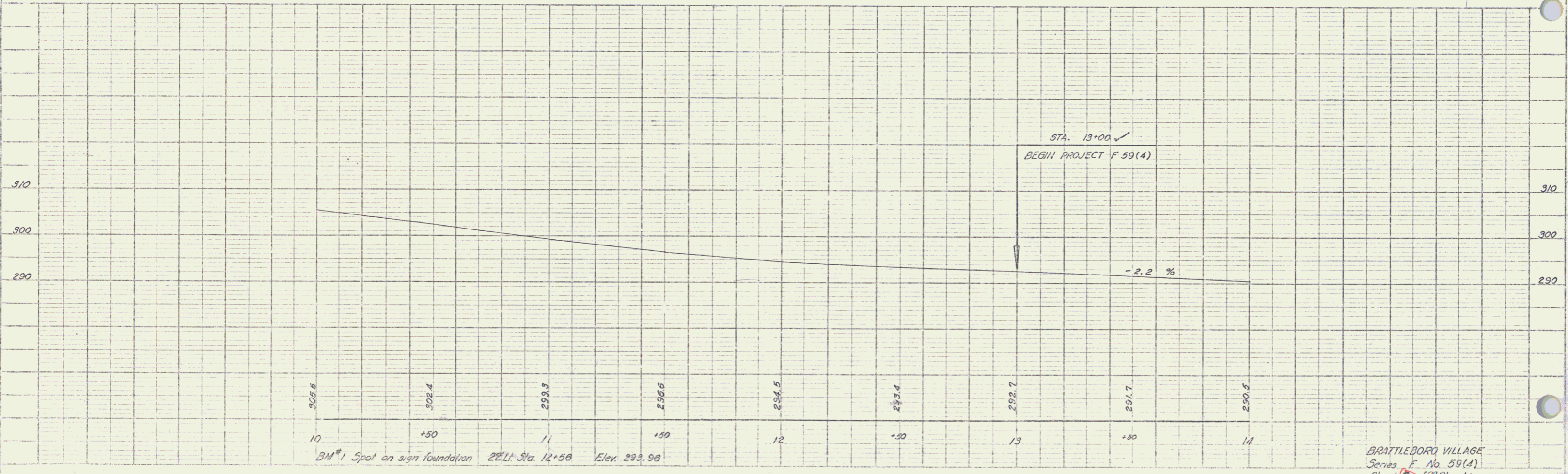

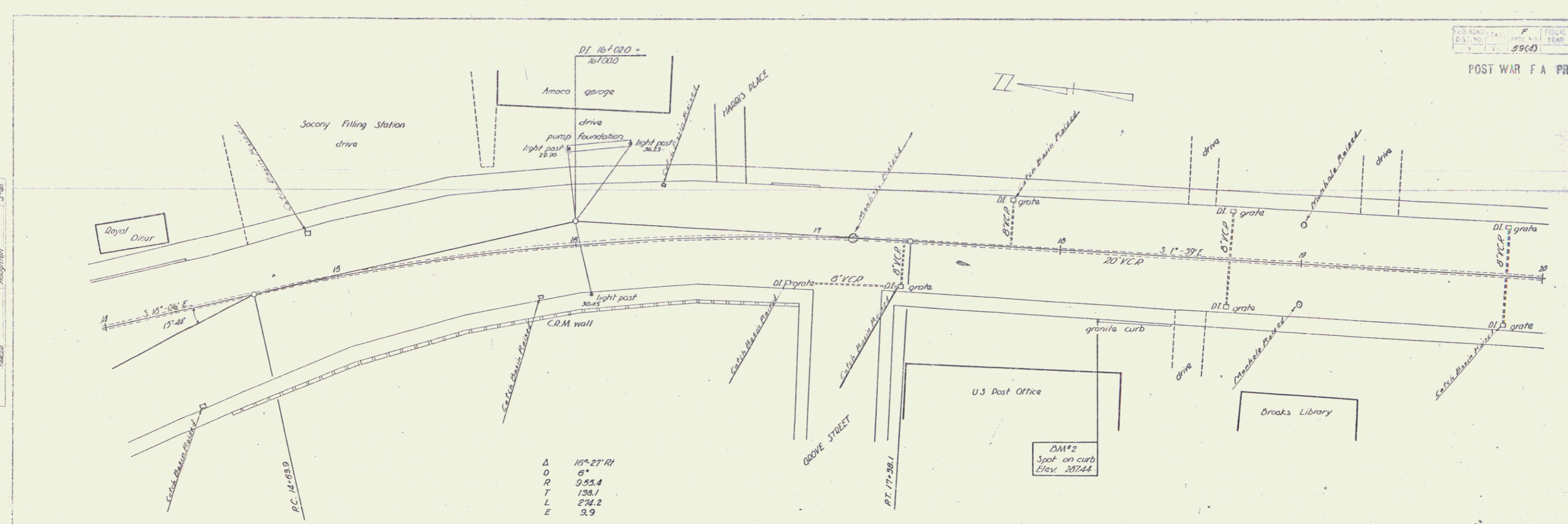

Δ 15° 27' 41"
 D 6"
 R 955.4
 T 138.1
 L 274.2
 E 3.9

DATE: 10/1/54
 DRAWN BY: J. M. HAYES
 CHECKED BY: J. M. HAYES
 PROJECT: DRAUGHTS
 SHEET: 27

DATE: 10/1/54
 DRAWN BY: J. M. HAYES
 CHECKED BY: J. M. HAYES
 PROJECT: DRAUGHTS
 SHEET: 27

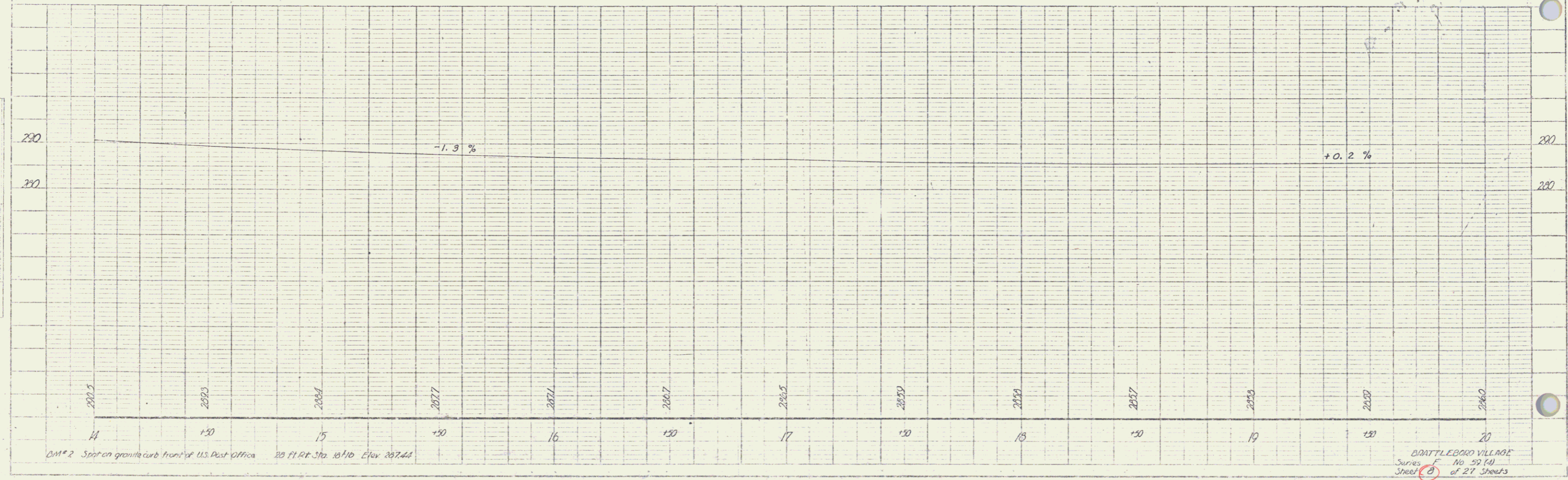

DM#2 Spot on granite curb front of U.S. Post Office 20 FT. RT. Sta. 16+10 Elev. 207.44

DRAUGHTS VILLAGE
 Series F No. 27 (4)
 Sheet 27 of 27 Sheets

PLAT
 DRAWN BY
 CHECKED BY
 DATE
 NO.

DRAWN BY
 CHECKED BY
 DATE
 NO.

59(4) 9 27
 POST WAR F A PRIMARY

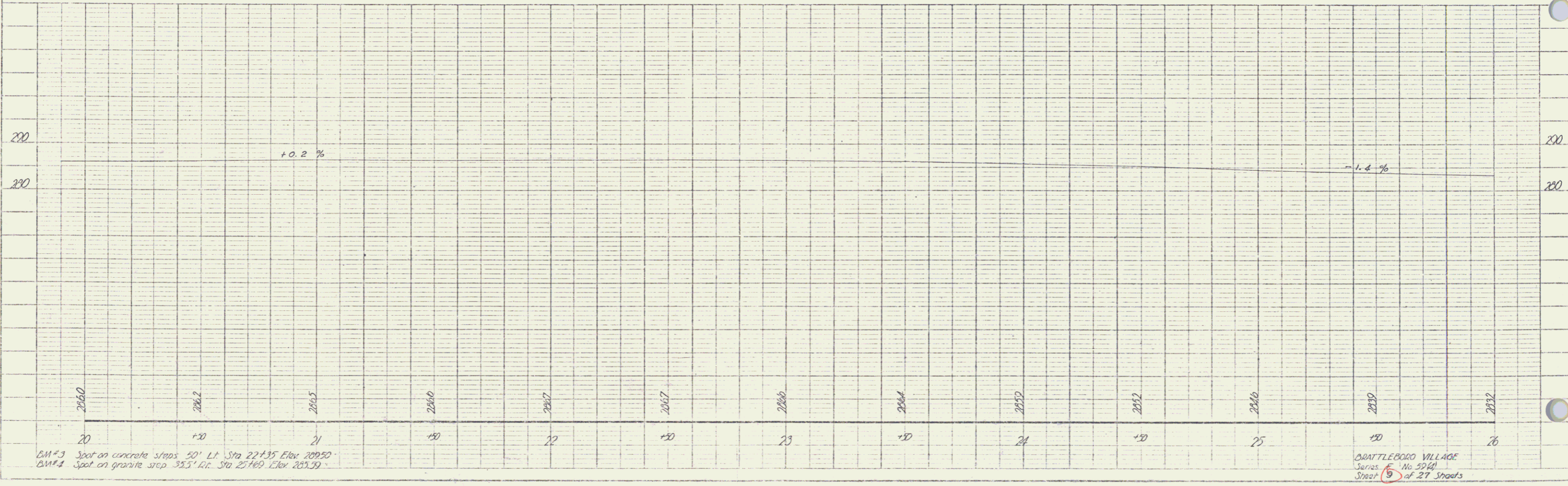
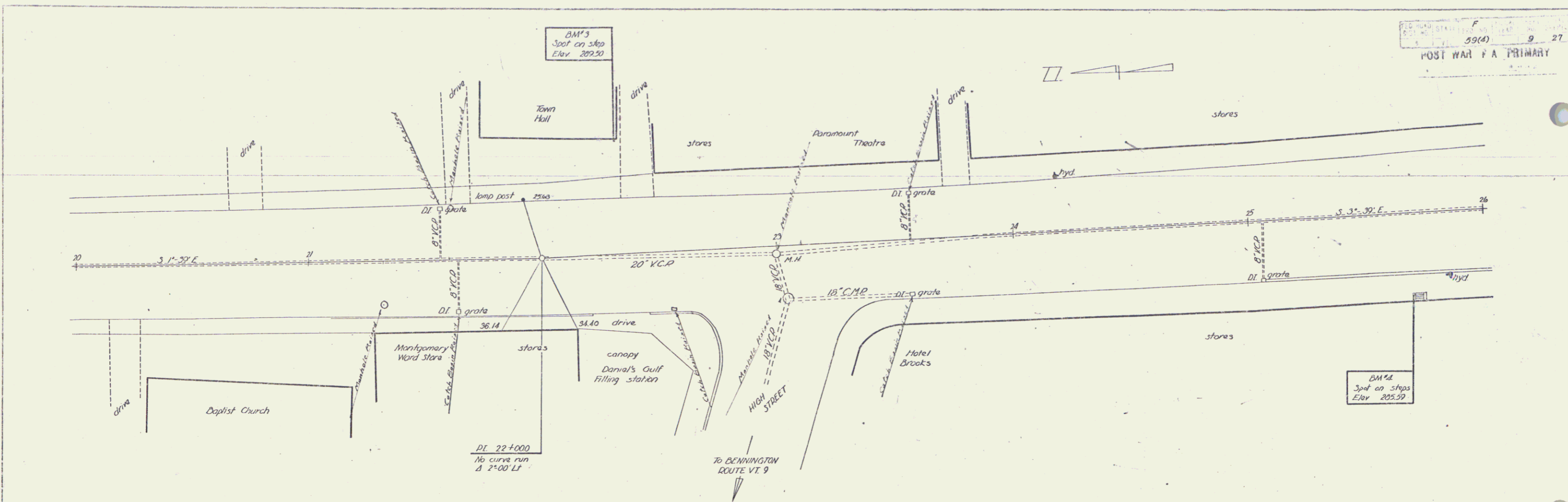

BM#3 Spot on concrete steps 50' L_R Sta 22+35 Elev 289.50
 BM#4 Spot on granite step 355' L_R Sta 25+60 Elev 285.50

BATTLEBOGO VILLAGE
 Series F No. 59(4)
 Sheet 9 of 27 Sheets

SCALE
 HORIZONTAL
 VERTICAL

PLAN
 SHEET NO. 10
 DATE 10/27/47
 DRAWN BY [unclear]
 CHECKED BY [unclear]

PLAN
 SHEET NO. 10
 DATE 10/27/47
 DRAWN BY [unclear]
 CHECKED BY [unclear]

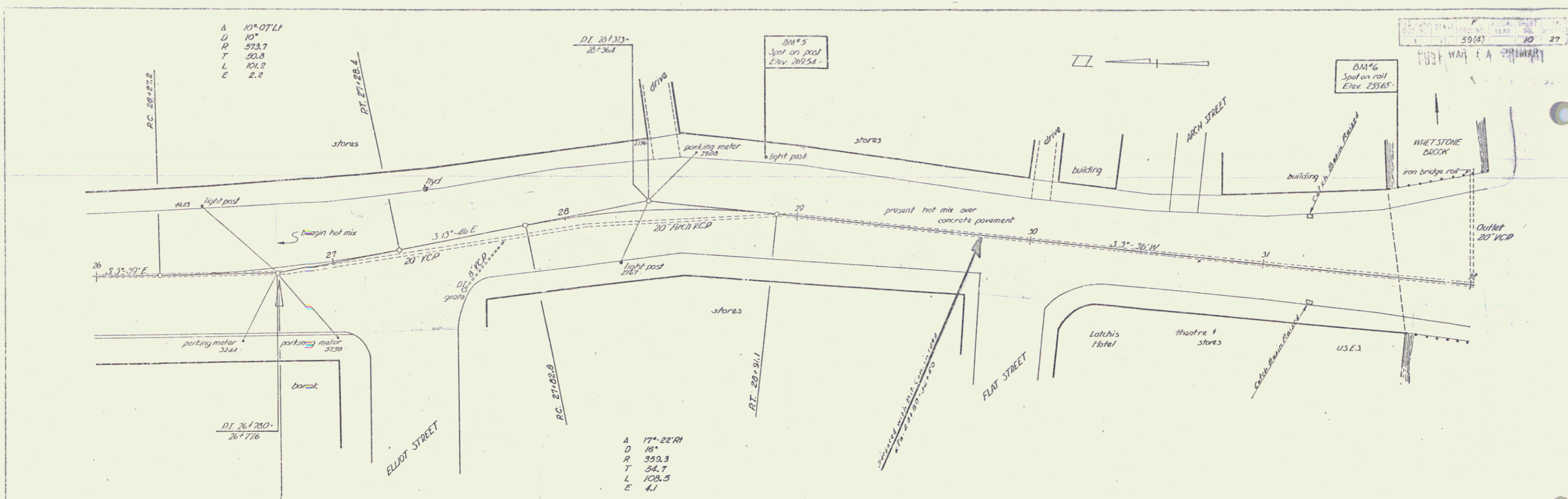

A 10° 07' L
 D 10"
 R 593.7
 T 52.9
 L 101.2
 E 2.2

A 17° 22' R
 D 16"
 R 359.3
 T 54.7
 L 108.5
 E 4.1

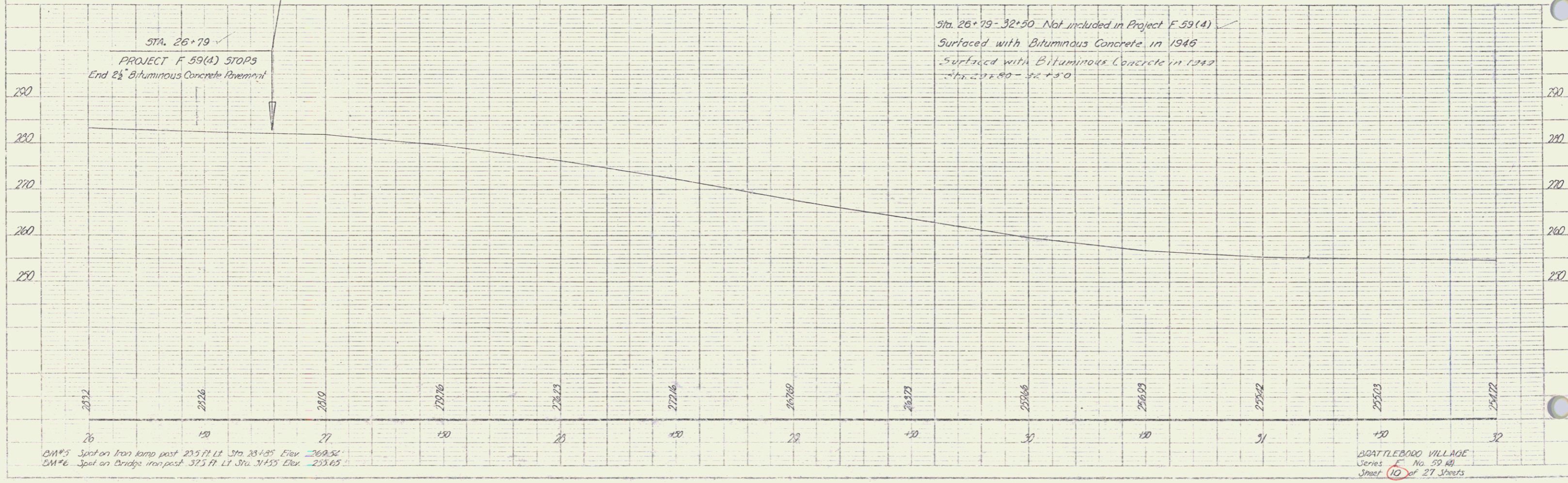

DM#5 Spot on Iron lamp post 23.5 ft LI Sta. 26+95 Elev. 269.52
 DM#6 Spot on Dredge iron post 37.5 ft LI Sta. 31+55 Elev. 255.65

SEATTLEBORO VILLAGE
 Series F No. 59 (4)
 Sheet 10 of 27 Sheets

PLAN
 NO. 100
 DATE 1/14/48
 DRAWN BY [unclear]
 CHECKED BY [unclear]

TITLE
 PROJECT F 59(4) RESUMES
 BRATTLEBORO VILLAGE
 SHEET 11 OF 27 SHEETS

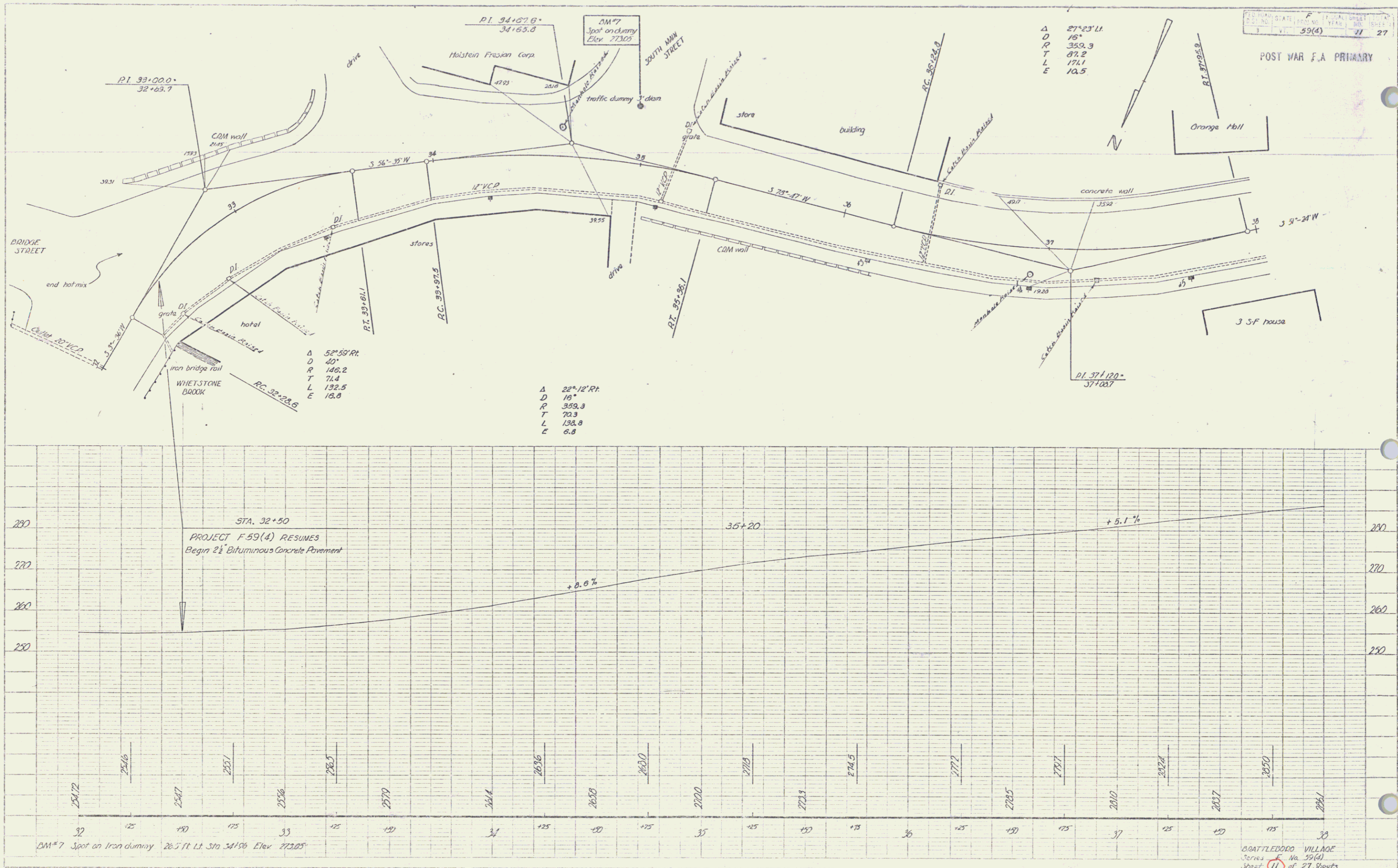

Δ 27°23' Lt
 D 18'
 R 359.3
 T 47.2
 L 171.1
 E 10.5

Δ 52°55' Rt
 D 40'
 R 146.2
 T 71.4
 L 132.5
 E 16.8

Δ 22°12' Rt
 D 16'
 R 359.3
 T 70.3
 L 138.8
 E 6.8

STATE OF VERMONT
 PROJECT NO. 59(4) SHEET NO. 11 OF 27

POST WAR F.A. PRIMARY

BRATTLEBORO VILLAGE
 Series No. 59(4)
 Sheet 11 of 27 Sheets

7

Δ 8°00' LI
 D 4°
 R 716.0
 T 34.1
 L 101.9
 E 1.8

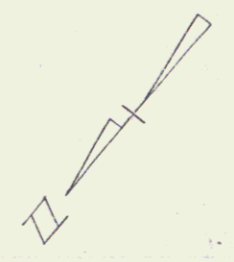

PLAN	DESCRIPTION
1	Proposed
2	As Shown
3	As Shown
4	As Shown
5	As Shown
6	As Shown
7	As Shown
8	As Shown
9	As Shown
10	As Shown
11	As Shown
12	As Shown
13	As Shown
14	As Shown
15	As Shown
16	As Shown
17	As Shown
18	As Shown
19	As Shown
20	As Shown
21	As Shown
22	As Shown
23	As Shown
24	As Shown
25	As Shown
26	As Shown
27	As Shown
28	As Shown
29	As Shown
30	As Shown
31	As Shown
32	As Shown
33	As Shown
34	As Shown
35	As Shown
36	As Shown
37	As Shown
38	As Shown
39	As Shown
40	As Shown
41	As Shown
42	As Shown
43	As Shown
44	As Shown
45	As Shown
46	As Shown
47	As Shown
48	As Shown
49	As Shown
50	As Shown
51	As Shown
52	As Shown
53	As Shown
54	As Shown
55	As Shown
56	As Shown
57	As Shown
58	As Shown
59	As Shown
60	As Shown
61	As Shown
62	As Shown
63	As Shown
64	As Shown
65	As Shown
66	As Shown
67	As Shown
68	As Shown
69	As Shown
70	As Shown
71	As Shown
72	As Shown
73	As Shown
74	As Shown
75	As Shown
76	As Shown
77	As Shown
78	As Shown
79	As Shown
80	As Shown
81	As Shown
82	As Shown
83	As Shown
84	As Shown
85	As Shown
86	As Shown
87	As Shown
88	As Shown
89	As Shown
90	As Shown
91	As Shown
92	As Shown
93	As Shown
94	As Shown
95	As Shown
96	As Shown
97	As Shown
98	As Shown
99	As Shown
100	As Shown

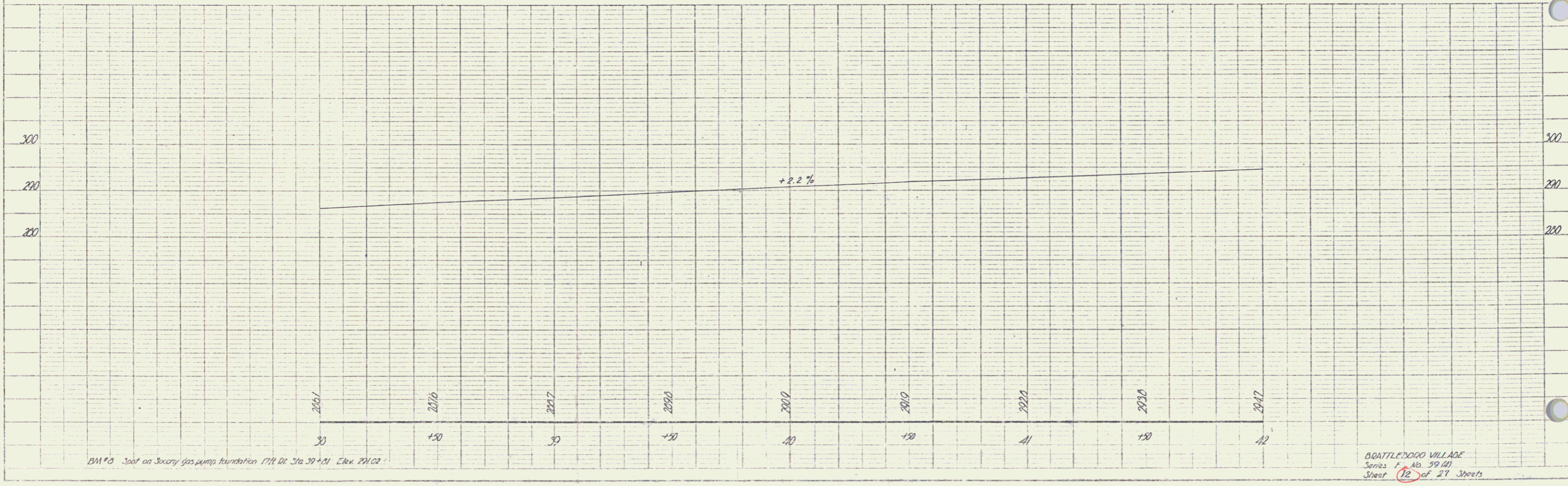
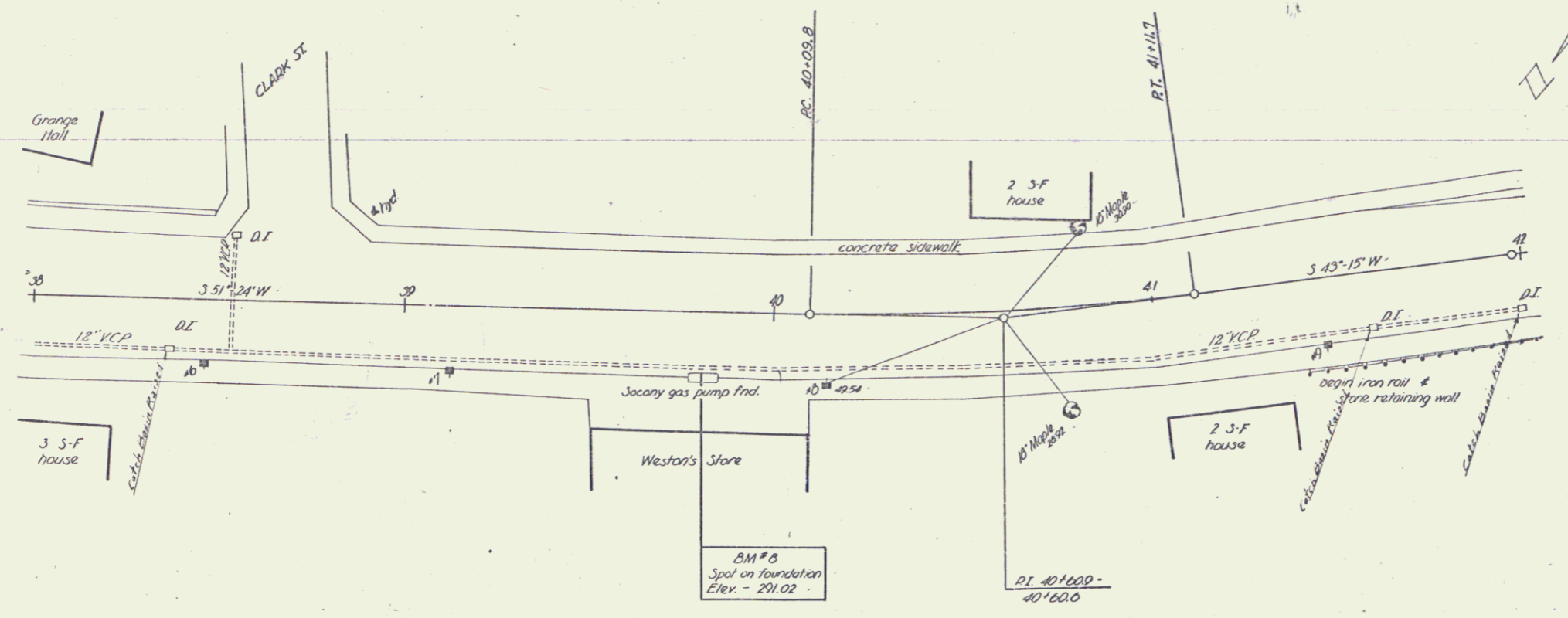

BM # B Spot on Society gas pump foundation IPR D.I. Sta 39+21 Elev. 291.02

PLAN
 DATE 1/20/59
 DRAWN BY [illegible]
 CHECKED BY [illegible]

PROJECT
 BATTLECO VILLAGE
 NOTE: SEE SHEET 112 FOR BENCHMARK DATA

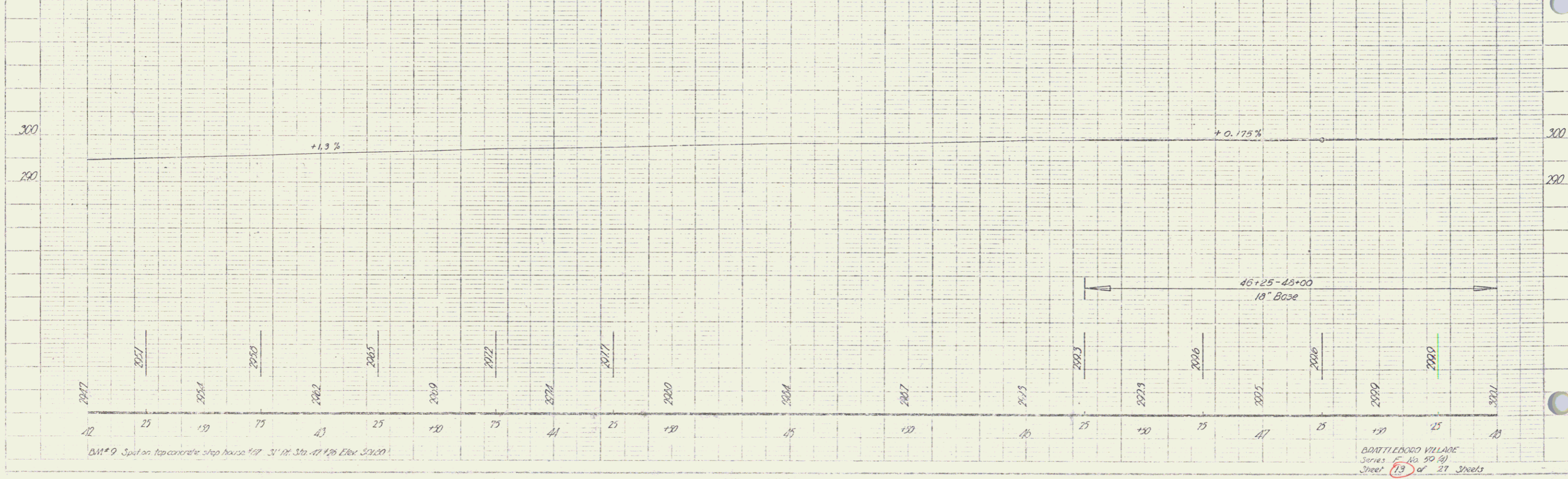
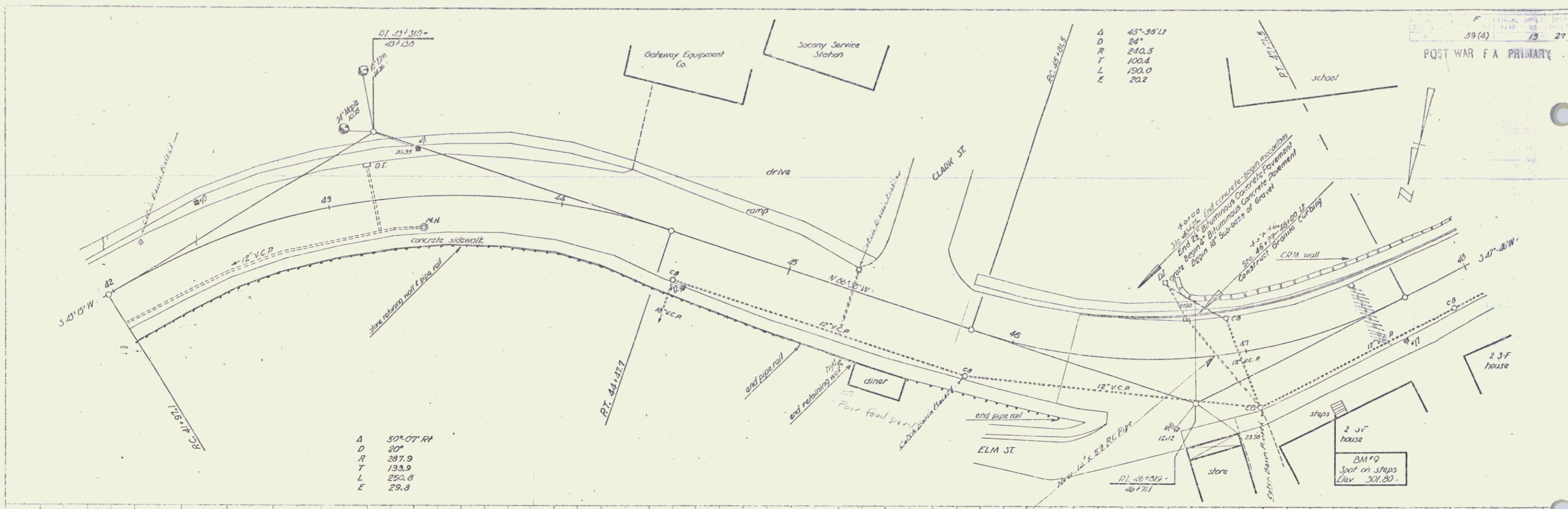

PLAN
 DATE: 1/15/59
 DRAWN BY: [illegible]
 CHECKED BY: [illegible]

POST WAR F.A. PRIMARY
 DATE: 1/15/59
 DRAWN BY: [illegible]
 CHECKED BY: [illegible]

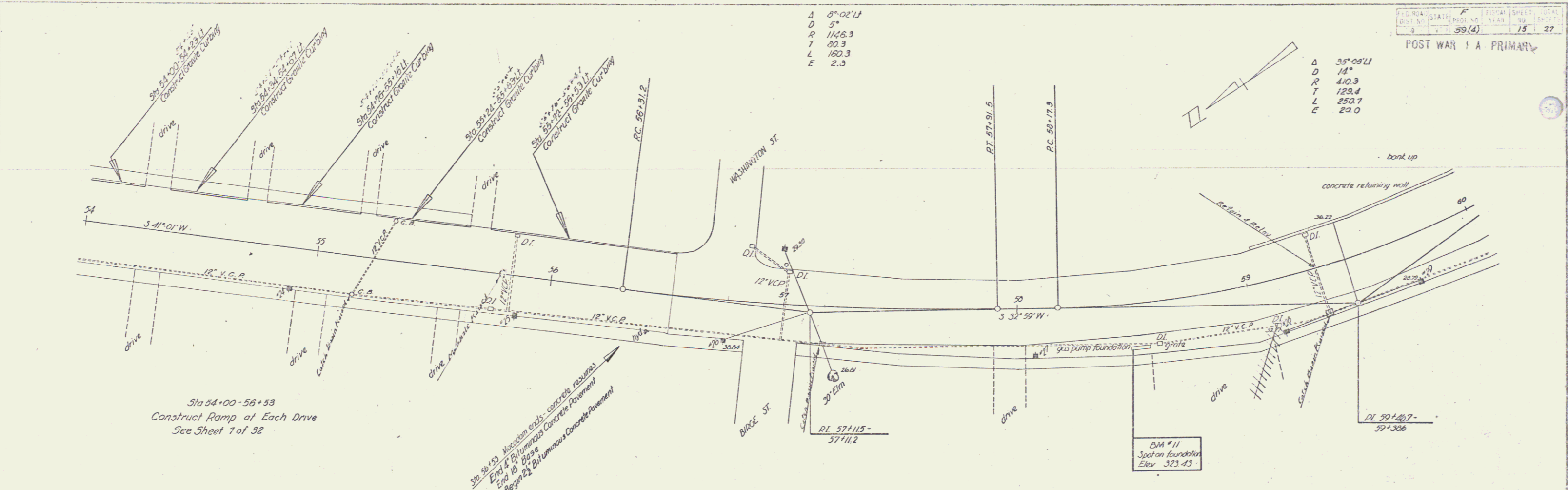

Δ 8°-02'11"
 D 5'
 R 1146.3
 T 80.3
 L 180.3
 E 2.3

Δ 35°-08'11"
 D 14'
 R 410.3
 T 129.4
 L 250.7
 E 23.0



SEATTLE BORO VILLAGE
 Series F No 59 (64)
 Sheet 15 of 27 Sheets

PROJECT: *Adaptation*
 SHEET: *16*
 DATE: *4-64*

PROJECT: *Adaptation*
 SHEET: *16*
 DATE: *4-64*

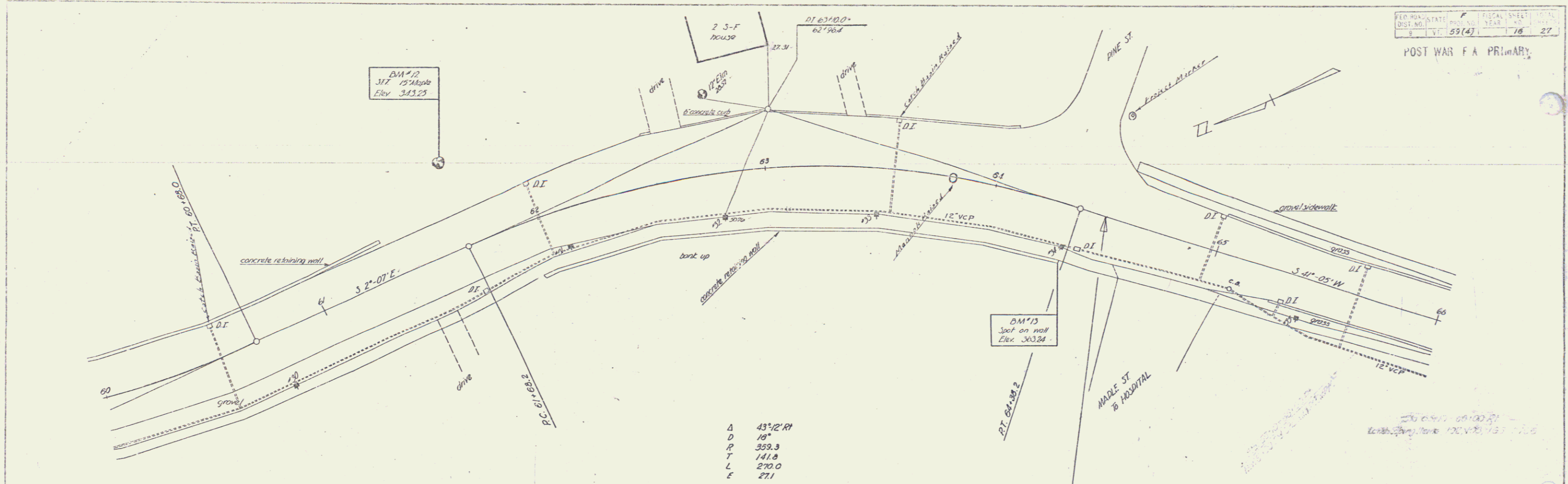

Δ	43°12'RI
D	16'
R	309.3
T	141.8
L	270.0
E	271

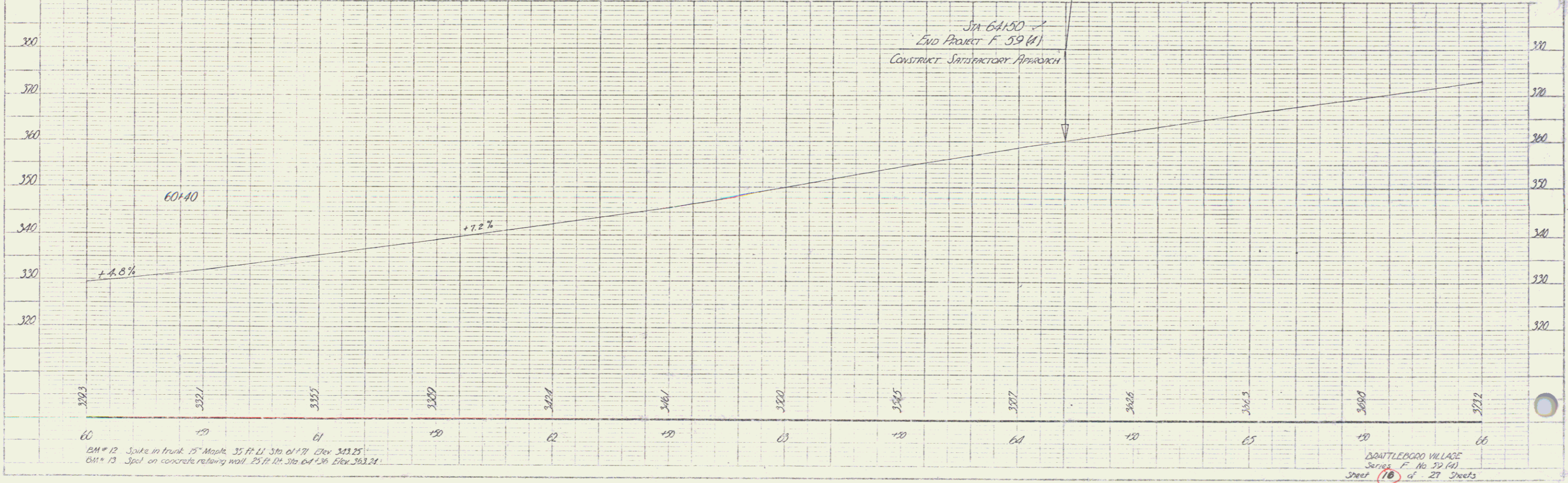

BM # 12 Spike in front 15" Manhole 35 Ft. L1 Sta. of 171 Elev. 343.25
 BM # 13 Spot on concrete retaining wall 25 Ft. L1 Sta. of 136 Elev. 303.24

QUATTLEBORO VILLAGE
 Series F No. 32 (4)
 Sheet 16 of 27 Sheets

PLAN
 DATE 1/24/60
 DRAWN BY [Signature]
 CHECKED BY [Signature]
 PROJECT [Signature]

PLAN
 DATE 1/24/60
 DRAWN BY [Signature]
 CHECKED BY [Signature]
 PROJECT [Signature]

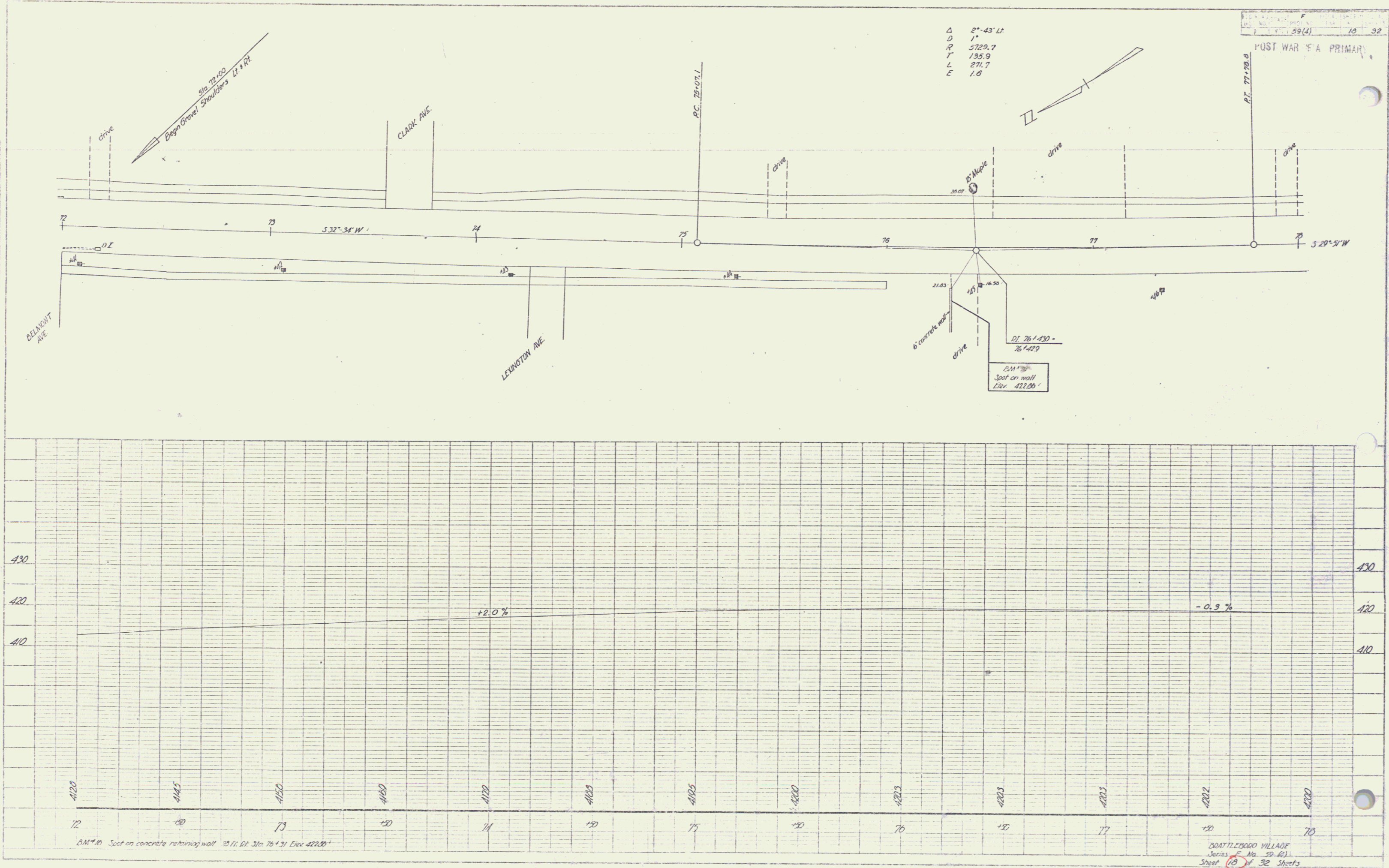

39(4) 18 32
 POST WAR 'A' PRIMARY

DOATLEBODD VILLAGE
 Series No. 39(4)
 Sheet 18 of 32 Sheets

148

