

Prepared by: E.A. Rogers
 Date: 8/18/39
 Checked by: E.A. Rogers
 Date: 8/18/39

Scale: 1" = 40'

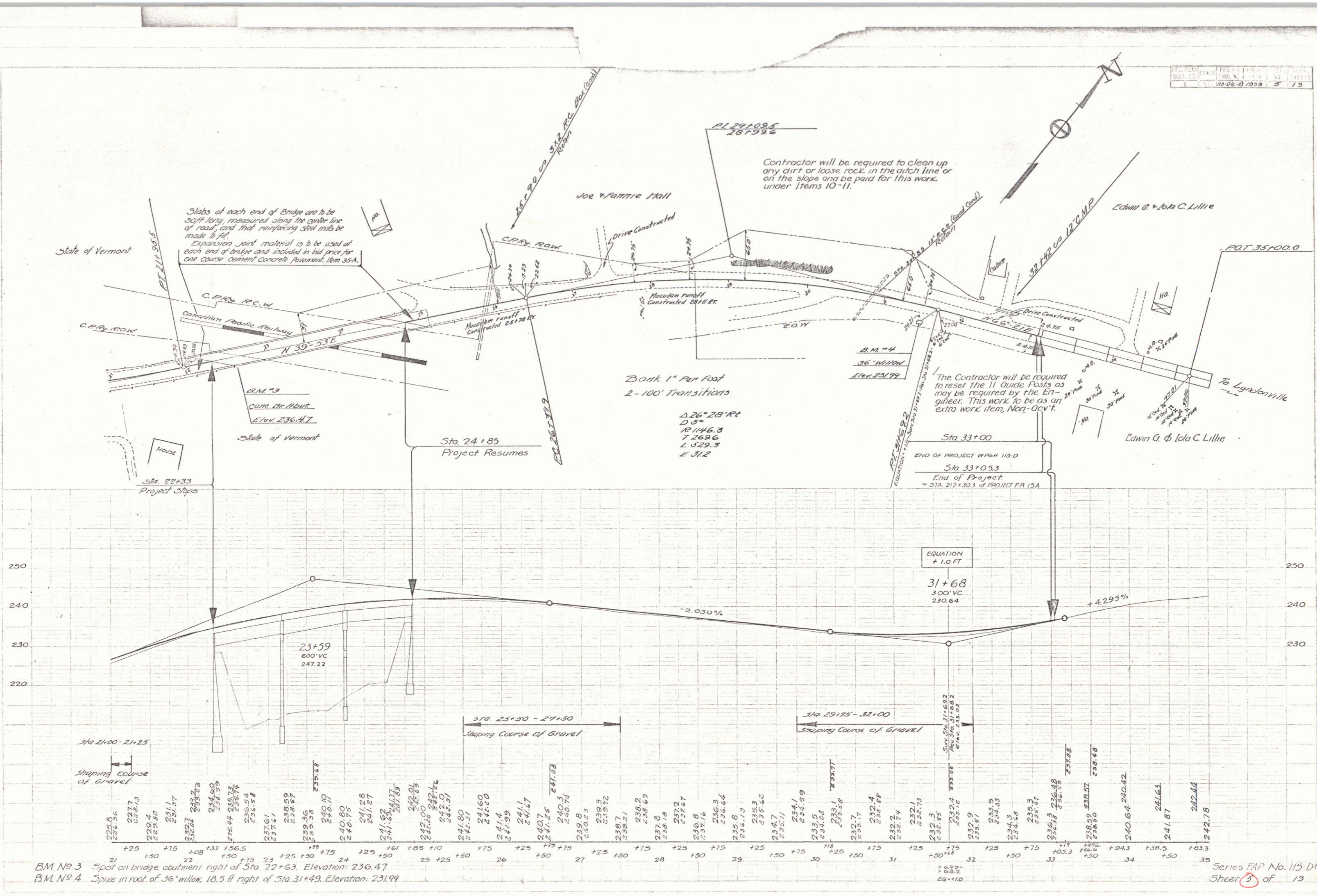

BM No 3 Spot on bridge abutment right of Sta 22+63. Elevation: 236.47
 BM No 4 Spike in root of 36" willow, 18.5 ft right of Sta. 31+49. Elevation: 231.99