

Barrett P.O.
Project
Notes
Date
Scale
Sheet

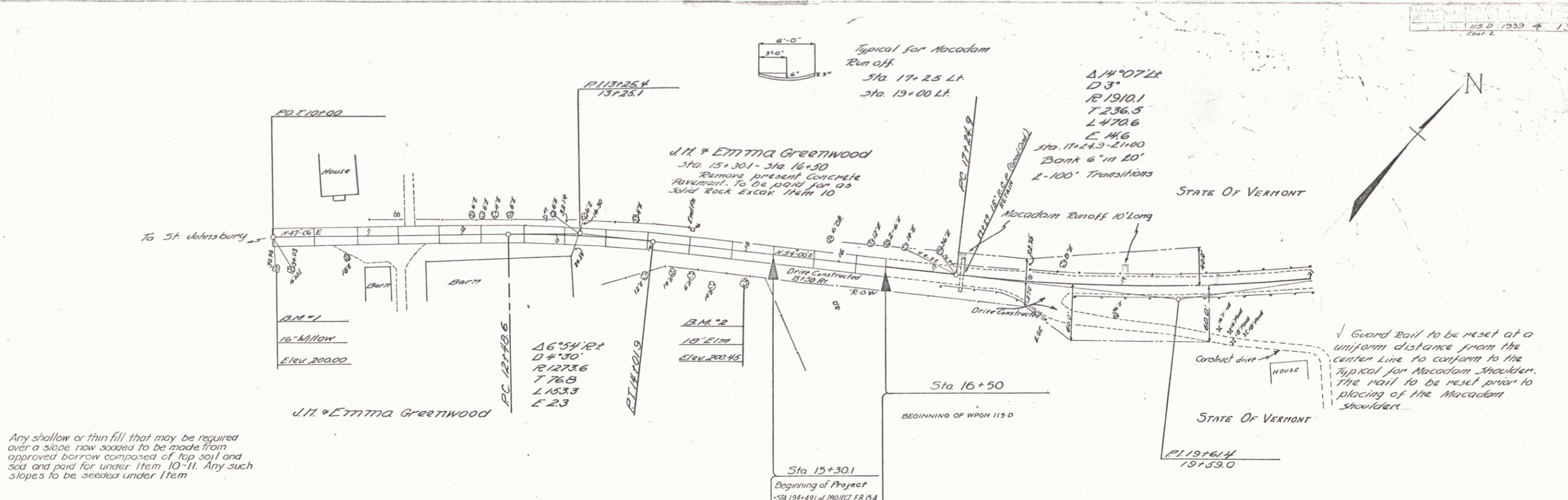

Any shallow or thin fill that may be required over a slope now scooped to be made from approved borrow composed of top soil and sod and paid for under Item 10-11. Any such slopes to be seeded under Item

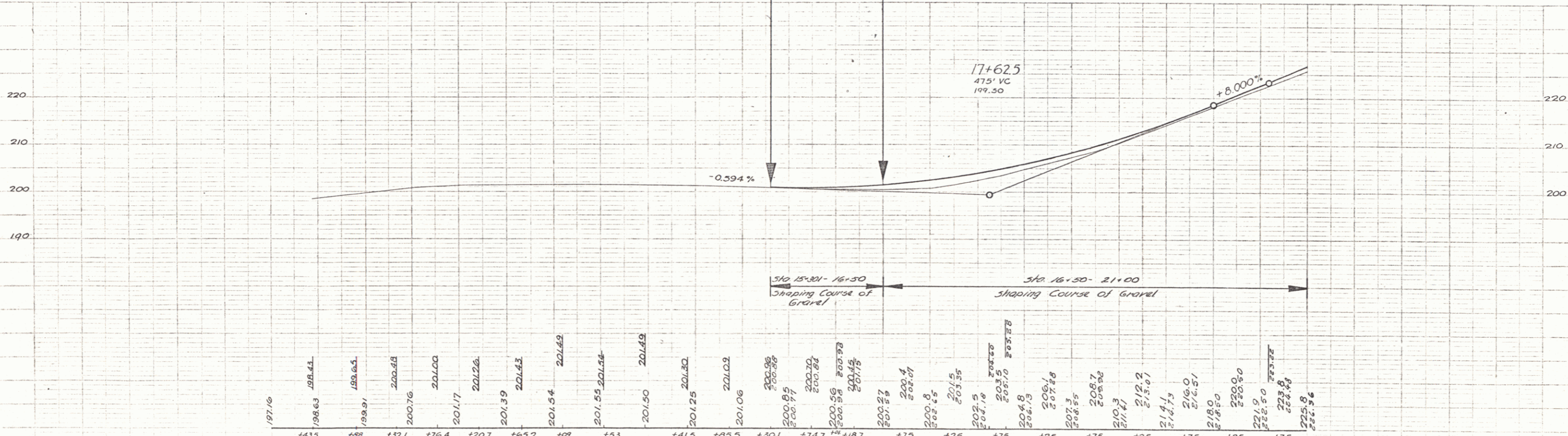

B.M. No 1 Spike in 16' willow 31 ft right of Sta. 10+00. Elevation: 200.00
 B.M. No 2 Spike in root of 18' elm, 27 ft right of Sta. 15+02. Elevation: 200.45

2