

Sta. 342+00 to 351+00
 East Bridge Approach washed out during flood of
 And since that date has been filled, and 2-48" Cor
 Metal Pipes installed.

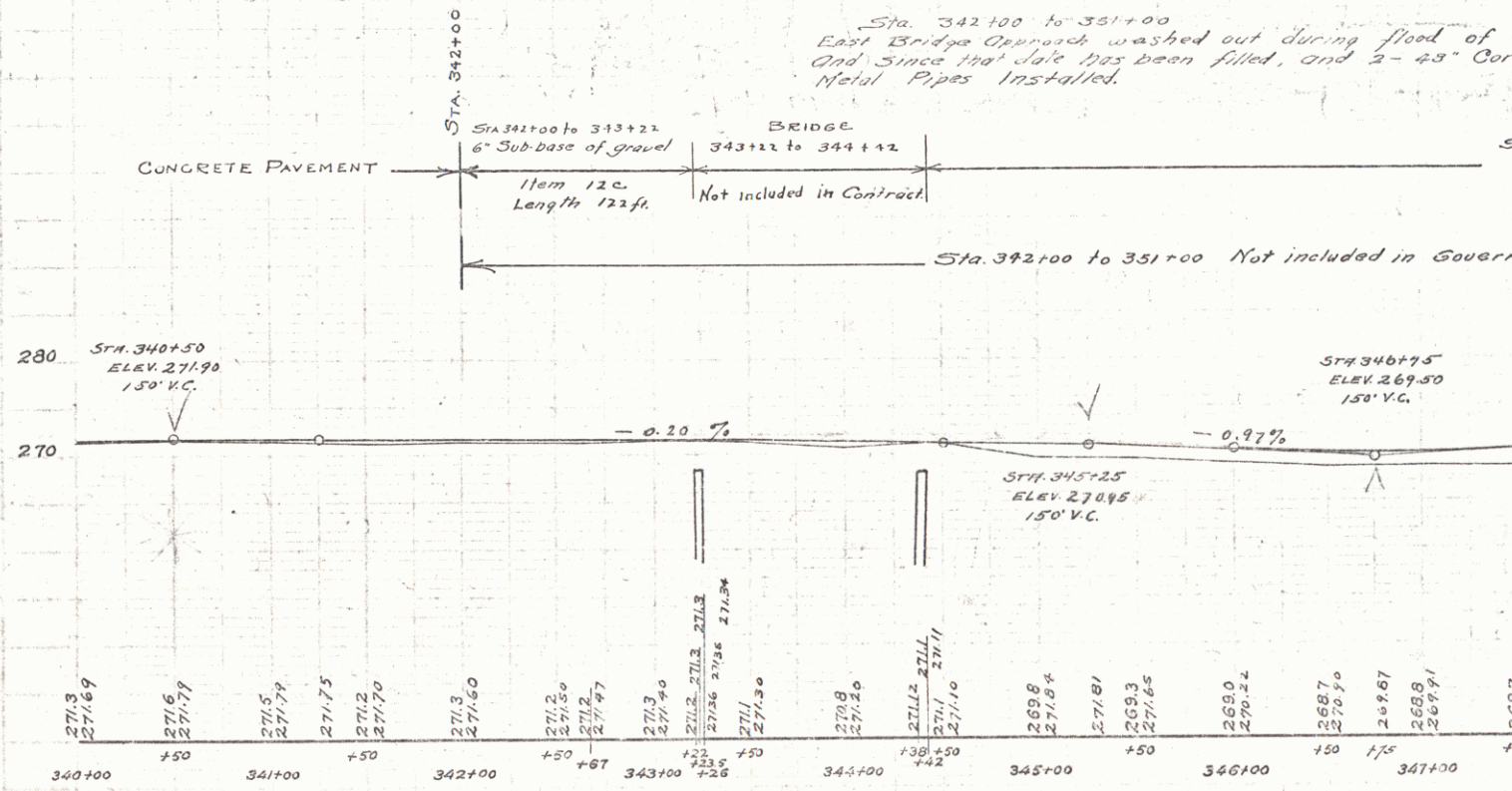

B.M. No. 37 Spike in Root 18" Elm. Right of Sta. 347+40 Elev. 268.44
 " " 38 " " " 12" " " " " 353+82 " 278.85