

MURPHY REALTY CO., INC.
ST. JOHNSBURY, VERMONT

PRICE CHOPPER SUPERMARKET

Route: U.S. ROUTE 5 ROADWAY IMPROVEMENTS

Town: ST. JOHNSBURY, VERMONT

Proj # 99R228

Project: PC Supermarket

MP 3.571-3.723

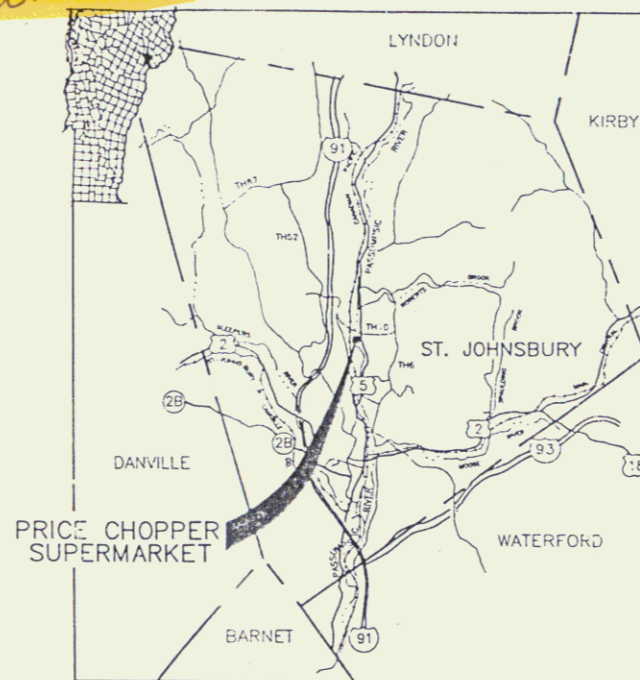

LOCATION PLAN

SCALE: 1" = .67 MILES

RIGHT-OF-WAY DIVISION
TOWN FILE
PERPETUAL
Town of St J US5
(To Be Returned To R.O.W. Division)

LIST OF STANDARD SHEETS

B-71	RESIDENTIAL AND COMMERCIAL DRIVES	12-11-82 R
D-2	UNDERDRAIN & CARRIER PIPE CONSTRUCTION DETAILS	10-30-85 R
D-6	REINFORCED CONCRETE DROP INLET W/GRATE (DITCHES)	04-04-73
D-8	REINFORCED CONCRETE DROP INLET W/PRECAST COVER & GRATE (BOTTOM SECTION)	12-06-71
D-11	GRATES & COVERS (TYPE A)	08-24-81 R
D-15	CAST IRON GRATE W/FRAME, TYPE E	02-7-93 R
C-9	UTILITY WORK ZONE	02-01-86 R
E-100	CONSTRUCTION APPROACH SIGNS	10-21-92 R
E-101	CONSTRUCTION SIGN DETAILS	10-21-92 R
E-102	CONSTRUCTION SIGN DETAILS	10-21-92 R
E-103	TRAFFIC CONTROL - MISCELLANEOUS DETAILS	09-20-93 R
E-107	DELINEATION, BARRIQUES AND DETOURS FOR CONSTRUCTION AREAS	09-20-93 R
E-107A	BREAKAWAY BARRICADE DETAILS	09-20-93 R
E-110	MAJOR MAINTENANCE OPERATION LANE CLOSURE	09-20-93 R
E-121	STANDARD SIGN PLACEMENT - CONVENTIONAL ROAD	01-23-89 R
E-123	GUIDE SIGN PLACEMENT - MISCELLANEOUS DETAILS	01-23-89 R
E-127	ROUTE MARKINGS AT RURAL INTERSECTION	12-18-89
E-135	INTERSTATE ROUTE MARKER - SIGN DETAIL	01-13-93 R
E-136	U.S. AND STATE ROUTE MARKER SIGN DETAILS	01-13-93 R
E-144	REGULATORY SIGN DETAILS	01-23-89
E-152	WARNING SIGN DETAILS	10-21-92 R
E-160	FLANGED CHANNEL STEEL SIGN POST DETAIL	10-21-92 R
E-162	TUBULAR ALUMINUM SIGN POST	10-21-92 R
E-191	PAVEMENT MARKING DETAILS	01-23-89 R
T-1	TEMPORARY EROSION CONTROL DETAILS	12-07-76 R
T-2	TEMPORARY EROSION CONTROL DETAILS	07-05-72

LIST OF DRAWINGS

NAME	SHEET NO.
TITLE SHEET	1
TYPICAL SECTIONS & DETAILS	2-3
ROADWAY LAYOUT, GRADING & DRAINAGE PLAN	4-8
PROFILE SHEET	7
PAVEMENT MARKING & SIGNING PLAN	8-9
TRAFFIC SIGN SUMMARY SHEET	10
TRAFFIC CONTROL PLAN	11
CROSS-SECTION SHEETS	12-13

DuBois & King Inc.

engineering
planning
management
development

3/8/2000 checked & 1/13/95

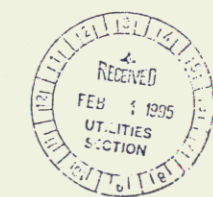

FOR APPROVAL

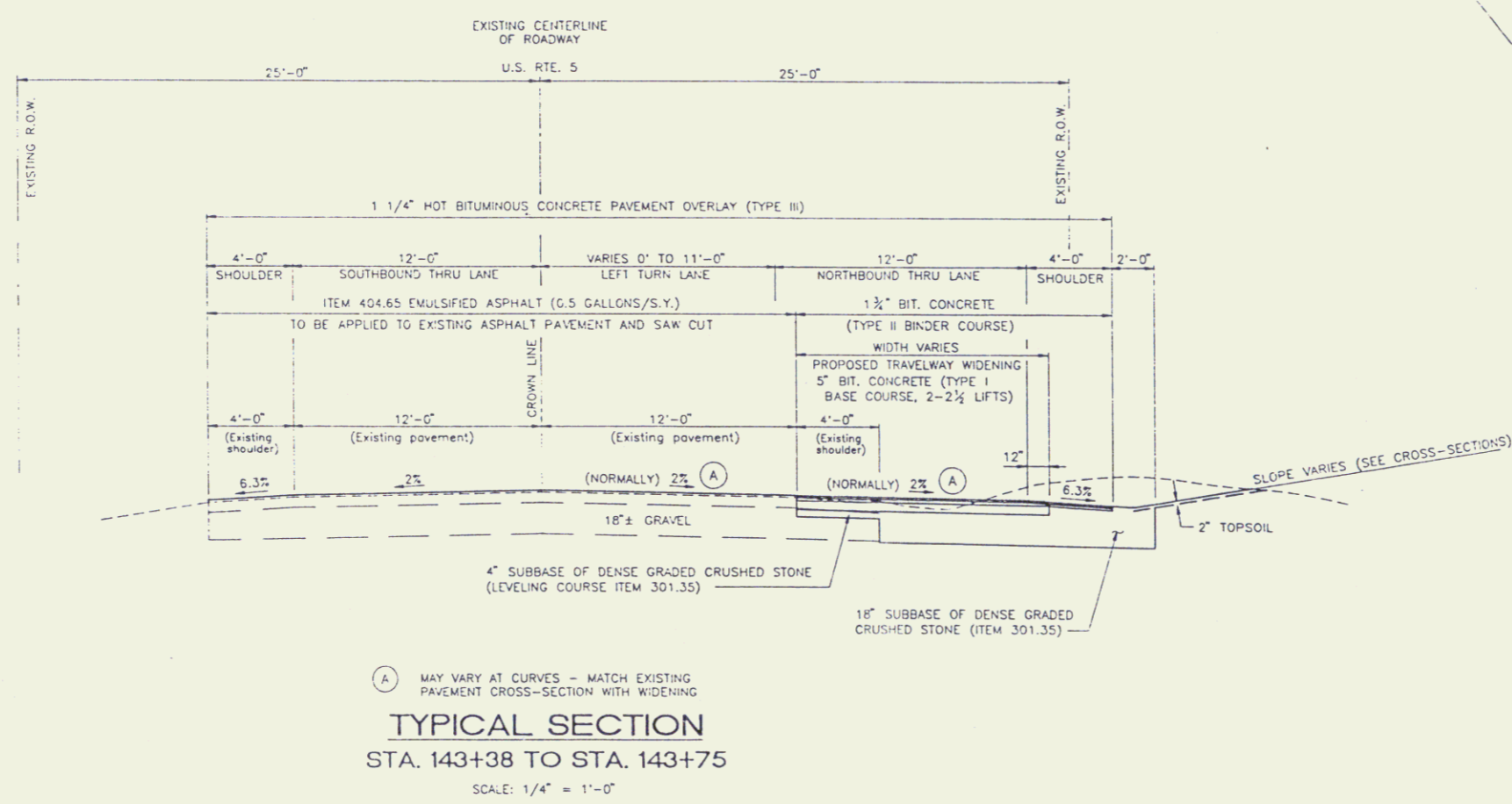
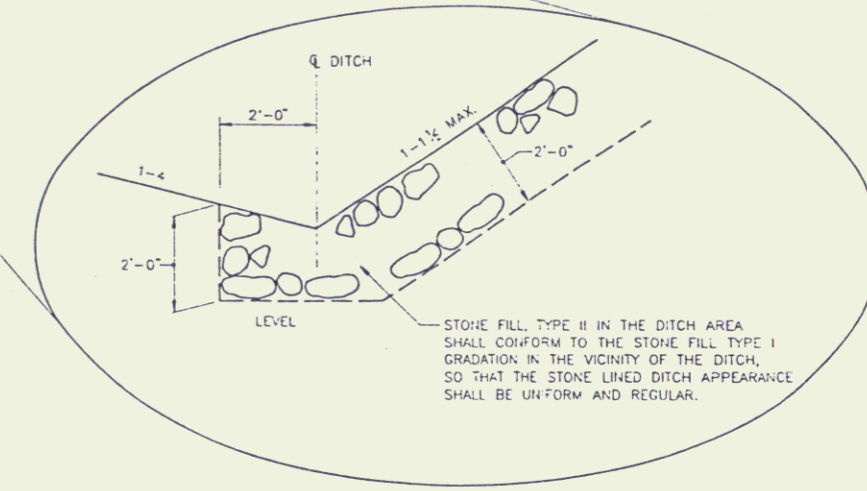
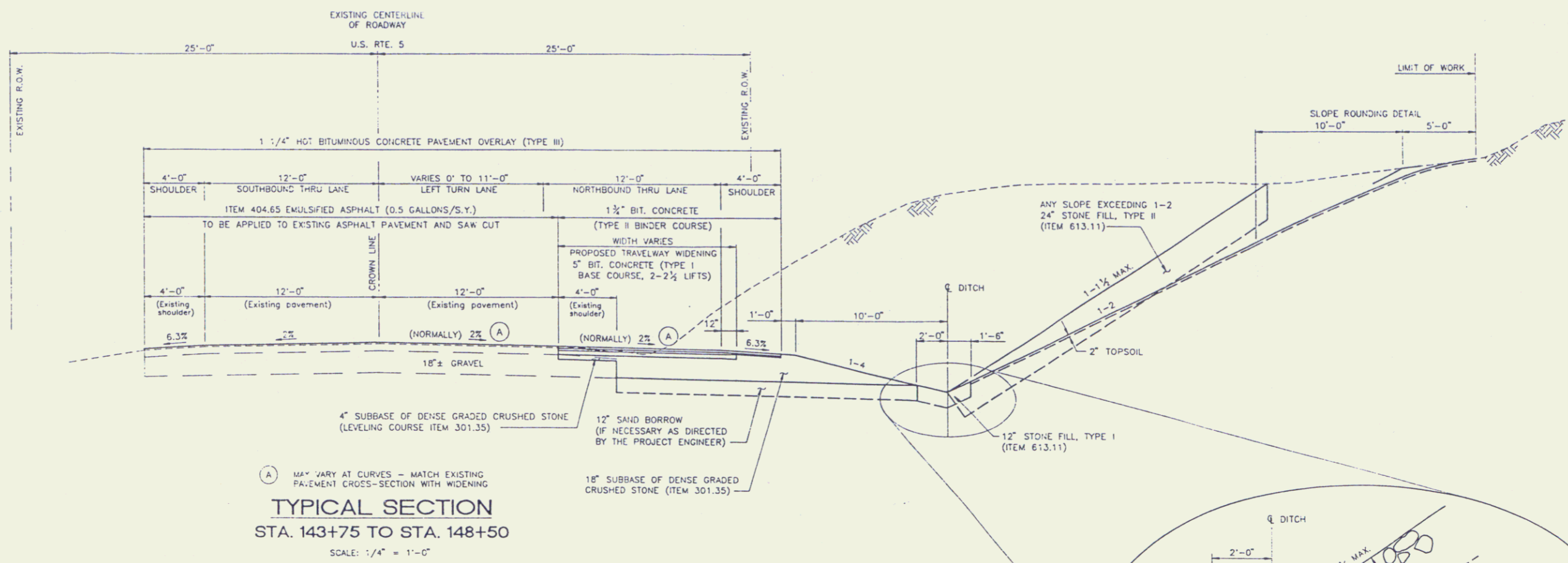

GENERAL NOTES

- EXISTING PAVEMENT IS TO BE SAW-CUT AT THE POINT OF WIDENING. IMMEDIATELY PRIOR TO PAVING EACH LIFT, THIS WILL BE COATED WITH EMULSIFIED ASPHALT (RS-1).
- ALL MATERIALS AND WORKMANSHIP SHALL CONFORM WITH THE 1995 EDITION OF VERMONT AGENCY OF TRANSPORTATION STANDARD SPECIFICATIONS FOR CONSTRUCTION.

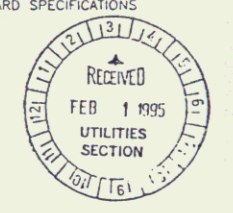

NO.	DATE	REVISIONS	BY	CK'D

DuBois & King INC.
engineering planning management development

MURPHY PROPERTIES, INC.
PRICE CHOPPER SUPERMARKET
ST. JOHNSBURY, VERMONT

TYPICAL SECTIONS

DRAWN BY: GNS	DATE: JAN. 13, 1995
CHECKED BY: R13524F	PROJECT NO.:
SCALE: 1/4" = 1'-0"	DRAWING NO.:
SHEET 2 OF 23	

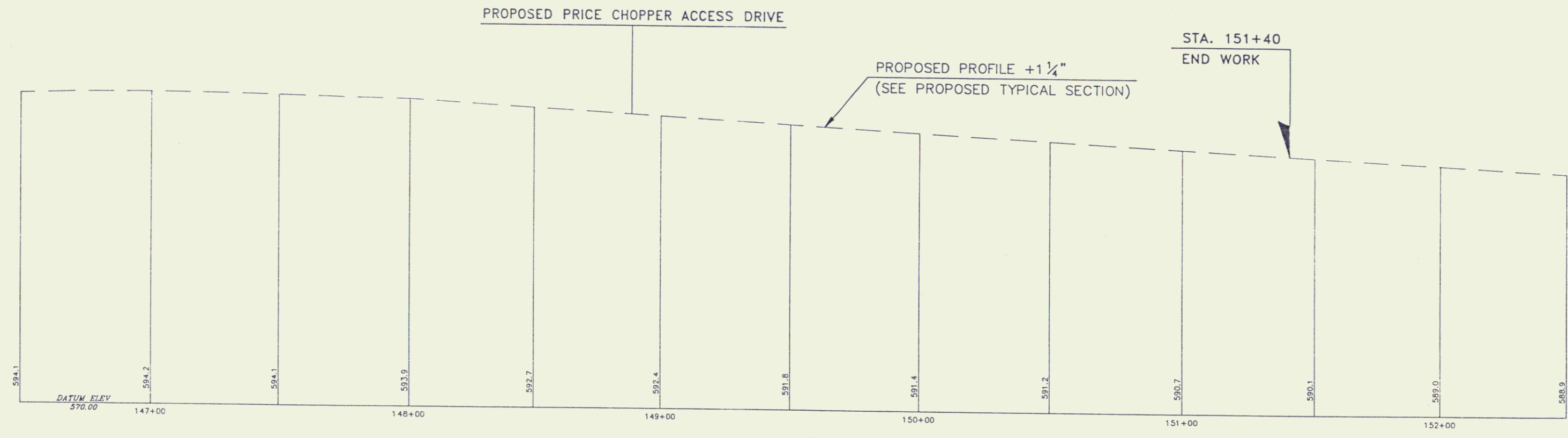
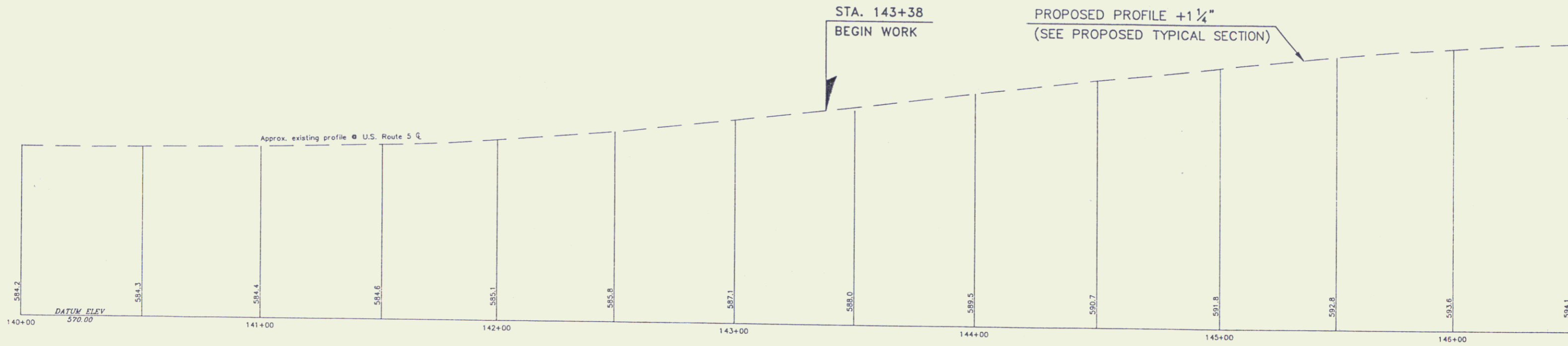

PROFILE
 SCALE: 1" = 20' HORIZ.
 1" = 4' VERT.

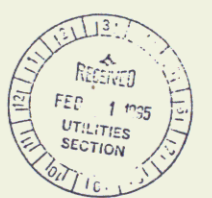

NO.	DATE	REVISIONS	BY	CK'D



MURPHY PROPERTIES, INC.
 PRICE CHOPPER SUPERMARKET
 ST. JOHNSBURY, VERMONT
 CENTERLINE PROFILE
 OF U.S. ROUTE 5

DRAWN BY	GNS	DATE	DEC. 5, 1995
CHECKED BY		PROJ. NO.	R13524P
PROJ. ENG.		DRAW. NO.	
SHEET			7 OF 21

7

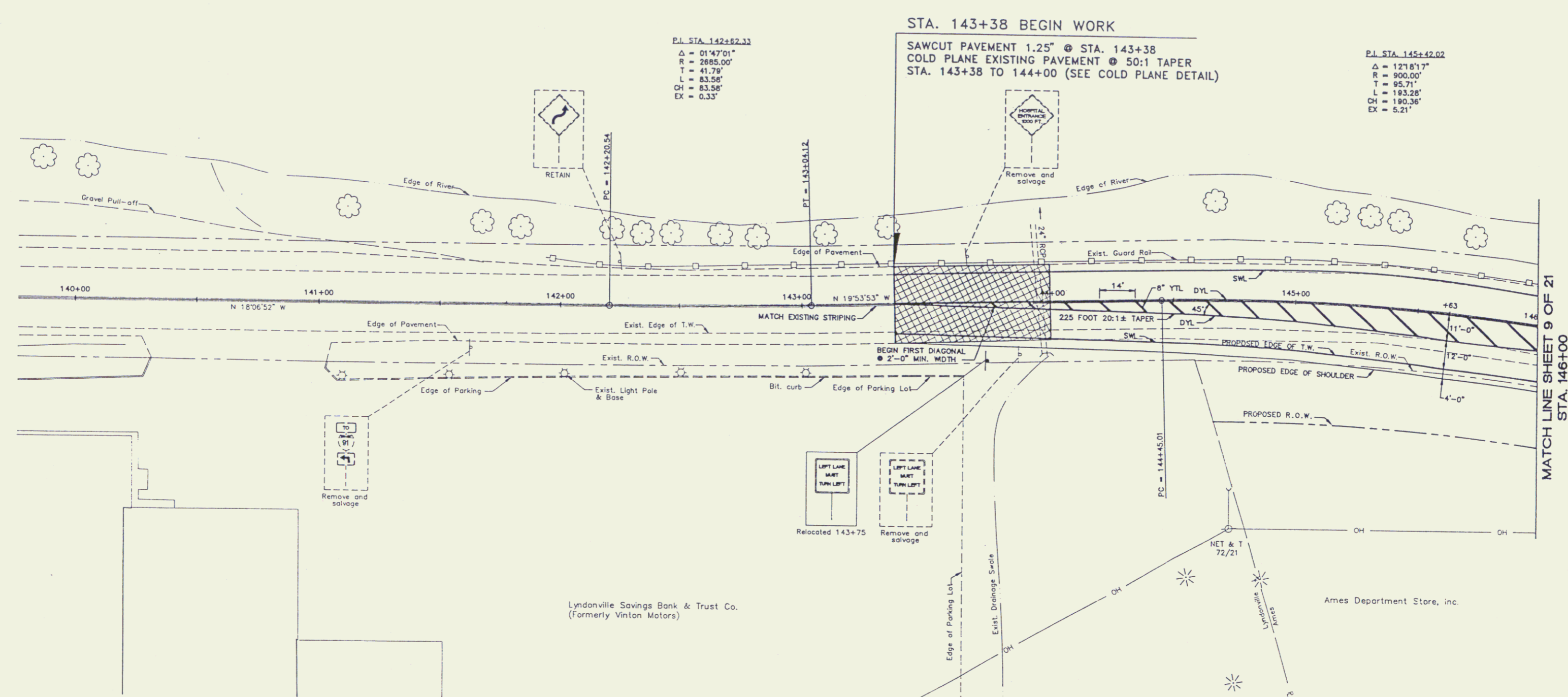

P.I. STA. 142+62.33
 $\Delta = 01'47.01"$
 $R = 2685.00'$
 $T = 41.79'$
 $L = 83.58'$
 $CH = 83.58'$
 $EX = 0.33'$

STA. 143+38 BEGIN WORK
 SAWCUT PAVEMENT 1.25" @ STA. 143+38
 COLD PLANE EXISTING PAVEMENT @ 50:1 TAPER
 STA. 143+38 TO 144+00 (SEE COLD PLANE DETAIL)

P.I. STA. 145+42.02
 $\Delta = 121'8.17"$
 $R = 900.00'$
 $T = 95.71'$
 $L = 193.28'$
 $CH = 190.36'$
 $EX = 5.21'$

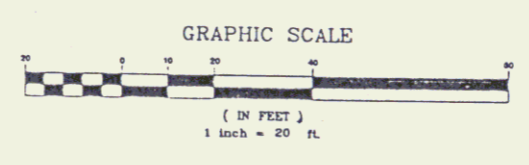

ABBREVIATION	DESCRIPTION
DWL	4" DOTTED WHITE LINE
SWL	4" SOLID WHITE LINE
SYL	4" SOLID YELLOW LINE
BWL	4" BROKEN WHITE LINE
DYL	4" DOUBLE YELLOW LINE
WTL	8" WHITE TRANSVERSE LINE
YTL	8" YELLOW TRANSVERSE LINE
SL	24" STOP LINE

ALL PAVEMENT MARKINGS SHALL BE THERMOPLASTIC.

NO.	DATE	REVISIONS	BY	CK'D

DuBois & King
 engineering planning management development

MURPHY PROPERTIES, INC.
 PRICE CHOPPER SUPERMARKET
 ST. JOHNSBURY, VERMONT
PAVEMENT MARKING AND SIGNING PLAN

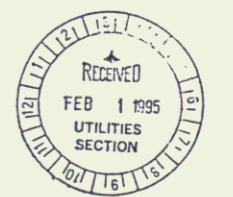

DRAWN BY	GNS	DATE	JAN. 13, 1995
CHECKED BY		PROJ. NO.	R13524P
		DRAW. NO.	
SHEET (8) OF 21			

MATCH LINE SHEET 8 OF 21
STA. 146+00

Murphy Realty Company, Inc.

STA. 151+40 END WORK
SAWCUT PAVEMENT @ STA. 151+40
COLD PLANE EXISTING PAVEMENT @ 50:1 TAPER
STA. 150+75 TO 151+40 (SEE COLD PLANE DETAIL)

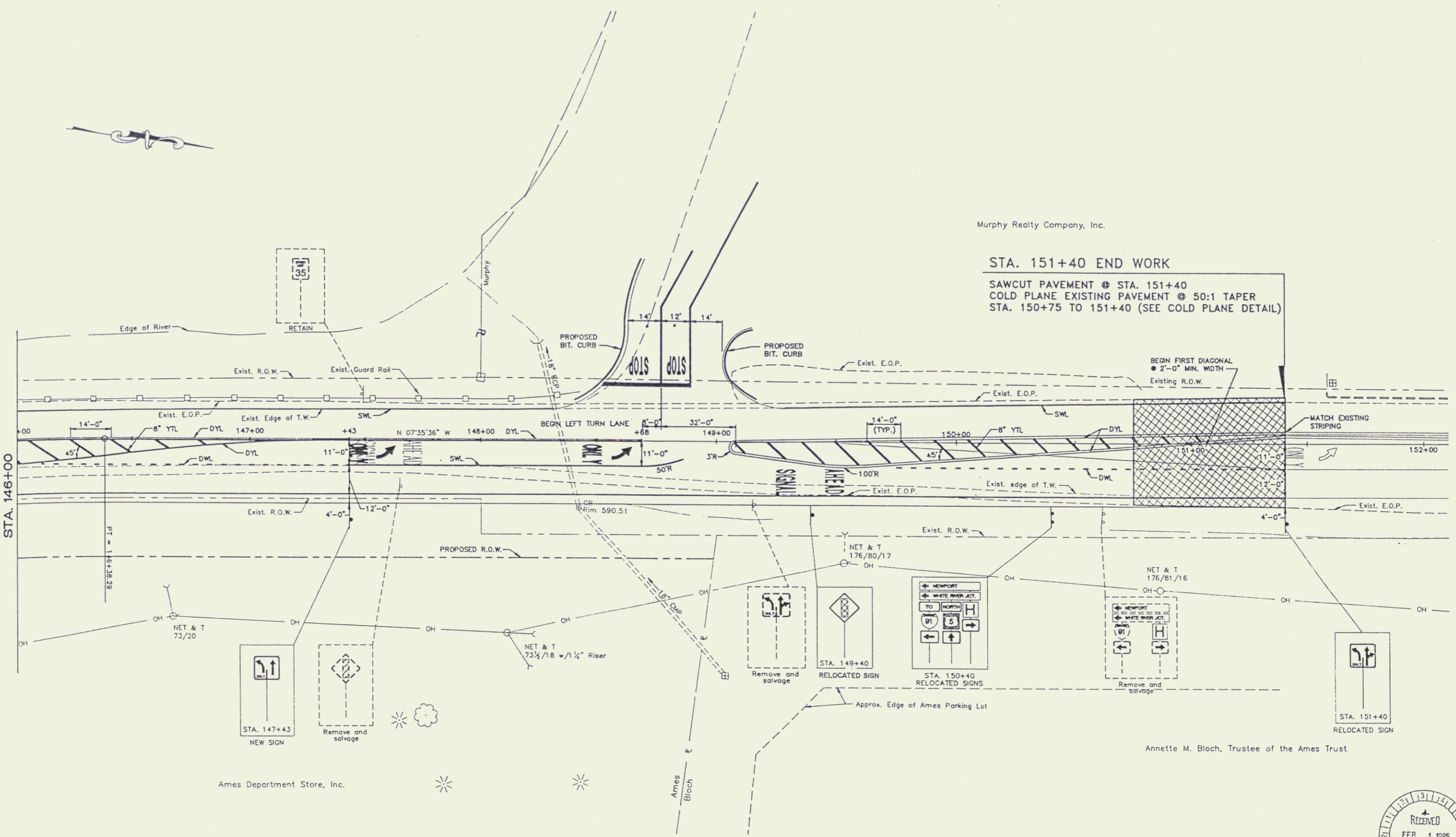

Ames Department Store, Inc.

Annette M. Bloch, Trustee of the Ames Trust

STRIPING ABBREVIATIONS	
ABBREVIATION	DESCRIPTION
DWL	4" DOTTED WHITE LINE
SWL	4" SOLID WHITE LINE
SYL	4" SOLID YELLOW LINE
BWL	4" BROKEN WHITE LINE
DYL	4" DOUBLE YELLOW LINE
WTL	8" WHITE TRANSVERSE LINE
YTL	8" YELLOW TRANSVERSE LINE
SL	24" STOP LINE

ALL PAVEMENT MARKINGS SHALL BE THERMOPLASTIC.

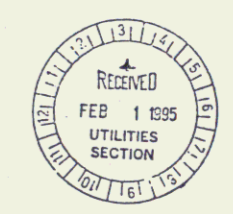
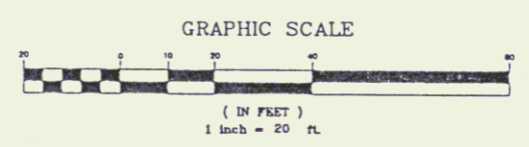

NO.	DATE	REVISIONS	BY	CHK'D

DuBois & King
INC.
engineering planning management development

MURPHY PROPERTIES, INC.
PRICE CHOPPER SUPERMARKET
ST. JOHNSBURY, VERMONT
PAVEMENT MARKING AND SIGNING PLAN

DRAWN BY	DATE
GNS	JAN. 16,
CHECKED BY	PROJ. NO.
	R13524P
PROJ. ENG.	DRAW. NO.
SHEET 9 OF 2	

9

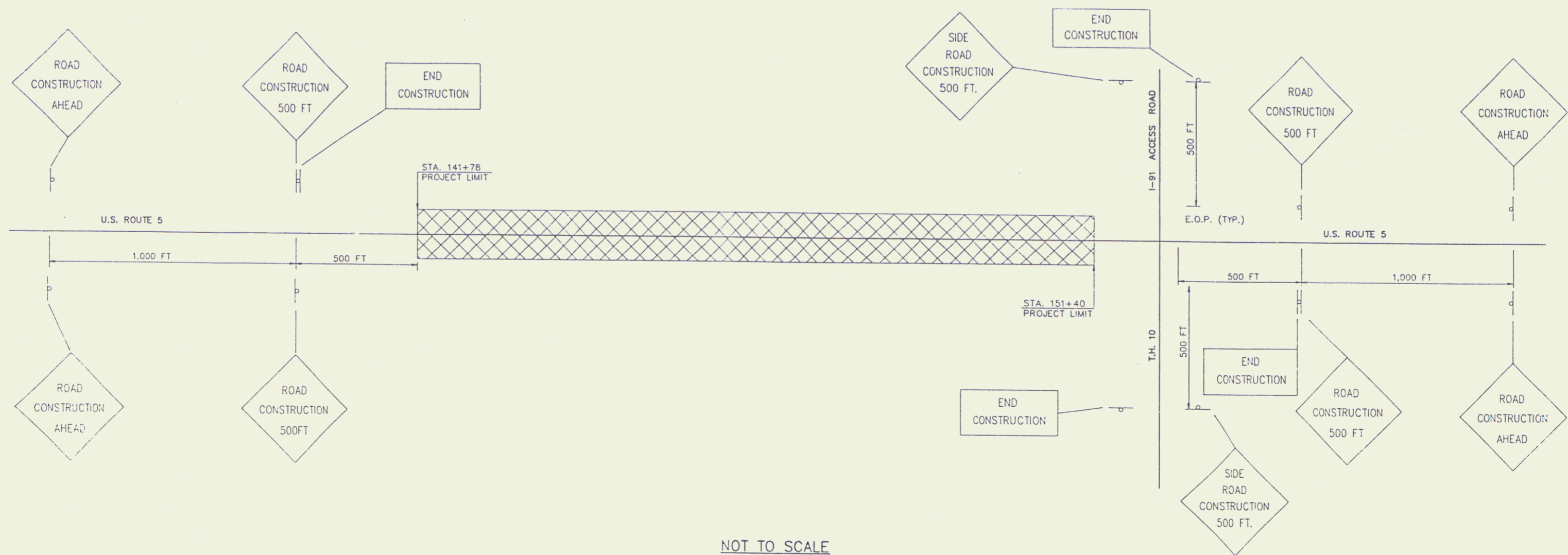

INTRODUCTION

THE FOLLOWING TRAFFIC CONTROL INFORMATION IS INTENDED TO BE AN OUTLINE FOR HOW THE WORK SHOULD PROCEED. IT IS THE CONTRACTOR'S RESPONSIBILITY TO PROVIDE SPECIFIC DETAILS TO TAKE CARE OF SPECIFIC SITUATIONS. IF THE CONTRACTOR DOES NOT WISH TO FOLLOW THIS OUTLINE, HE MAY SUBMIT AN ALTERNATE PROPOSAL TO THE TRAFFIC AND SAFETY DIVISION VIA THE ENGINEER. THE CONTRACTOR MUST ALLOW AT LEAST 4 WEEKS FOR REVIEW AND APPROVAL OF A COMPREHENSIVE PLAN AND TWO WEEKS FOR REVIEW AND APPROVAL OF MINOR CHANGES/DETAILS. ALL TRAFFIC CONTROL DETAILS MUST BE DESIGNED AND IMPLEMENTED IN ACCORDANCE WITH THE MUTCD AND STANDARDS E-9, E-100, E-101, E-102, E-106, E-107, E-107A, AND E-110.

GENERAL

MAINTAIN 2 LANES (ONE EACH WAY) AT ALL TIMES. THE MINIMUM TRAVELLED-WAY WIDTH IS 22'. SPECIAL CARE MUST BE TAKEN TO PROVIDE ACCESS THROUGH WORK ZONES FOR EMERGENCY VEHICLES. THE CONTRACTOR SHALL COORDINATE WITH BOTH THE FIRE AND POLICE DEPARTMENTS TO DETERMINE THEIR MINIMUM ACCESS REQUIREMENTS.

MAINTAIN ACCESS TO ALL PROPERTIES AT ALL TIMES FOR EMERGENCY VEHICLES. MAINTAIN ACCESS TO ALL COMMERCIAL PROPERTIES DURING BUSINESS HOURS. ACCESS TO RESIDENTIAL PROPERTIES MAY BE RESTRICTED FOR A SHORT DURATION (A FEW HOURS) WITH PERMISSION OF THE OWNER. COORDINATE MAJOR WORK ON COMMERCIAL ACCESS WITH THE OWNER AT LEAST ONE WEEK PRIOR TO STARTING THE WORK.

EXISTING SIGNING SHALL REMAIN, WITH RELOCATION AS NECESSARY, UNTIL ITS NEED NO LONGER EXISTS. TEMPORARY SIGNING SHALL BE ADDED, AS NEEDED AND AS REQUIRED BY THE MUTCD. NEW SIGNING SHALL BE INSTALLED AS IT BECOMES APPLICABLE AND AS CONSTRUCTION NEARS COMPLETION.

GENERAL CONT.

TRAFFIC SHALL NOT BE CHANGED FROM ONE PATTERN TO THE NEXT UNTIL ALL TEMPORARY MARKINGS AND SIGNING ARE COMPLETED. ANY CONFLICTING MARKING SHALL BE REMOVED BY BURNING OR GRINDING.

SIGNALIZED INTERSECTIONS MUST BE CONTROLLED BY UNIFORMED TRAFFIC OFFICERS (UTO'S) ANY TIME WHEN THEY ARE NOT IN NORMAL OPERATION EXCEPT DURING NIGHT TIME FLASHING OPERATION. CARE SHALL BE TAKEN BY THE CONTRACTOR TO KEEP THE SIGNAL OPERATIONAL AT ALL TIMES.

THE BID PRICE FOR THE ITEM TRAFFIC CONTROL (641.10) SHALL INCLUDE ALL APPROACH AND ON-PROJECT CONSTRUCTION SIGNING, BARRIERS, CONES, BARRICADES, TEMPORARY REGULATORY, WARNING SIGNS AND POSTS. ALL ADJUSTING AND RELOCATING WILL BE PAID UNDER THEIR SPECIFIC BID PRICES.

- 1. 646.60, .61 & .66 TEMPORARY PAVEMENT MARKINGS
- 2. 630.10 UTO'S
- 3. 630.15 FLAGGERS
- 4. 621.90 TEMPORARY TRAFFIC BARRIER
- 5. 646.82 REMOVAL OF EXISTING PAVEMENT MARKINGS

PHASE 1 UTILITIES & DRAINAGE

MAINTAIN TRAFFIC ON EXISTING ROADWAY. INSTALL PROPOSED DRAINAGE. PRIOR TO ANY EXCAVATION THE CONTRACTOR SHALL CALL DIG-SAFE (800) 225-4977.

THE CONTRACTOR SHALL NOTIFY THE TOWN OF ANY ANTICIPATED DISRUPTION OF EXISTING UTILITIES 24 HOURS IN ADVANCE. NO DISRUPTIONS ARE ANTICIPATED AT THIS TIME. PRIOR TO BEGINNING ANY WORK IN THE VICINITY OF THE SIGNAL AND SIGNAL LOOPS 48 HOURS NOTICE SHALL BE GIVEN TO STEVE EDWARDS (VAOT TRAFFIC SIGNAL MAINTENANCE ENGINEER) AT (800) 826-2690.

PHASE 2

WIDEN THE EAST SIDE OF THE ROADWAY TO INCLUDE UNDERDRAIN, SUB-BASE AND BASE COURSE PAVING. INSTALL PERMANENT SIGNING. PERMANENT SIGNING SHALL BE COVERED DURING CONSTRUCTION. DURING THIS CONSTRUCTION, SUB-BASE PLACEMENT SHALL KEEP PACE WITH THE EXCAVATION SO AS TO MINIMIZE DROP-OFFS. ACCESS TO ALL DRIVES MUST BE MAINTAINED.

PHASE 3

THIS PHASE SHALL CONSIST OF THE FINAL PAVING AND APPLICATION OF THE FINAL MARKINGS. TRAFFIC CONTROL SHALL BE IN ACCORDANCE WITH STD E-110.

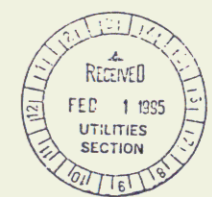

NO.	DATE	REVISIONS	BY	CKD

DuBois & King
 engineering planning management development

MURPHY PROPERTIES, INC.
 PRICE CHOPPER SUPERMARKET
 ST. JOHNSBURY, VERMONT

TRAFFIC CONTROL PLAN

DRAWN BY	GNB	DATE	JAN. 16, 1995
CHECKED BY		PROJECT NO.	R13524P
PROJECT ENG.		DRAWN NO.	
SHEET			11 OF 21

11

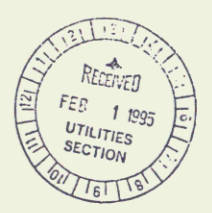
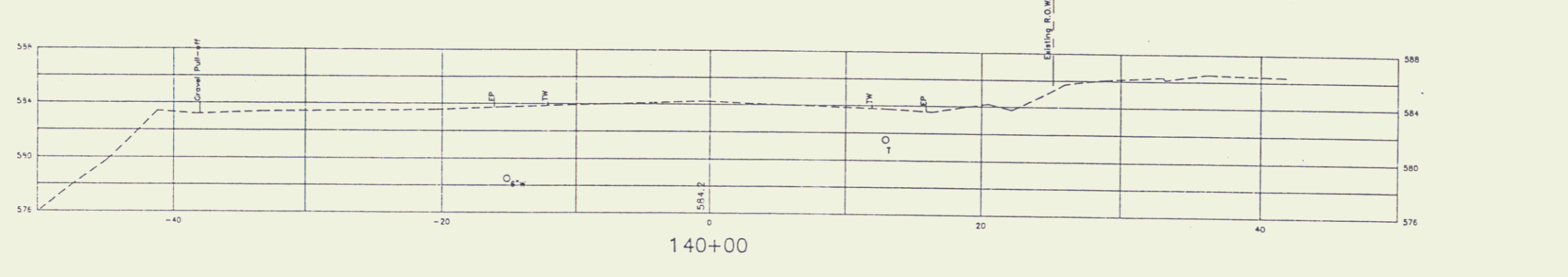
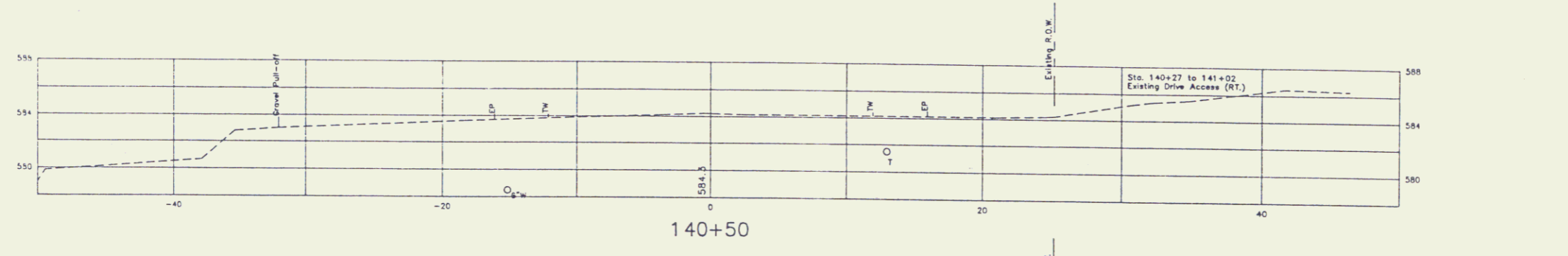
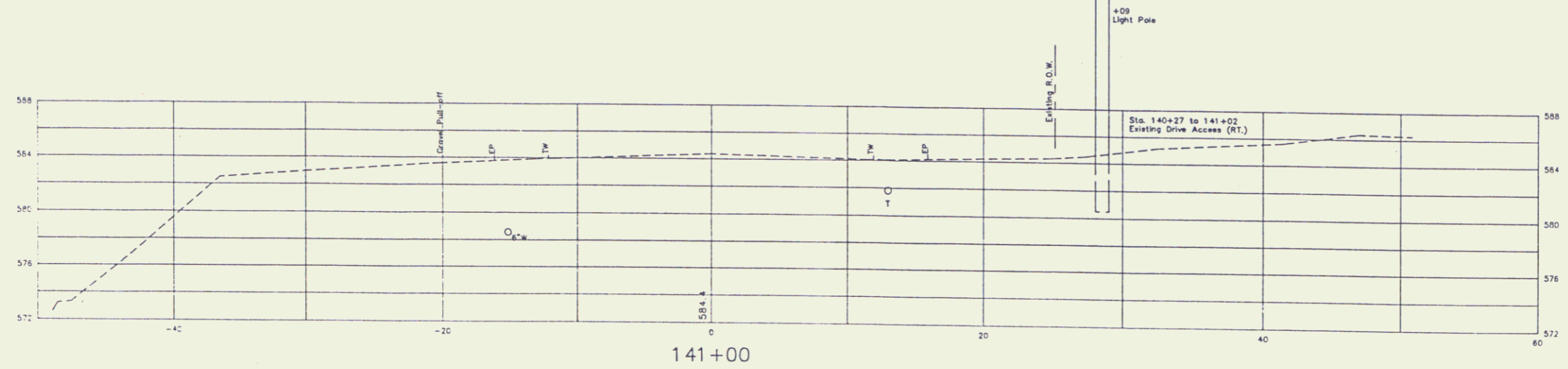
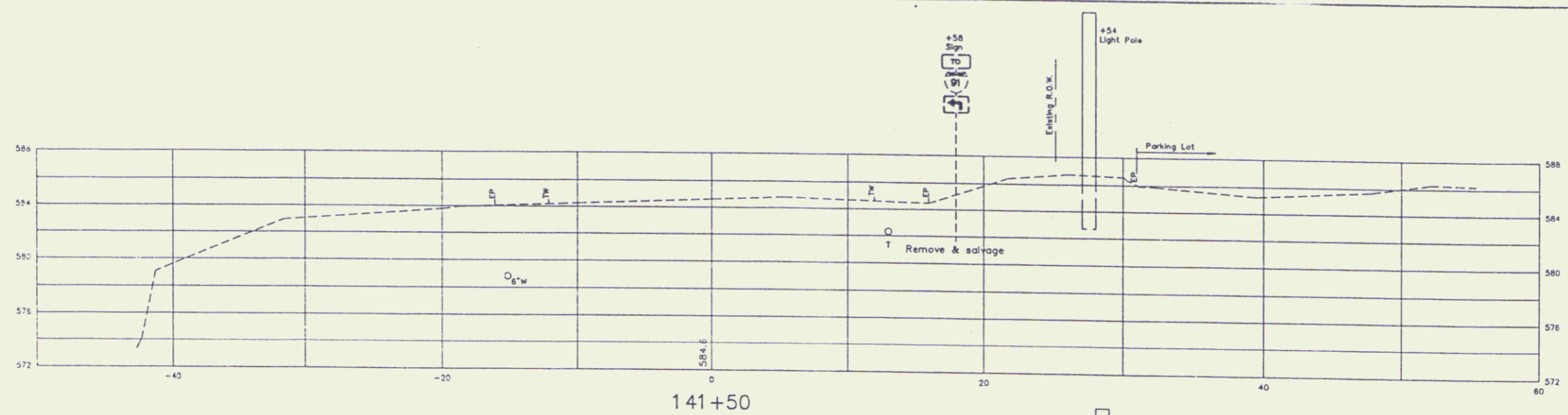

NOTE
 THE UTILITY LOCATIONS SHOWN ON THE PLANS ARE APPROXIMATE AND HAVE BEEN PLOTTED BASED ON INFORMATION OBTAINED FROM RECORD PLANS. UNDERGROUND TELEPHONE HAS BEEN PLOTTED WITH AN ASSUMED DEPTH OF COVER OF 24". WATER LINES HAVE BEEN PLOTTED WITH AN ASSUMED DEPTH OF COVER OF 5'-0".
 THE CONTRACTOR SHALL NOTIFY "DIGSAFE" AT (800) 225-4977 PRIOR TO ANY EXCAVATION.

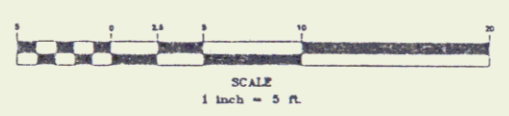

NO.	DATE	REVISIONS	BY	CHK'D



MURPHY PROPERTIES, INC.
 PRICE CHOPPER SUPERMARKET
 ST. JOHNSBURY, VERMONT
CROSS SECTIONS

DRAWN BY GNS	DATE DEC. 5, 1994
DESIGNED BY R13524P	SCALE
SHEET 12 OF 21	

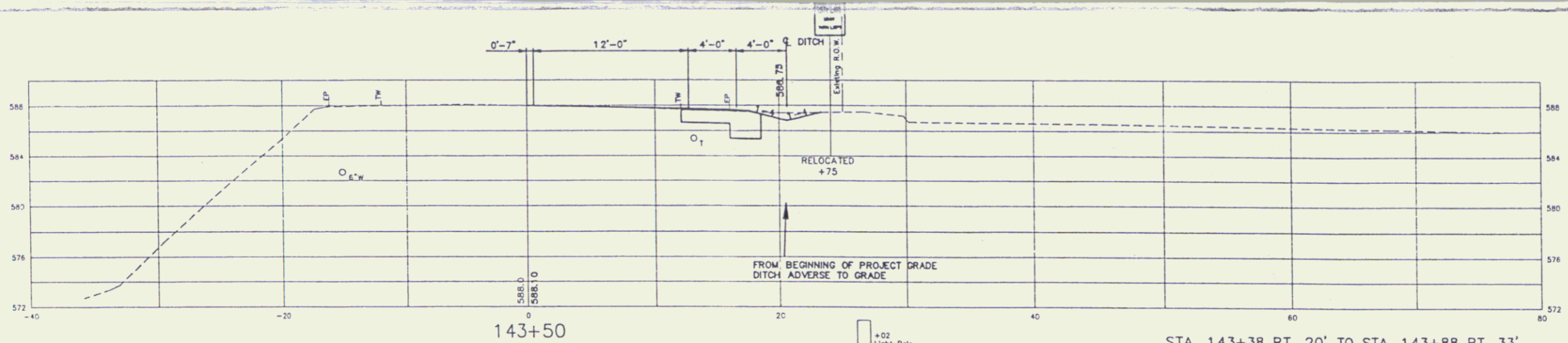

STA. 143+38 BEGIN WORK AHEAD

STA. 143+38 RT. 20' TO STA. 143+88 RT. 33'
CONST. DRAINAGE SWALE (ADVERSE TO GRADE -
TO DRAIN INTO CULVERT, RIGHT)

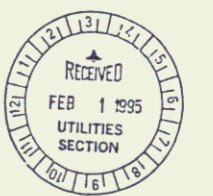
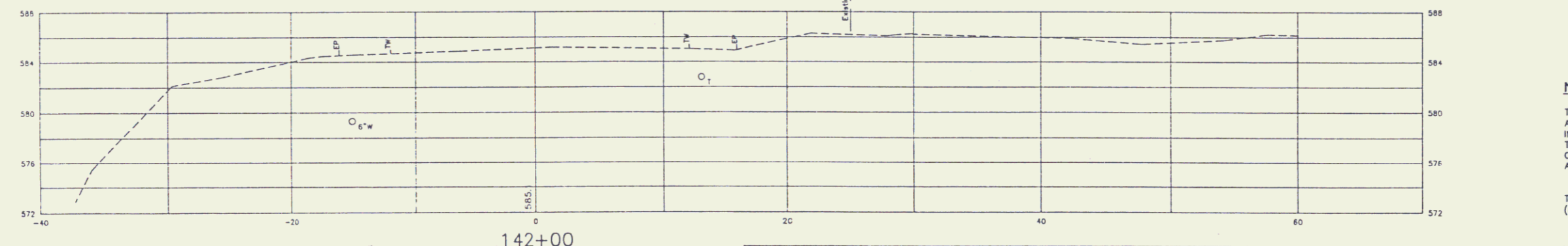
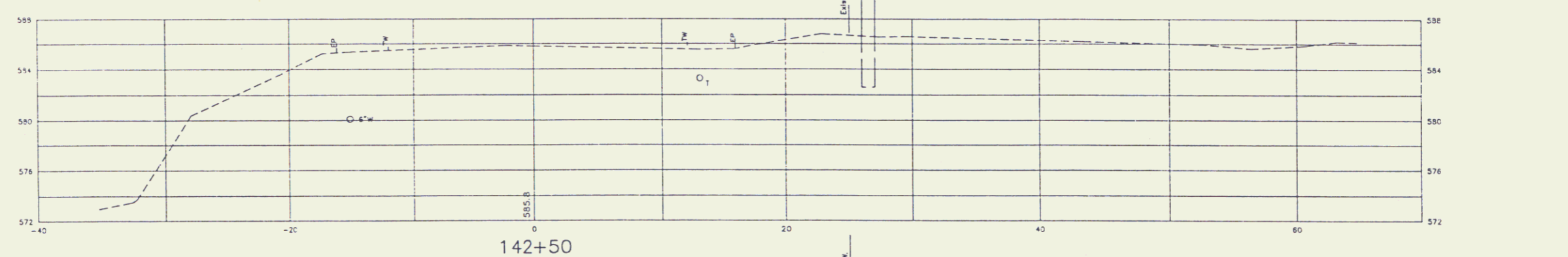
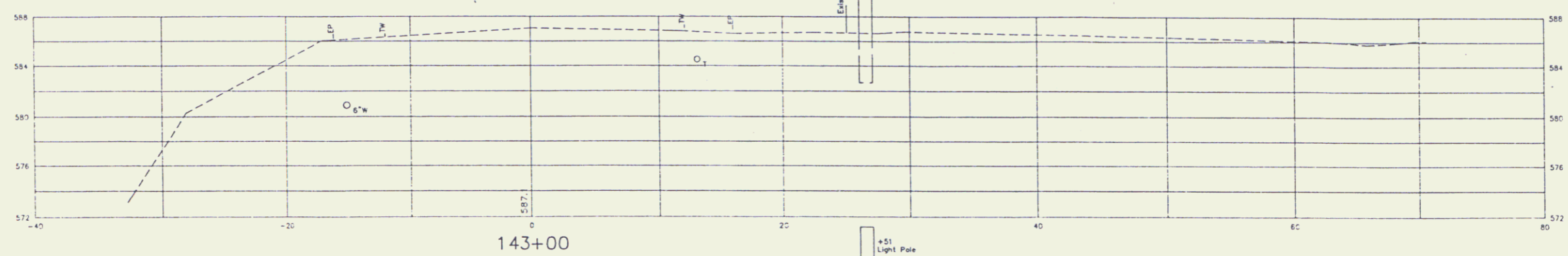

NOTE
THE UTILITY LOCATIONS SHOWN ON THE PLANS ARE APPROXIMATE AND HAVE BEEN PLOTTED BASED ON INFORMATION OBTAINED FROM RECORD PLANS. UNDERGROUND TELEPHONE HAS BEEN PLOTTED WITH AN ASSUMED DEPTH OF COVER OF 24". WATER LINES HAVE BEEN PLOTTED WITH AN ASSUMED DEPTH OF COVER OF 5'-0".
THE CONTRACTOR SHALL NOTIFY "DIGSAFE" AT (800) 225-4977 PRIOR TO ANY EXCAVATION.

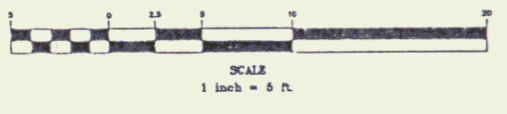

NO.	DATE	REVISIONS	BY	CHK'D

DuBois & King
INC.
engineering planning management development

MURPHY PROPERTIES, INC.
PRICE CHOPPER SUPERMARKET
ST. JOHNSBURY, VERMONT
CROSS SECTIONS

DRAWN BY ONS	DATE DEC. 5, 1994
CHECKED BY R13524P	
PROJECT ENG	DRAWN BY
SHEET 13 OF 21	

13

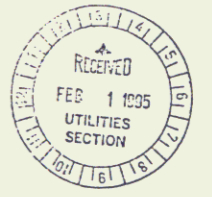
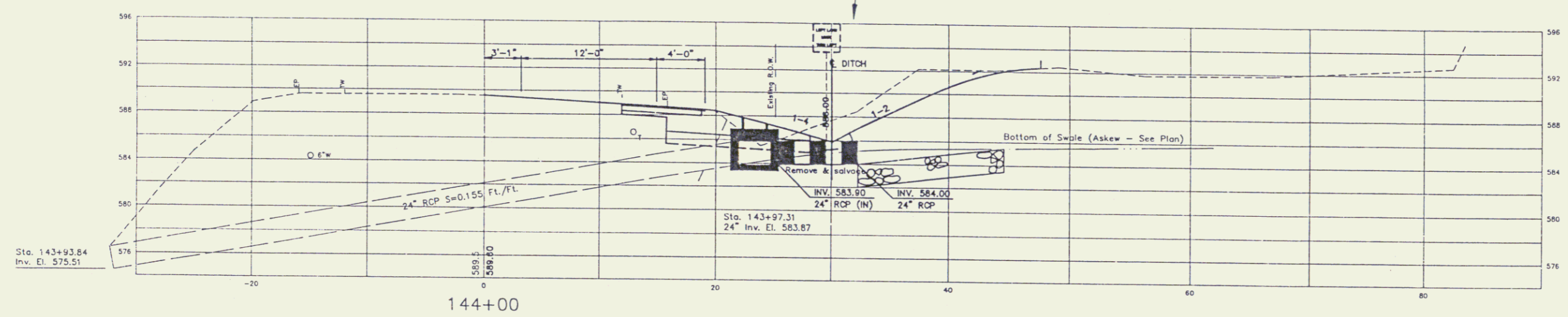
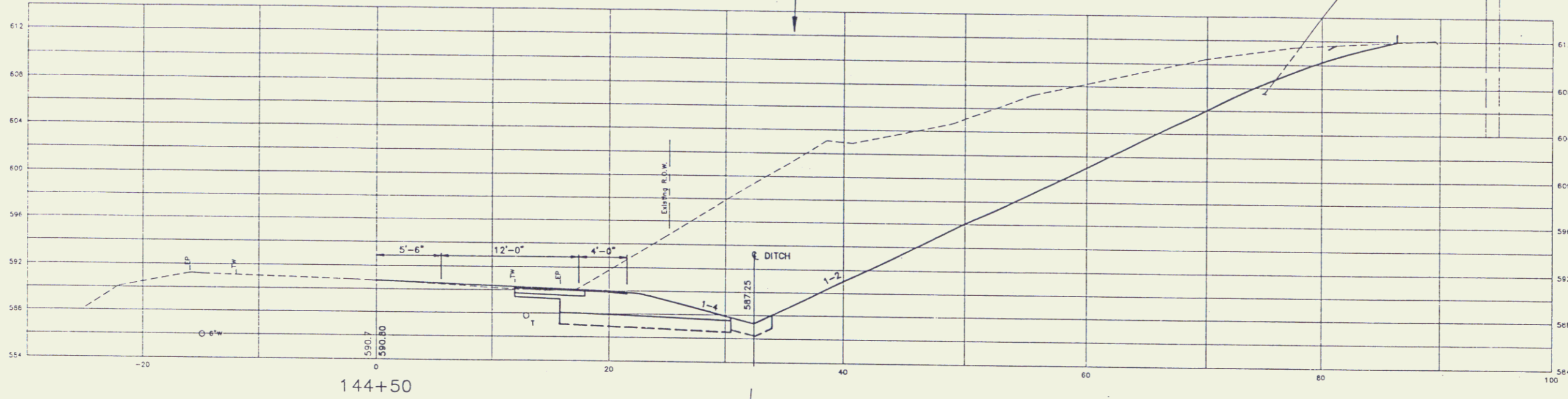
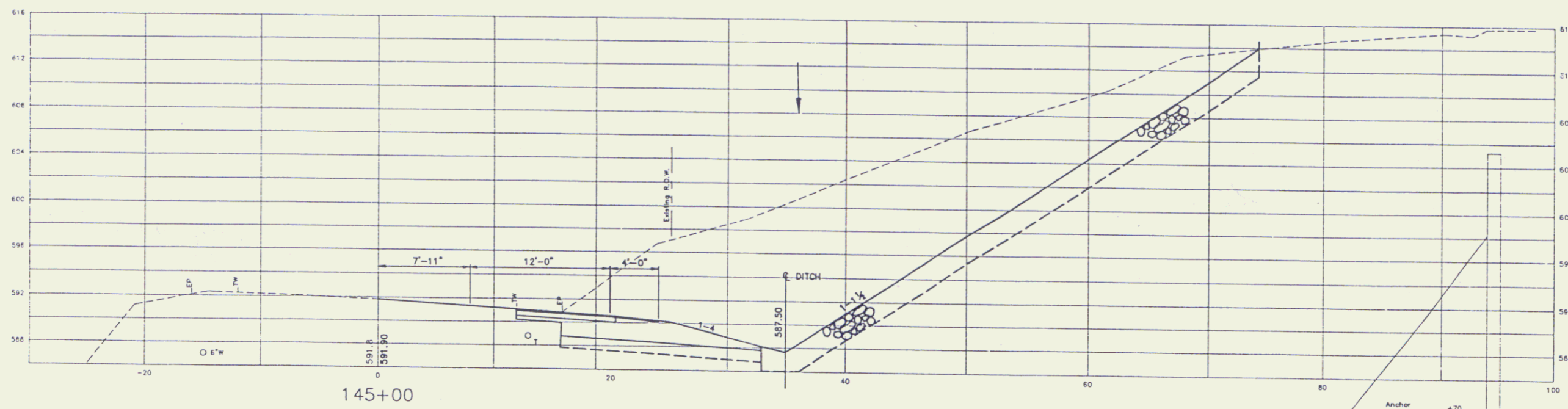

STA. 143+97 RT. 22' TO STA. 143+88 RT. 33'
 REMOVE EXIST. DRAINAGE HEADER
 CONST. 4'x4' D.I. (CONCRETE)
 WITH DRAINAGE MANHOLE FRAME & COVER
 CONST. 12'x24" R.C.P.
 CONST. 12" INLET DITCH WITH
 2'-0" STONE FILL TYPE II (ITEM 613.10)

NOTE
 THE UTILITY LOCATIONS SHOWN ON THE PLANS ARE APPROXIMATE AND HAVE BEEN PLOTTED BASED ON INFORMATION OBTAINED FROM RECORD PLANS. UNDERGROUND TELEPHONE HAS BEEN PLOTTED WITH AN ASSUMED DEPTH OF COVER OF 24". WATER LINES HAVE BEEN PLOTTED WITH AN ASSUMED DEPTH OF COVER OF 5'-0".

THE CONTRACTOR SHALL NOTIFY "DIGSAFE" AT (800) 225-4977 PRIOR TO ANY EXCAVATION.

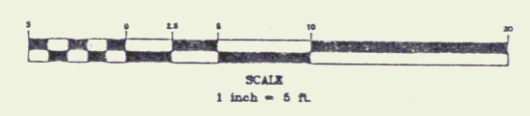

NO.	DATE	REVISIONS	BY	CHK'D

DuBois & King
 INC.
 engineering planning management development

MURPHY PROPERTIES, INC.
 PRICE CHOPPER SUPERMARKET
 ST. JOHNSBURY, VERMONT
CROSS SECTIONS

DRAWN BY GNS	DATE JAN. 16, 1995
CHECKED BY	PROJ. NO. R13524P
PROJ. ENG.	DRAW. NO.
SHEET 14 OF 21	

14

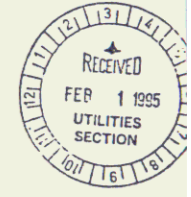
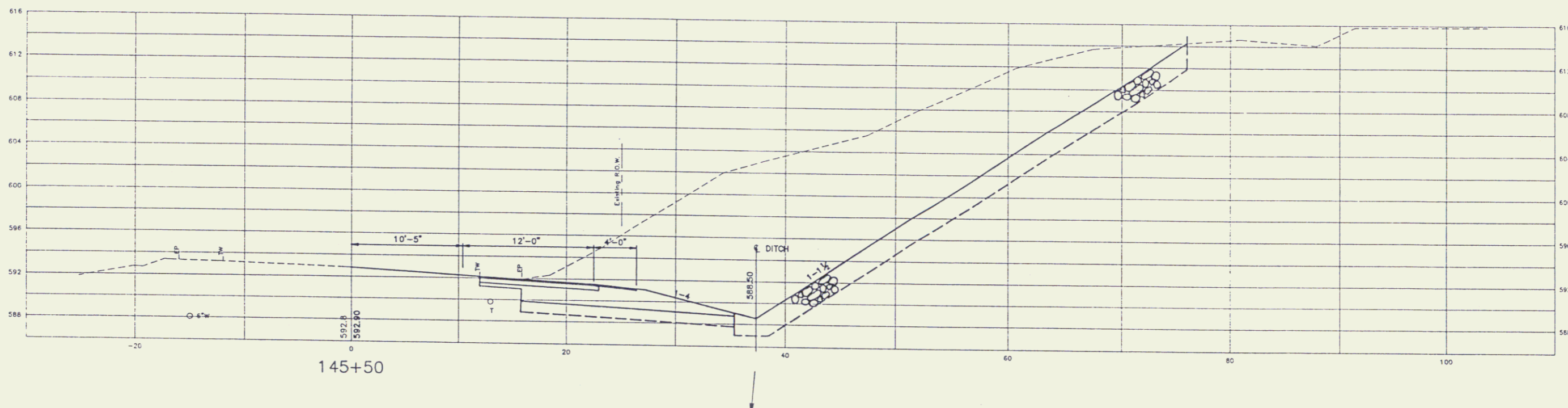
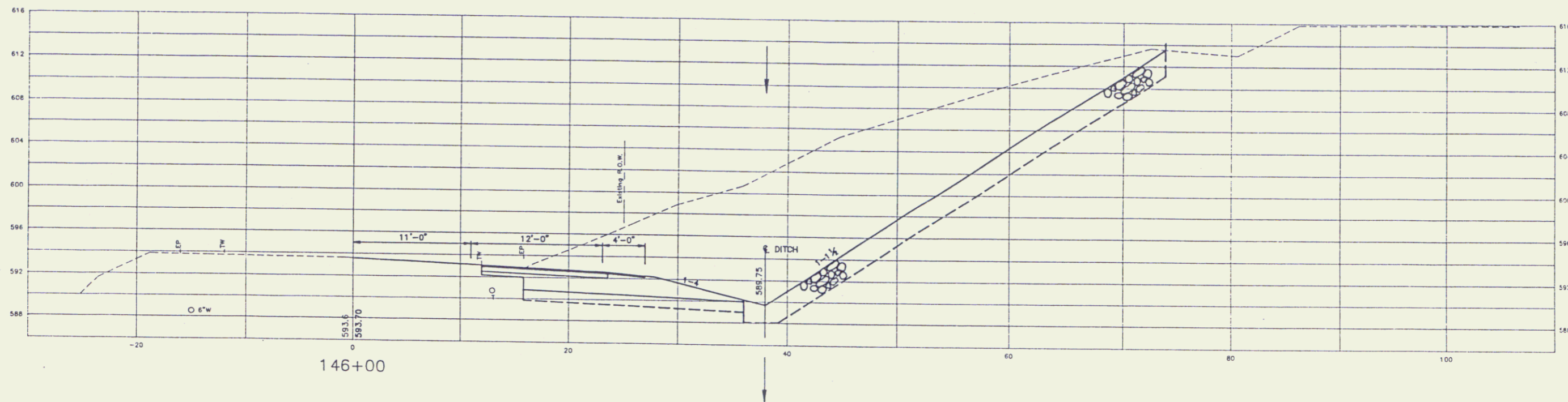

NOTE
 THE UTILITY LOCATIONS SHOWN ON THE PLANS ARE APPROXIMATE AND HAVE BEEN PLOTTED BASED ON INFORMATION OBTAINED FROM RECORD PLANS. UNDERGROUND TELEPHONE HAS BEEN PLOTTED WITH AN ASSUMED DEPTH OF COVER OF 24". WATER LINES HAVE BEEN PLOTTED WITH AN ASSUMED DEPTH OF COVER OF 5'-0".

THE CONTRACTOR SHALL NOTIFY "DIGSAFE" AT (800) 225-4977 PRIOR TO ANY EXCAVATION.

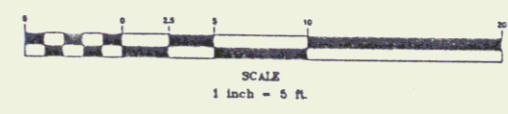

NO.	DATE	REVISION	BY	CHECK

DuBois & King
 inc.
 engineering planning management development

MURPHY PROPERTIES, INC.
 PRICE CHOPPER SUPERMARKET
 ST. JOHNSBURY, VERMONT
CROSS SECTIONS

DESIGNED BY	GNS	DATE	JAN. 16
DRAWN BY		PROJECT NO.	R135241
CHECKED BY		DRAWN NO.	
		15 OF 15	

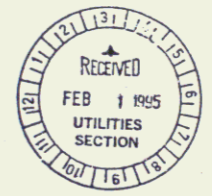
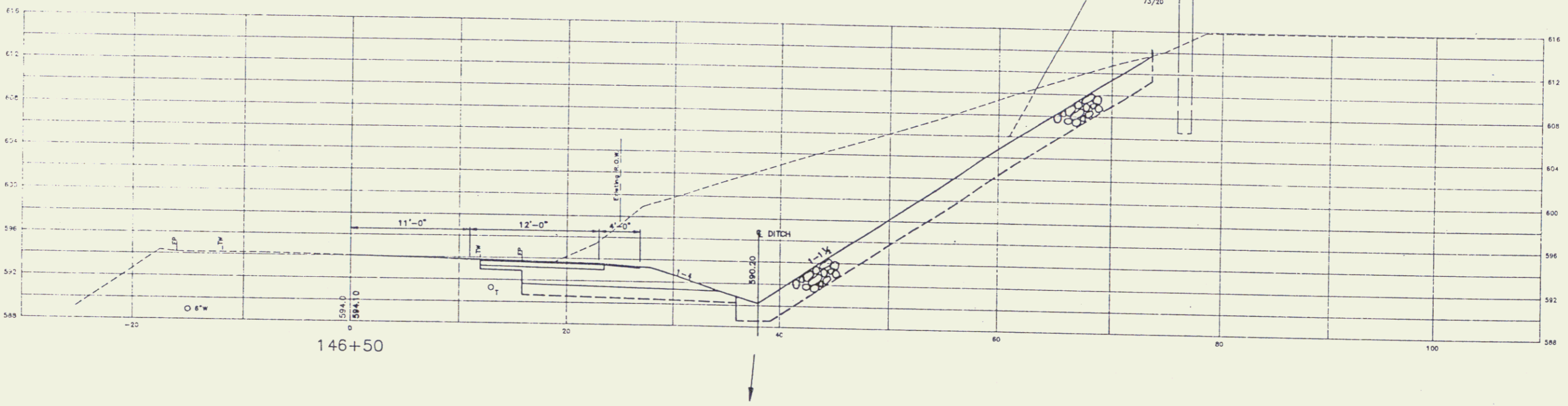
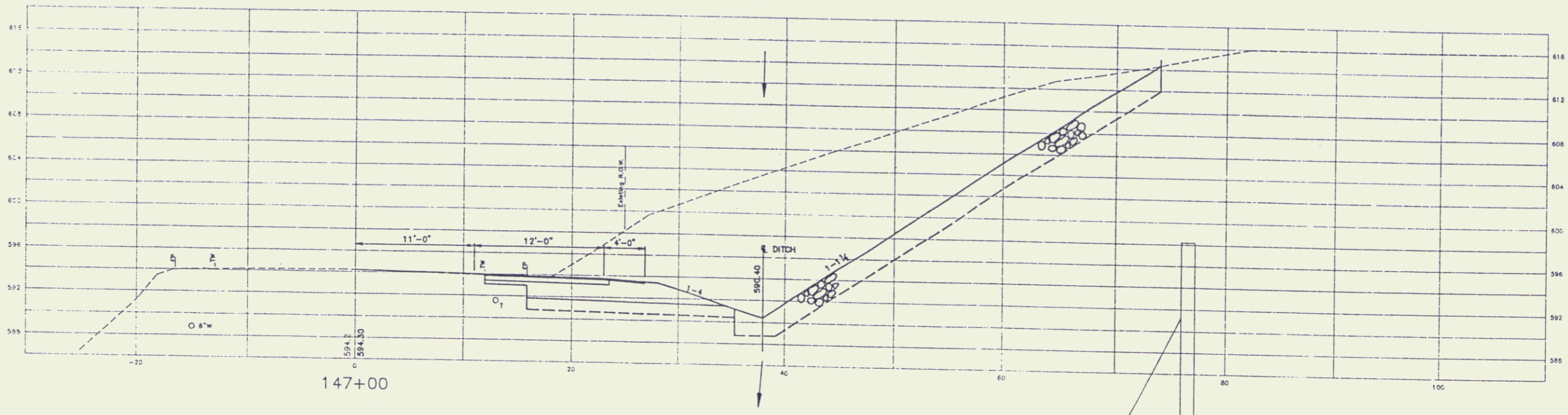

NOTE
 THE UTILITY LOCATIONS SHOWN ON THE PLANS ARE APPROXIMATE AND HAVE BEEN PLOTTED BASED ON INFORMATION OBTAINED FROM RECORD PLANS. UNDERGROUND TELEPHONE HAS BEEN PLOTTED WITH AN ASSUMED DEPTH OF COVER OF 24". WATER LINES HAVE BEEN PLOTTED WITH AN ASSUMED DEPTH OF COVER OF 5'-0".

THE CONTRACTOR SHALL NOTIFY "DIGSAFE" AT (800) 225-4977 PRIOR TO ANY EXCAVATION. **JAN 27 1995**

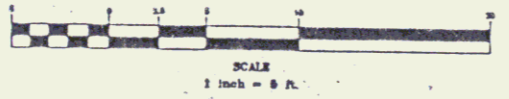

NO.	DATE	REVISIONS	BY	CHKD.

DuBois & King
 engineering planning management development

MURPHY PROPERTIES, INC.
 PRICE CHOPPER SUPERMARKET
 ST. JOHNSBURY, VERMONT
CROSS SECTIONS

DRAWN BY	DATE
CHKD. BY	JAN. 16, 1995
ORDERED BY	PROJ. NO.
	R13524P
SHEET 16 OF 21	

16

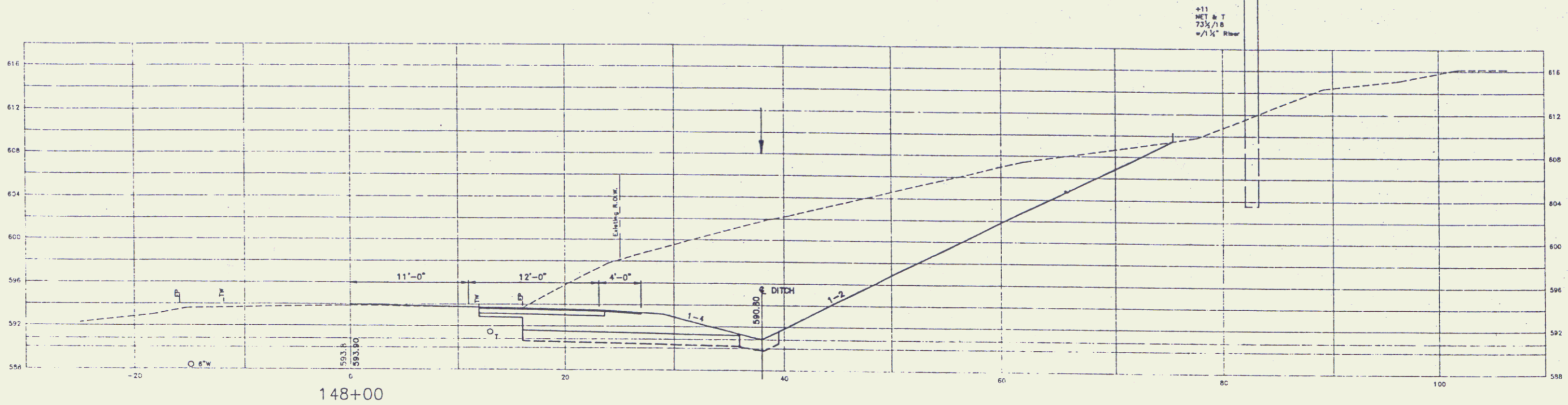

148+00

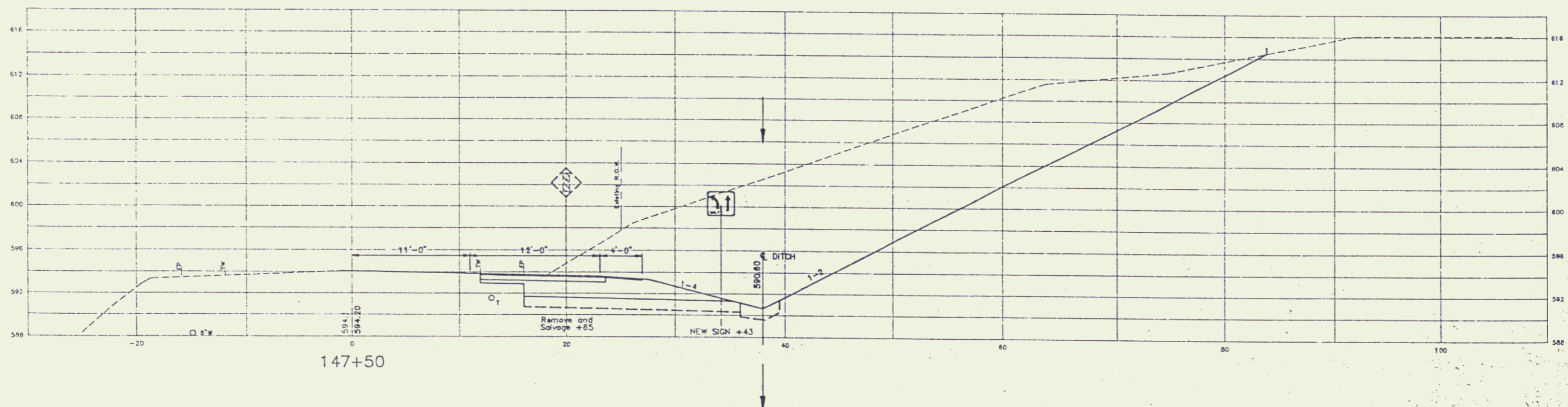

147+50

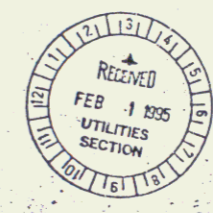

NOTE
 THE UTILITY LOCATIONS SHOWN ON THE PLANS ARE APPROXIMATE AND HAVE BEEN PLOTTED BASED ON INFORMATION OBTAINED FROM RECORD PLANS. UNDERGROUND TELEPHONE HAS BEEN PLOTTED WITH AN ASSUMED DEPTH OF COVER OF 24". WATER LINES HAVE BEEN PLOTTED WITH AN ASSUMED DEPTH OF COVER OF 5'-0".
 THE CONTRACTOR SHALL NOTIFY "DIGSAFE" AT (800) 225-4977 PRIOR TO ANY EXCAVATION. **JAN 27 1995**



NO.	DATE	REVISIONS	BY	QCD



MURPHY PROPERTIES, INC.
 PRICE CHOPPER SUPERMARKET
 ST. JOHNSBURY, VERMONT
CROSS SECTIONS

DESIGNED BY	JGNS	DATE	JAN. 16, 1995
CHECKED BY	R15524P		
PLOT DATE			
SHEET 17		OF 21	

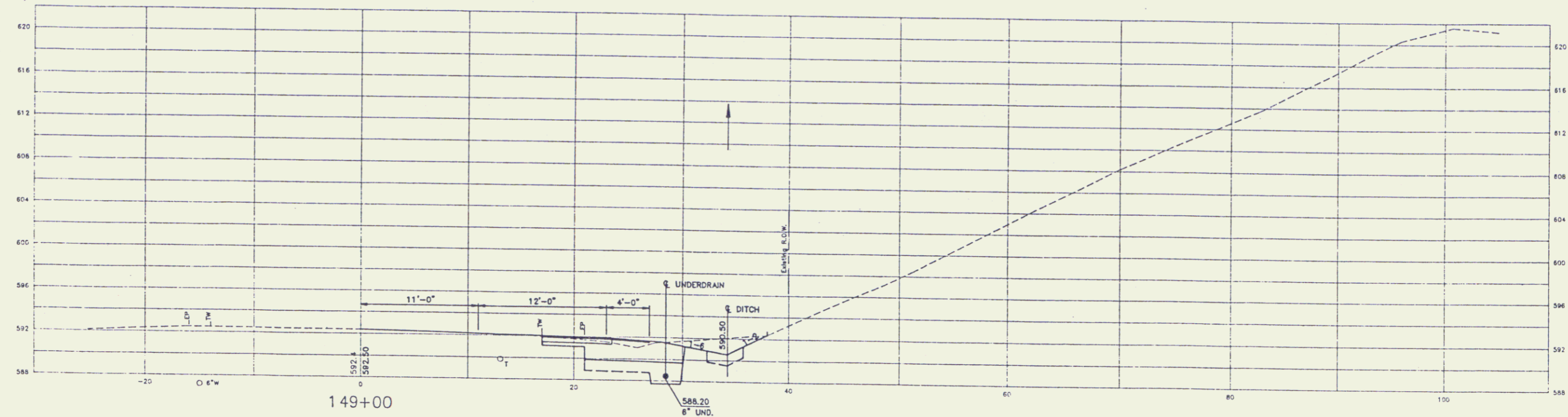

STA. 148+43 RT. 30' TO STA. 149+75 RT. 28.5'
 CONST. 130x6 UNDERDRAIN (TIE TO EXISTING D.I.
 AT STA. 143+43 RT.29')

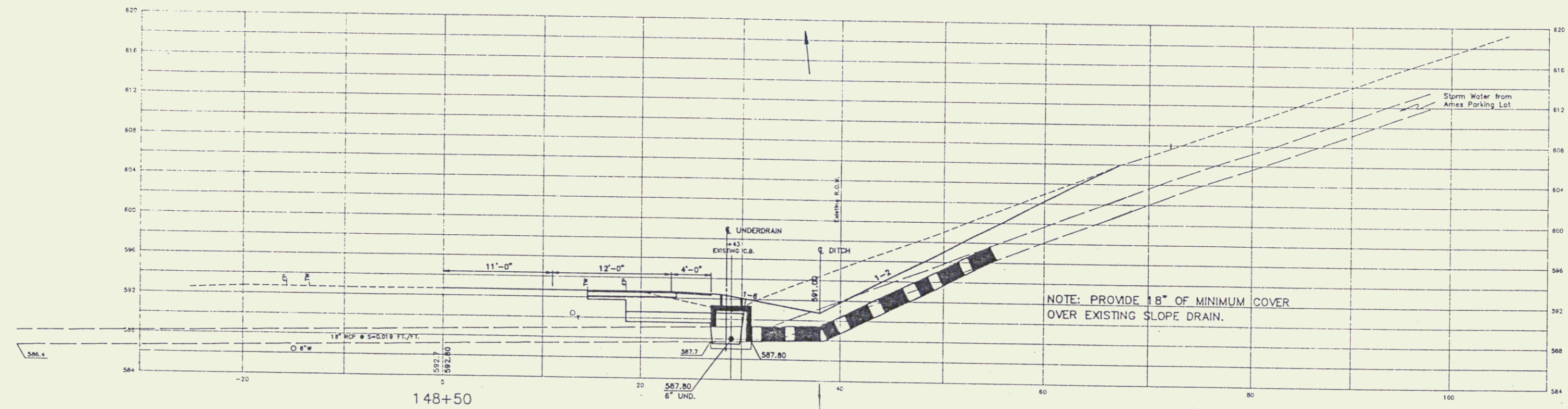

STA. 148+43 RT. 30' TO 55'
 RE-CONSTRUCT EXISTING D.I. TO A
 DRAINAGE MANHOLE
 RE-CONST. 25x18 CMP SLOPE DRAIN
 AND RE-CONNECT TO EXISTING DRAINAGE STRUCTURE.

NOTE
 THE UTILITY LOCATIONS SHOWN ON THE PLANS ARE APPROXIMATE AND HAVE BEEN PLOTTED BASED ON INFORMATION OBTAINED FROM RECORD PLANS. UNDERGROUND TELEPHONE HAS BEEN PLOTTED WITH AN ASSUMED DEPTH OF COVER OF 24". WATER LINES HAVE BEEN PLOTTED WITH AN ASSUMED DEPTH OF COVER OF 5'-0".

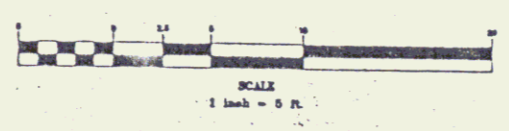
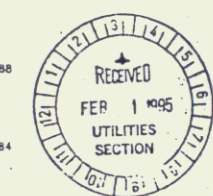

NO.	DATE	REVISIONS	BY	CHK'D



MURPHY PROPERTIES, INC.
 PRICE CHOPPER SUPERMARKET
 ST. JOHNSBURY, VERMONT

CROSS SECTIONS

DRAWN BY	GNS	DATE	JAN. 16, 1995
CHECKED BY	R13524P	PROJECT NO.	R13524P
SCALE	AS SHOWN	SHEET NO.	18 OF 21

JAN 27 1995

THE CONTRACTOR SHALL NOTIFY "DIGSAFE" AT (800) 225-4977 PRIOR TO ANY EXCAVATION.

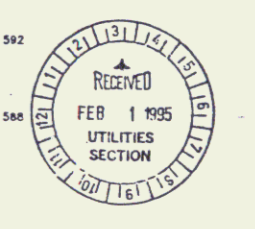
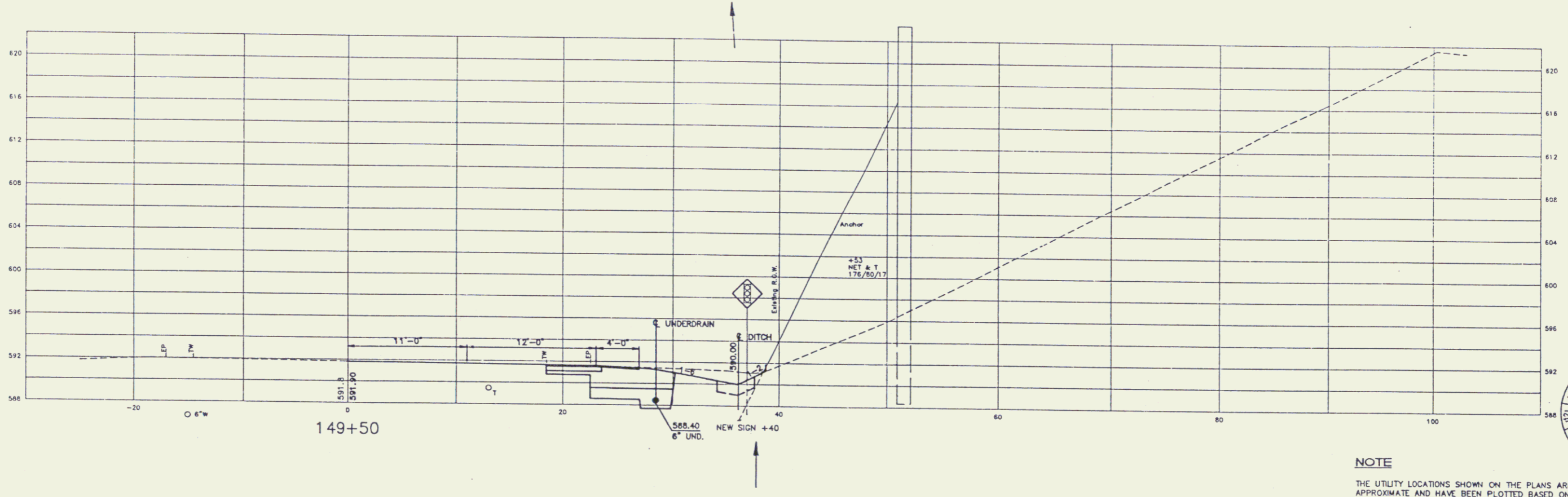
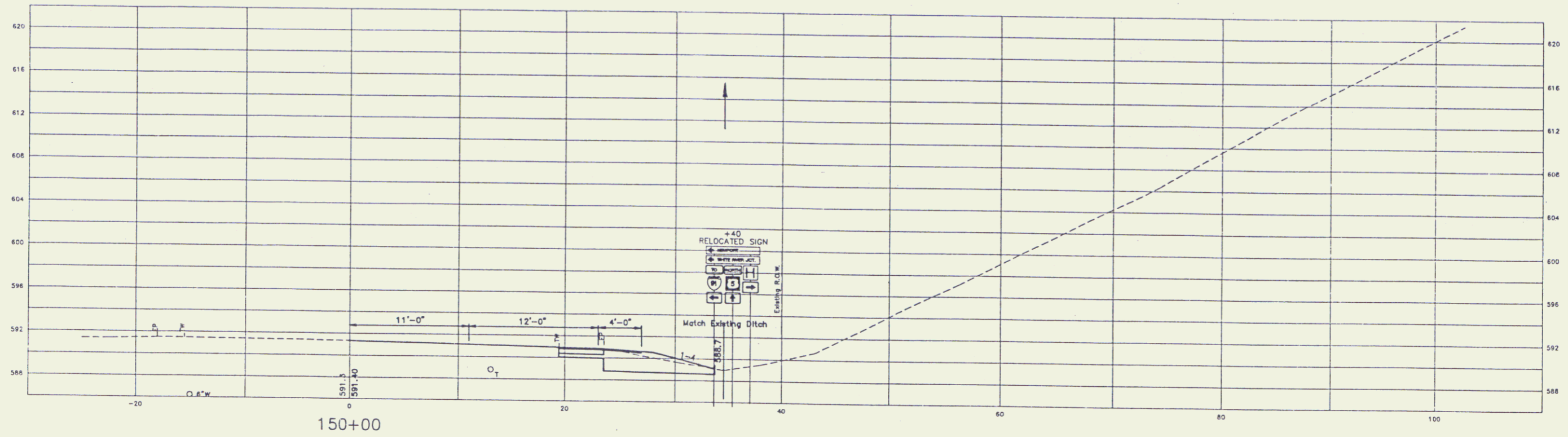

NOTE
 THE UTILITY LOCATIONS SHOWN ON THE PLANS ARE APPROXIMATE AND HAVE BEEN PLOTTED BASED ON INFORMATION OBTAINED FROM RECORD PLANS. UNDERGROUND TELEPHONE HAS BEEN PLOTTED WITH AN ASSUMED DEPTH OF COVER OF 24". WATER LINES HAVE BEEN PLOTTED WITH AN ASSUMED DEPTH OF COVER OF 5'-0".

THE CONTRACTOR SHALL NOTIFY "DIOSAFE" AT (800) 225-4977 PRIOR TO ANY EXCAVATION.

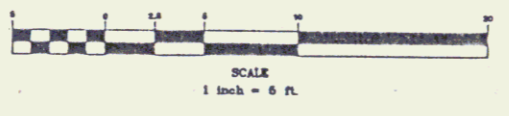

NO.	DATE	REVISIONS	BY	CHK'D

DuBois & King
 engineering planning management development

MURPHY PROPERTIES, INC.
 PRICE CHOPPER SUPERMARKET
 ST. JOHNSBURY, VERMONT
CROSS SECTIONS

DESIGNED BY	DATE
CHK'D BY	PROJ. NO.
PLANNED BY	DATE
SHEET 19 OF 21	

19

STA. 151+40 END WORK AHEAD

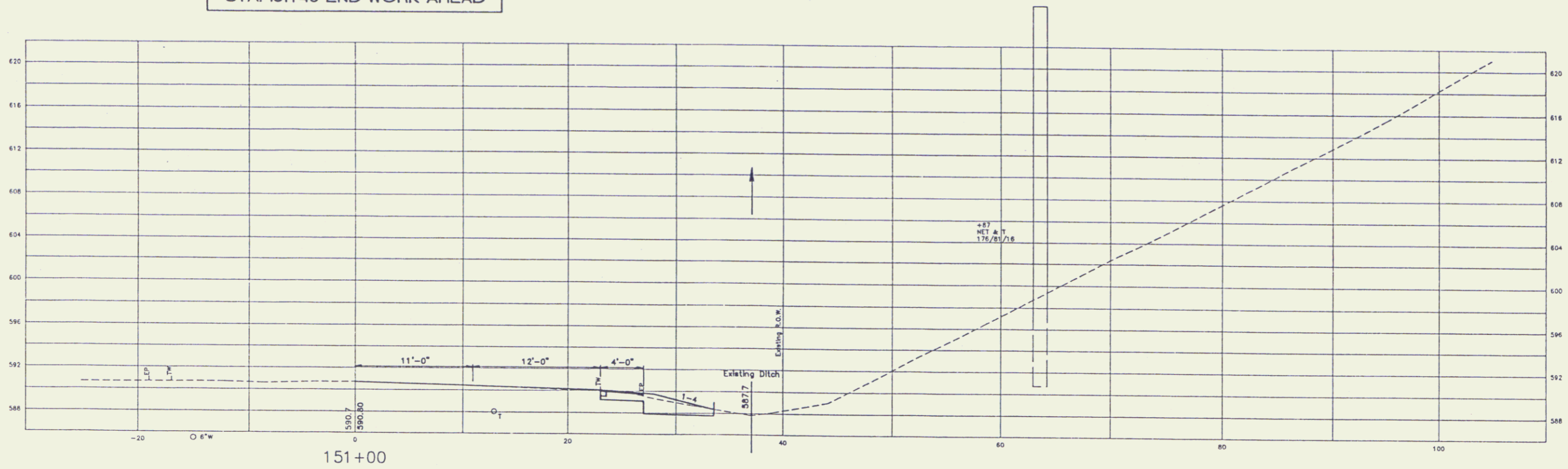

151+00

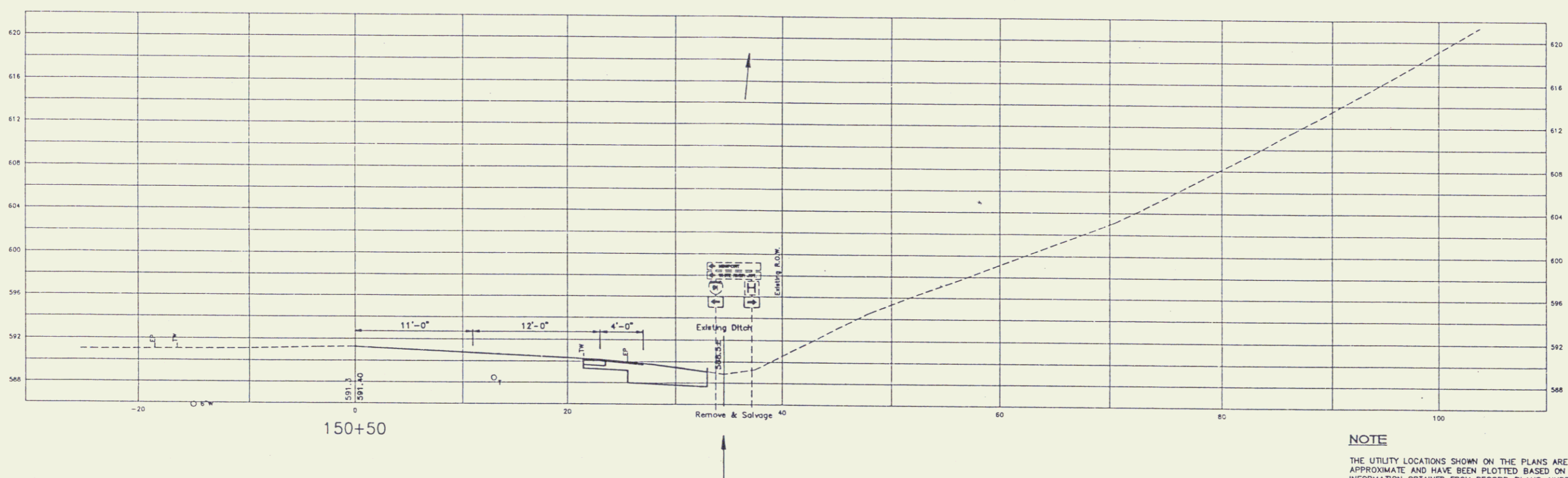

150+50

NOTE
 THE UTILITY LOCATIONS SHOWN ON THE PLANS ARE APPROXIMATE AND HAVE BEEN PLOTTED BASED ON INFORMATION OBTAINED FROM RECORD PLANS. UNDERGROUND TELEPHONE HAS BEEN PLOTTED WITH AN ASSUMED DEPTH OF COVER OF 24". WATER LINES HAVE BEEN PLOTTED WITH AN ASSUMED DEPTH OF COVER OF 5'-0".

THE CONTRACTOR SHALL NOTIFY "DIGSAFE" AT (800) 225-4977 PRIOR TO ANY EXCAVATION.

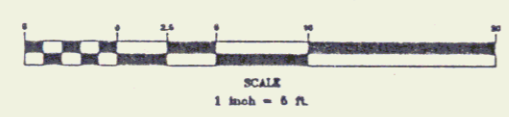
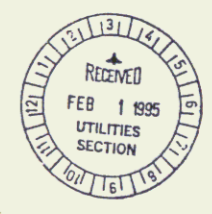

NO.	DATE	REVISIONS	BY	CHK'D

DuBois & King
 engineering planning management development

MURPHY PROPERTIES, INC.
 PRICE CHOPPER SUPERMARKET
 ST. JOHNSBURY, VERMONT
CROSS SECTIONS

DESIGNED BY GNS	DATE NOV 1994
CHECKED BY R13524P	PROJECT NO. R13524P
PROJECT ENG.	DRAWN BY
SHEET 20 OF 21	

20

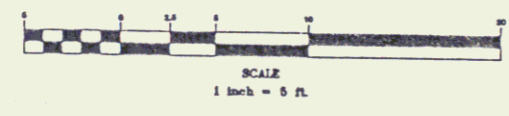
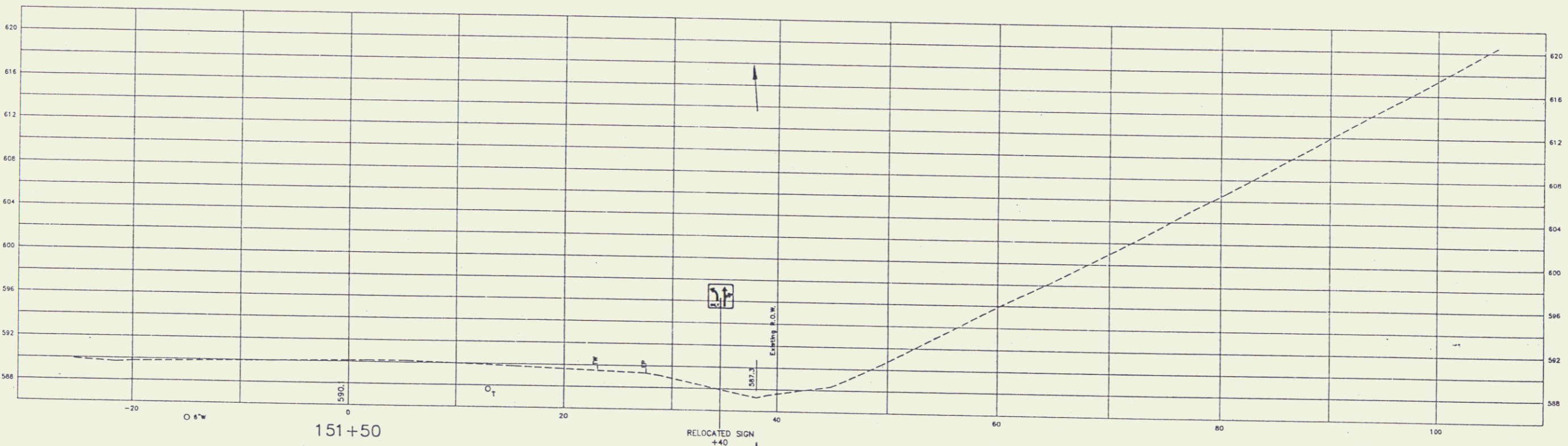
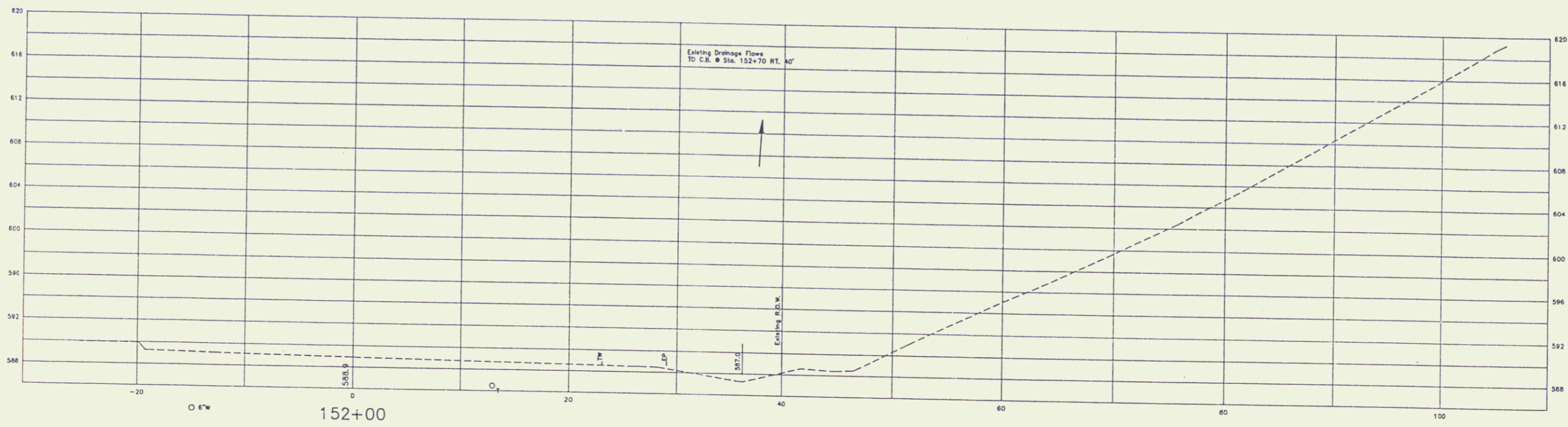

NO.	DATE	REVISIONS	BY	CHK'D

DuBois & King
 engineering planning management development

MURPHY PROPERTIES, INC.
 PRICE CHOPPER SUPERMARKET
 ST. JOHNSBURY, VERMONT
CROSS SECTIONS

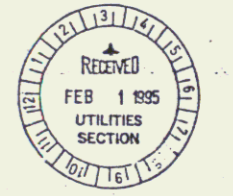

DRAWN BY GNS	DATE NOV 1994
CHECKED BY R13524P	PROJ. NO. R13524P
PROJ. ENG.	DRAW. NO.
SHEET 21 OF 21	

21