

P.L. STA. 142+82.33
 $\Delta = 01^{\circ}47'01''$
 $R = 2685.00'$
 $T = 41.79'$
 $L = 83.58'$
 $CH = 83.58'$
 $EX = 0.33'$

STA. 143+38 BEGIN WORK 3571
 SAWCUT PAVEMENT 1.25" @ STA. 143+38
 COLD PLANE EXISTING PAVEMENT @ 50:1 TAPER
 STA. 143+38 TO 144+00 (SEE COLD PLANE DETAIL)

P.L. STA. 145+42.02
 $\Delta = 121^{\circ}18'17''$
 $R = 900.00'$
 $T = 95.71'$
 $L = 193.28'$
 $CH = 190.36'$
 $EX = 5.21'$

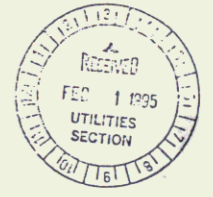
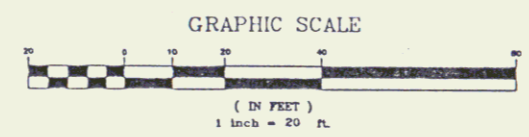
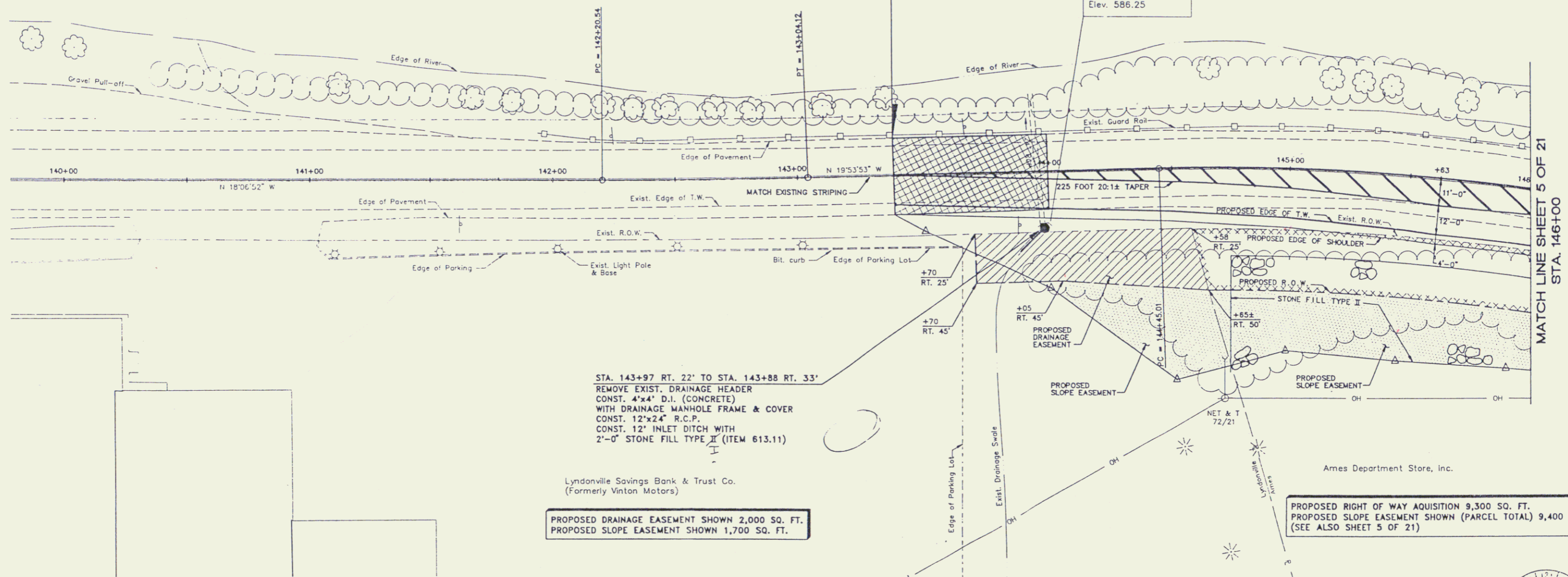

	MURPHY PROPERTIES, INC. PRICE CHOPPER SUPERMARKET ST. JOHNSBURY, VERMONT	DRAWN BY: GNS DATE: JAN. 17, 1995
	ROADWAY LAYOUT, GRADING AND DRAINAGE PLAN	CHECKED BY: [] PERM. NO.: R13524P
	SHEET 17 OF 21 4	DRAWN BY: [] DATE: []