

Culv Station	Lt.	Rt.
1194+49	1	1
1201+42	1	1
1203+26	1	1
1226+01	1	1

Culv Station	Lt.	Rt.
1221+09	2	2

Sta - 316	Lt.	Rt.	Arches
1210+00-1214+68	1	1	2
1219+60-1221+60	2	2	2
1234+00-1235+28 48' 48"	4	4	4

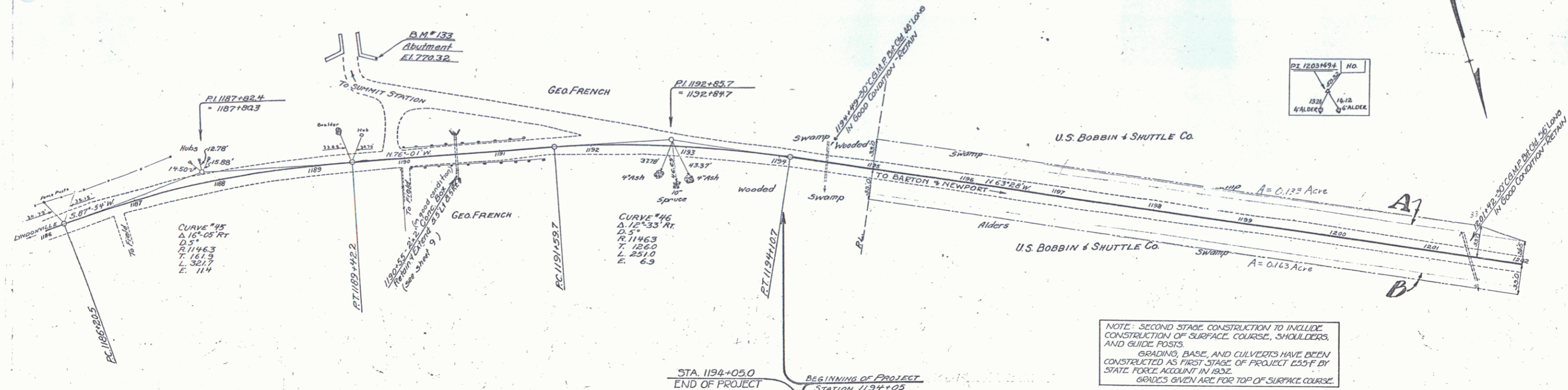
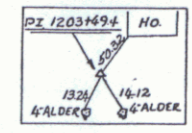
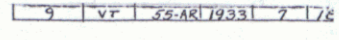

NOTE: SECOND STAGE CONSTRUCTION TO INCLUDE CONSTRUCTION OF SURFACE COURSE, SHOULDERS, AND GUIDE POSTS. GRADING, BASE, AND CULVERTS HAVE BEEN CONSTRUCTED AS FIRST STAGE OF PROJECT E55-F BY STATE FORCE ACCOUNT IN 1932. GRADES GIVEN ARE FOR TOP OF SURFACE COURSE.

PARCEL	Instrument Date	GRANTOR	GRANTEES	RECORDED	REMARKS
A-A	11-20-28	Q.C.D.	2-3-33	U.S. BOBBIN & SHUTTLE CO.	ST. 11
B-B					

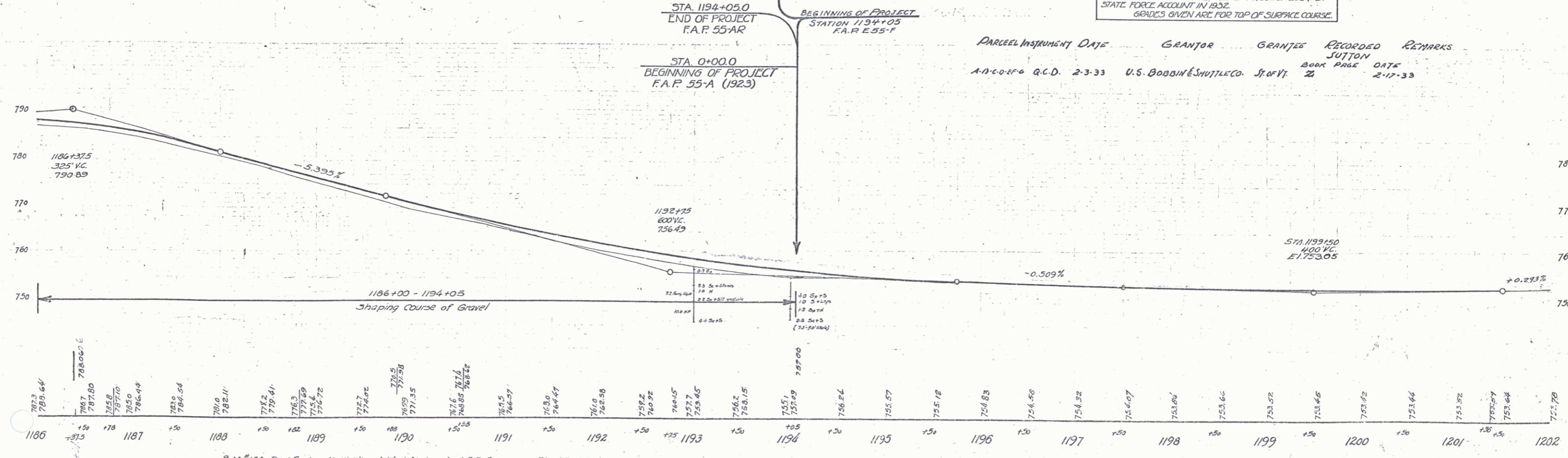

Station	Elevation
1186	787.3
1187	785.64
1188	787.80
1189	785.8
1190	787.70
1191	785.0
1192	786.44
1193	786.04
1194	786.11
1195	782.41
1196	786.3
1197	787.49
1198	785.4
1199	786.72
1200	782.7
1201	786.46
1202	785.92

D.M. 133 Faint Spot on North Wing of West Abutment of R.R. Overpass Elev. 770.32

SUTTON SERIES E E 55-F SHEET 14 OF 14