

FEED ROAD DIST. NO.	STATE	FED. AID PROJ. NO.	FISCAL YEAR	SHEET NO.	TOTAL SHEETS
9	VT	2-55-F	1933	4	14
				7	18

GUIDE POSTS REQUIRED

Curve Station	LT	RT
1184+49	1	1
1201+42	1	1
1203+26	1	1
1226+01	1	1

WOOD GUARD RAIL REQUIRED

Curve Station	LT	RT
1221+09	28'	28'

CADLE GUARD RAIL REQUIRED

Sta - Sta	LT	RT	Anchors
1204+00-1214+00	140'	2	
1204+00-1214+00 - 200'	2		
1234+00-1239+00 68' 68'	4		

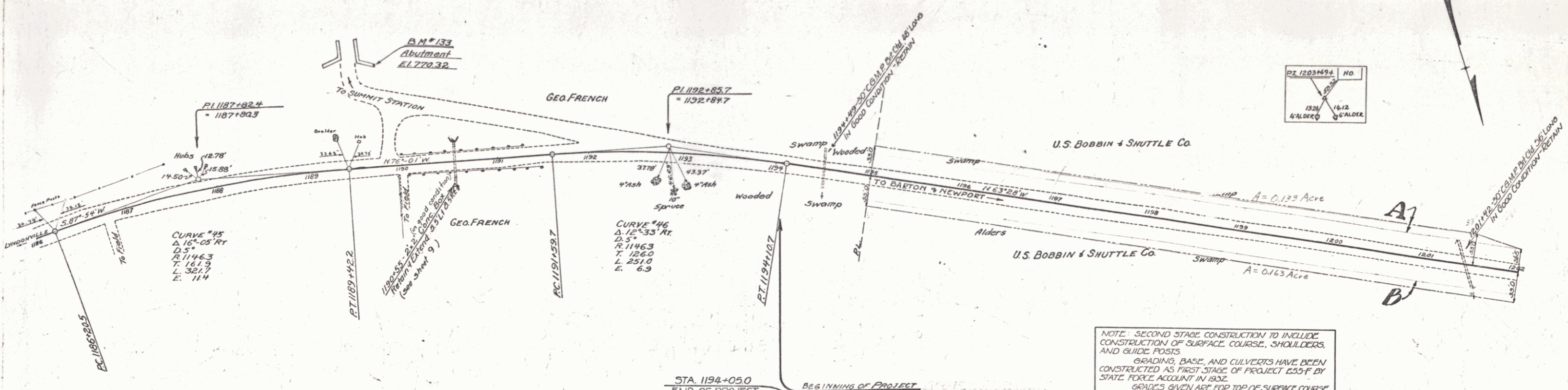

NOTE: SECOND STAGE CONSTRUCTION TO INCLUDE CONSTRUCTION OF SURFACE COURSE, SHOULDERS, AND GUIDE POSTS. GRADING, BASE, AND CULVERTS HAVE BEEN CONSTRUCTED AS FIRST STAGE OF PROJECT E55-F BY STATE FORCE, ACCOUNT IN 1932. GRADICES GIVEN ARE FOR TOP OF SURFACE COURSE.

PARCEL INSTRUMENT DATE	GRANTOR	GRANTEE	RECORDED	REMARKS
A-1-0-0-0 Q.C.D. 2-3-33	U.S. BOBBIN & SHUTTLE CO.	STAFF	26	2-17-33

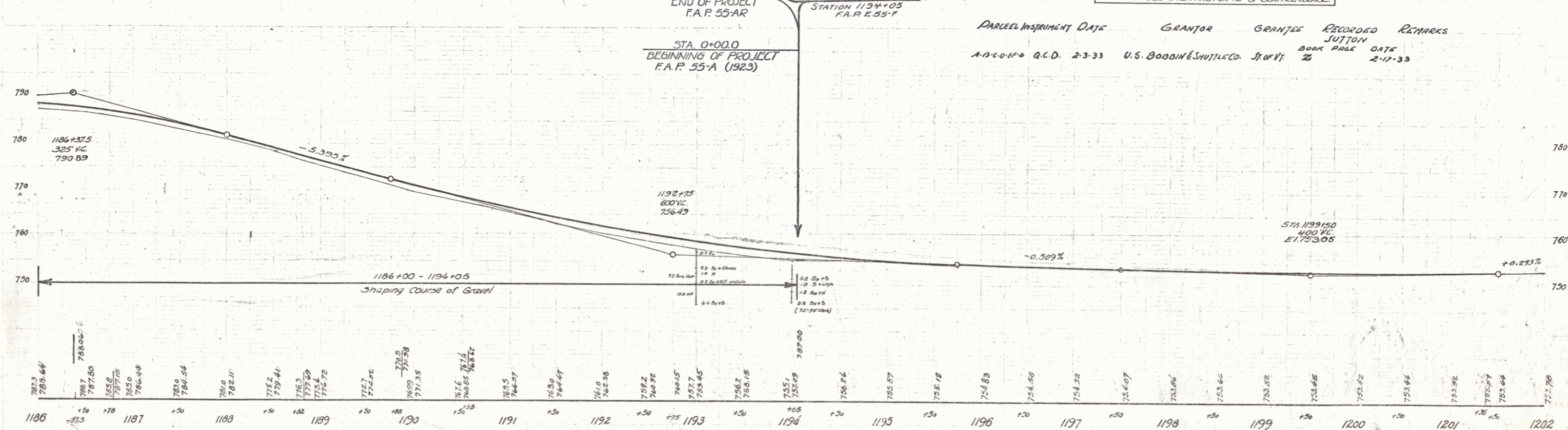

D.M. #133 Paint Spot on North Wing of West Abutment of R.R. Overpass Elev. 770.32

SUTTON
SERIES F E 55-F
SHEET 4 OF 14
SERIES F E 55-AR
SHEET 7 OF 18