

**INDEX OF SHEETS**

SHEET NO.	DESCRIPTION
1.	Title Page
2-3.	Typical Sections
4.	Item Quantity & Drainage Sheet
5.	Earthwork Sheet
6.	S.U.W. Detail Sheet
7-8.	Plan & Profile Sheet
9.	20 Scale Detail of Intersection
10.	Blank
11.	A-1 Solid Rock Excavation
12.	B-1 Banking Tables
13.	C-1 Curb and Slope Edging
14.	D-5 Drop Inlets
15.	D-10 Drop Inlet Tops
16.	D-11 Cast Iron Grates
17.	D-13 Catch Basin or Manhole
18.	E-1 Barricades, Signs and Lights
19.	J-1 Project & Boundary Markers
20.	Blank
21-26.	Cross Sections

**STATE OF VERMONT  
DEPARTMENT OF HIGHWAYS**

**PROPOSED IMPROVEMENT**

**TOWN OF LYNDON  
COUNTY OF CALEDONIA  
U.S. ROUTE 5  
ST. JOHNSBURY-NEWPORT RD.**

A REDESIGN OF THE PRESENT  
INTERSECTION OF ROUTES U.S. 5 & VT. 114  
LENGTH OF PROJECT 750.00 FEET = 0.142 MILES

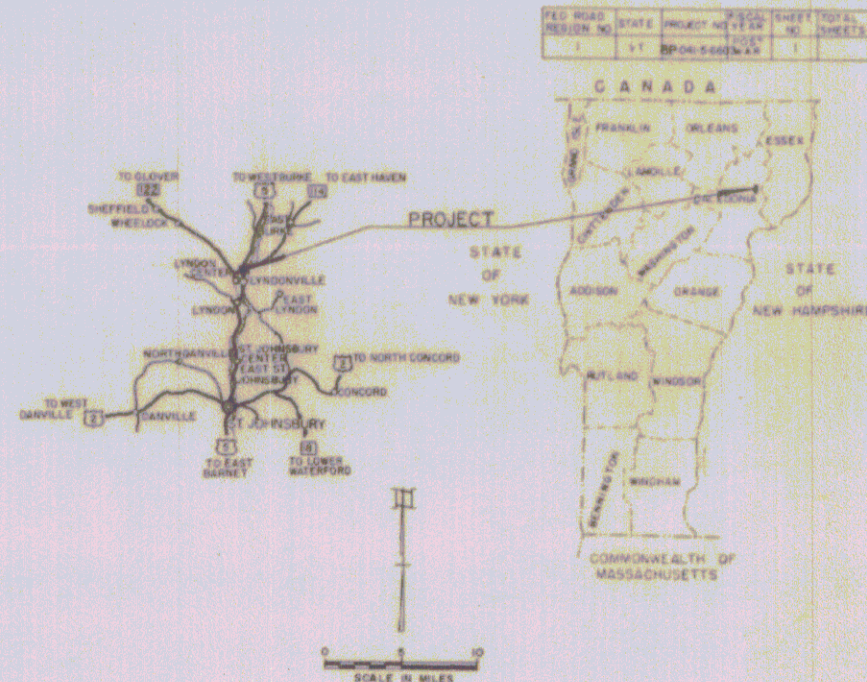

**CONVENTIONAL SIGNS**

COUNTY LINE	---
TOWN LINE	---
FENCE LINE	---
STONE WALL	---
UNFENCED PROPERTY	---
GUARD RAIL	---
TRAVELED WAY	---
RAILROAD	---
RETAINING WALL	---
CENTER LINE	---
SURVEY LINE	---
CULVERT	---
DROP INLET	---
TROLLEY POLE	---
POWER POLE	---
TELEPHONE POLE	---
TREES	---
HEDGE	---

**CURVE DATA**

DEFLECTION OF ANGLE	Δ
DEGREE OF CURVE	D
RADIUS OF CURVE	R
TANGENT DISTANCE	T
LENGTH OF CURVE	L
EXTERNAL DISTANCE	E
POINT OF INTERSECTION	P.I.
POINT OF CURVE	P.C.
POINT OF TANGENT	P.T.
POINT ON TANGENT	P.O.T.
POINT ON SUB-TANGENT	POST

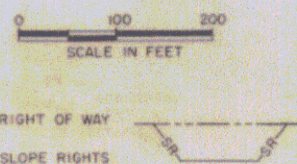

THESE PLANS ARE SUBJECT TO SUCH REVISIONS AS MAY BE REQUIRED BY THE BUREAU OF PUBLIC ROADS OR THE COMMISSIONER OF HIGHWAYS.

CONSTRUCTION IS TO BE CARRIED ON IN ACCORDANCE WITH THESE PLANS AND THE STANDARD SPECIFICATIONS FOR HIGHWAY AND BRIDGE CONSTRUCTION, DATED APRIL, 1964, AS APPROVED BY THE BUREAU OF PUBLIC ROADS ON OCTOBER 2, 1964, INCLUDING ALL SUBSEQUENT APPROVED REVISIONS AND SUCH REVISED SPECIFICATIONS AND SPECIAL PROVISIONS AS ARE INCORPORATED IN THESE PLANS.

APPROVED <i>E. W. Cleburne</i> ASST. CHIEF ENGINEER DATE 8/2/66	APPROVED <i>B. J. Leland</i> SUPERVISOR ENGINEER DATE 9/2/66	APPROVED _____ BRIDGE ENGINEER DATE _____	APPROVED <i>P. M. Stinson</i> DISTRICT ENGINEER DATE 8/10/66	APPROVED <i>G. W. Lunt</i> HIGHWAY ENGINEER DATE 8/18/66	APPROVED <i>P. A. Curran</i> CHIEF ENGINEER DATE 8/17/66 SUBMITTED BY ORDER OF THE STATE HIGHWAY BOARD
---	--	---	--	--	---

Pin # 992216  
Date 11/19/66

DEPARTMENT OF COMMERCE  
BUREAU OF PUBLIC ROADS

APPROVED \_\_\_\_\_  
DIVISION ENGINEER DATE \_\_\_\_\_

PROJECT BP NO. 041-5-6603

SHEET 1 OF 26 SHEETS

CONSTRUCT DRIVES  
 U.S. 443+87 Rt. (40')  
 U.S. 449+70 Lt. (40') Paved  
 U.S. 449+40 Lt. (40')  
 U.S. 451+60 Lt. (40') Paved  
 Ramp A 5+23 Rt. (40')  
 Vt. Rte. 114-7+00 Rt. (40')  
 Vt. Rte. 114-5+25-7+00 Rt. (20') in trailer park  
 Ramp 1+42 Rt. (40')

GRANITE CURB, ITEM 556-B  
 U.S. 447+90-449+60 Rt.  
 449+00-449+20 Rt.  
 449+60-1+02 Ramp A Rt.  
 440+03-449+50 Lt.  
 449+90-451+40 Lt.  
 451+80-452+05 Lt.  
 Ramp A 1+42-1+62 Rt.

TOPSOIL & SEEDING, ITEMS 511 & 521  
 U.S. 451+08-252+75 Rt.  
 Ramp A 1+45-4+40 Lt.  
 Rte. 114-2+60-4+50 Rt.  
 GRANITE SLOPE EDGING  
 ITEM 556-A  
 Rte. 114 2+70-5+53 (& Island)

DEMOLITION & DISPOSAL OF BUILDING, ITEM 596  
 Vt. Rte. 114 3+00 Lt.  
 EXCAVATION & REMOVAL OF ROAD SURFACE and/or PAVEMENTS, ITEM 119  
 1+50-4+50 DAMP 'A'  
 2+50-4+50 Vt. Rte. 114

DRILLING & BLASTING OF SOLID ROCK SUBGRADE, ITEM 115  
 Vt. Rte. 114 2+50-3+00  
 4+50-7+00

REMOVAL & DISPOSAL OF PRESENT GUARD RAIL, ITEM 549  
 452+00-457+50 Rt. (U.S. Rte. 5)

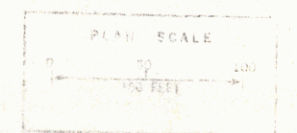
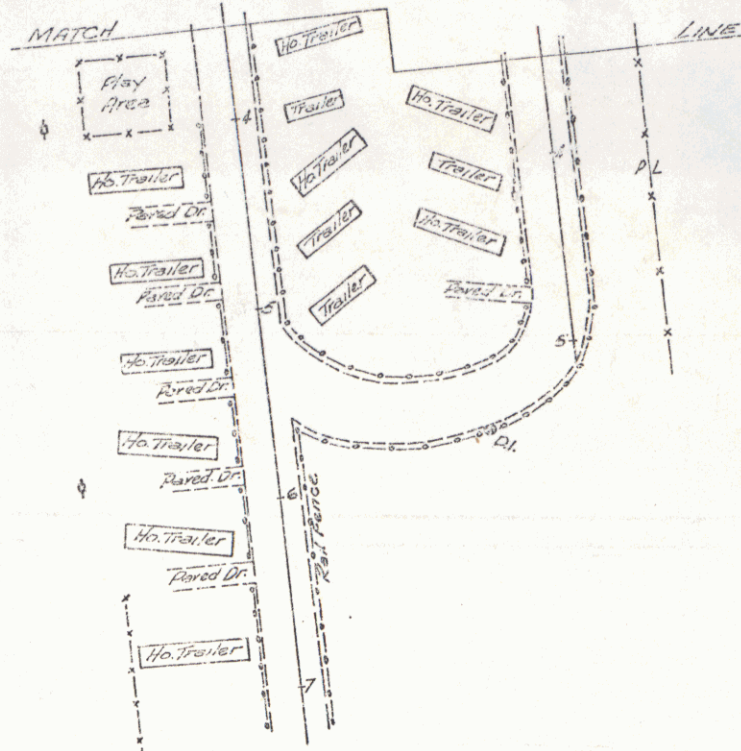
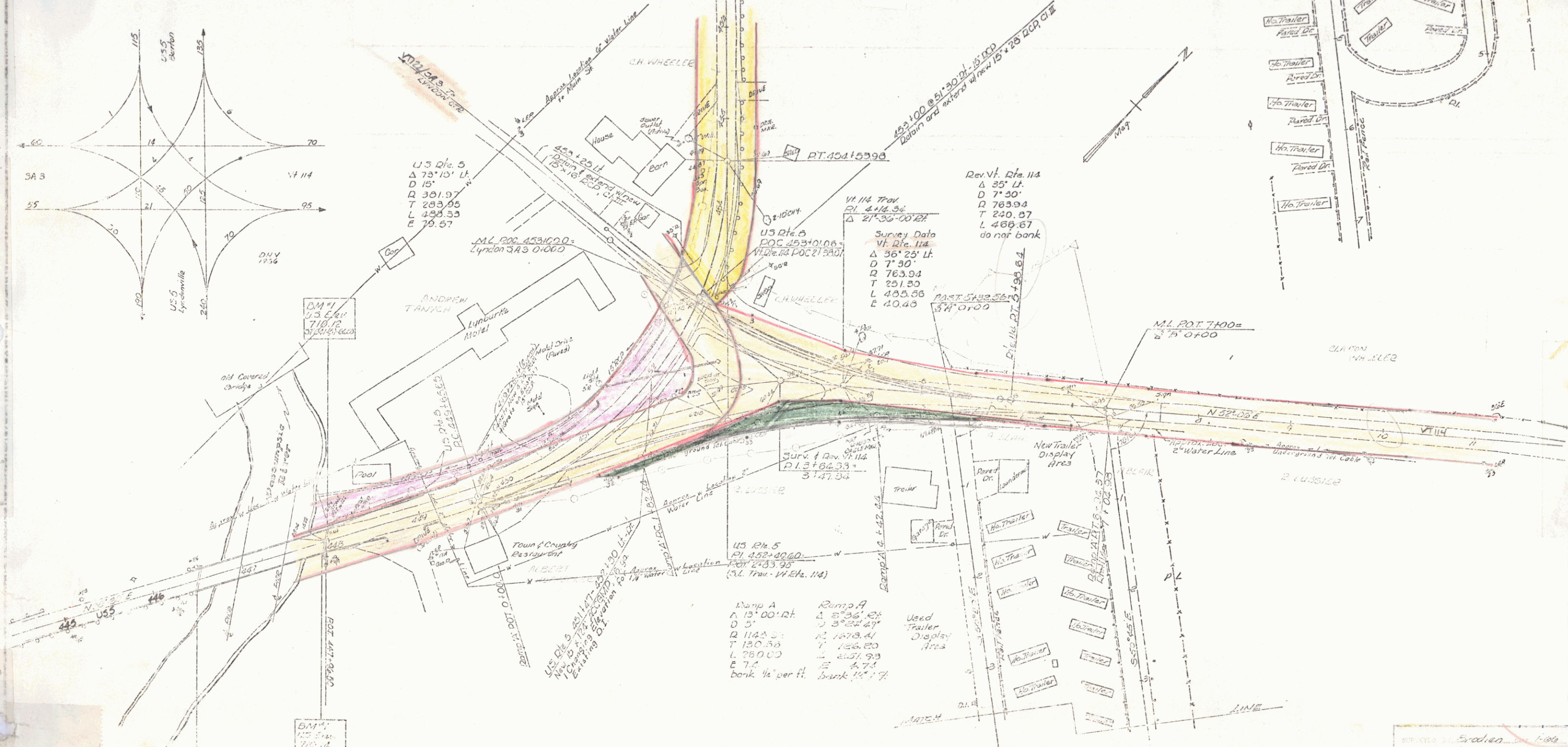
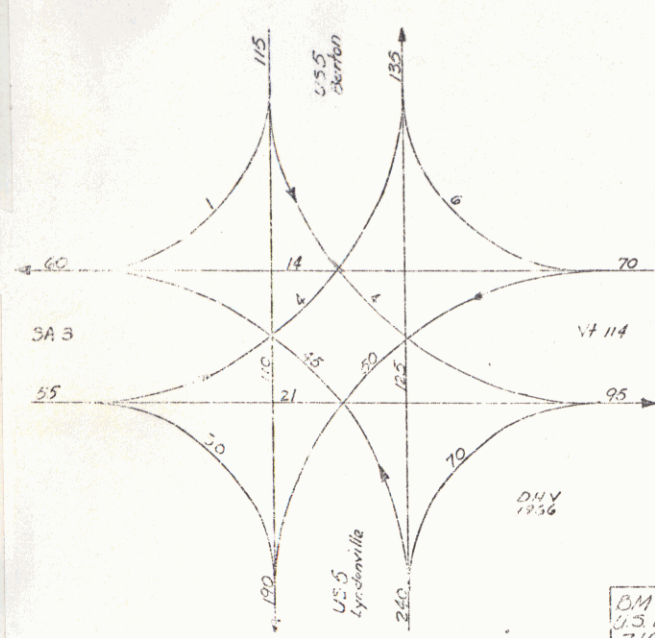

Project: **BP 0415-6603**  
 2

POOR ORIGINAL COPY

CONSTRUCT DRIVE	594.75-6023 ITEM 556-B	TOP-OIL + SEEDING ITEM 551-161	DEMOLITION + DISPOSAL OF BUILDING ITEM 555	GRADING + ELASTING OF SOIL
US 5 447+00-451+00	US 5 447+30-450+60	US 5 451+00-453+75	US 5 451+00-453+75	US 5 451+00-453+75
US 5 451+70-453+75	US 5 451+70-453+75	Ramp A 1+40-4+40	Ramp A 1+40-4+40	Ramp A 1+40-4+40
US 5 451+70-453+75	US 5 451+70-453+75	Ramp A 1+40-4+40	Ramp A 1+40-4+40	Ramp A 1+40-4+40
US 5 451+70-453+75	US 5 451+70-453+75	Ramp A 1+40-4+40	Ramp A 1+40-4+40	Ramp A 1+40-4+40
US 5 451+70-453+75	US 5 451+70-453+75	Ramp A 1+40-4+40	Ramp A 1+40-4+40	Ramp A 1+40-4+40
US 5 451+70-453+75	US 5 451+70-453+75	Ramp A 1+40-4+40	Ramp A 1+40-4+40	Ramp A 1+40-4+40
US 5 451+70-453+75	US 5 451+70-453+75	Ramp A 1+40-4+40	Ramp A 1+40-4+40	Ramp A 1+40-4+40
US 5 451+70-453+75	US 5 451+70-453+75	Ramp A 1+40-4+40	Ramp A 1+40-4+40	Ramp A 1+40-4+40
US 5 451+70-453+75	US 5 451+70-453+75	Ramp A 1+40-4+40	Ramp A 1+40-4+40	Ramp A 1+40-4+40

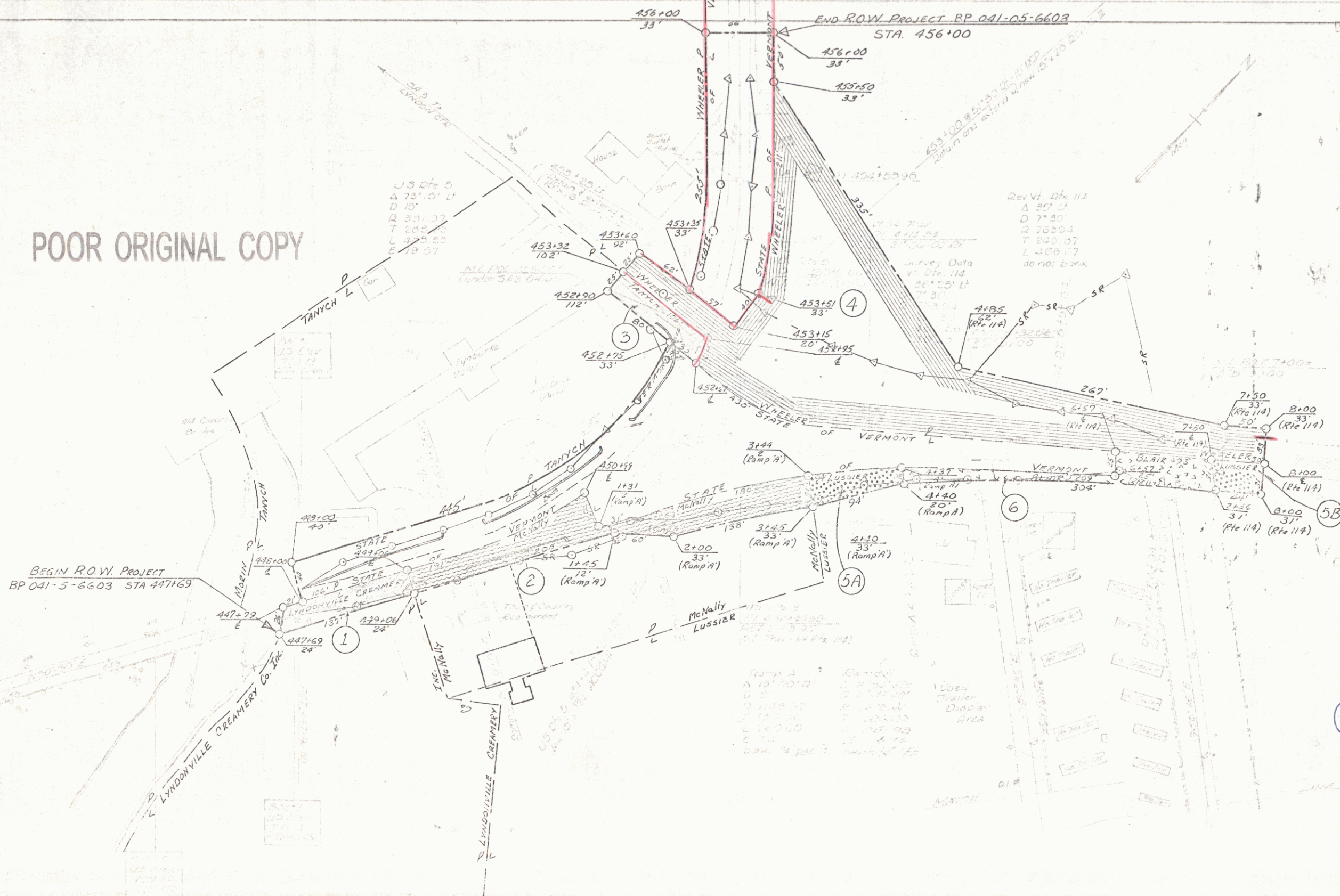

Row not acquired

DATE: 5/1/50  
 DRAWN BY: [Signature]  
 CHECKED BY: [Signature]  
 TITLE: [Blank]  
 SHEET: 5