

CONSTRUCT DRIVES  
 U.S. 443+87 Rt. (40')  
 U.S. 449+70 Lt. (40') Paved  
 U.S. 449+40 Lt. (40')  
 U.S. 451+60 Lt. (40') Paved  
 Ramp A 5+23 Rt. (40')  
 Vt. Rte. 114-7+00 Rt. (40')  
 Vt. Rte. 114-5+25-7+00 Rt. (20') in trailer park  
 Ramp 1+22 Rt. (40')

REMOVAL & DISPOSAL OF PRESENT  
 GUARD RAIL, ITEM 549  
 452+00-457+50 Rt. (U.S. Rte. 5)

GRANITE CURB, ITEM 556-B  
 U.S. 447+90-448+60 Rt.  
 449+00-449+20 Rt.  
 449+60-1+02 Ramp A Rt.  
 440+03-449+50 Lt.  
 449+90-451+40 Lt.  
 451+80-452+05 Lt.  
 Ramp A 1+42-1+62 Rt.

TOPSOIL & SEEDING, ITEMS 511 & 521  
 U.S. 451+08-252+75 Rt.  
 Ramp A 1+45-4+40 Lt.  
 Rte. 114-2+60-4+50 Rt.  
 GRANITE SLOPE EDGING  
 ITEM 556-A  
 Rte. 114 2+70-5+53 (& island)

DEMOLITION & DISPOSAL OF  
 BUILDING, ITEM 596  
 Vt. Rte. 114 3+00 Lt.

EXCAVATION & REMOVAL OF ROAD  
 SURFACE and/or PAVEMENTS,  
 ITEM 119  
 1+50-4+50 DAMP 'A'  
 2+50-4+50 Vt. Rte. 114

DRILLING & BLASTING OF SOLID  
 ROCK SUBGRADE, ITEM 115  
 Vt. Rte. 114 2+50-3+00  
 4+50-7+00

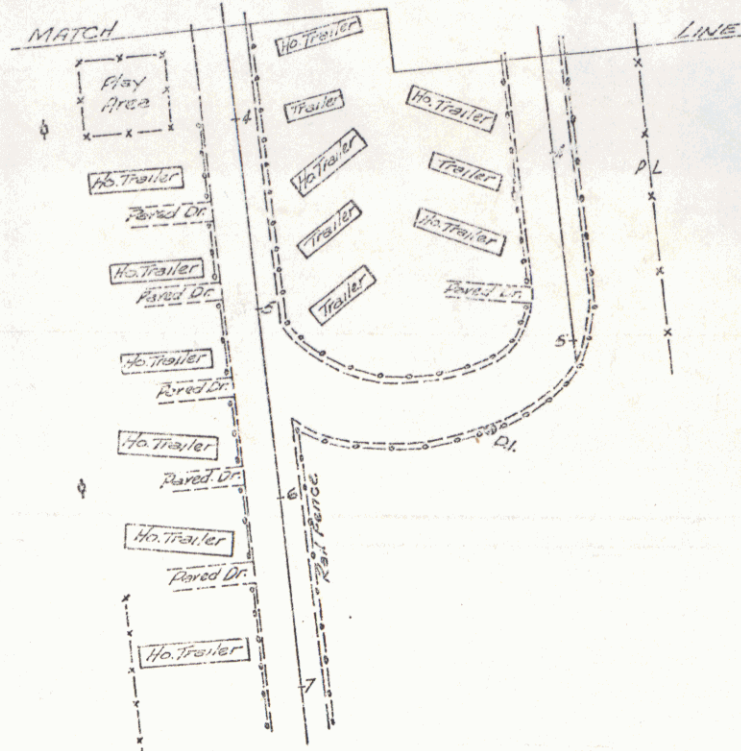
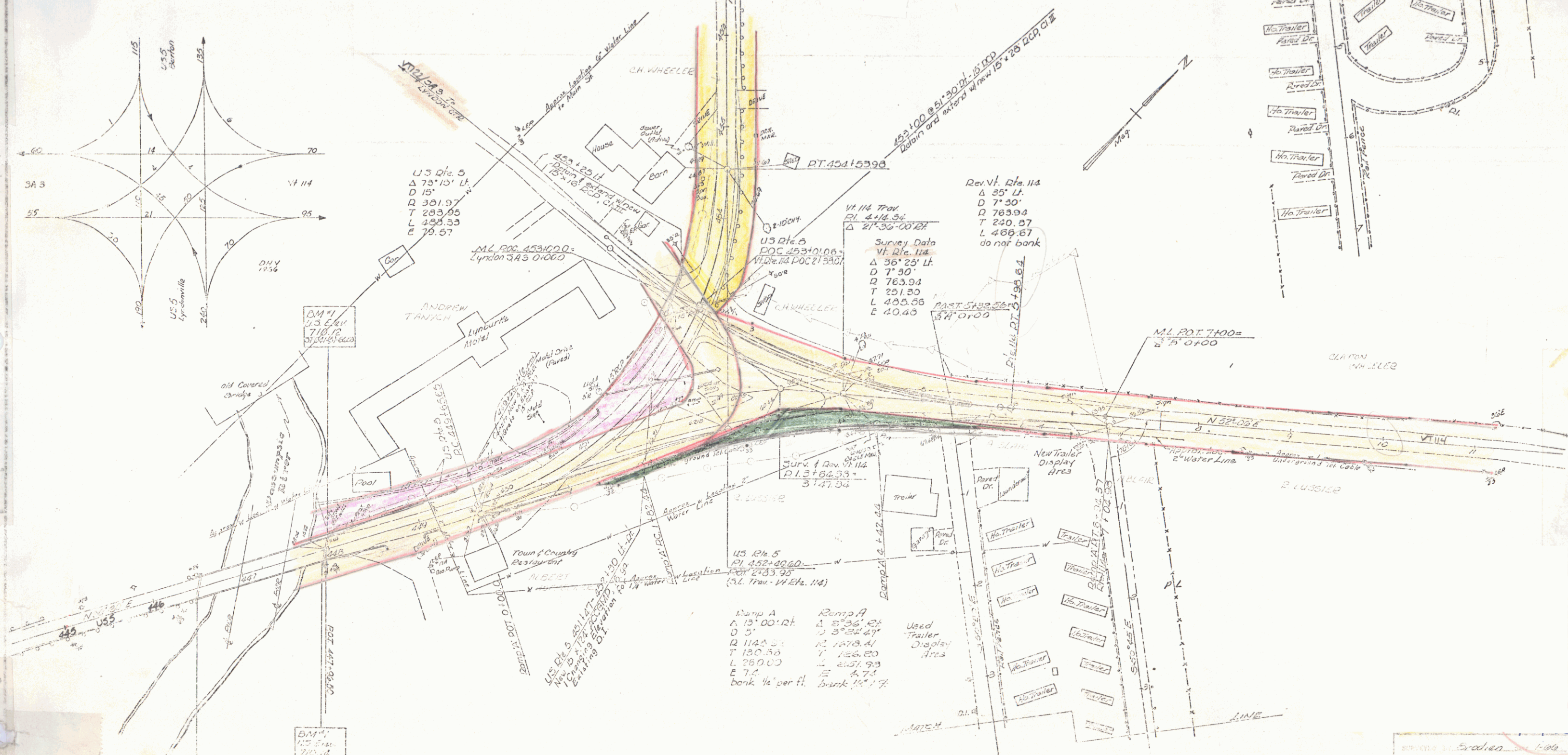
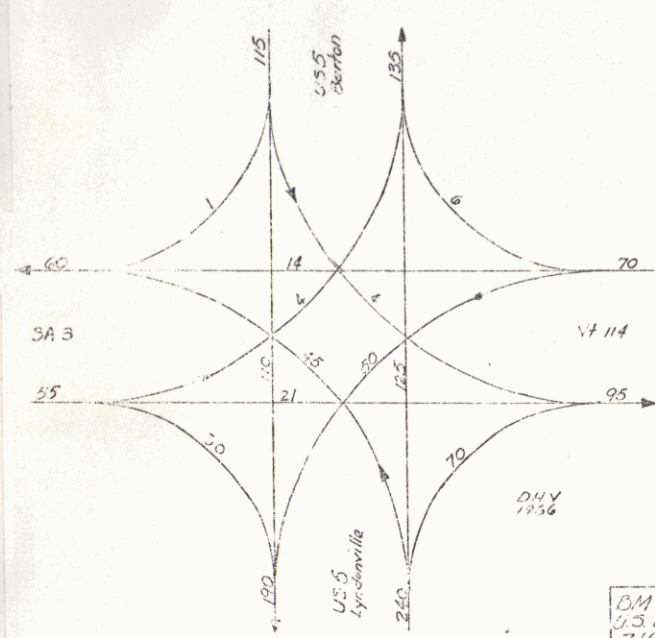

Project  
 BP 0415-6603  
 2