

CONSTRUCT DRIVE	
STATION	POS
10+10	LT
11+00	PT
11+60	RT

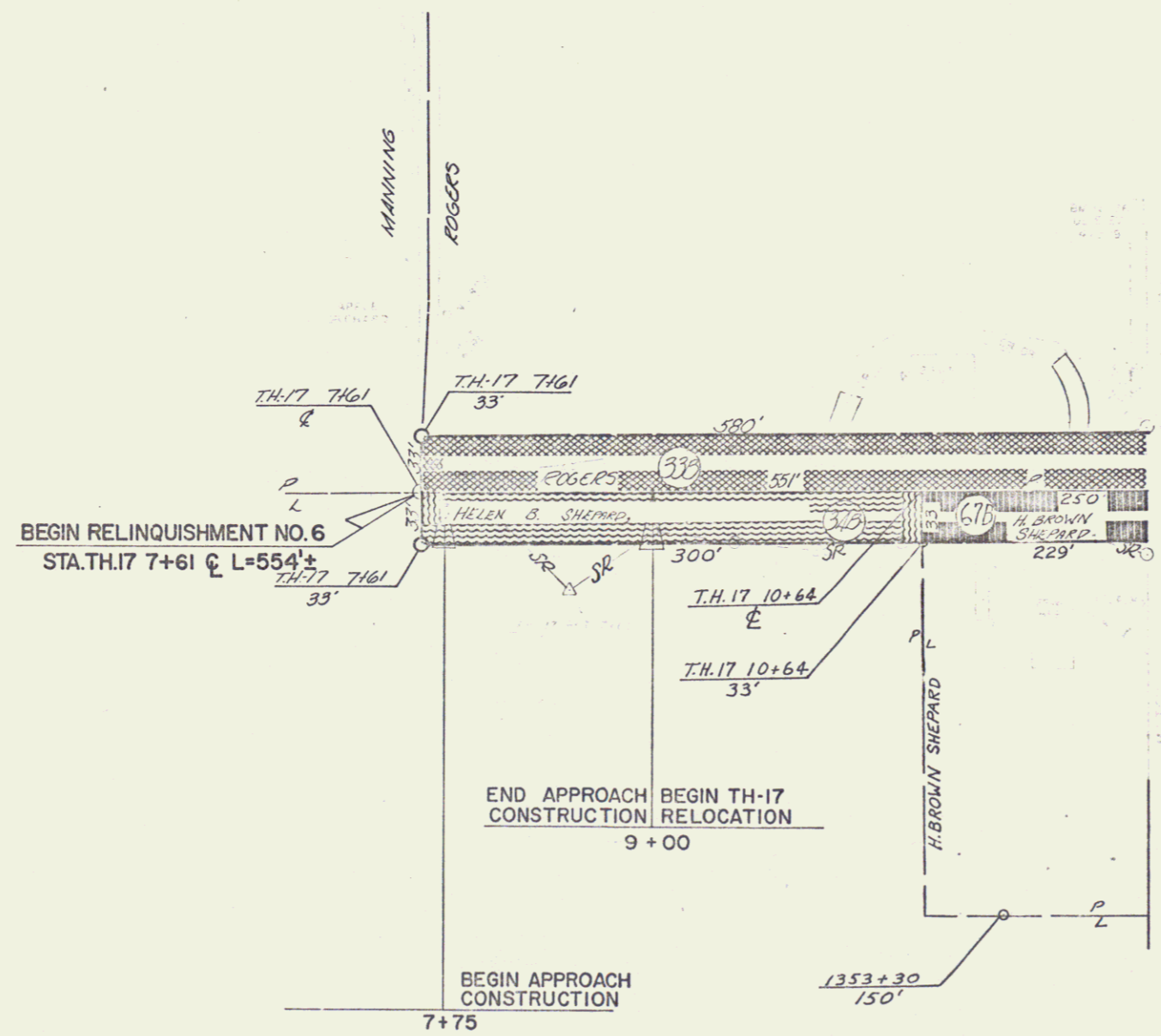

STATE OF MICHIGAN  
 DEPARTMENT OF HIGHWAYS  
 CASTLETON  
 TH-17 RELOCATION  
 PLAN  
 STA. 7+0000 - 12+00.00

0 50 100  
 100 FEET

F 020-1161(8) 39 DEC 1967 75