

PROPERTY LINE FENCE WITH STEEL POSTS ITEM 583-II MOD.		
STATION	STATION	POS.
923+75	925+75	RT
924+25	927+00	LT

SPEED CHANGE LANE		
STATION	STATION	POS.
923+00	924+25	LT

GRANITE SLOPE EDGING ITEM 556-A		
STATION	STATION	POS.
923+00	923+00	-

DEMOLITION AND DISPOSAL OF BUILDING ITEM 586		
STATION	POS.	
923+00	RT	
924+25	RT	

CONSTRUCT DRIVE		
STATION	POS.	
927+00	RT	
930+75	RT	

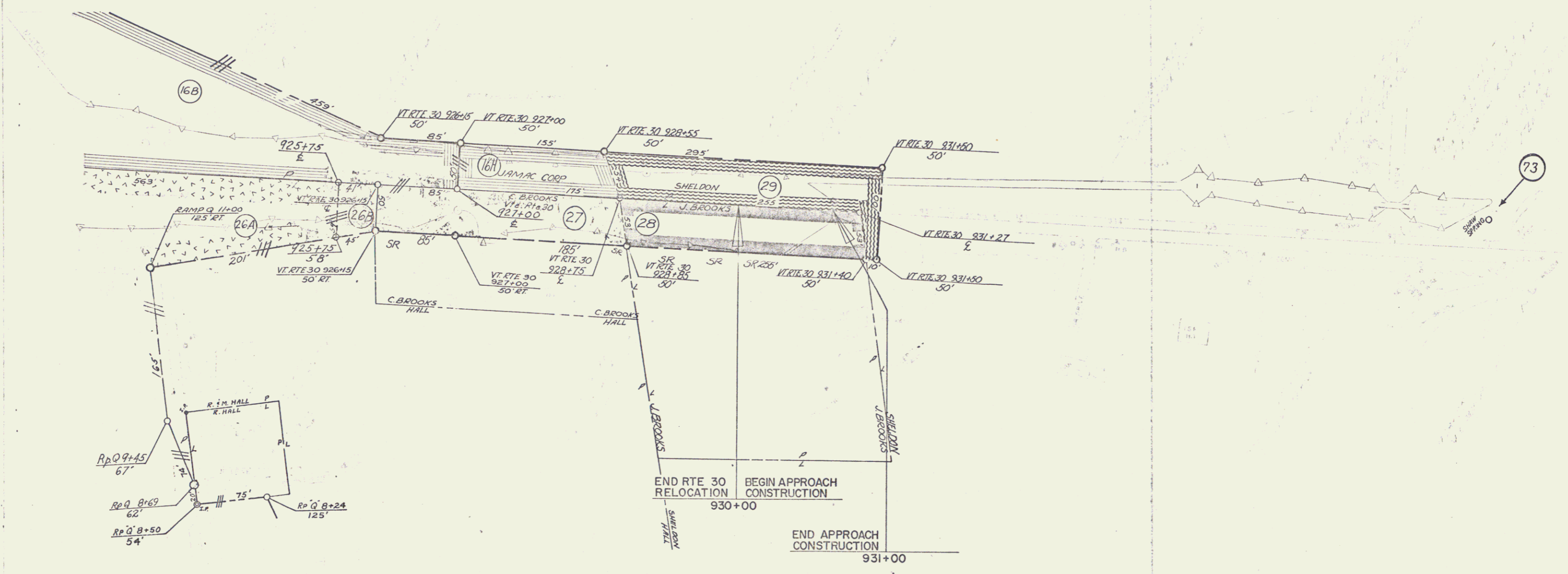

STATE OF VERMONT  
 DEPARTMENT OF TRANSPORTATION  
 RAIL AVENUE, CASTLETON  
 ROUTE 201, BELLEVILLE  
 PLAN  
 11(8) 33 75

14