

INDEX OF SHEETS

SHEET NO.	DESCRIPTION
1	Title Sheet
2	Typical Sheet
3	Typical of Rest Area
4	Alignment Data Sheet
5	County Sheet
6-7	Station Detail and Drainage Sheet
8-12	Earthwork Sheets
13-16	Blank
17	Row Detail Sheet
18-20	Plan and Profile Sheets
21	Blank
22	A-61 Drilling and Blasting of Solid Rock - Subgrade
23	B-1 Banking Tables
24	B-2 Typical Slope Grading
25	B-3 Muck Excavation
26	B-4 Embankment on a Slope
27	B-11 Methods of Slope Stabilization
28	B-15 Entrance and Exit Terminals
29	B-17 Details of Rest Areas
30-40	Blank
41	D-2 Weeds
42	D-3 Jute Matting
43	D-4 Asphalt Corr. Galv. Met. Pipe Elbows
44	D-8 Drop Inlets
45	D-11 Details of Gates and Covers for Drop Inlets
46	D-16 Drop Inlet - Type II
47	D-17 Vertical Risers
48	Blank
49-50	E-1 Barricades, Signs, and Lights
51	E-3 Federal Aid Construction Identification Signs
52	F-1 Property Line Fence
53	Blank
54	J-1 Boundary Markers
55	Blank
56-57	Cross Sections
58	Blank
59-61	Cross Sections
62-63	Chamnel Sections
64	Plan and Profile Sheets

**STATE OF VERMONT
DEPARTMENT OF HIGHWAYS**

PROPOSED IMPROVEMENT

PRIMARY PROJECT

TOWNS OF IRA-W. RUTLAND

COUNTY OF RUTLAND

U.S. ROUTE 4 L.A.

FAIR HAVEN-RUTLAND ROAD

BEGINNING AT A POINT 0.074 MILES
EASTERLY OF THE CASTLETON-IRA TOWN LINE
AND EXTENDING EASTERLY 1.264 MILES.

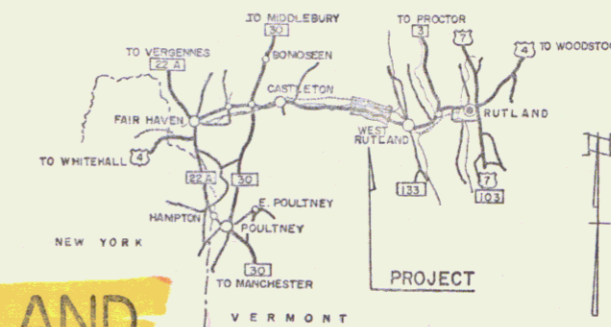

FED. ROAD DISTRICT NO.	STATE	PROJECT NO.	SHEET NO.
VT	FD020-1	116	1

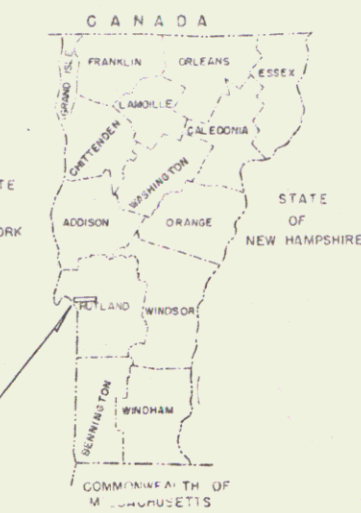

PROJECT NAME & NUMBER STAGE I	
IRA W. RUTLAND F020-1(5) GRADING & DRAINAGE	
RECORD PLANS	
MATERIALS	
SUBBASE OF SAND & GRAVEL BACKFILL - PELLETIER PIT - CASTLETON, VT.	
CONCRETE CLASS B, REINFORCING STEEL & CAST IRON GRATE TYPE A - JOSEPH P. CARRARA & SONS - NO. CLARENDON, VT.	
METAL CULVERT PIPE & CAST IRON GRATE TYPE C - NORTHEASTERN CULV. CORP. - WESTMINSTER, VT.	
ALUMINUM CULVERT PIPE - KAISER ALUMINUM & CHEMICAL SALES, INC. - SCHENECTADY, N. Y.	
PROPERTY LINE FENCE & EROSION CONTROL ITEMS - S.T. GRISWOLD & CO., INC. - WILLISTON, VT.	
CONTRACTOR - EARLE & MERRY INC. - RUTLAND, VT.	
CONTRACT - DATED - OCTOBER 14, 1966.	
RESIDENT ENGINEER - P. J. JETTE	
STARTED - OCTOBER 17, 1966.	
INSPECTOR - R. CASSIDY	
COMPLETED - NOVEMBER 21, 1967.	
RECORD PLANS - P. J. JETTE	
ACCEPTED - NOVEMBER 21, 1967.	

LENGTH OF ROADWAY 6,672.78 FEET = 1.264 MILES

LENGTH OF PROJECT 6,672.78 FEET = 1.264 MILES

ADT 1962	3850
ADT 1986	6000
DHV 1986	740
V	60 MPH
D	61%
T	8%

NOTE: For Right of Way details, see Right of Way plans for this project.

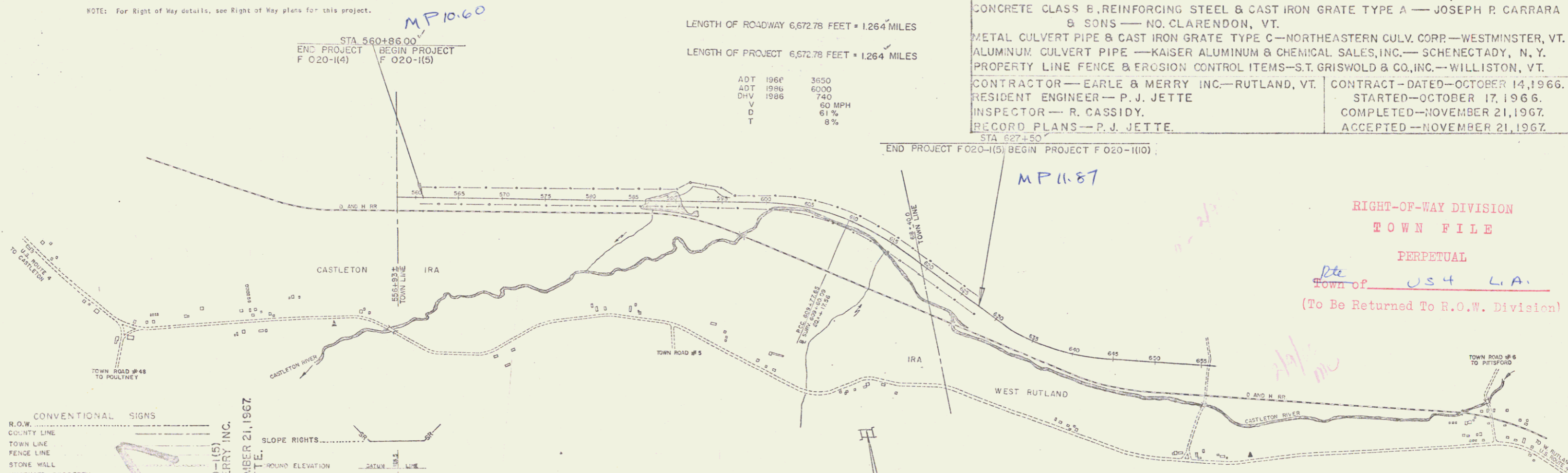

RIGHT-OF-WAY DIVISION
TOWN FILE
PERPETUAL
Town of USA L.A.
(To Be Returned To R.O.W. Division)

CONVENTIONAL SIGNS

R.O.W. LINE	---
COUNTY LINE	---
TOWN LINE	---
FENCE LINE	---
STONE WALL	---
UNFENCED PROPERTY	---
GUARD RAIL	---
TRAVELED WAY	---
RAILROAD	---
RETAINING WALL	---
CENTER LINE	---
SURVEY LINE	---
CULVERT	---
DROP INLET	---
TROLLEY POLE	---
POWER POLE	---
TELEPHONE POLE	---
TREES	---
HEDGE	---
FEDERAL AID CONSTRUCTION IDENTIFICATION SIGNS	---

**IRAW, RUTLAND F020-1(5)
CONTRACTOR EARLE & MERRY INC.
CONST. COMPLETED NOVEMBER 21, 1967
RECORD PLANS - P. J. JETTE**

SLOPE RIGHTS

ROUND ELEVATION	---
RADE ELEVATION	---

CURVE DATA

DEFLECTION OF ANGLE	Δ
DEGREE OF CURVE	D
RADIUS OF CURVE	R
TANGENT DISTANCE	T
LENGTH OF CURVE	L
EXTERNAL DISTANCE	E
POINT OF INTERSECTION	PI
POINT OF CURVE	PC
POINT OF TANGENT	PT
POINT ON TANGENT	POT
POINT ON SUB-TANGENT	POST

SCALE IN FEET

THESE PLANS ARE SUBJECT TO SUCH REVISIONS AS MAY BE REQUIRED BY THE BUREAU OF PUBLIC ROADS OR THE COMMISSIONER OF HIGHWAYS.

CONSTRUCTION IS TO BE CARRIED ON IN ACCORDANCE WITH THESE PLANS AND THE STANDARD SPECIFICATIONS FOR HIGHWAY AND BRIDGE CONSTRUCTION DATED APRIL 1954, AS APPROVED BY THE BUREAU OF PUBLIC ROADS ON OCT. 12, 1954, INCLUDING ALL SUBSEQUENT APPROVED REVISIONS AND SUCH REVISED SPECIFICATIONS AND SPECIAL PROVISIONS AS ARE INCORPORATED IN THESE PLANS.

STAGE I CONSTRUCTION

DEPARTMENT OF COMMERCE
BUREAU OF PUBLIC ROADS
Pin# 99R210

APPROVED <i>R.H. Crowl</i> DATE 11/24/62	APPROVED <i>E.H. Chubb</i> DATE 11/2/62	APPROVED <i>J.M. Brown</i> DATE 11/15/62	APPROVED <i>J.A. Plunk</i> DATE 11/30/62	APPROVED <i>L.W. Lane</i> DATE 11/14/63	APPROVED <i>A.D. Bishop</i> DATE 1/19/63
---	--	---	---	--	---

PROJECT F 020-1 (5)

SHEET 116 SHEETS

DRILLING & BLASTING OF
SOLID ROCK SUBGRADE
ITEM 115
WB 571+25 - 578+25
EB 572+25 - 575+75

PROPERTY LINE FENCE WITH
STEEL POSTS MOD. ITEM 503II
EB 576+00 - 583+00 LF
WB 573+00 - 583+00 LF

*THREE CABLE GUARD RAIL
WITH STEEL POSTS, ITEM 542
WB 567+00 - 583+00 LF
WB 580+00 - 590+36 LF
EB 567+00 - 577+82 LF
EB 580+75 - 581+71 LF
EB 581+60 - 583+00 LF

* BIT CONC CURB, ITEM 555
WB 567+00 - 583+00 LF
EB 567+00 - 577+82 LF
EB 581+60 - 583+00 LF

REVISIONS
 NO. DATE BY
 1 1/14/80 J.E.M.
 2 2/14/80 J.E.M.
 3 2/14/80 J.E.M.

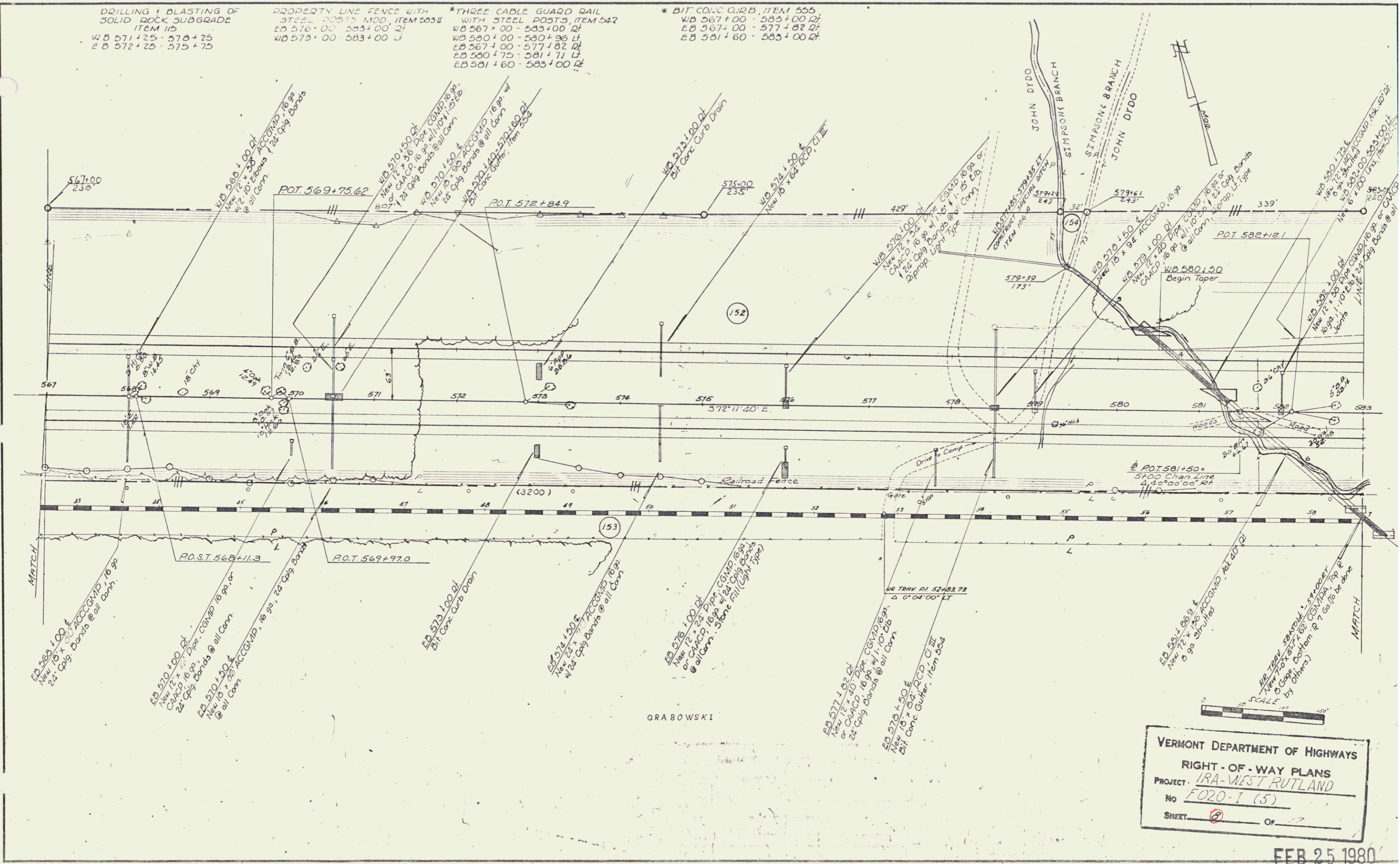

VERMONT DEPARTMENT OF HIGHWAYS
 RIGHT-OF-WAY PLANS
 PROJECT: IRA-WEST RUTLAND
 NO. F020-1 (5)
 SHEET 2 OF 7

FEB 25 1980

- * PROPERTY LINE FENCE WITH STEEL POSTS, MOD. ITEM 503-II
WB 583+00 - 585+00 Lt.
WB 583+00 - 587+50 Lt.
EB 582+00 - 589+00 Lt.
WB 583+00 - 589+00 Lt.
- * THREE CABLE GUARD RAIL WITH STEEL POSTS, 542
WB 583+00 - 591+30 Lt.
WB 587+00 - 590+04 Lt.
EB 583+00 - 592+04 Lt.
EB 583+00 - 599+00 Lt.
- * STANDARD STEEL BEAM GUARD RAIL, ITEM 545-A
595+99 - 596+53 Lt, WB
- * SLOPE EDGING
WB 594+53 - 594+89 Lt
MUCK EXCAVATION
ITEM 117
EB 585+50 - 590+50
WB 585+50 - 590+50
- * 6" CONC CURB
ITEM 205
WB 583+00 - 587+00 Lt.
EB 583+00 - 592+64 Lt.
- * CEDAR LOG GUARD RAIL (Rest Area)
WB 591+75 - 594+07 Lt.

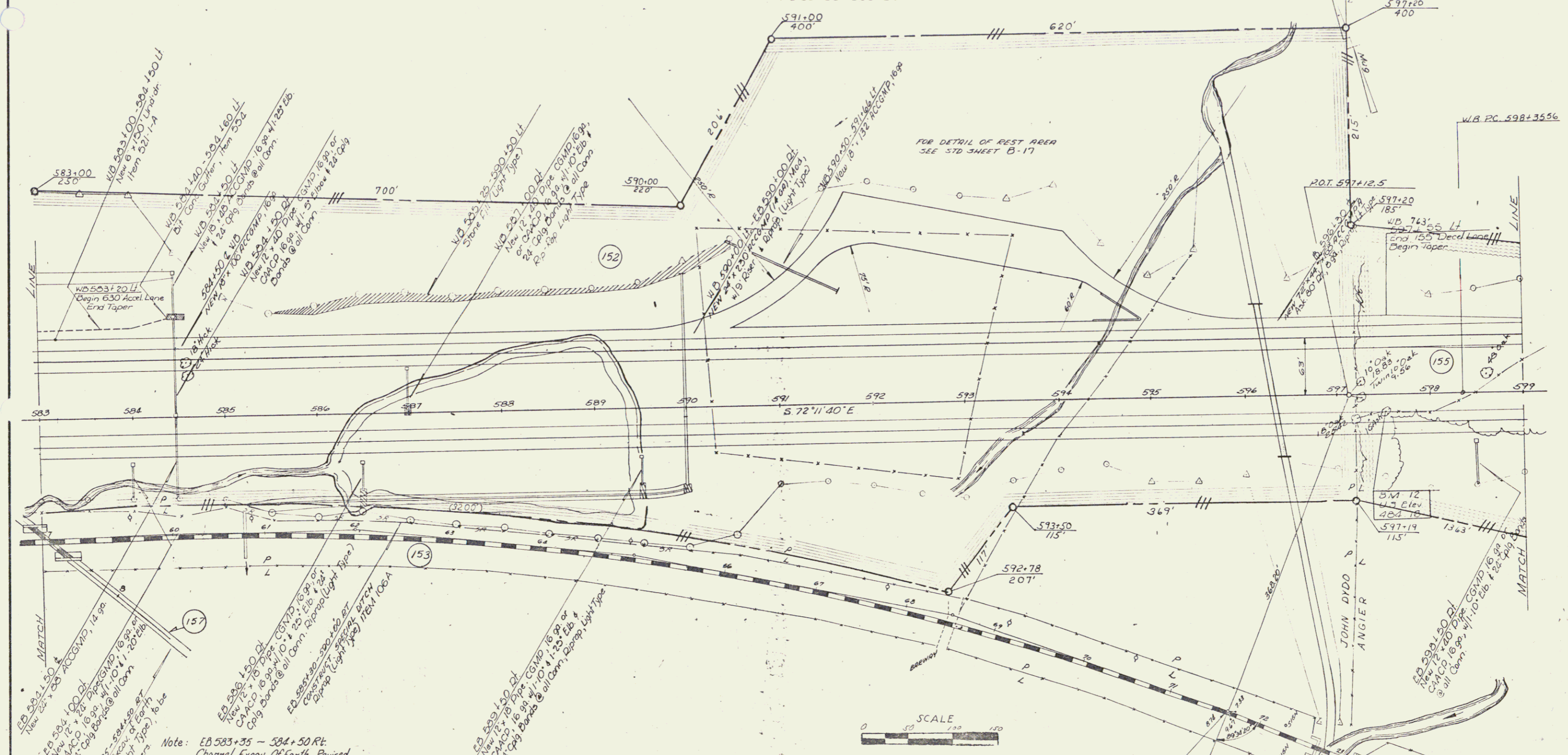

Note: EB 583+35 - 584+50 Rt.
Channel Excav. Of Earth. Revised
See Sheet No 9A For As-built
Ditch Design. Right To Const And
Maintain Ditch Per Order Of
Highway Board.

VERMONT DEPARTMENT OF HIGHWAYS
 RIGHT-OF-WAY PLANS
 PROJECT: I-94 WEST RUTLAND
 No: F020-1 (5)
 SHEET: 8 OF 17

FEB 25 1980

PROPERTY LINE FENCE WITH
STEEL POSTS, MOD. ITEM 542
WB 599+00 - 615+00 LF

THREE CABLE GUARD RAIL
WITH STEEL POSTS, ITEM 542
WB 599+00 - 615+00 RT

MUCK EXCAVATION
ITEM 117
WB 599+50 - 609+50
EB 599+50 - 610+50

INFORMATION SHEET NO. 1
ALPHABETICALLY
BY CHECKED
DATE

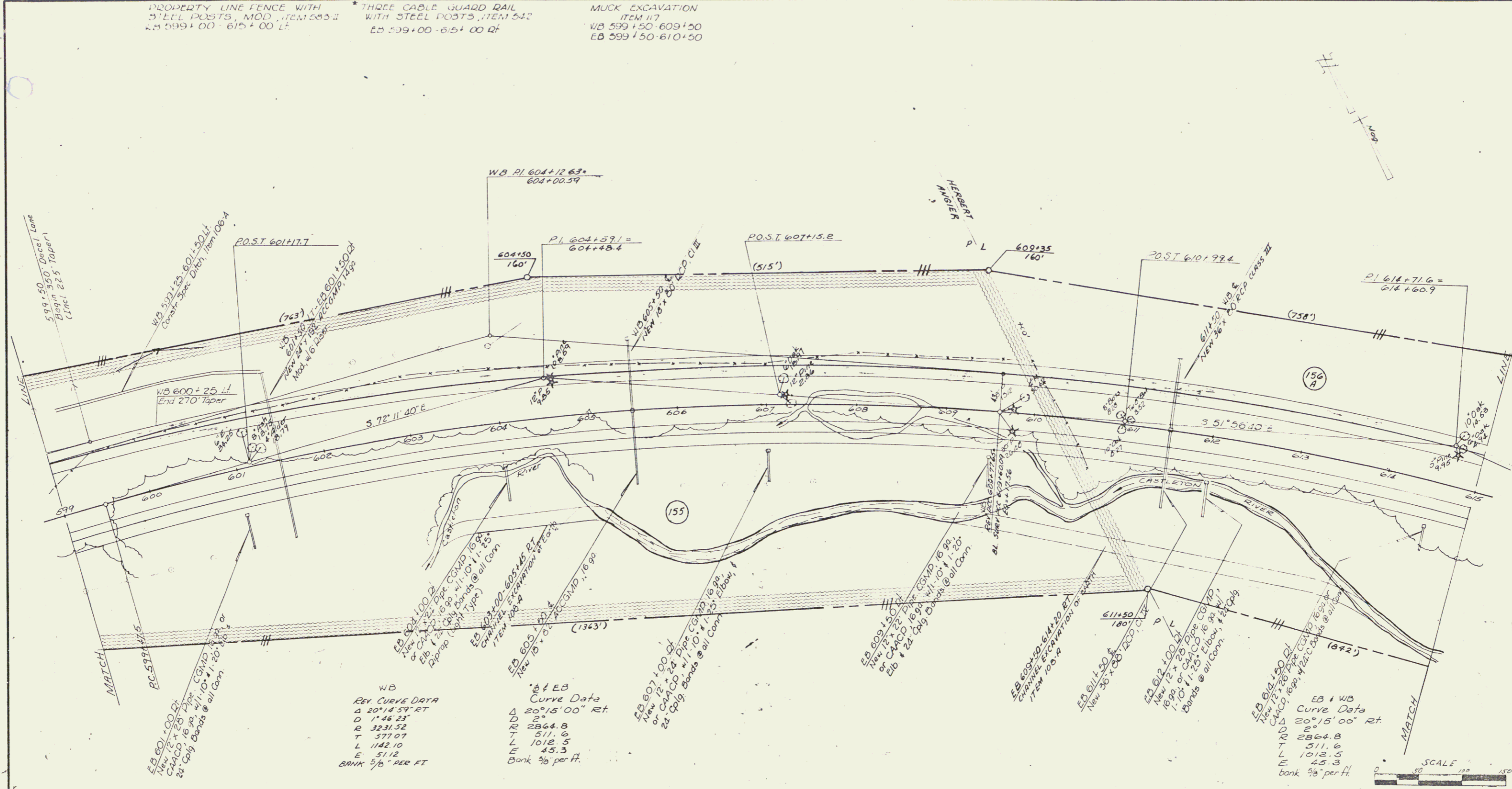

WB
REV. CURVE DATA
Δ 20°14'59" RT
D 1'46'23"
R 3231.52
T 371.07
L 1142.10
E 51.12
BANK 3/8" PER FT

EB
REV. CURVE DATA
Δ 20°15'00" RT
D 2"
R 2864.8
T 511.6
L 1012.5
E 45.3
BANK 3/8" PER FT

EB + WB
Curve Data
Δ 20°15'00" RT
D 2"
R 2864.8
T 511.6
L 1012.5
E 45.3
BANK 3/8" PER FT

VERMONT DEPARTMENT OF HIGHWAYS
RIGHT-OF-WAY PLANS
PROJECT: IRA-WEST RUTLAND
NO. F020-1 (5)
SHEET 10 OF 17



FEB 25 1980

PROPERTY LINE FENCE WITH
STEEL POSTS, MOD. ITEM 503-II
EB 615+00 - 627+50 LI
WB 625+00 - 627+50 LI

* STANDARD STEEL BEAM
GUARD RAIL, ITEM 545-A
616+50 - 617+04 WB LI

* THREE CABLE GUARD RAIL
ITEM 542
WB 619+50 - 627+50 LI
LB 615+00 - 617+70 LI
EB 626+86 - 627+50 LI

4 1/2 WB
Δ 35'00"00" LI
D 1'45"
R 3274.0
T 1032.3
L 2000
E 190.9
bank 1/2 per ft

12in. EB
Δ 36'10"17" LI
D 1'45"
R 3274.05
T 1073.44
L 2074.56
E 171.48
bank 1/2 per ft

PLANNED
 DATE REVISION
 BY
 NO.

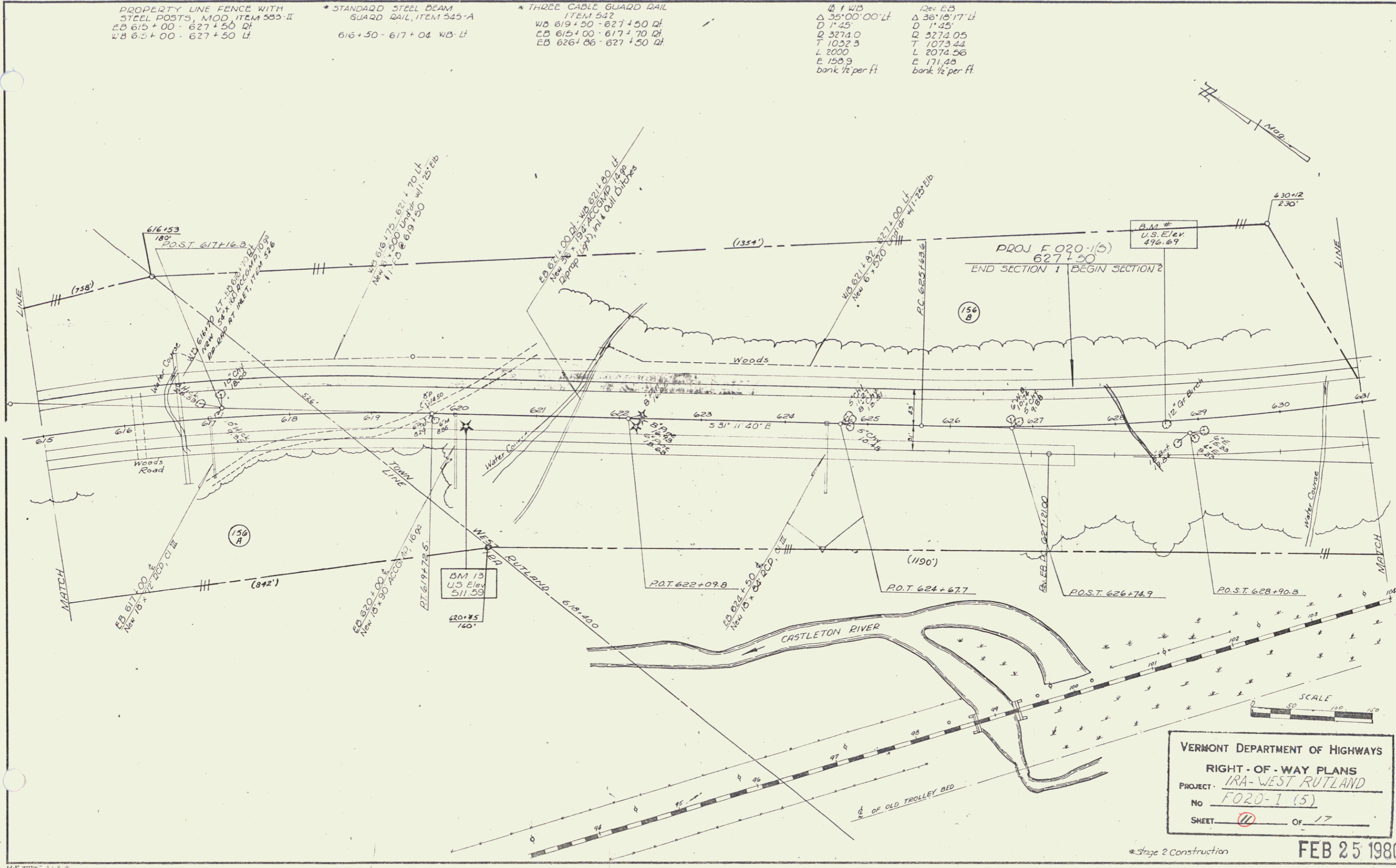

VERMONT DEPARTMENT OF HIGHWAYS
 RIGHT-OF-WAY PLANS
 PROJECT: IRA-WEST RUTLAND
 NO: F020-1 (5)
 SHEET: 11 OF 17

* Stage 2 Construction
 FEB 25 1980

Curve Data
 Δ 35°00'00" LT
 D 1°45'
 R 3274.0
 T 1032.3
 L 2000.0
 E 158.9

DATE REVISIONS
 1. 1/18/80
 2. 2/12/80
 3. 2/12/80
 4. 2/12/80
 5. 2/12/80
 6. 2/12/80
 7. 2/12/80
 8. 2/12/80
 9. 2/12/80
 10. 2/12/80
 11. 2/12/80
 12. 2/12/80
 13. 2/12/80
 14. 2/12/80
 15. 2/12/80
 16. 2/12/80
 17. 2/12/80
 18. 2/12/80
 19. 2/12/80
 20. 2/12/80
 21. 2/12/80
 22. 2/12/80
 23. 2/12/80
 24. 2/12/80
 25. 2/12/80
 26. 2/12/80
 27. 2/12/80
 28. 2/12/80
 29. 2/12/80
 30. 2/12/80
 31. 2/12/80
 32. 2/12/80
 33. 2/12/80
 34. 2/12/80
 35. 2/12/80
 36. 2/12/80
 37. 2/12/80
 38. 2/12/80
 39. 2/12/80
 40. 2/12/80
 41. 2/12/80
 42. 2/12/80
 43. 2/12/80
 44. 2/12/80
 45. 2/12/80
 46. 2/12/80
 47. 2/12/80
 48. 2/12/80
 49. 2/12/80
 50. 2/12/80
 51. 2/12/80
 52. 2/12/80
 53. 2/12/80
 54. 2/12/80
 55. 2/12/80
 56. 2/12/80
 57. 2/12/80
 58. 2/12/80
 59. 2/12/80
 60. 2/12/80
 61. 2/12/80
 62. 2/12/80
 63. 2/12/80
 64. 2/12/80
 65. 2/12/80
 66. 2/12/80
 67. 2/12/80
 68. 2/12/80
 69. 2/12/80
 70. 2/12/80
 71. 2/12/80
 72. 2/12/80
 73. 2/12/80
 74. 2/12/80
 75. 2/12/80
 76. 2/12/80
 77. 2/12/80
 78. 2/12/80
 79. 2/12/80
 80. 2/12/80
 81. 2/12/80
 82. 2/12/80
 83. 2/12/80
 84. 2/12/80
 85. 2/12/80
 86. 2/12/80
 87. 2/12/80
 88. 2/12/80
 89. 2/12/80
 90. 2/12/80
 91. 2/12/80
 92. 2/12/80
 93. 2/12/80
 94. 2/12/80
 95. 2/12/80
 96. 2/12/80
 97. 2/12/80
 98. 2/12/80
 99. 2/12/80
 100. 2/12/80

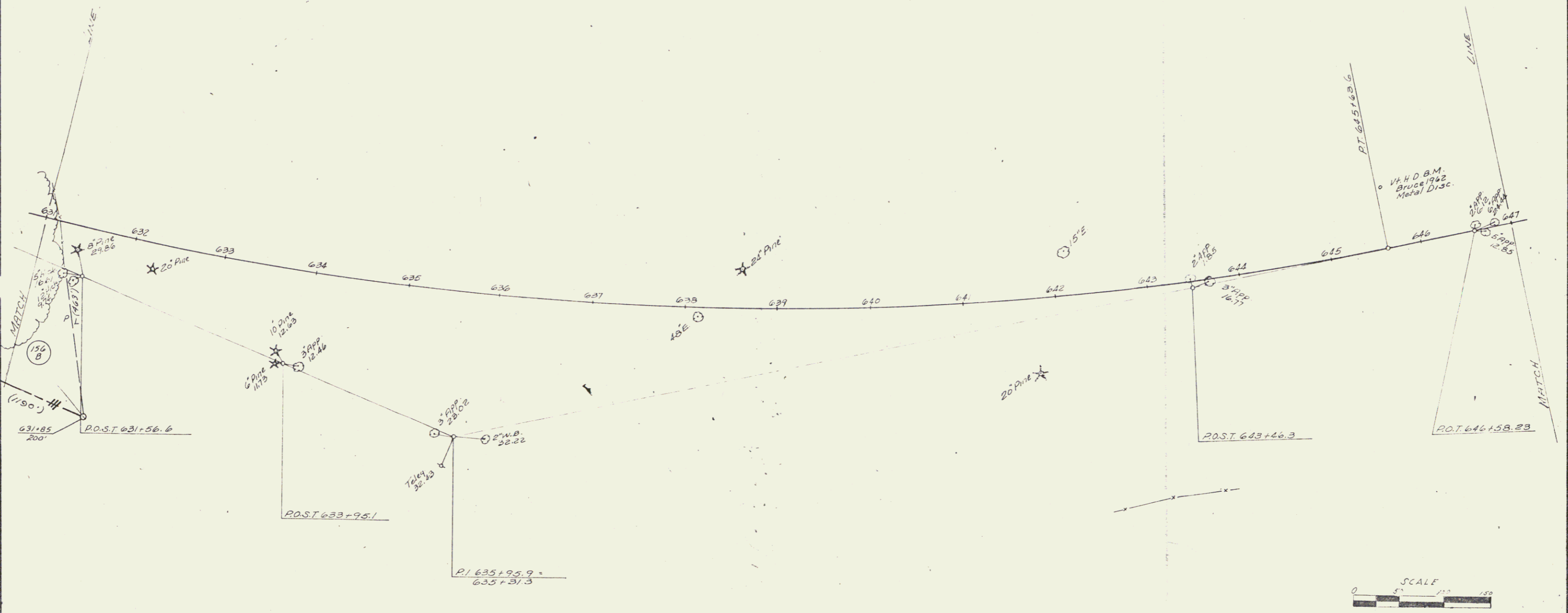

VERMONT DEPARTMENT OF HIGHWAYS
 RIGHT-OF-WAY PLANS
 PROJECT: IRA-WEST RUTLAND
 NO: F020-1 (5)
 SHEET: 12 OF 17

FEB 25 1980

PROPERTY LINE FENCE WITH STEEL POSTS W/OP Item 583-II
 EB 560+88 - 567+00 EL
 WB 560+86 - 567+00 LH

* THREE CABLE GUARD RAIL W/LIGHT STEEL POSTS ITEM 558
 WB 560+83 - 567+00 EL
 EB 560+86 - 567+00 EL

DRILLING & BLASTING OF SOLID ROCK SUBGRADE ITEM 115
 WB 560+86 - 566+25

TERMINATED TIE-ROD ITEM 554
 * BIT-CONC CURB, ITEM 555
 WB 560+86 - 567+00 EL
 EB 560+86 - 567+00 EL

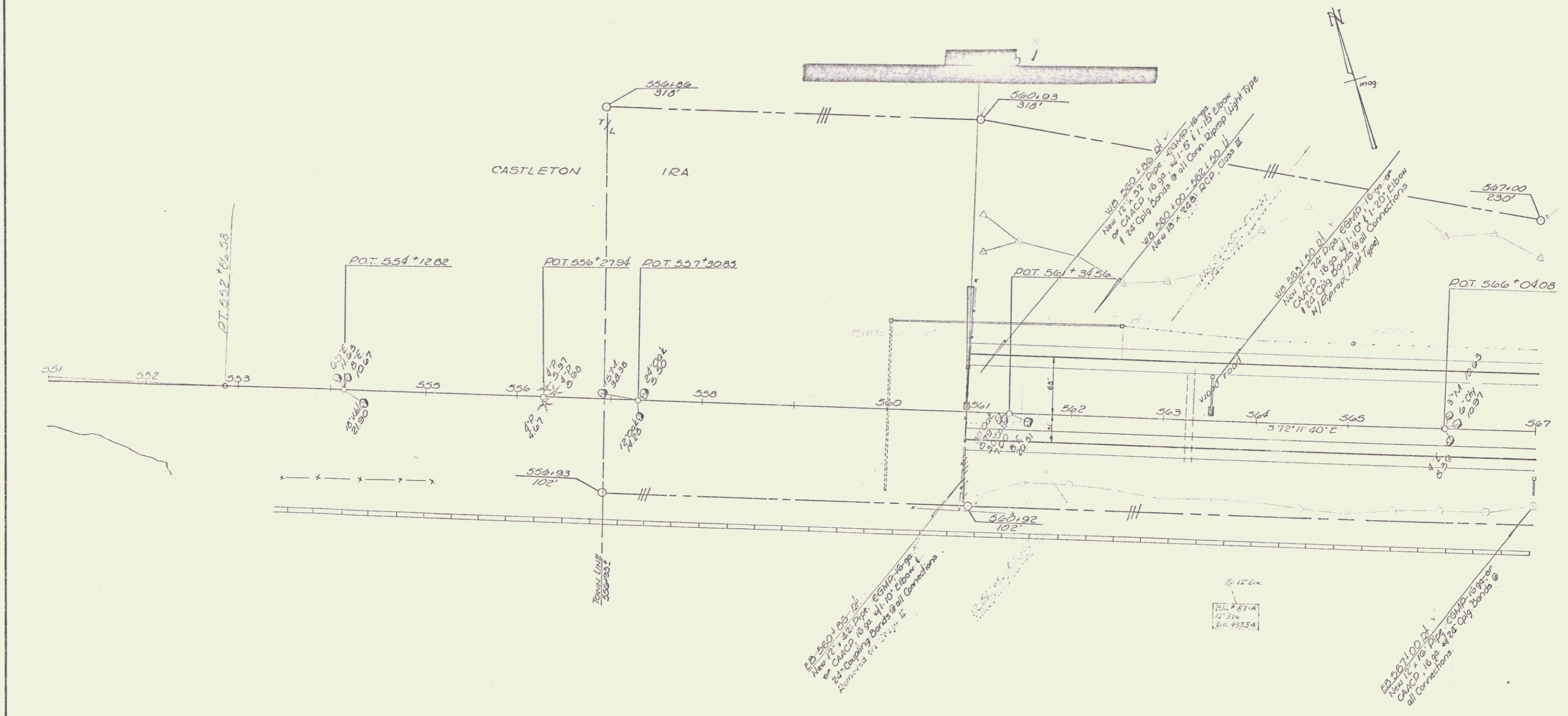

CONTROL OF ACCESS COMPLETE ON THIS SHEET

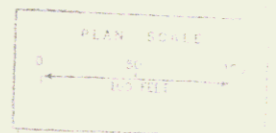

* Stage 2 Construction
 Stage 2 Construction

STAGE 1 CONSTRUCTION

SURVEYED BY Jawa H DATE 3/65
 DRAWN BY Elonagan Collins DATE 3/65
 TRACED BY L. Clark DATE 4/65

IRA - WEST RUTLAND
 PROJ. F NO. 020 - 1(5) (11)
 SHEET 20 OF 116

PLAN
 PREPARED BY
 DATE
 CHECKED BY
 DATE
 APPROVED BY
 DATE

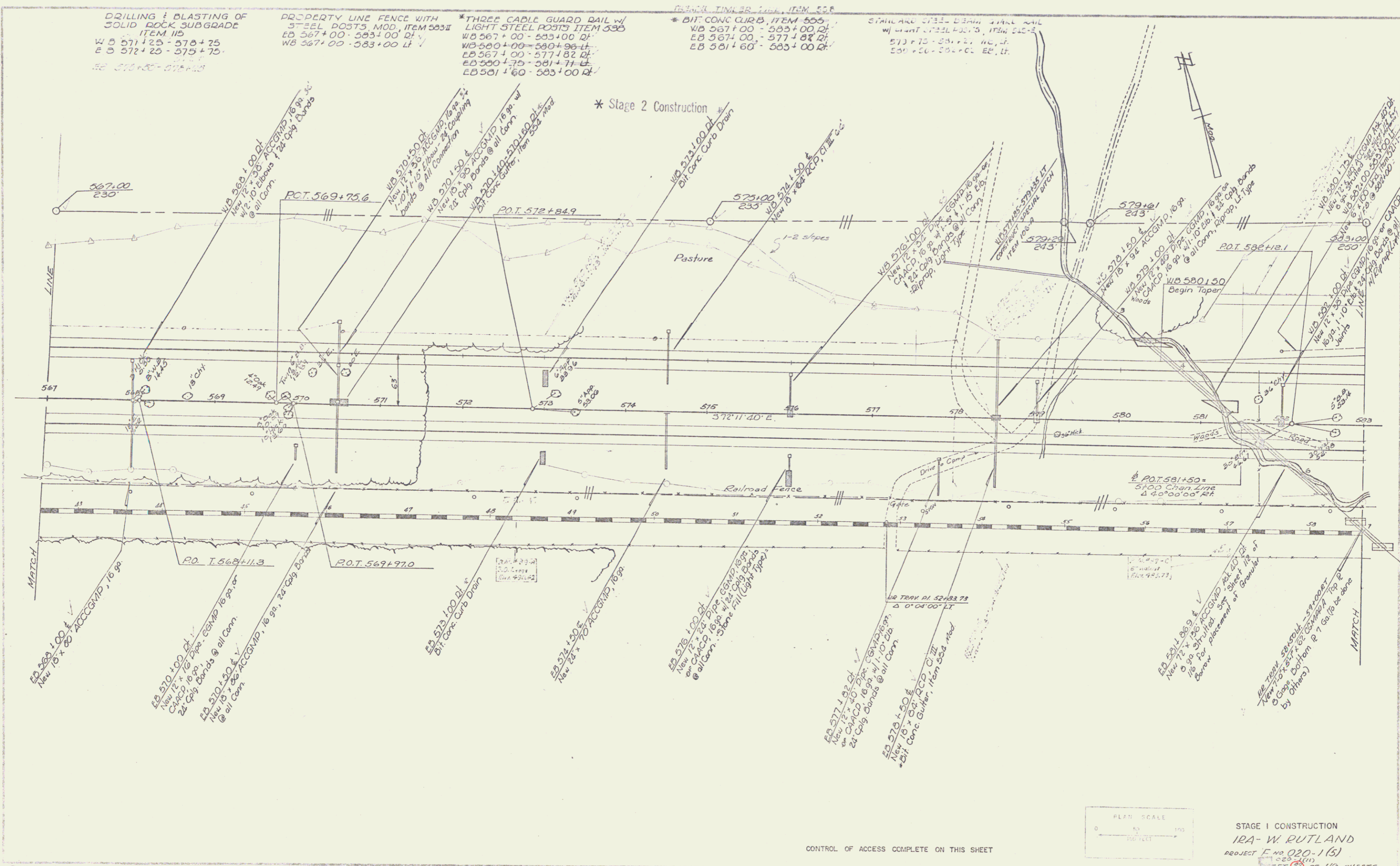

DRILLING & BLASTING OF
 SOLID ROCK SUBGRADE
 ITEM 115
 WB 571+25 - 578+75
 EB 572+25 - 575+75

PROPERTY LINE FENCE WITH
 5\"/>

*THREE CABLE GUARD RAIL w/
 LIGHT STEEL POSTS ITEM 505
 WB 567+00 - 583+00 RL
 EB 569+00 - 580+96 RL
 EB 567+00 - 577+82 RL
 EB 580+75 - 581+74 RL
 EB 581+60 - 583+00 RL

*BIT CONC CURB, ITEM 505
 WB 567+00 - 583+00 RL
 EB 567+00 - 577+82 RL
 EB 581+60 - 583+00 RL

STAIRLAND STEEL BEAM STAKE W/IL
 W/ 4\"/>

* Stage 2 Construction

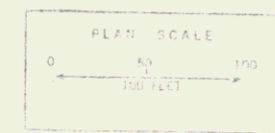

CONTROL OF ACCESS COMPLETE ON THIS SHEET

STAGE I CONSTRUCTION
 IRA - W. RUTLAND
 PROJECT E No 020-1 (5)
 1:250 (in)
 SHEET 77 OF 110 SHEETS

Stage 2 Construction
 Sheet 77 of 110 Sheets

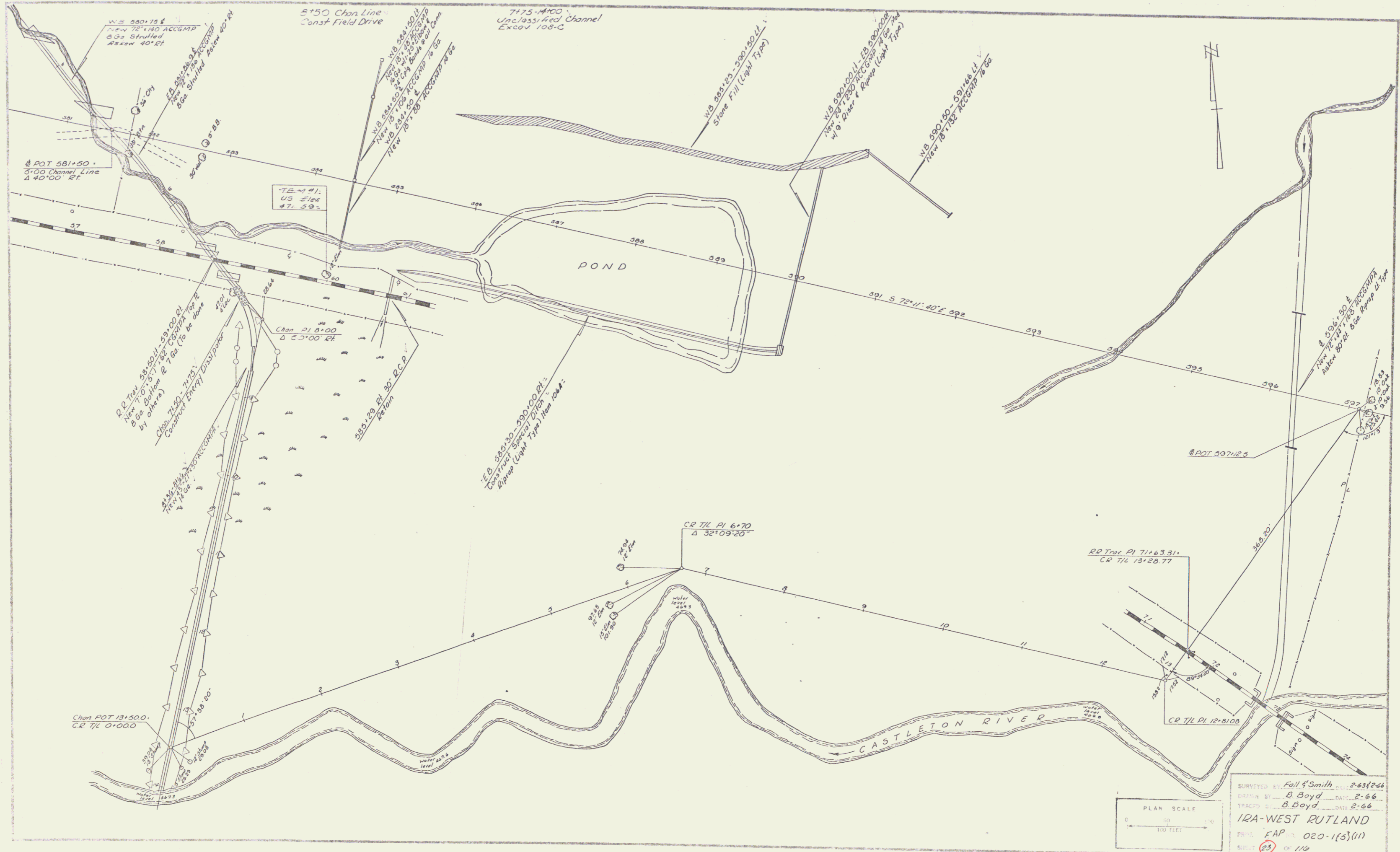

PLAN SCALE
 0 50 100 FEET

SURVEYED BY: Fall S. Smith 2-63-64
 DRAWN BY: B. Boyd 2-66
 TRACED BY: B. Boyd 2-66
IRA-WEST RUTLAND
 PROJ. CAP. 020-1(3)(11)
 SHEET 23 OF 110

Stage 2 Construction Sheet 78 of 170 Sheets

12

PLAN	DESIGNED	BY	DATE
	CHECKED	BY	DATE
	REVISIONS	NO.	DESCRIPTION

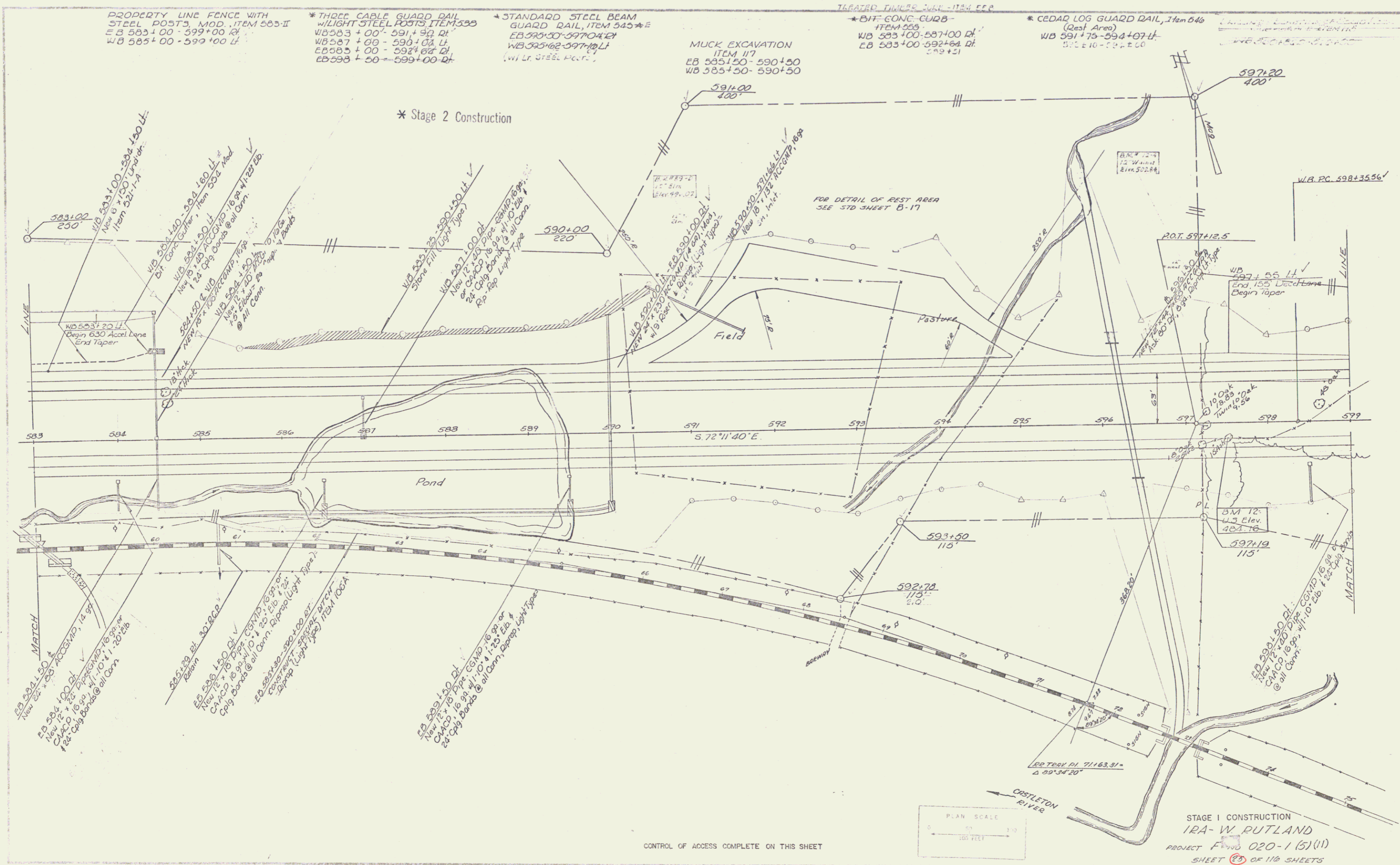

PROPERTY LINE FENCE WITH STEEL POSTS, MOD. ITEM 583-II
 EB 583+00 - 599+00 Lt.
 WB 585+00 - 599+00 Lt.

*THREE CABLE GUARD RAIL W/LIGHT STEEL POSTS ITEM 593
 WB 583+00 - 591+90 Lt.
 WB 587+00 - 590+00 Lt.
 EB 583+00 - 592+64 Lt.
 EB 588+50 - 599+00 Lt.

*STANDARD STEEL BEAM GUARD RAIL, ITEM 543 *E
 EB 585+50 - 597+00 Lt.
 WB 585+62 - 597+00 Lt.
 (w/ Lt. Steel Posts)

MUCK EXCAVATION ITEM 117
 EB 585+50 - 590+50
 WB 585+50 - 590+50

*BIT CONG. CURB - ITEM 585
 WB 583+00 - 587+00 Lt.
 EB 583+00 - 592+64 Lt.
 (w/ Lt. Steel Posts)

*CEDAR LOG GUARD RAIL, Item 546 (East Area)
 WB 591+75 - 594+07 Lt.
 WB 592+10 - 592+50 Lt.

* Stage 2 Construction

CONTROL OF ACCESS COMPLETE ON THIS SHEET

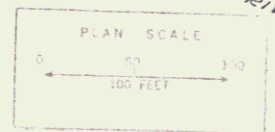

STAGE I CONSTRUCTION
 IRA-W. RUTLAND
 PROJECT F-020-1(5)(11)
 SHEET 25 OF 116 SHEETS

Stage 2 Construction Sheet 80 of 170 Sheets

PROPERTY LINE FENCE WITH STEEL POSTS, MOD. ITEM 32-11
WB 599+00 - 615+00 Lt. / EB 599+00 - 615+00 Rt.

THREE CABLE GUARD RAIL WITH LIGHT STEEL POSTS ITEM 1338
EB 599+00 - 615+00 Rt. / 609+30

MUCK EXCAVATION ITEM 117
WB 599+50 - 609+50 / EB 599+50 - 610+50

CONSTRUCT U-TURN V 603+50 Med.

TREATED TIMBER CURB, ITEM 206
603+42 - 615+00 Rt. / Lt.

* Stage 2 Construction

PLAN	REVISED	BY	DATE
REVISED	BY	DATE	
REVISED	BY	DATE	
REVISED	BY	DATE	
REVISED	BY	DATE	
REVISED	BY	DATE	
REVISED	BY	DATE	
REVISED	BY	DATE	
REVISED	BY	DATE	
REVISED	BY	DATE	

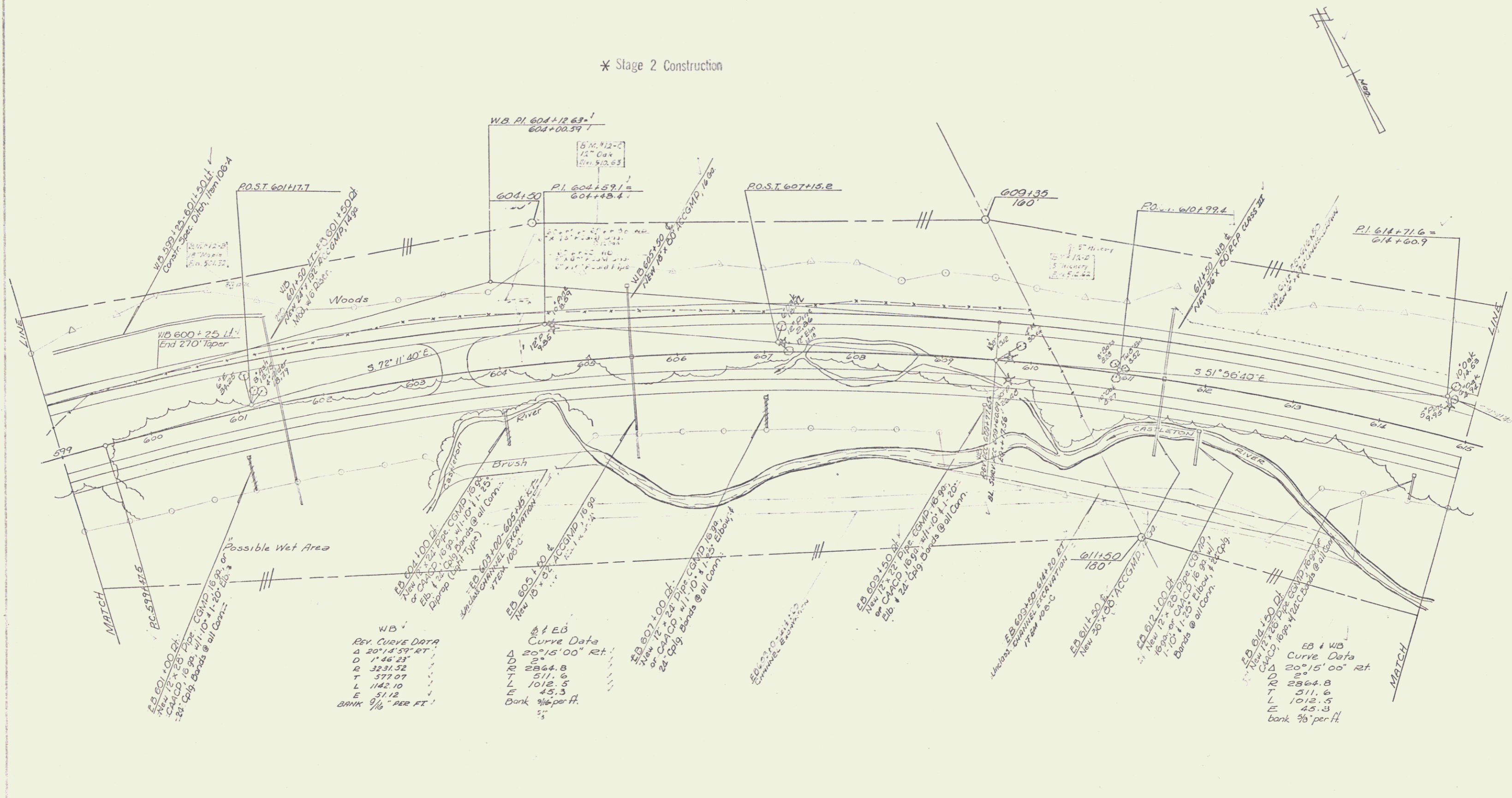

WB		EB	
REV. CURVE DATA		Curve Data	
Δ	20°12'59" RT.	Δ	20°15'00" RT.
D	1'46" 23"	T	511.6
R	3231.52	T	2864.8
T	577.97	L	1012.5
L	1142.10	E	45.3
E	51.12	Bank	3/4" per ft.
Bank	9/16" per ft.		

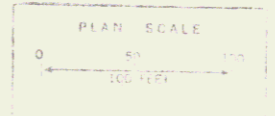

CONTROL OF ACCESS COMPLETE ON THIS SHEET

STAGE I CONSTRUCTION
IRA W. RUTLAND
PROJ. NO. 020-1 (5) (11)
SHEET 27 OF 110 SHEETS

Stage 2 Construction

Sheet 27 of 110 Sheets

