

PROPERTY LINE FENCE WITH  
STEEL POSTS, MOD. ITEM 503-II  
EB 615+00 - 627+50 LI  
WB 625+00 - 627+50 LI

\* STANDARD STEEL BEAM  
GUARD RAIL, ITEM 545-A  
616+50 - 617+04 WB LI

\* THREE CABLE GUARD RAIL  
ITEM 542  
WB 619+50 - 627+50 LI  
LB 615+00 - 617+70 LI  
EB 626+86 - 627+50 LI

4 1/2 WB	12in. EB
Δ 35'00"00" LI	Δ 36'10"17" LI
D 1'45"	D 1'45"
R 3274.0	R 3274.05
T 1032.3	T 1073.44
L 2000	L 2074.56
E 190.9	E 171.48
bank 1/2 per ft	bank 1/2 per ft

PLANNED  
 DATE  
 DRAWN BY  
 CHECKED BY  
 NO.

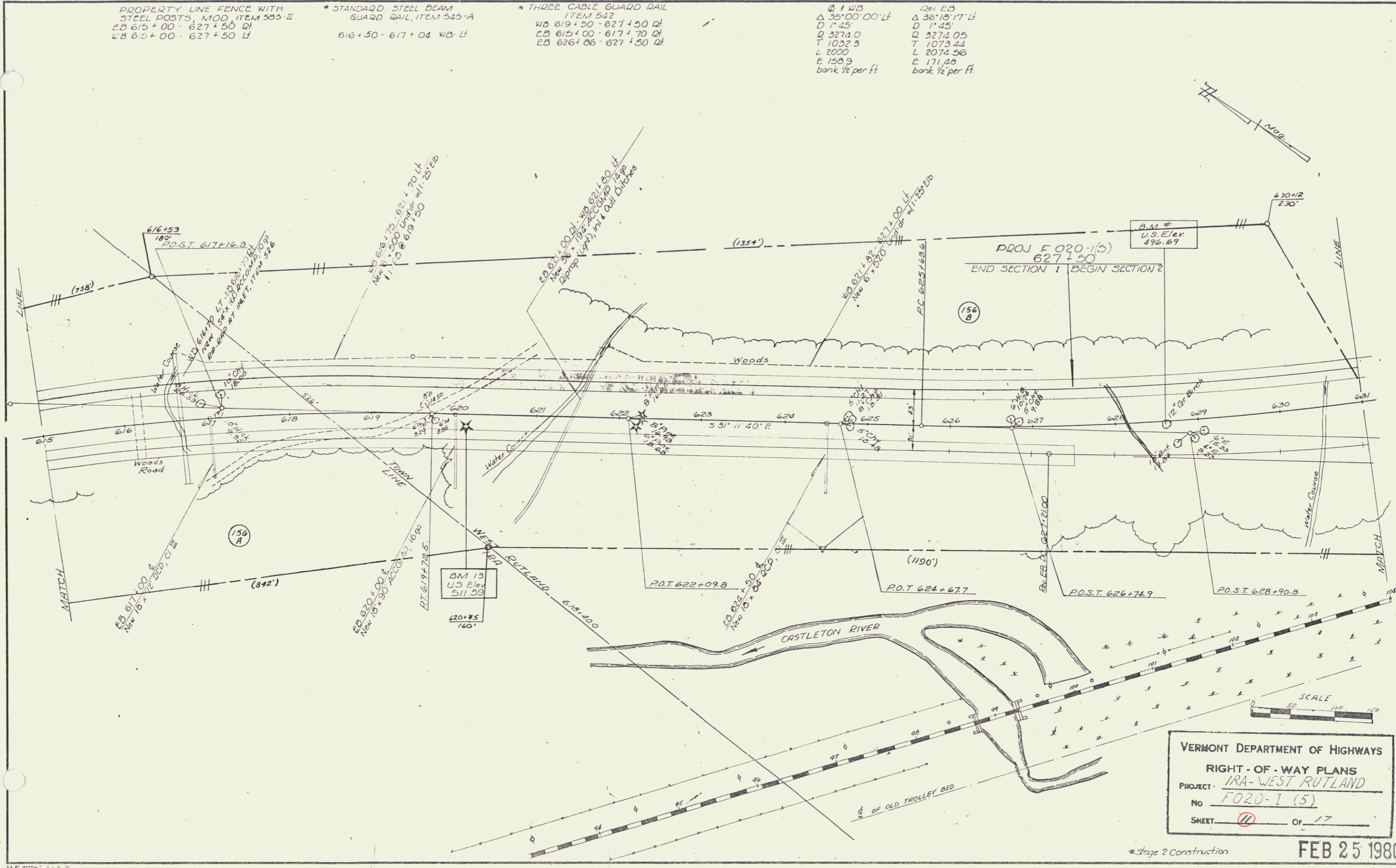

VERMONT DEPARTMENT OF HIGHWAYS  
 RIGHT-OF-WAY PLANS  
 PROJECT: IRA-WEST RUTLAND  
 NO: F020-1(5)  
 SHEET: 11 OF 17

\* Stage 2 Construction  
 FEB 25 1980