

DRILLING & BLASTING OF
SOLID ROCK SUBGRADE
ITEM 115
WB 571+25 - 578+25
EB 572+25 - 575+75

PROPERTY LINE FENCE WITH
STEEL POSTS MOD. ITEM 503II
EB 576+00 - 583+00 LF
WB 573+00 - 583+00 LF

*THREE CABLE GUARD RAIL
WITH STEEL POSTS, ITEM 542
WB 567+00 - 583+00 LF
WB 580+00 - 590+36 LF
EB 567+00 - 577+82 LF
EB 580+75 - 581+71 LF
EB 581+60 - 583+00 LF

*BIT CONC CURB, ITEM 555
WB 567+00 - 583+00 LF
EB 567+00 - 577+82 LF
EB 581+60 - 583+00 LF

REVISIONS
 NO. DATE BY
 1 1/14/80 J.E.

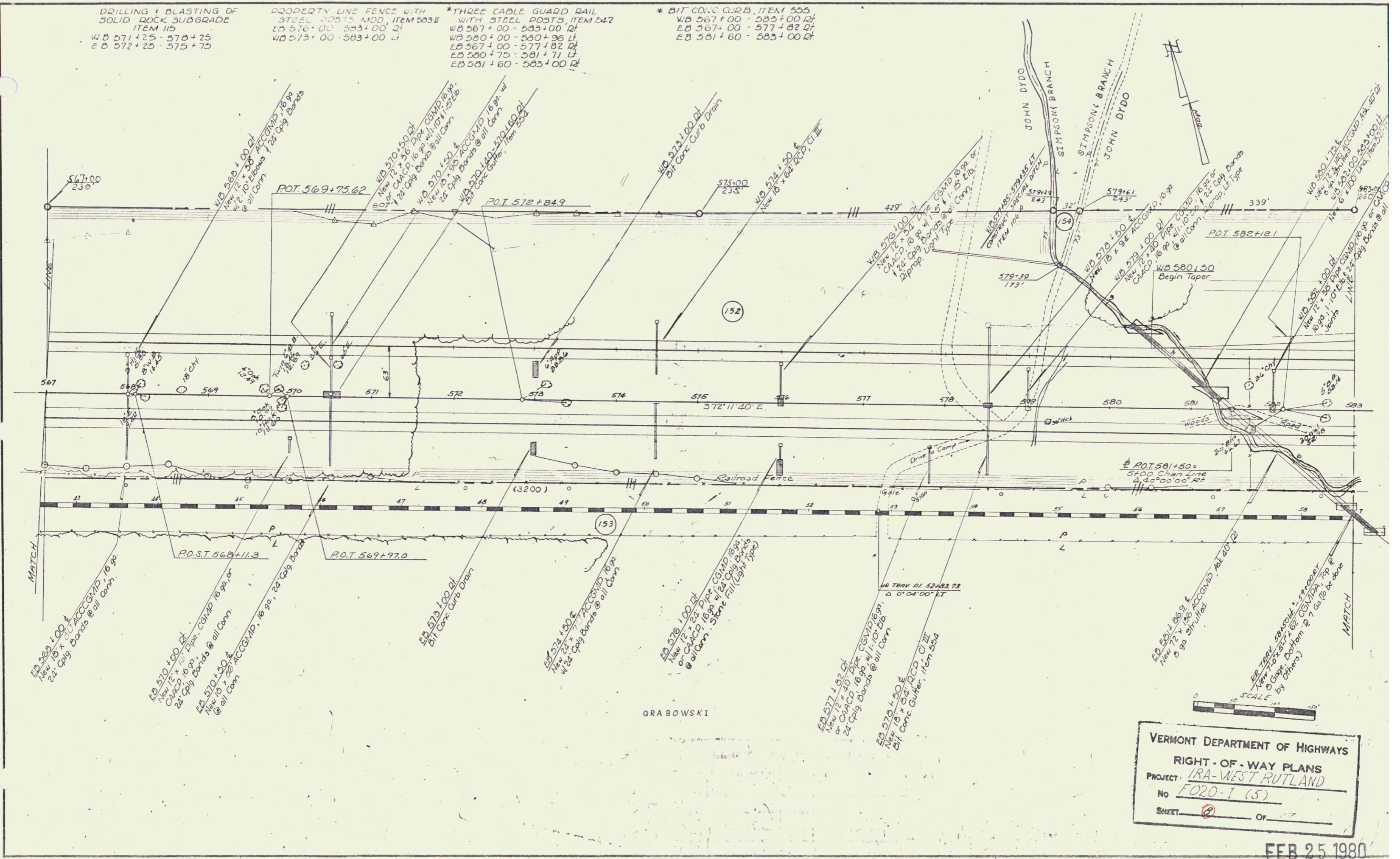

VERMONT DEPARTMENT OF HIGHWAYS
 RIGHT-OF-WAY PLANS
 PROJECT: IRA-WEST RUTLAND
 NO. F020-1 (5)
 SHEET 2 OF 7

FEB 25 1980