

CONSTRUCT DRIVE	
STATION	POS
523+78	RT

CHAIN LINK FENCE 6' HIGH			
STATION	POS	STATION	POS
521+20	RT	523+25	RT
523+25	RT	525+00	RT

CONSTRUCT RAMP		
RAMP	STATION	STATION
J	520+57	521+99.69
K	520+75	521+00

CONSTRUCT SPEED CHANGE LAINE		
STATION	STATION	POS
525+67	526+09	RT

DEMOLITION AND DISPOSAL OF BUILDING ITEM 556	
STATION	POS
525+47	LT
526+30	LT
525+47	LT

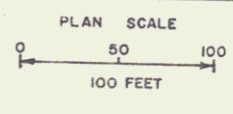
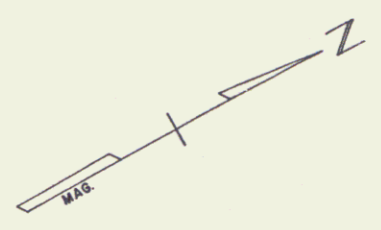
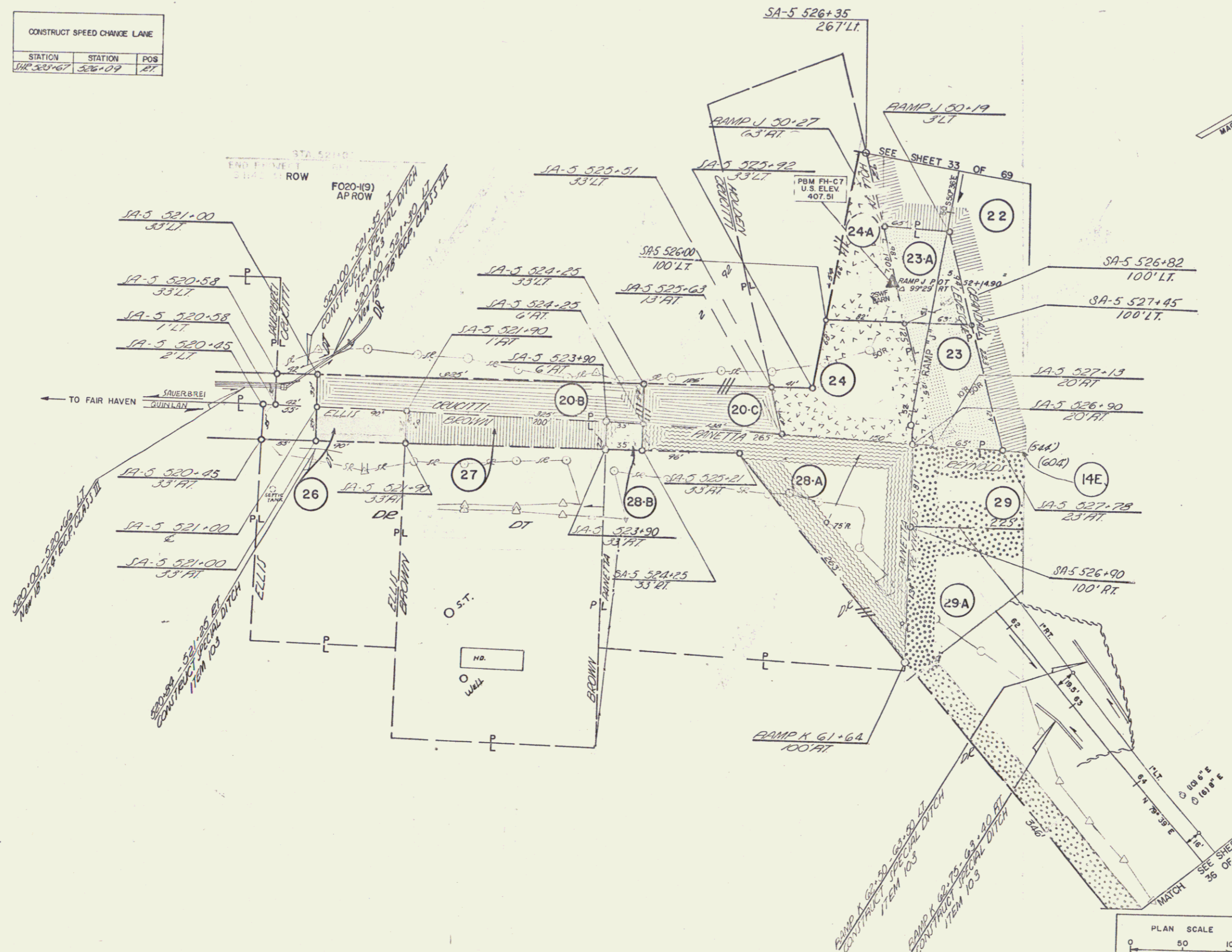

* STAGE 2 CONSTRUCTION
 STATE OF VERMONT
 DEPARTMENT OF HIGHWAYS
 RELOCATION OF US ROUTE 4 in the town of
 FAIR HAVEN
 PLAN
 SA-5 520+00-528+00
 WESTER-MARTIN, INC.
 CONSULTING ENGINEERS
 50 BURLINGTON, VERMONT
 SURVEYED BY W.M. INC. CHECKED BY A.M. RAS SCALE AS SHOWN
 DRAWN BY J.O. IN CHARGE RAS DATE 11/14/67
 PROJECT NO. F020-119 AP ROW SHEET 34 OF 69